

iHFG Standard Components

Room Layout Sheet

Room Name **1 Bed Room - Mental Health, 18m²**

RLS Room Code

1br-mh-18-i

RDS Room Code

1br-mh-18-i

- BD/D BED - DOMESTIC, SINGLE
- BH/LM BULKHEAD - LAMINATE
- BH/PB BULKHEAD - PLASTERBOARD, PAINT FINISH
- BLK LOCKER - BEDSIDE
- BLVI BLIND - VENETIAN, INTEGRAL
- BRCTVW BRACKET - TELEVISION, WALL MOUNTED
- CBD/WD CUPBOARD - WARDROBE
- CHR/P CHAIR - PATIENT
- CHR/V CHAIR - VISITOR
- COM/IPTV COMMUNICATION OUTLET - INTERNET PROTOCOL TELEVISION
- CPT CARPET
- DK/BI DESK - BUILT IN
- EC EMERGENCY CALL
- FS FIXED SHELF
- L/N-V LIGHT - NIGHT LIGHT, VANDAL PROOF
- L/R-V LIGHT - READING, VANDAL PROOF
- LS/E LIGHT SWITCH - ENSUITE
- LS/R LIGHT SWITCH - ROOM
- LS/RL LIGHT SWITCH - READING LIGHT
- MRA MIRROR - ACRYLIC
- OPV OBSERVATION PANEL WITH INTEGRAL VENETIAN BLINDS
- PC PATIENT CALL
- PO/1 POWER OUTLET - SINGLE
- PO/C POWER OUTLET - CLEANER'S
- SAC STAFF ASSIST CALL
- SK7 TIMBER SKIRTING
- V1 VINYL FLOORING, STANDARD SLIP RESISTANT
- WP/L WALL PANEL, LAMINATE
- WPP WALL PROTECTION PANEL
- WPF WALL PAINT FINISH

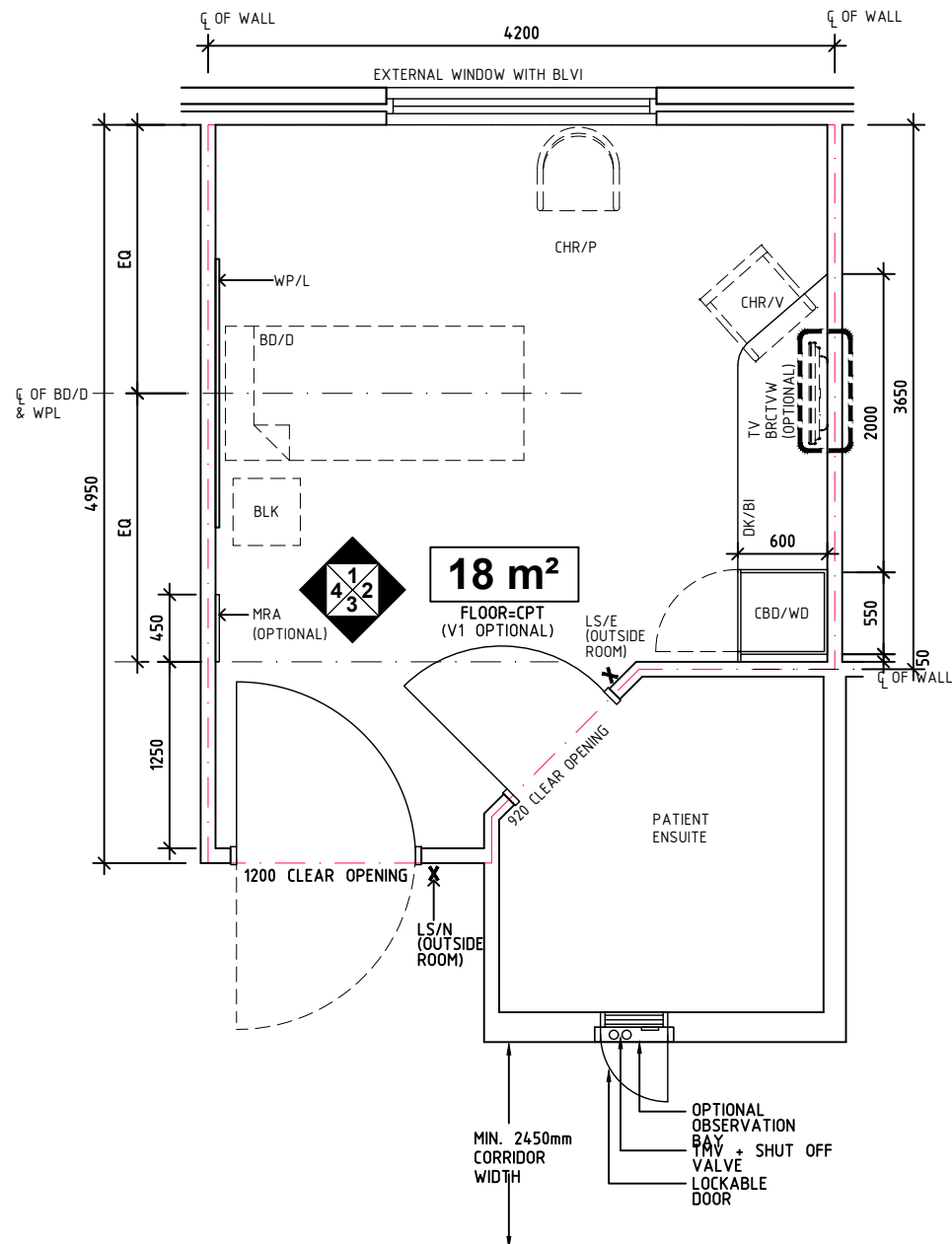

PLAN

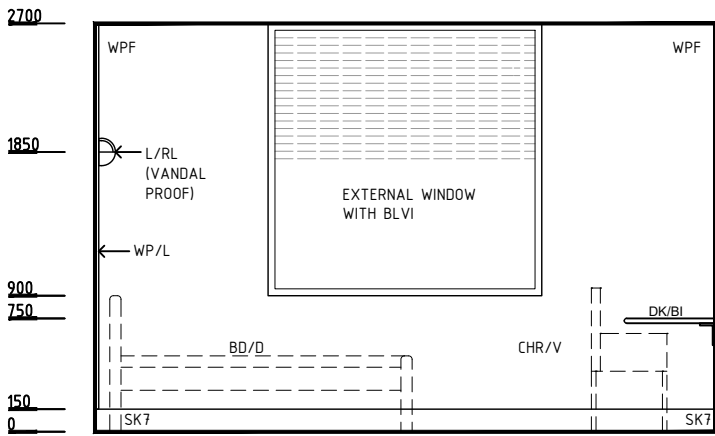

ELEVATION 1

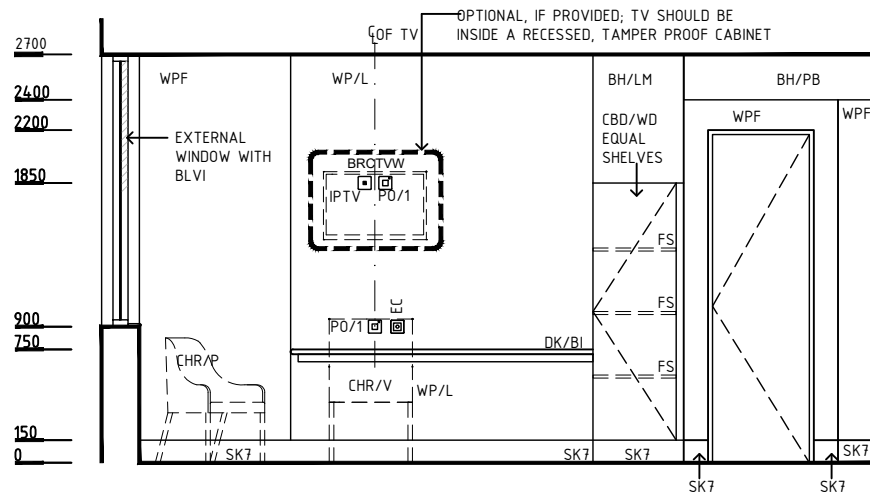

ELEVATION 2

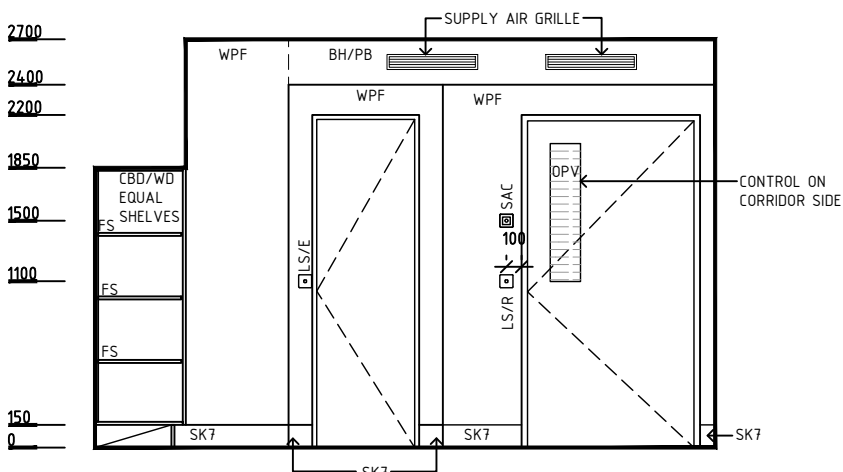

ELEVATION 3

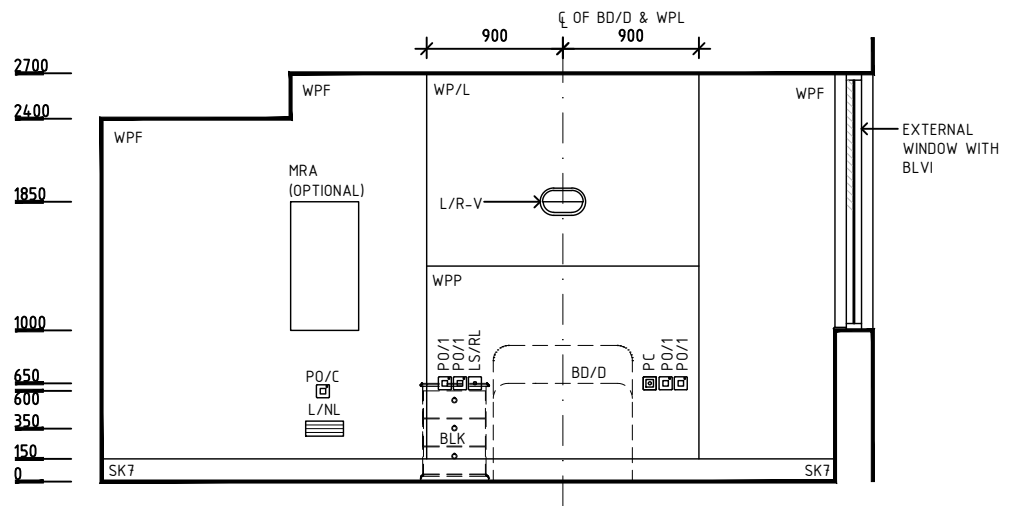

ELEVATION 4

REV	DESCRIPTION	DATE	BY	REV	DESCRIPTION	DATE	BY	COMPATIBILITY
1	FIRST ISSUE	30.08.11	SK					
2	GENERAL REVISION	31.10.12	CT					
3	GENERAL REVISION	30.09.22	AK					



International Health Facility Guidelines at:
www.healthdesign.com.au/iHFG
 Editable version of Standard Components on
 Health Facility Briefing System (HFBS) at:
www.healthdesign.com.au/TAHPI



DESIGNED	APPROVED	DATE	SCALE(S)	SHEET
AK	RH	30.09.22	1:50 in A3	1 OF 2
CAD FILE NAME		PAPER DRAWING ID		ISSUE
1br-mh-18-i		1br-mh-18-i-1		3

iHFG Standard Components

Room Layout Sheet

Room Name **1 Bed Room - Mental Health, 18m2 (Inboard Ensuite)**

RLS Room Code

1br-mh-18-i

RDS Room Code

1br-mh-18-i

GENERAL NOTES:

THIS DRAWING TO BE READ IN CONJUNCTION WITH R.D.S. (ROOM DATA SHEETS) WHICH TAKES PRECEDENCE.

CEILING LEGEND:

- BH-PB PLASTERBOARD BULKHEAD
- PB PLASTERBOARD FLUSH SET CEILING
- PC3 PLASTERBOARD SQUARE SET CORNICE.
- GRID LINE

- ACT ← CEILING TYPE
- 2700 ← HEIGHT ABOVE F.F.L.

ELEC LEGEND:

- L/DRV LIGHT - DOWNLIGHT, RECESSED, VANDAL PROOF
- L/LL-V LIGHT - LIGHT LED, VANDAL PROOF

MECHANICAL LEGEND:

- SUPPLY AIR GRILLE / VANDAL PROOF
- RETURN AIR GRILLE / VANDAL PROOF

FIRE SERVICES LEGEND:

- SMOKE DETECTOR
- SPRINKLER

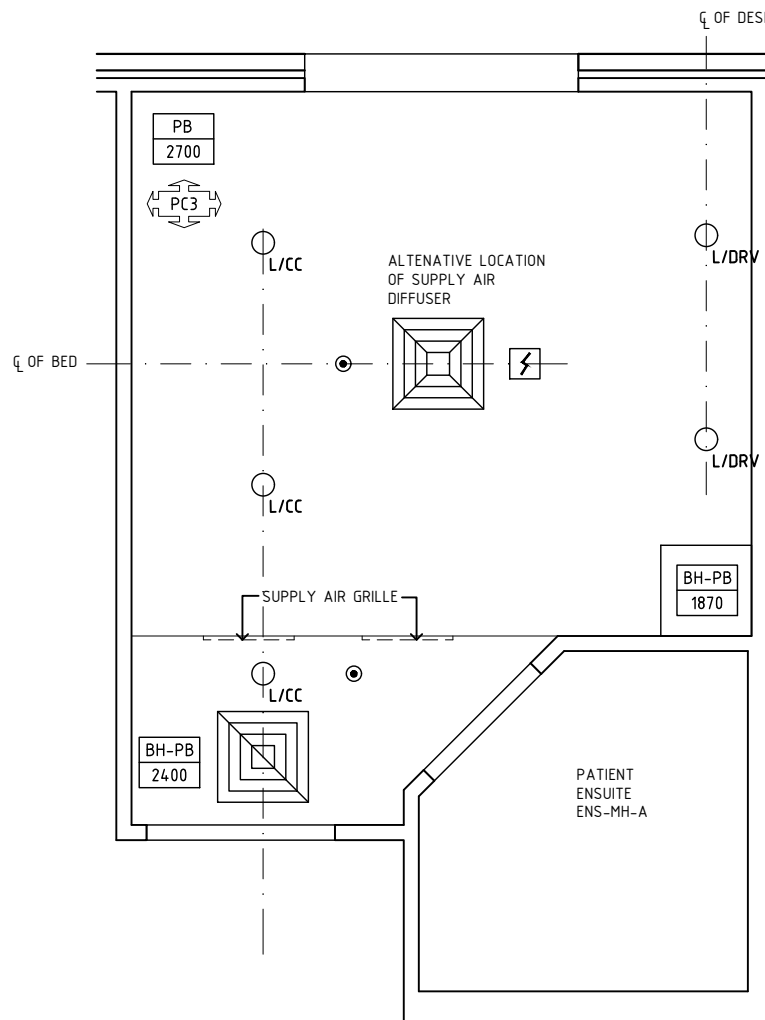

REFLECTED CEILING PLAN

REV	DESCRIPTION	DATE	BY	REV	DESCRIPTION	DATE	BY	COMPATIBILITY
1	FIRST ISSUE	30.08.11	SK					
2	GENERAL REVISION	31.10.12	CT					
3	GENERAL REVISION	30.09.22	AK					

International Health Facility Guidelines	International Health Facility Guidelines at: www.healthdesign.com.au/iHFG Editable version of Standard Components on Health Facility Briefing System (HFBS) at: www.healthdesign.com.au/TAHPI			DESIGNED	APPROVED	DATE	SCALE(S)	SHEET
	AK	RH		30.09.22	1:50 in A3	2 OF 2		
	CAD FILE NAME			PAPER DRAWING ID		ISSUE		
1br-mh-18-i		1br-mh-18-i-2		3				

This document is for advisory purpose only