

iHFG Standard Components

Room Layout Sheet

Room Name | **1 Bed Room - Standard, 18m², Alternative Option**

RLS Room Code

1br-st-18-i

RDS Room Code

1br-st-18-i

- BD/IE BED - INPATIENT, ELECTRIC
- BH/PB BULKHEAD - PLASTERBOARD, PAINT FINISH
- BLK LOCKER - BEDSIDE
- BLVI BLIND - VENETIAN, INTEGRAL
- BRCSB BRACKET - SUCTION BOTTLE
- BRCTVW BRACKET - TELEVISION, WALL MOUNTED
- CBD/SP CUPBOARD - SPECIAL
- CBD/WD CUPBOARD - WARDROBE
- CG CORNER GUARD
- CHR/P CHAIR - PATIENT
- CHR/V CHAIR - VISITOR
- COM/2 COMMUNICATION OUTLET - DOUBLE
- COM/IPTV COMMUNICATION OUTLET - INTERNET PROTOCOL TELEVISION
- CPS CURTAIN - PRIVACY SCREEN
- CTPS CURTAIN TRACK - PRIVACY SCREEN
- DDG DISPENSER - DISPOSABLE GLOVES
- DFP DOOR AND DOOR FRAME PROTECTION
- DHS DISPENSER - HAND SANITISER
- DHT DISPENSER - PAPER HAND TOWEL
- DK/BI DESK - BUILT IN
- DSA DISPENSER - SOAP, ANTISEPTIC
- EC EMERGENCY CALL
- FR/UB FRIDGE - UNDER BENCH
- FS FIXED SHELF
- HWB/IV HAND WASH BASIN - INTEGRAL VANITY
- IVS IV STAND - MOBILE
- L/NL LIGHT - NIGHT LIGHT
- LS/3 LIGHT SWITCH - 3 GANG
- LS/E LIGHT SWITCH - ENSUITE
- LS/EL LIGHT SWITCH - EXAMINATION LIGHT
- MA MEDICAL AIR
- MR MIRROR
- O2 OXYGEN
- OPV OBSERVATION PANEL WITH INTEGRAL VENETIAN BLINDS
- PC PATIENT CALL
- PCH PATIENT CALL HANDSET
- PO/1 POWER OUTLET - SINGLE
- PO/1E POWER OUTLET - EMERGENCY, SINGLE
- PO/2 POWER OUTLET - DOUBLE
- PO/C POWER OUTLET - CLEANER'S
- S SUCTION
- SAC STAFF ASSIST CALL
- SB SUCTION BOTTLE
- SBK SPLASHBACK
- SK4 FLOOR VINYL COVERED SKIRTING
- SP SERVICES PANEL
- SUFS SHELVE UNIT - FIXED SHELVES
- TAP/ST TAPWARE - SENSOR TAP
- TB/O TABLE - OVERBED
- TP/HS TELEPHONE - HANDSET, STANDARD
- TV TELEVISION

- V1 VINYL FLOORING, STANDARD SLIP RESISTANT
- V6 VINYL FLOORING, NON SLIP - TEXTURED
- WBC/20 WASTE BIN - CLINICAL, 20 LITRE
- WBG WASTE BIN - GENERAL
- WPF WALL PAINT FINISH
- WPP WALL PROTECTION PANEL

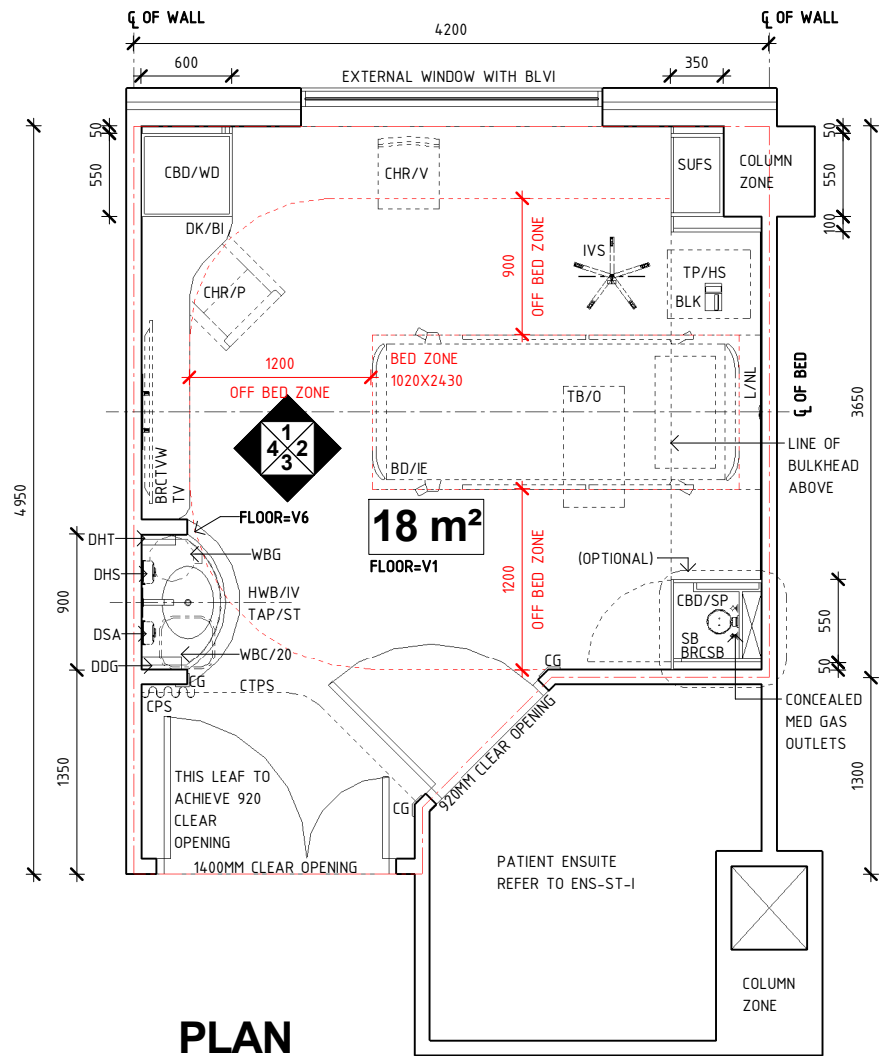

PLAN

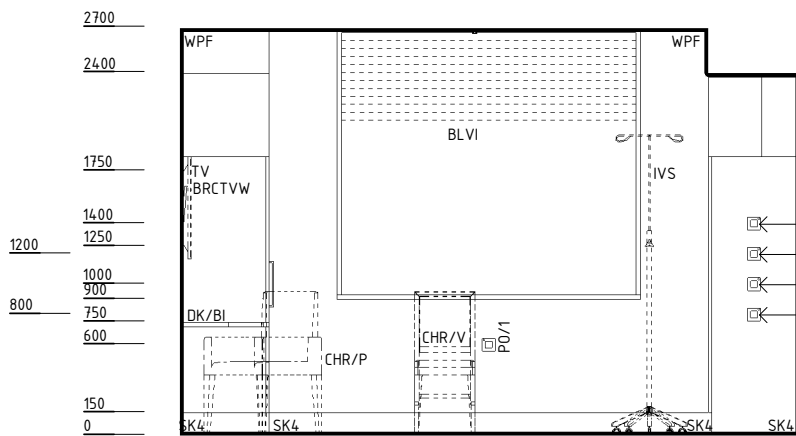

ELEVATION 1

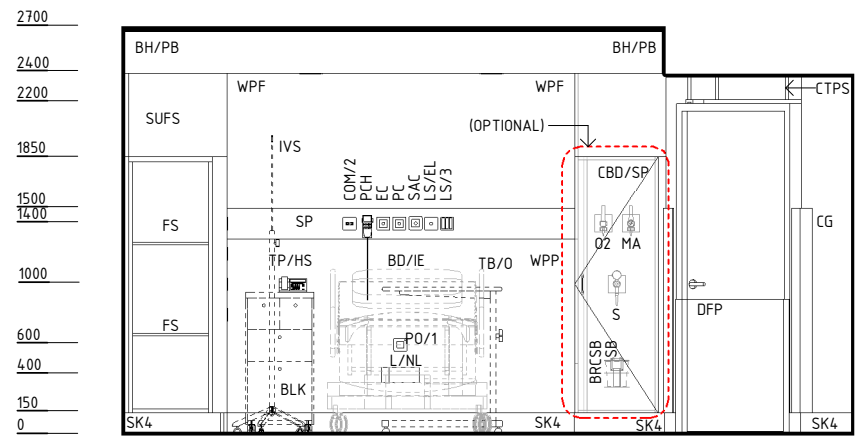

ELEVATION 2

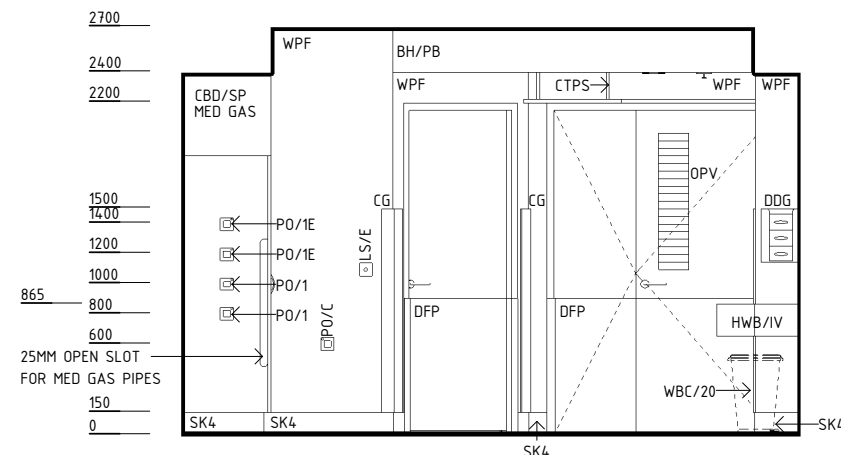

ELEVATION 3

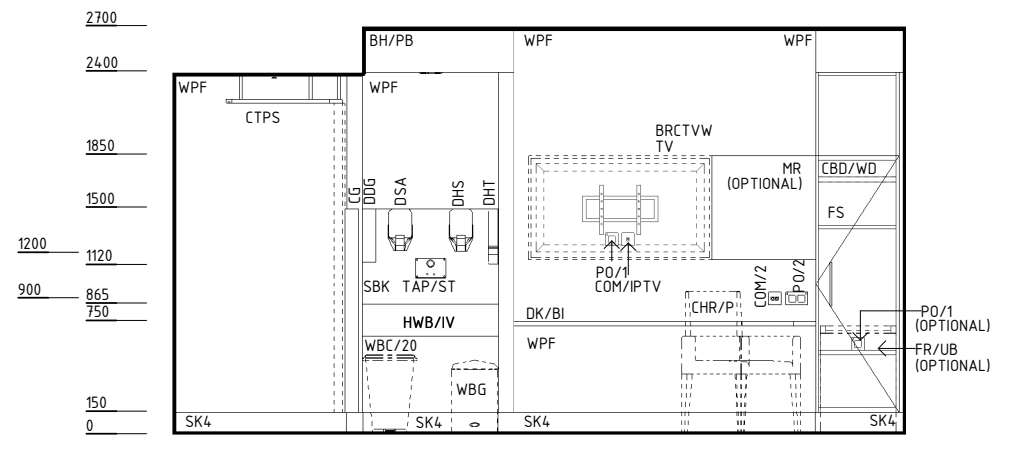

ELEVATION 4

REV	DESCRIPTION	DATE	BY	REV	DESCRIPTION	DATE	BY	COMPATIBILITY
1	FIRST ISSUE	24.10.10	LL	4	GENERAL REVISION	15.03.22	TJ	iHFG
2	GENERAL REVISION	30.08.11	ASD	5	GENERAL REVISION	15.03.22	ES	
3	GENERAL REVISION	31.10.12	CT					



International Health Facility Guidelines at:
www.healthdesign.com.au/iHFG
 Editable version of Standard Components on
 Health Facility Briefing System (HFBS) at:
www.healthdesign.com.au ©TAHPI



DESIGNED	APPROVED	DATE	SCALE(S)	SHEET
ES	CC	15.03.22	1 : 50	1 OF 3
REVIT FILE NAME	PAPER DRAWING ID	ISSUE		
1br-st-18-i	1br-st-18-i-1	5		

This document is for advisory purpose only

iHFG Standard Components

Room Layout Sheet

RLS Room Code

1br-st-18-i

RDS Room Code

1br-st-18-i

Room Name | **1 Bed Room - Standard, 18m2, Alternative Option**

GENERAL NOTES:

THIS DRAWING TO BE READ IN CONJUNCTION WITH R.D.S. (ROOM DATA SHEETS) WHICH TAKES PRECEDENCE.

ALL SERVICES INDICATED ARE INDICATIVE AND SUBJECT TO DETAILED PROJECT SPECIFIC ENGINEERING DESIGN.

CEILING LEGEND:

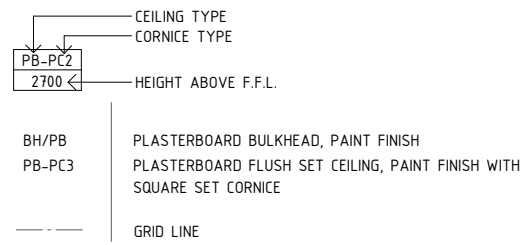

ELECTRICAL LEGEND:

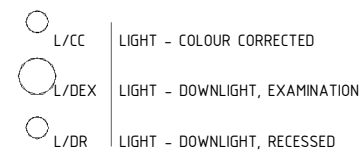

MECHANICAL LEGEND:

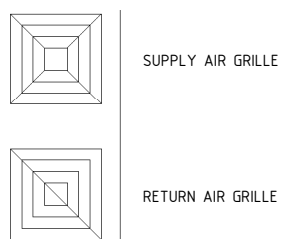

FIRE SERVICES LEGEND:

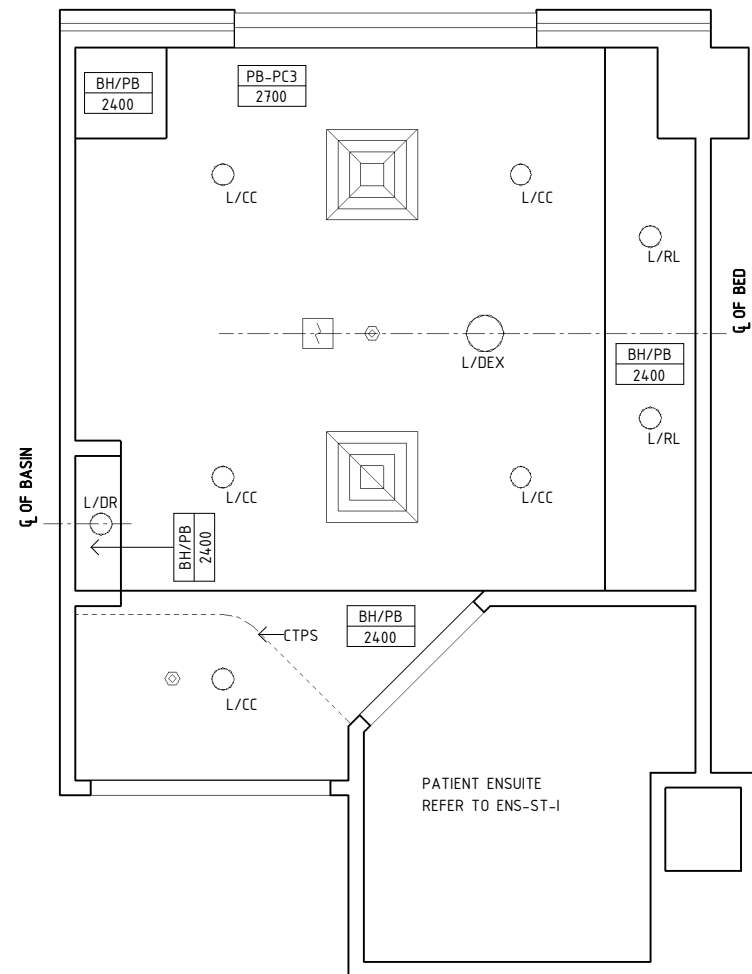
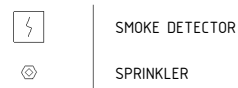

REFLECTED CEILING PLAN

REV	DESCRIPTION	DATE	BY	REV	DESCRIPTION	DATE	BY	COMPATIBILITY																						
1	FIRST ISSUE	24.10.10	LL	4	GENERAL REVISION	15.03.22	TJ	iHFG																						
2	GENERAL REVISION	30.08.11	ASD	5	GENERAL REVISION	15.03.22	ES																							
3	GENERAL REVISION	31.10.12	CT																											
<table border="1"> <thead> <tr> <th>DESIGNED</th> <th>APPROVED</th> <th>DATE</th> <th>SCALE(S)</th> <th>SHEET</th> </tr> </thead> <tbody> <tr> <td>ES</td> <td>CC</td> <td>15.03.22</td> <td>1 : 50</td> <td>2 OF 3</td> </tr> <tr> <td colspan="2"> <table border="1"> <thead> <tr> <th>REVIT FILE NAME</th> <th>PAPER DRAWING ID</th> <th>ISSUE</th> </tr> </thead> <tbody> <tr> <td>1br-st-18-i</td> <td>1br-st-18-i-2</td> <td>5</td> </tr> </tbody> </table> </td> <td colspan="2"></td> <td></td> </tr> </tbody> </table>								DESIGNED	APPROVED	DATE	SCALE(S)	SHEET	ES	CC	15.03.22	1 : 50	2 OF 3	<table border="1"> <thead> <tr> <th>REVIT FILE NAME</th> <th>PAPER DRAWING ID</th> <th>ISSUE</th> </tr> </thead> <tbody> <tr> <td>1br-st-18-i</td> <td>1br-st-18-i-2</td> <td>5</td> </tr> </tbody> </table>		REVIT FILE NAME	PAPER DRAWING ID	ISSUE	1br-st-18-i	1br-st-18-i-2	5				<p>International Health Facility Guidelines at: www.healthdesign.com.au/iHFG Editable version of Standard Components on Health Facility Briefing System (HFBS) at: www.healthdesign.com.au @TAHPI</p>	
DESIGNED	APPROVED	DATE	SCALE(S)	SHEET																										
ES	CC	15.03.22	1 : 50	2 OF 3																										
<table border="1"> <thead> <tr> <th>REVIT FILE NAME</th> <th>PAPER DRAWING ID</th> <th>ISSUE</th> </tr> </thead> <tbody> <tr> <td>1br-st-18-i</td> <td>1br-st-18-i-2</td> <td>5</td> </tr> </tbody> </table>		REVIT FILE NAME	PAPER DRAWING ID	ISSUE	1br-st-18-i	1br-st-18-i-2	5																							
REVIT FILE NAME	PAPER DRAWING ID	ISSUE																												
1br-st-18-i	1br-st-18-i-2	5																												

iHFG Standard Components

Room Layout Sheet

Room Name | 1 Bed Room - Standard, 18m2, Alternative Option

RLS Room Code

1br-st-18-i

RDS Room Code

1br-st-18-i

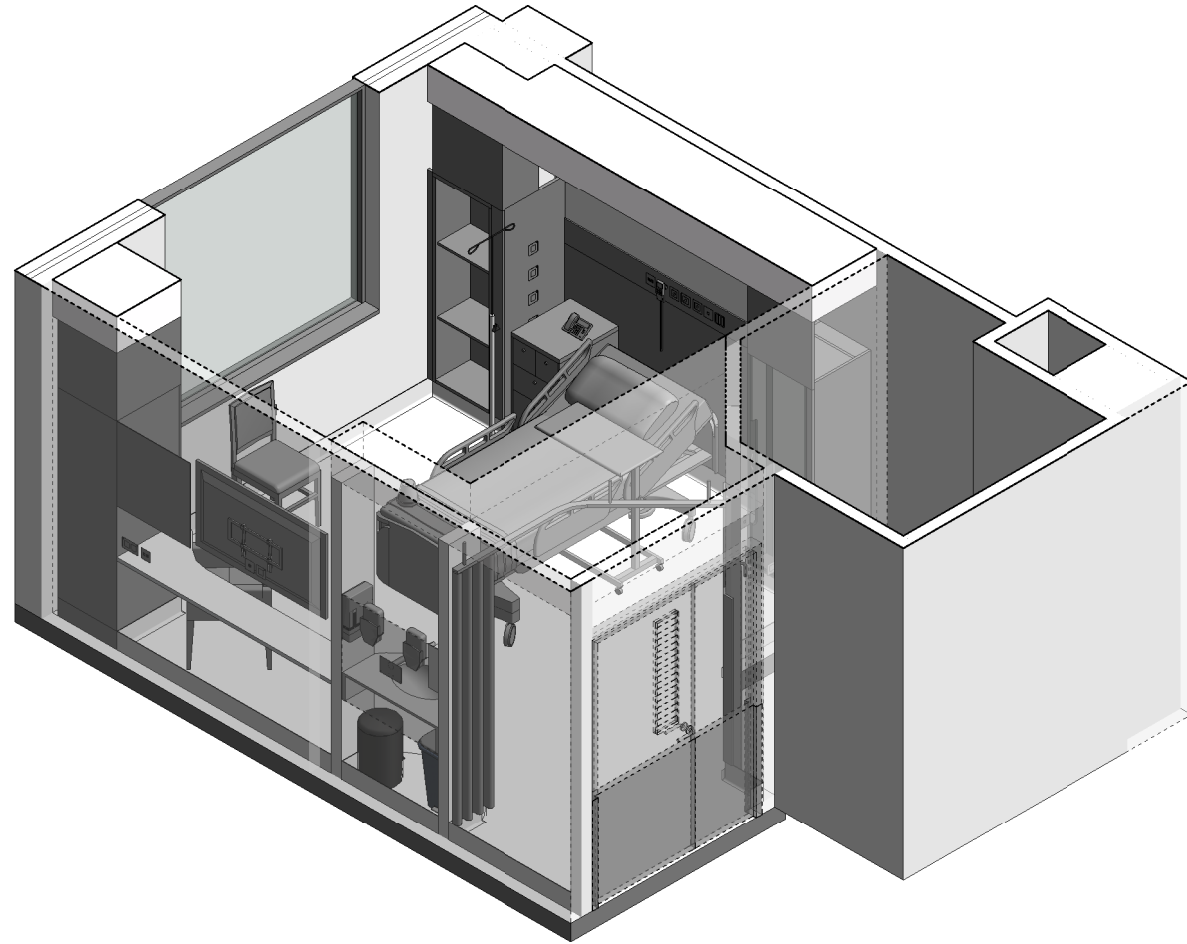

ISOMETRIC VIEW 01

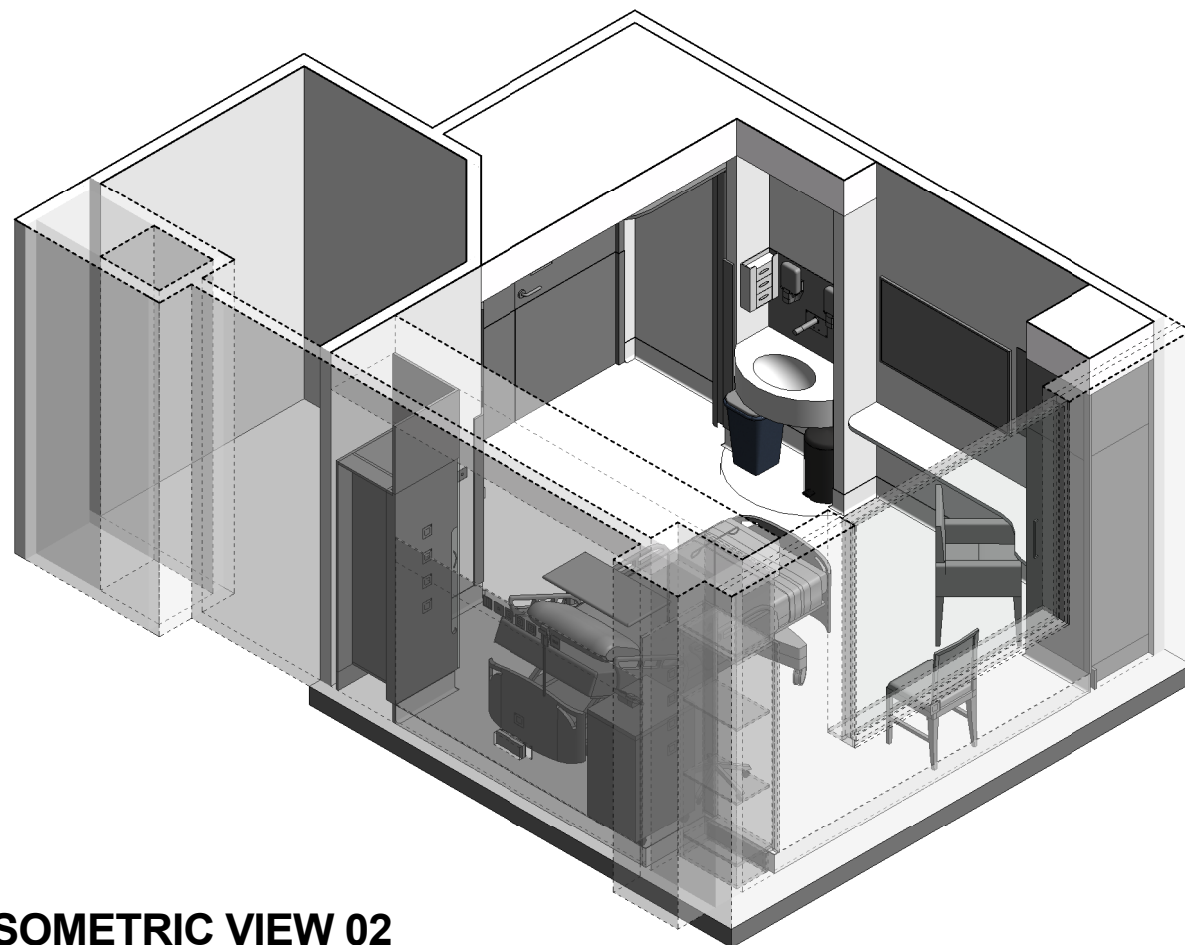

ISOMETRIC VIEW 02

REV	DESCRIPTION	DATE	BY	REV	DESCRIPTION	DATE	BY	COMPATIBILITY
1	FIRST ISSUE	24.10.10	LL	4	GENERAL REVISION	15.03.22	TJ	iHFG
2	GENERAL REVISION	30.08.11	ASD	5	GENERAL REVISION	15.03.22	ES	
3	GENERAL REVISION	31.10.12	CT					

DESIGNED	APPROVED	DATE	SCALE(S)	SHEET
ES	CC	15.03.22		3 OF 3
REVIT FILE NAME		PAPER DRAWING ID		ISSUE
1br-st-18-i		1br-st-18-i-3		5

iHFG International Health Facility Guidelines

International Health Facility Guidelines at:
www.healthdesign.com.au/iHFG
 Editable version of Standard Components on
 Health Facility Briefing System (HFBS) at:
www.healthdesign.com.au @TAHPI



This document is for advisory purpose only