

iHFG Standard Components

Room Layout Sheet

RLS Room Code

adln-i

RDS Room Code

adln-i

Room Name **ADL Lounge**

AW	ARTWORK
BKC	BOOKCASE
COM/2	COMMUNICATION OUTLET - DOUBLE
COM/IPTV	COMMUNICATION OUTLET - INTERNET PROTOCOL TELEVISION
CPT	CARPET
CRZ	CREDENZA
CTW	CURTAIN TRACK - WINDOW
CWIN	CURTAIN - WINDOW
EC	EMERGENCY CALL
LO/1	LOUNGE - 1 SEAT
LO/2	LOUNGE - 2 SEAT
PO/1	POWER OUTLET - SINGLE
SK7	TIMBER SKIRTING
TB/L	TABLE - LOW
TP/HS	TELEPHONE - HANDSET, STANDARD
TV	TELEVISION
WCH	WHEELCHAIR
WP/L	WALL PANEL, LAMINATE
WPF	WALL PAINT FINISH

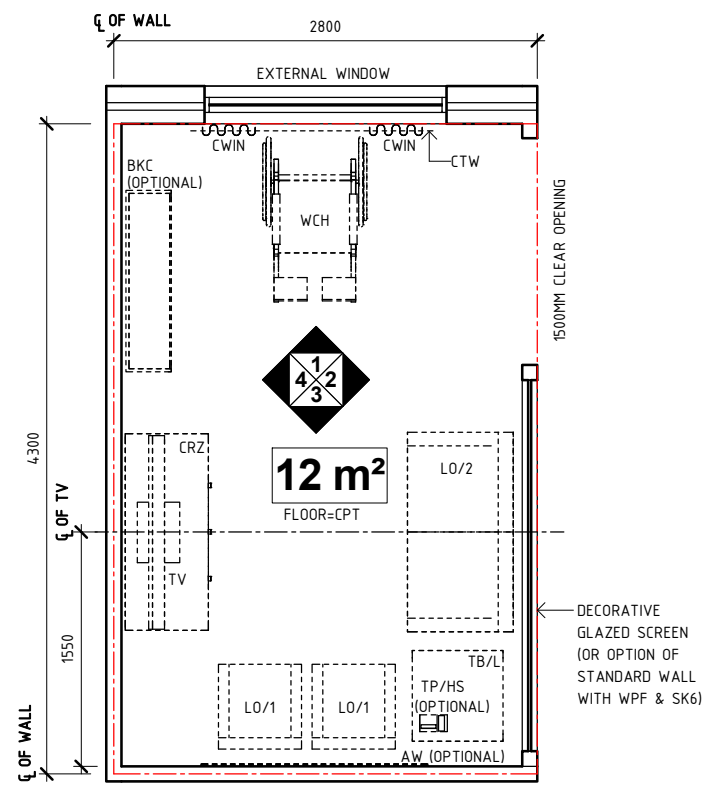

PLAN

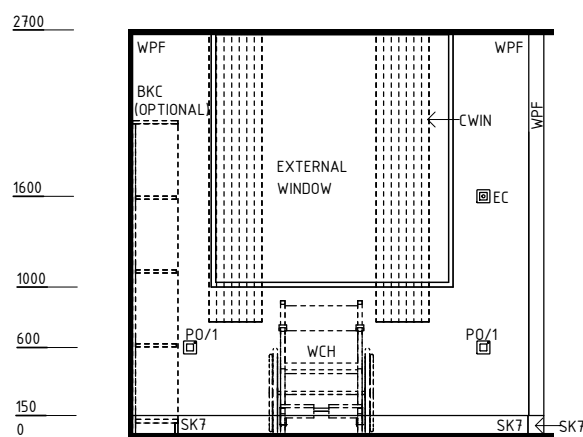

ELEVATION 1

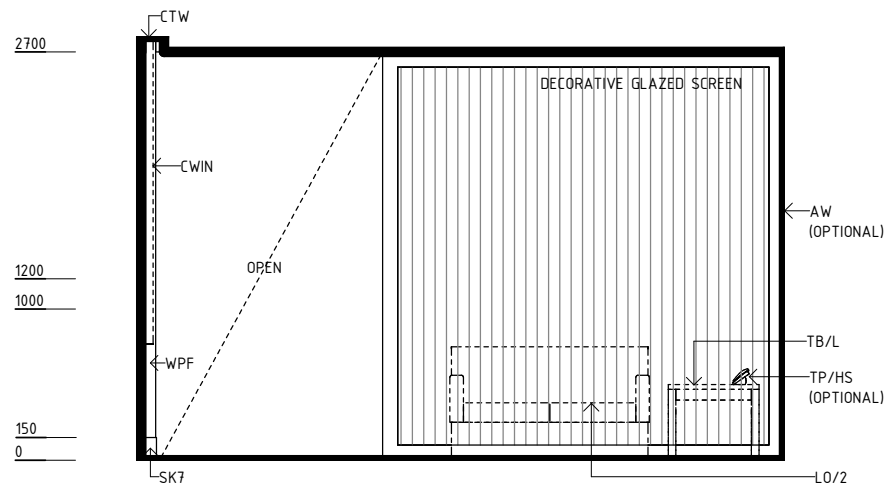

ELEVATION 2

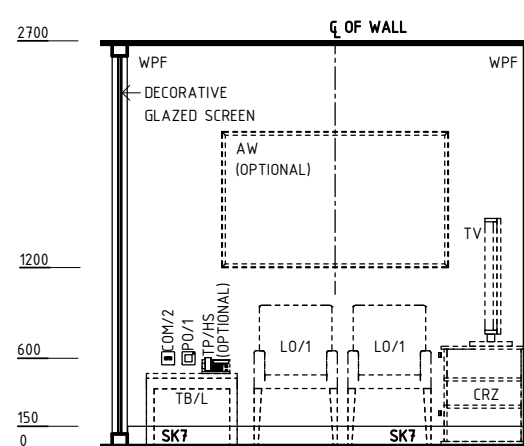

ELEVATION 3

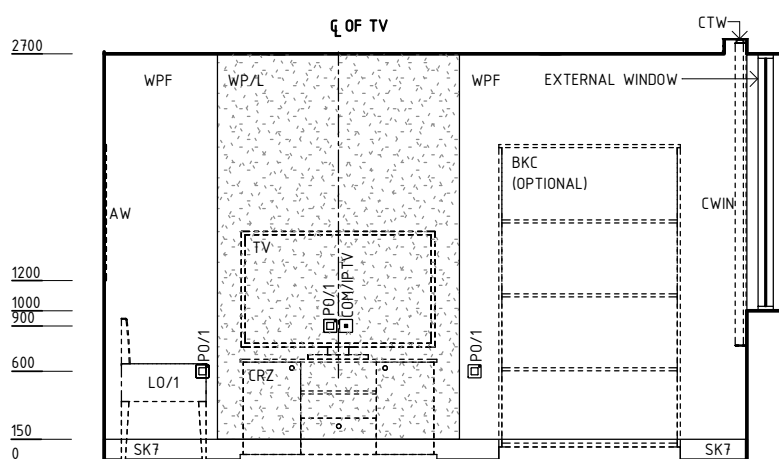

ELEVATION 4

REV	DESCRIPTION	DATE	BY	REV	DESCRIPTION	DATE	BY	COMPATIBILITY																					
1	FIRST ISSUE	24.10.10	LL	4	GENERAL REVISION	27.01.23	AK																						
2	GENERAL REVISION	30.08.11	SK																										
3	GENERAL REVISION	31.10.12	CT																										
International Health Facility Guidelines International Health Facility Guidelines at: www.healthdesign.com.au/iHFG Editable version of Standard Components on Health Facility Briefing System (HFBS) at: www.healthdesign.com.au ©TAHPI									<table border="1"> <tr> <th>DESIGNED</th> <th>APPROVED</th> <th>DATE</th> <th>SCALE(S)</th> <th>SHEET</th> </tr> <tr> <td>AK</td> <td>SA</td> <td>27.01.23</td> <td>1 : 50</td> <td>1 OF 2</td> </tr> <tr> <th colspan="2">REVIT FILE NAME</th> <th colspan="2">PAPER DRAWING ID</th> <th>ISSUE</th> </tr> <tr> <td colspan="2">adln-i</td> <td colspan="2">adln-i-1</td> <td>4</td> </tr> </table>	DESIGNED	APPROVED	DATE	SCALE(S)	SHEET	AK	SA	27.01.23	1 : 50	1 OF 2	REVIT FILE NAME		PAPER DRAWING ID		ISSUE	adln-i		adln-i-1		4
DESIGNED	APPROVED	DATE	SCALE(S)	SHEET																									
AK	SA	27.01.23	1 : 50	1 OF 2																									
REVIT FILE NAME		PAPER DRAWING ID		ISSUE																									
adln-i		adln-i-1		4																									

iHFG Standard Components

Room Layout Sheet

RLS Room Code

adIn-i

RDS Room Code

adIn-i

Room Name | **ADL Lounge**

GENERAL NOTES:

THIS DRAWING TO BE READ IN CONJUNCTION WITH R.D.S. (ROOM DATA SHEETS) WHICH TAKES PRECEDENCE.

ALL SERVICES INDICATED ARE INDICATIVE AND SUBJECT TO DETAILED PROJECT SPECIFIC ENGINEERING DESIGN.

CEILING LEGEND:



ELECTRICAL LEGEND:



MECHANICAL LEGEND:



FIRE SERVICES LEGEND:

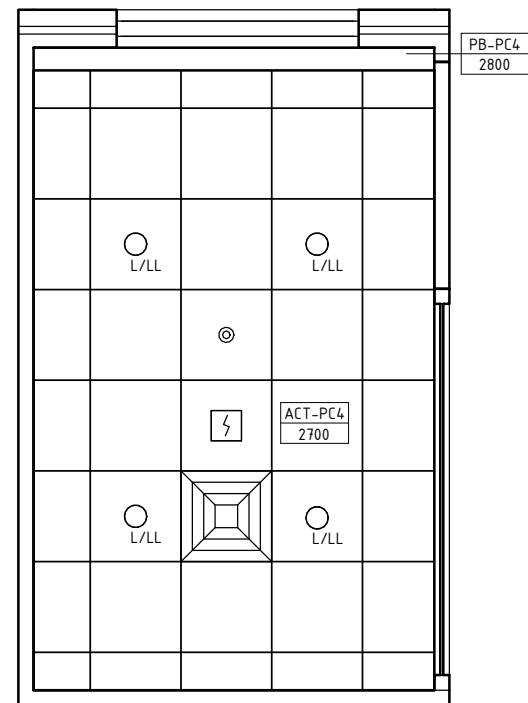

REFLECTED CEILING PLAN

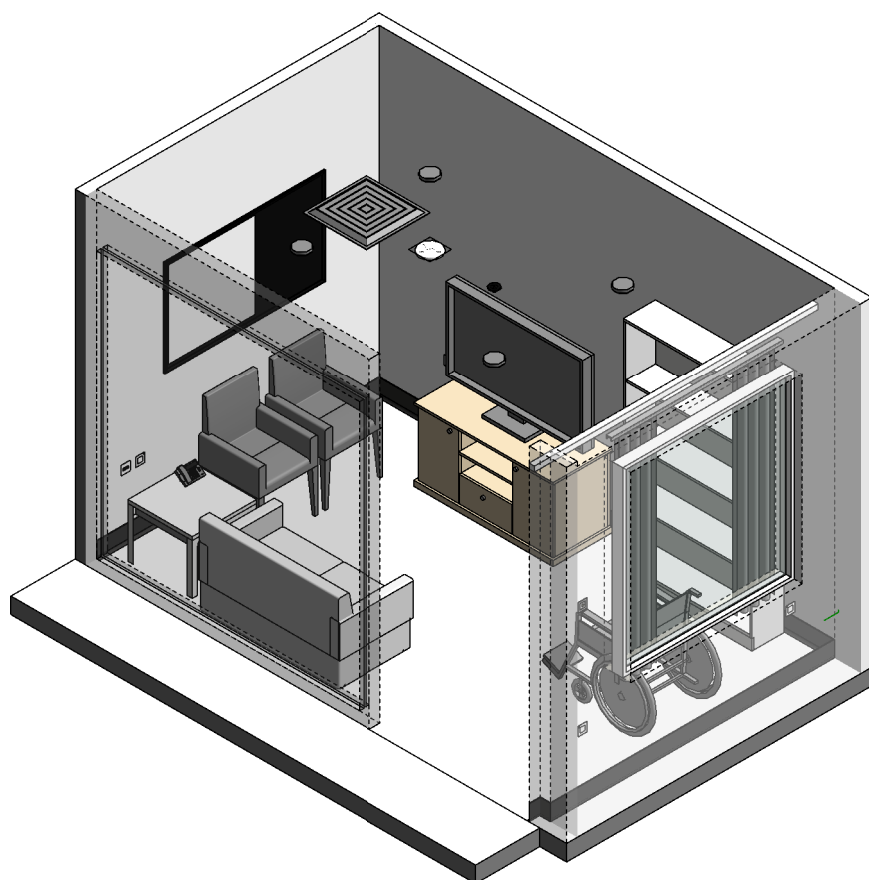

ISOMETRIC VIEW 1

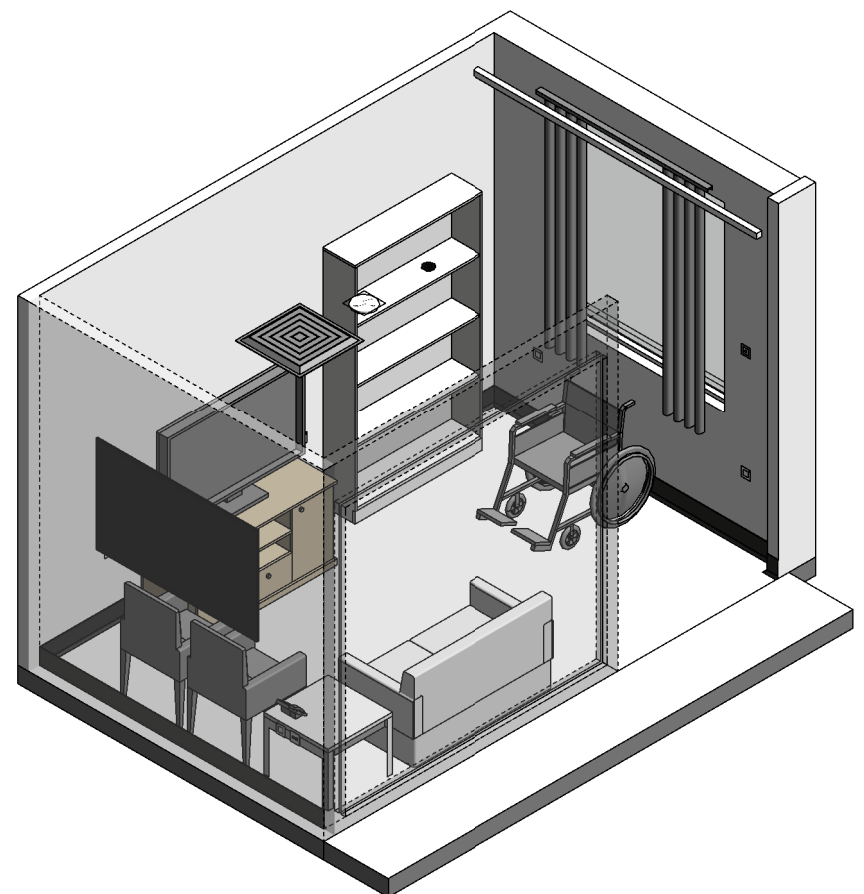

ISOMETRIC VIEW 2

REV	DESCRIPTION	DATE	BY	REV	DESCRIPTION	DATE	BY	COMPATIBILITY																				
1	FIRST ISSUE	24.10.10	LL	4	GENERAL REVISION	27.01.23	AK	iHFG																				
2	GENERAL REVISION	30.08.11	SK																									
3	GENERAL REVISION	31.10.12	CT																									
<table border="1"> <thead> <tr> <th>DESIGNED</th> <th>APPROVED</th> <th>DATE</th> <th>SCALE(S)</th> <th>SHEET</th> </tr> </thead> <tbody> <tr> <td>AK</td> <td>SA</td> <td>27.01.23</td> <td>1 : 50</td> <td>2 OF 2</td> </tr> <tr> <td colspan="2">REVIT FILE NAME</td> <td colspan="2">PAPER DRAWING ID</td> <td>ISSUE</td> </tr> <tr> <td colspan="2">adIn-i</td> <td colspan="2">adIn-i-2</td> <td>4</td> </tr> </tbody> </table>								DESIGNED	APPROVED	DATE	SCALE(S)	SHEET	AK	SA	27.01.23	1 : 50	2 OF 2	REVIT FILE NAME		PAPER DRAWING ID		ISSUE	adIn-i		adIn-i-2		4	
DESIGNED	APPROVED	DATE	SCALE(S)	SHEET																								
AK	SA	27.01.23	1 : 50	2 OF 2																								
REVIT FILE NAME		PAPER DRAWING ID		ISSUE																								
adIn-i		adIn-i-2		4																								