

# iHFG Standard Components

## Room Layout Sheet

RLS Room Code

ahdr-4-i

RDS Room Code

ahdr-4-i

Room Name **After Hours Drug Store, 4m<sup>2</sup>**

BH/PB	BULKHEAD - PLASTERBOARD, PAINT FINISH
BNL	BENCH - LAMINATE
CBD/PM	CUPBOARD - PHARMACY MANAGEMENT SYSTEM, LOCKABLE
CBD/UBL	CUPBOARD - UNDER BENCH, LOCKABLE
COM/1	COMMUNICATION OUTLET - SINGLE
COM/2	COMMUNICATION OUTLET - DOUBLE
CSA	CARD ACCESS
DA	DURESS ALARM
FR/DRS	FRIDGE - DRUG, SMALL
L/PT	LIGHT - PELMET TASK LIGHT
LS/P	LIGHT SWITCH - PELMET TASK LIGHT
LS/R	LIGHT SWITCH - ROOM
PO/2	POWER OUTLET - DOUBLE
PO/2E	POWER OUTLET - EMERGENCY, DOUBLE
RDR	REMOTE DOOR RELEASE BUTTON
SK4	FLOOR VINYL COVED SKIRTING
SUOA	SHELVING UNIT - OVER BENCH, ADJUSTABLE
TMP	TEMPERATURE MONITOR ALARM PANEL
V1	VINYL FLOORING, STANDARD SLIP RESISTANT
WBG/20	WASTE BIN - GENERAL, 20 LITRE
WPF	WALL PAINT FINISH

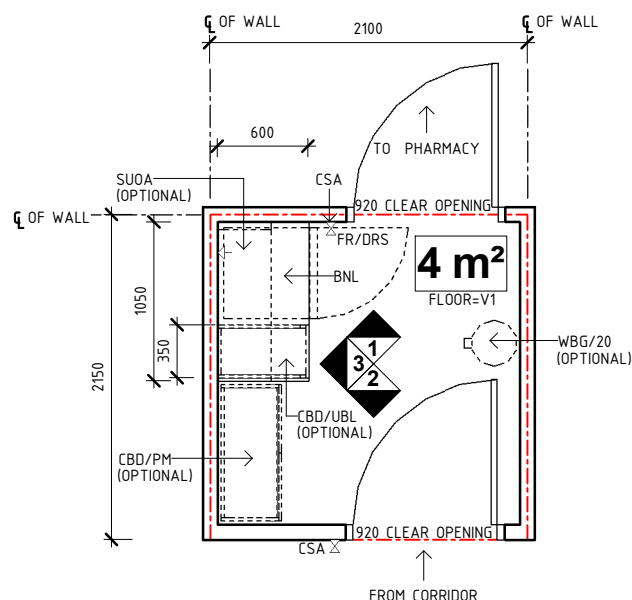

**PLAN**

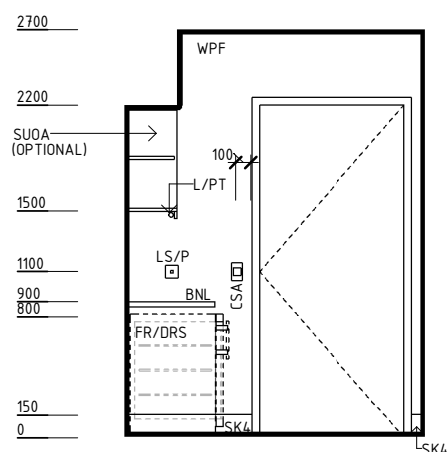

**ELEVATION 1**

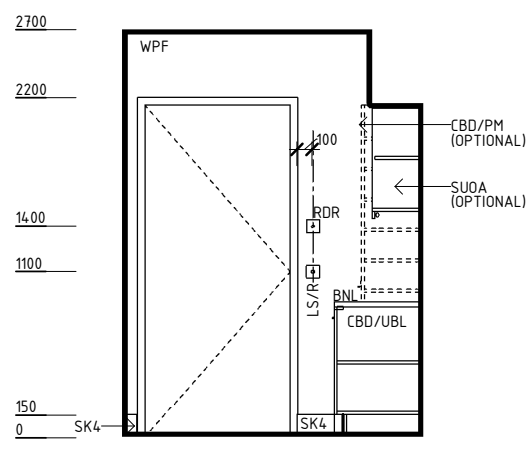

**ELEVATION 2**

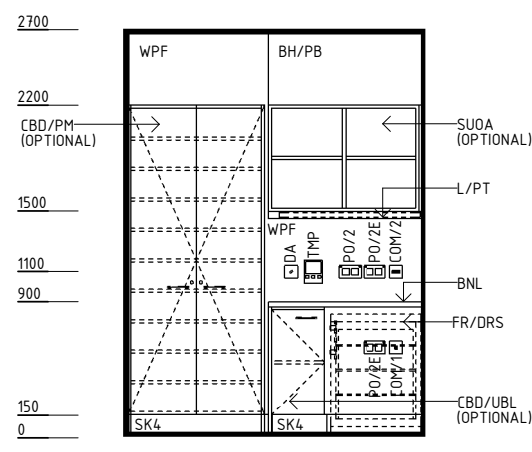

**ELEVATION 3**

REV	DESCRIPTION	DATE	BY	REV	DESCRIPTION	DATE	BY	COMPATIBILITY
1	FIRST ISSUE	19.10.15	NB					
2	GENERAL REVISION	30.12.22	RA					

# iHFG Standard Components

## Room Layout Sheet

RLS Room Code

ahdr-4-i

RDS Room Code

ahdr-4-i

Room Name | **After Hours Drug Store, 4m<sup>2</sup>**

### GENERAL NOTES:

THIS DRAWING TO BE READ IN CONJUNCTION WITH R.D.S. (ROOM DATA SHEETS) WHICH TAKES PRECEDENCE.

ALL SERVICES INDICATED ARE INDICATIVE AND SUBJECTED TO DETAILED PROJECT SPECIFIC ENGINEERING DESIGN.

### CEILING LEGEND:

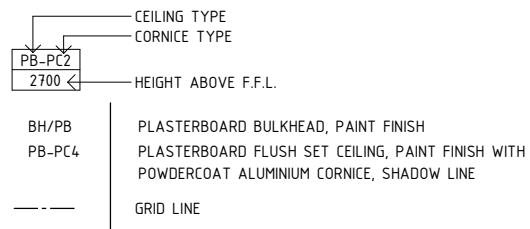

### ELECTRICAL LEGEND:

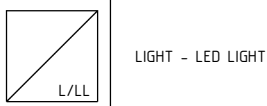

### MECHANICAL LEGEND:

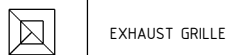

### FIRE SERVICES LEGEND:

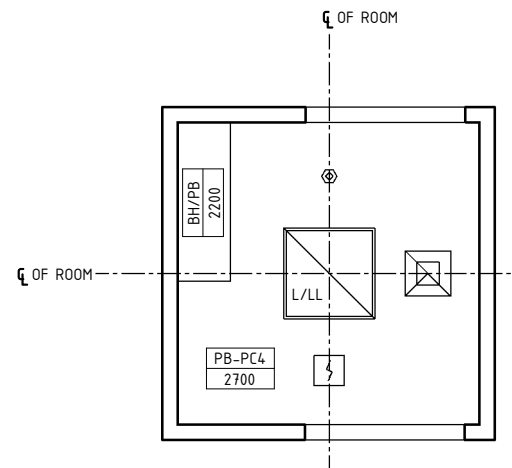
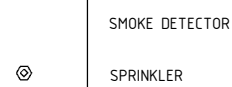

**REFLECTED CEILING PLAN**

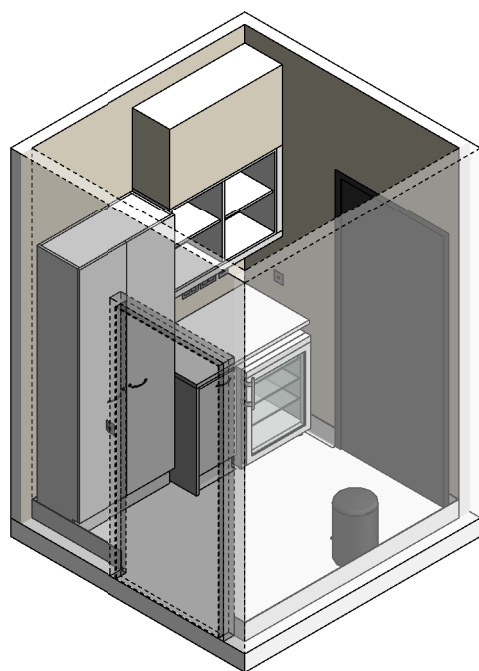

**ISOMETRIC VIEW 01**

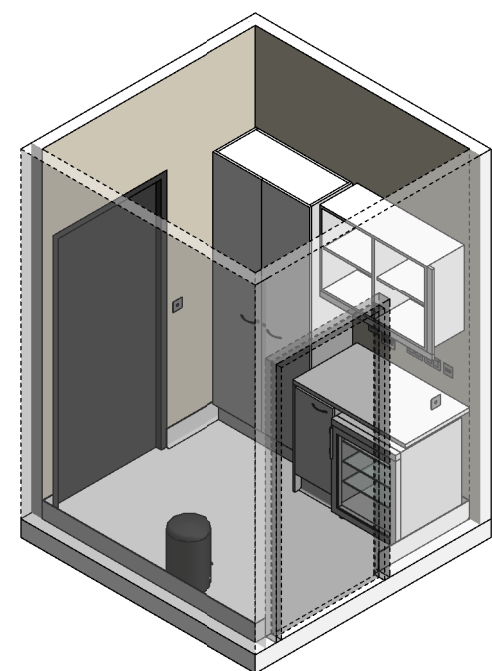

**ISOMETRIC VIEW 02**

REV	DESCRIPTION	DATE	BY	REV	DESCRIPTION	DATE	BY	COMPATIBILITY
1	FIRST ISSUE	19.10.15	NB					iHFG
2	GENERAL REVISION	30.12.22	RA					

DESIGNED	APPROVED	DATE	SCALE(S)	SHEET
RA	RH	30.12.22	1 : 50	2 OF 2
REVIT FILE NAME		PAPER DRAWING ID		ISSUE
ahdr-4-i		ahdr-4-i-2		2

This document is for advisory purpose only