

iHFG Standard Components

Room Layout Sheet

Room Name **After Hours Drug Store, 4m²**

RLS Room Code **AHDR-4-I**

RDS Room Code **AHDR-4-I**

Abbreviations

BNT	BENCHTOP
CBD/PM	CUPBOARD: PHARMACY MANAGEMENT, LOCKABLE
COM/2	COMMUNICATION OUTLET - DOUBLE
CRA	CARD ACCESS
DAL	DURESS ALARM
FCBD	FLOOR CUPBOARD WITH ADJUSTABLE SHELVES, LOCKABLE
FR/DR	FRIDGE: DRUG
GPO/1EP	EMERGENCY POWER OUTLET - SINGLE
GPO/2	GENERAL POWER OUTLET - DOUBLE
LS/R	LIGHT SWITCH - ROOM
TMA	TEMPERATURE MONITOR & ALARM
WBP	WASTE BIN, PAPER
WSHU	WALL SHELVING UNIT WITH ADJUSTABLE SHELVES
PBB	PLASTERBOARD BULKHEAD, PAINT FINISH
SK4	FLOOR VINYL COVERED SKIRTING
WPF	WALL PAINT FINISH
V1	VINYL FLOORING, STANDARD SLIP RESISTANT

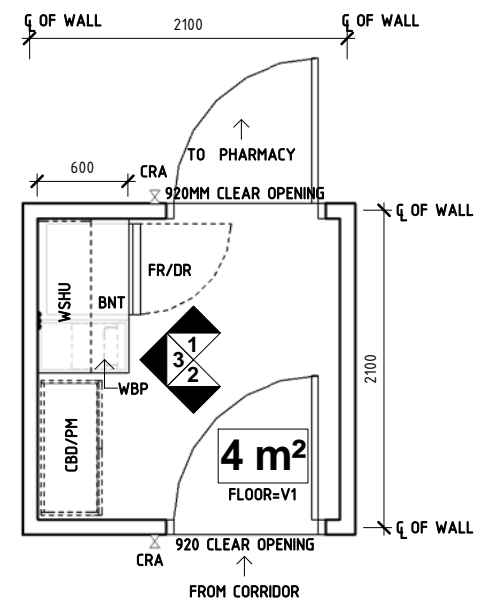

PLAN

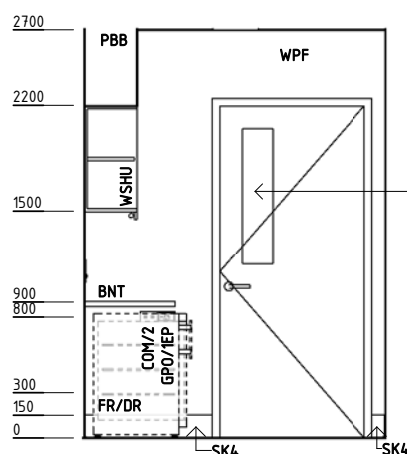

ELEVATION 1

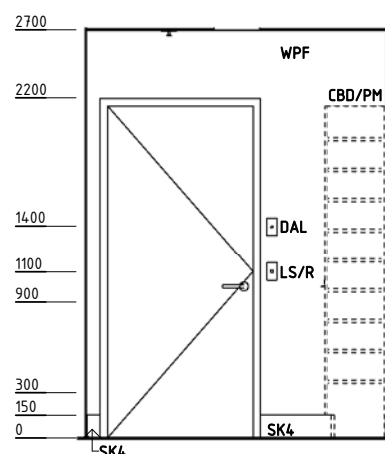

ELEVATION 2

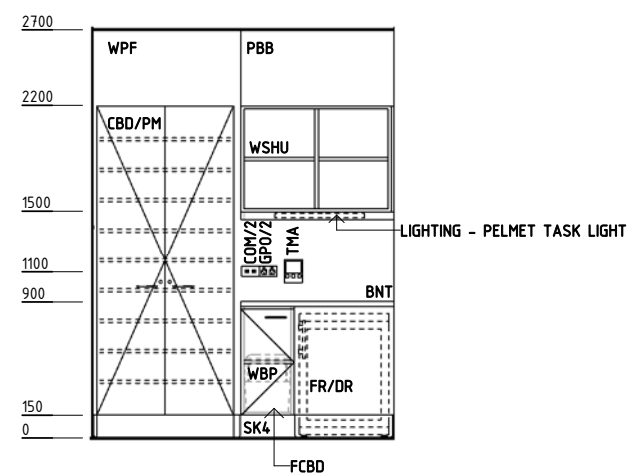

ELEVATION 3

REV	DESCRIPTION	DATE	BY	REV	DESCRIPTION	DATE	BY	REV	DESCRIPTION	DATE	BY
1	FIRST ISSUE #	19.10.2015	NB								

iHFG Standard Components

Room Layout Sheet

Room Name | After Hours Drug Store, 4m²

RLS Room Code AHDR-4-I
RDS Room Code AHDR-4-I

GENERAL NOTES:

THIS DRAWING TO BE READ IN CONJUNCTION WITH R.D.S.
(ROOM DATA SHEETS) WHICH TAKES PRECEDENCE.

ALL SERVICES INDICATED ARE INDICATIVE AND SUBJECTED TO
DETAILED PROJECT SPECIFIC ENGINEERING DESIGN.

CEILING LEGEND:

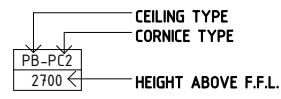

PB-PC4 PLASTERBOARD FLUSH SET CEILING, PAINT FINISH WITH
POWDERCOAT ALUMINIUM CORNICE, SHADOW LINE
PBB PLASTERBOARD BULKHEAD, PAINT FINISH

ELECTRICAL LEGEND:

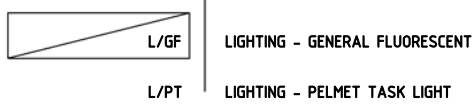

FIRE SERVICES LEGEND:

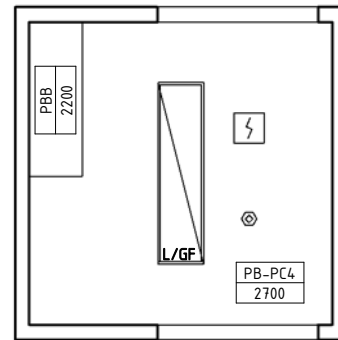

REFLECTED CEILING PLAN

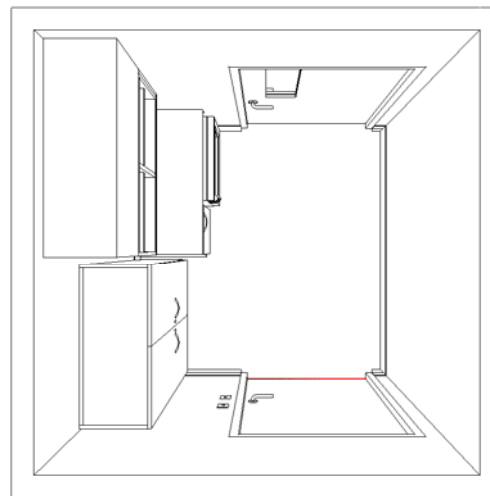

PERSPECTIVE - PLAN VIEW

REV	DESCRIPTION	DATE	BY	REV	DESCRIPTION	DATE	BY	REV	DESCRIPTION	DATE	BY
1	FIRST ISSUE #	19.10.2015	NB								

iHFG Standard Components

Room Layout Sheet

Room Name | After Hours Drug Store, 4m²

RLS Room Code AHDR-4-I
RDS Room Code AHDR-4-I

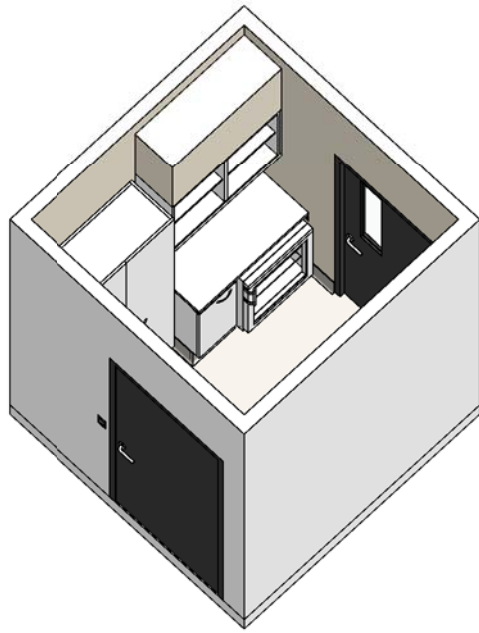

ISOMETRIC VIEW 01

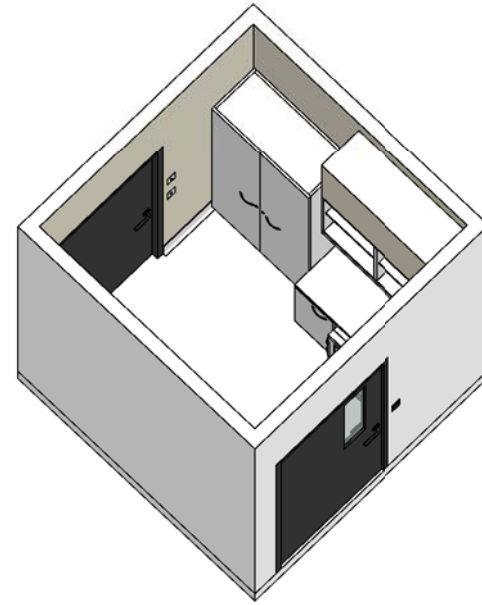

ISOMETRIC VIEW 02



PERSPECTIVE 01

REV	DESCRIPTION	DATE	BY	REV	DESCRIPTION	DATE	BY	REV	DESCRIPTION	DATE	BY
1	FIRST ISSUE #	19.10.2015	NB								



The International Health Facility Guidelines recommends the use of HFBS “Health Facility Briefing System” to edit all room data sheet information for your project.

HFBS provides edit access to all iHFG standard rooms, and departments, and more than 100 custom report templates.

HFBS Health Facility Briefing System



Briefing Module

The Health Facility Briefing System (HFBS) has numerous modules available via annual subscription. It suits healthcare Architects, Medical Planners, Equipment Planners Project Managers and Health Authorities.

Use the HFBS Briefing Module to quickly drag in health facility departments or pre-configured room templates from the iHFG standard, edit the room features such as finishes, furniture, fittings, fixtures, medical equipment, engineering services. The system can print or download as PDF more than 100 custom reports including room data sheets, schedules, and more...

To learn more about the HFBS web-based Healthcare Briefing and Design Software and to obtain editable versions of the “Standard Components” including Room Data Sheets (RDS) and Room Layout Sheets (RLS) offered on the iHFG website, signup for HFBS using the link below.

Get Started Now:
hfbs.healthdesign.com.au

- ✓ iHFG Room Data Sheets and Departments are instantly editable in the HFBS software available online.
- ✓ You can access hundreds of report templates to print your iHFG room data in HFBS.
- ✓ HFBS has a onetime free 3 day trial available to all new users.

Get Started Now:
hfbs.healthdesign.com.au



HFBS

Health Facility Briefing System

hfbsinfo.com | techsupport@healthdesign.com.au