

# iHFG Standard Components

## Room Layout Sheet

Room Name **Bay - Wheelchair Park, 8m<sup>2</sup>**

RLS Room Code

bwc-8-i

RDS Room Code

bwc-8-i

- CG CORNER GUARD
- CR CRASH RAIL
- L/LL LIGHT - LED LIGHT
- LS/B LIGHT SWITCH - BAY
- PO/2 POWER OUTLET - DOUBLE
- SK4 FLOOR VINYL COVERED SKIRTING
- V1 VINYL FLOORING, STANDARD SLIP RESISTANT
- WCH WHEELCHAIR
- WPF WALL PAINT FINISH

### GENERAL NOTES:

THIS DRAWING TO BE READ IN CONJUNCTION WITH R.D.S. (ROOM DATA SHEETS) WHICH TAKES PRECEDENCE.

ALL SERVICES INDICATED ARE INDICATIVE AND SUBJECT TO DETAILED PROJECT SPECIFIC ENGINEERING DESIGN.

### CEILING LEGEND:

- CEILING TYPE
- CORNICE TYPE
- BP-PC2 2700 ← HEIGHT ABOVE F.F.L.
- PB-PC3 PLASTERBOARD FLUSH SET CEILING, PAINT FINISH WITH PLASTERBOARD SQUARE SET CORNICE
- GRID LINE

### ELECTRICAL LEGEND:

- L/LL LIGHT - LED LIGHT

### FIRE SERVICES LEGEND:

- SMOKE DETECTOR
- SPRINKLER

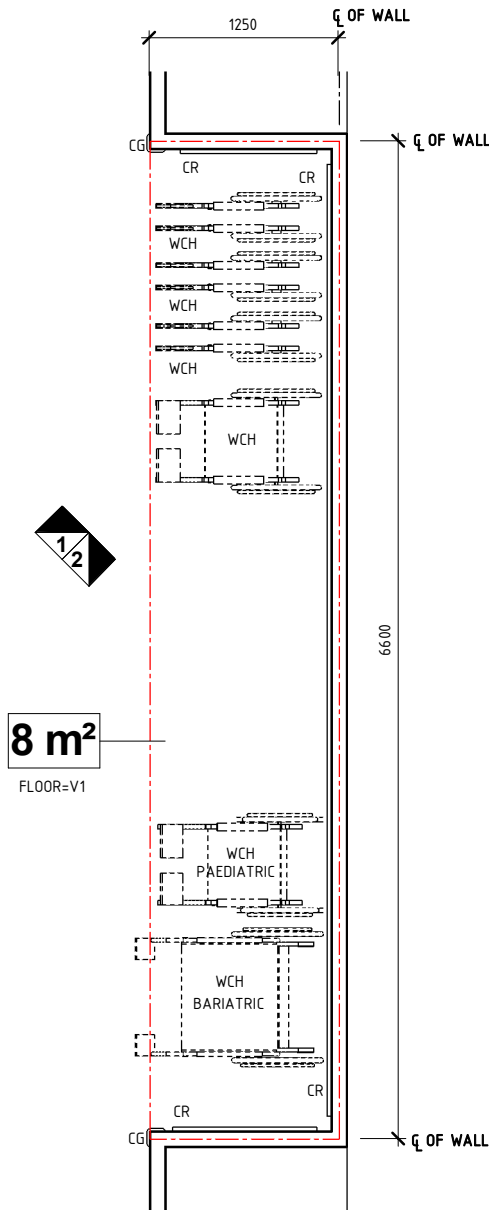

**PLAN**

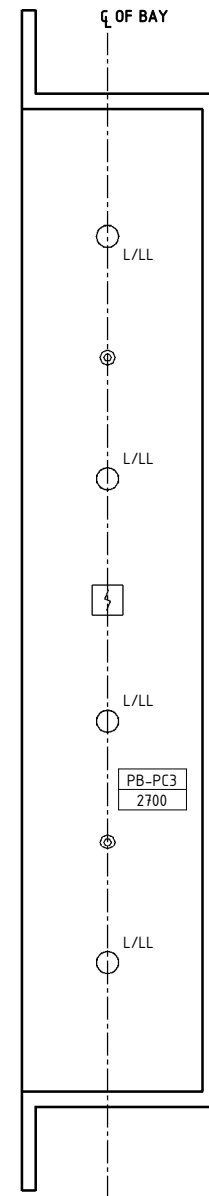

**REFLECTED CEILING PLAN**

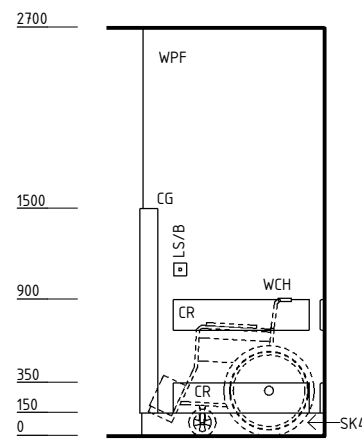

**ELEVATION 1**

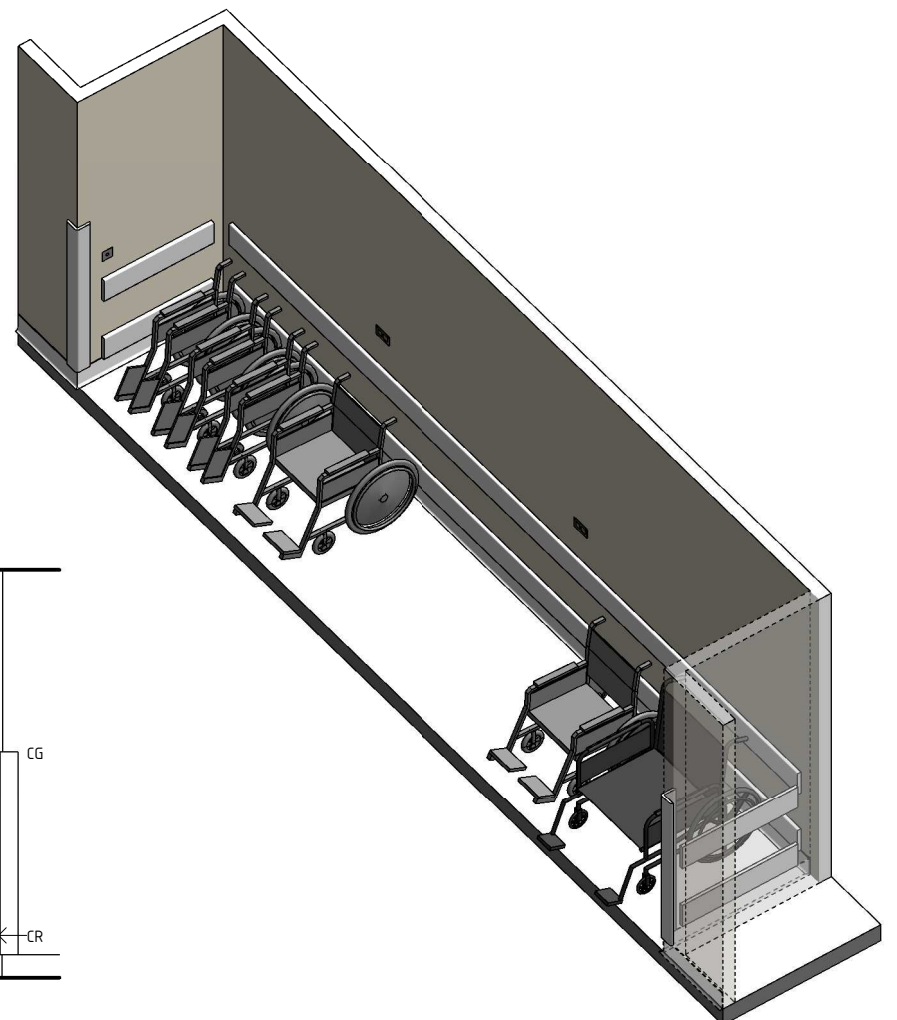

**ISOMETRIC VIEW**

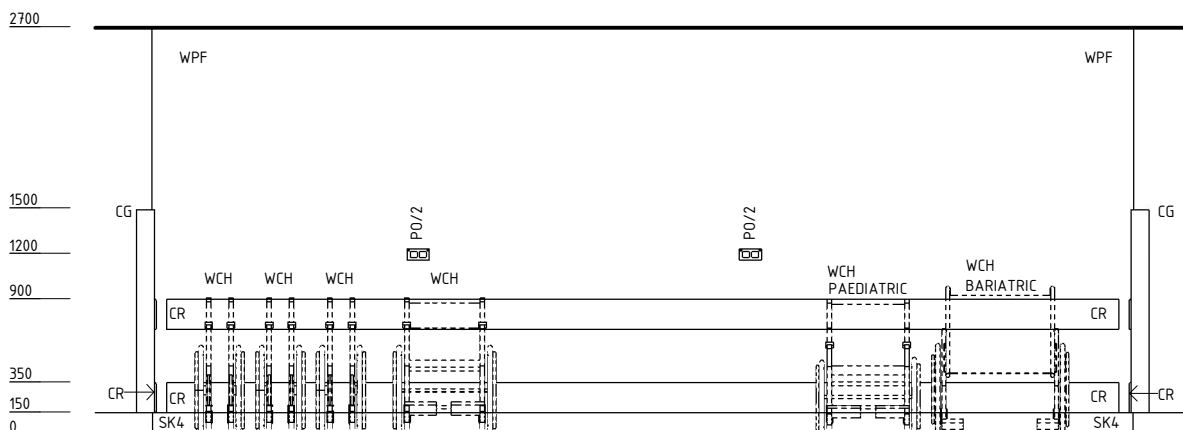

**ELEVATION 2**

REV	DESCRIPTION	DATE	BY	REV	DESCRIPTION	DATE	BY	COMPATIBILITY				
1	FIRST ISSUE	24.10.10	BJ	4	GENERAL REVISION	25.05.23	AM	iHFG				
2	GENERAL REVISION	30.08.11	ASD									
3	GENERAL REVISION	31.10.12	CT									
								DESIGNED	APPROVED	DATE	SCALE(S)	SHEET
								AM	SA	25.05.23	1 : 50	1 OF 1
								REVIT FILE NAME		PAPER DRAWING ID		ISSUE
								bwc-8-i		bwc-8-i-1		4



International Health Facility Guidelines at:  
[www.healthdesign.com.au/iHFG](http://www.healthdesign.com.au/iHFG)  
 Editable version of Standard Components on  
 Health Facility Briefing System (HFBS) at:  
[www.healthdesign.com.au](http://www.healthdesign.com.au) ©TAHPI

