

# iHFG Standard Components

## Room Layout Sheet

RLS Room Code

chst-20-i

RDS Room Code

chst-20-i

Room Name **Change Room - Staff (Male/Female), 20 m<sup>2</sup>**

- BHS BIDET HANDSET
- BNS BENCH SEAT
- C/BO CLOCK - BATTERY OPERATED
- CBT/CS CABINET - COAT/SHOES VALET
- COH COAT HOOK
- CSHR CURTAIN - SHOWER
- CTS CURTAIN TRACK - SHOWER
- DA DURESS ALARM
- DHT DISPENSER - PAPER HAND TOWEL
- DS DISPENSER - SOAP
- DTP DISPENSER - TOILET PAPER
- FW FLOOR WASTE
- HWB/C HAND WASH BASIN - TYPE 'C'
- KP KICKPLATE
- LIND/S LINEN CARRIER - DIRTY, SINGLE
- LK/2 LOCKER - 2 TIER
- MR MIRROR
- PAR/SHR PARTITIONS - SHOWER
- PAR/T PARTITIONS - TOILET
- PO/1S POWER OUTLET - SPECIAL
- S/SHR SOAP/ SHAMPOO HOLDER - RECESSED
- SBK SPLASHBACK
- SHR/1M SHOWER - SINGLE MIXER
- SHV SHELF - VANITY
- SK4 FLOOR VINYL COVERED SKIRTING
- T/CL TROLLEY - CLEAN LINEN
- TAP/M TAPWARE - MIXER
- TP/WM TELEPHONE - WALL MOUNTED
- V1 VINYL FLOORING, STANDARD SLIP RESISTANT
- WBG/20 WASTE BIN - GENERAL, 20 LITRE
- WBS WASTE BIN - SANITARY
- WCS WATER CLOSET - STANDARD
- WPF WALL PAINT FINISH

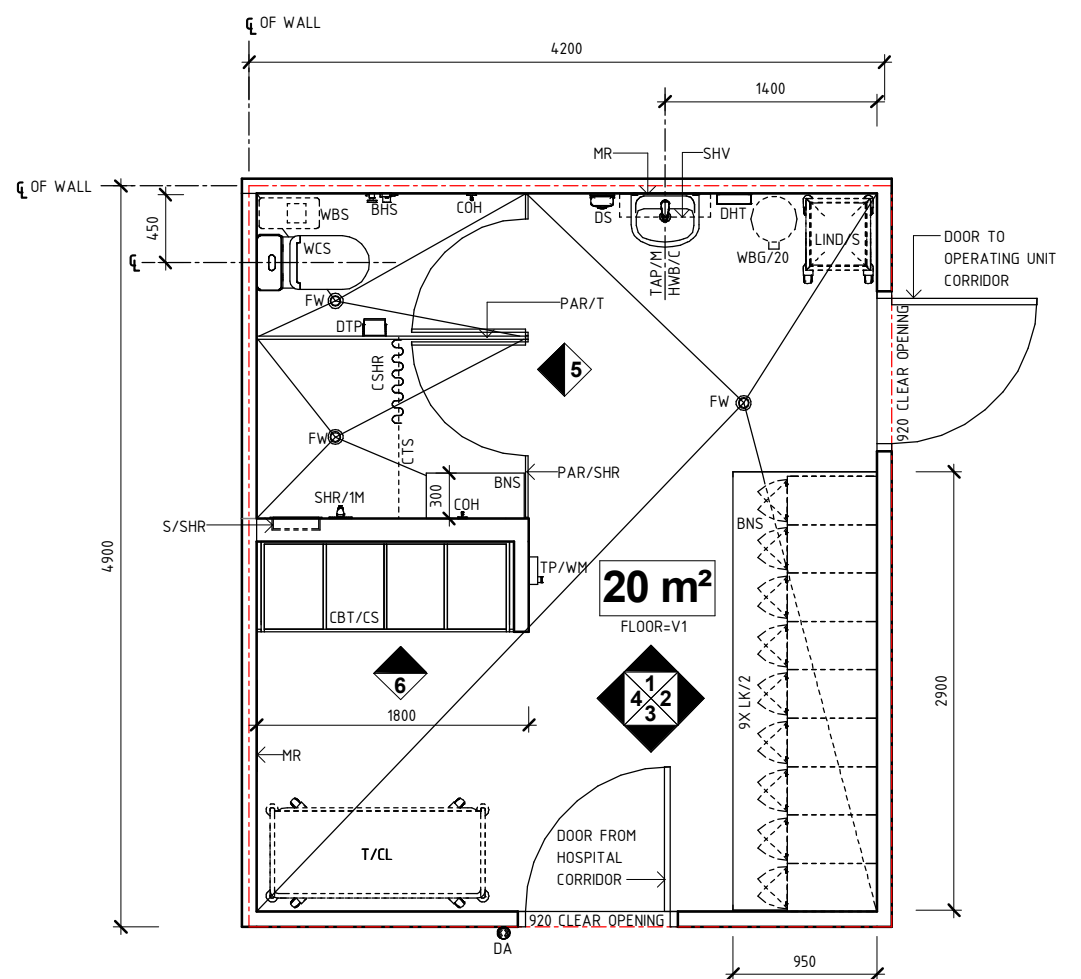

**PLAN**

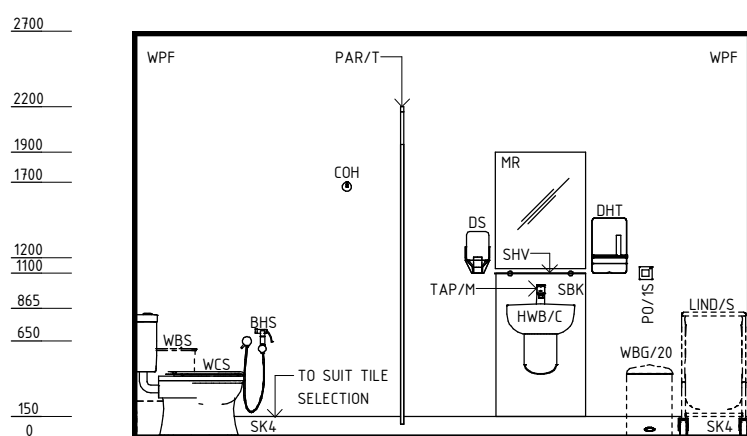

**ELEVATION 1**

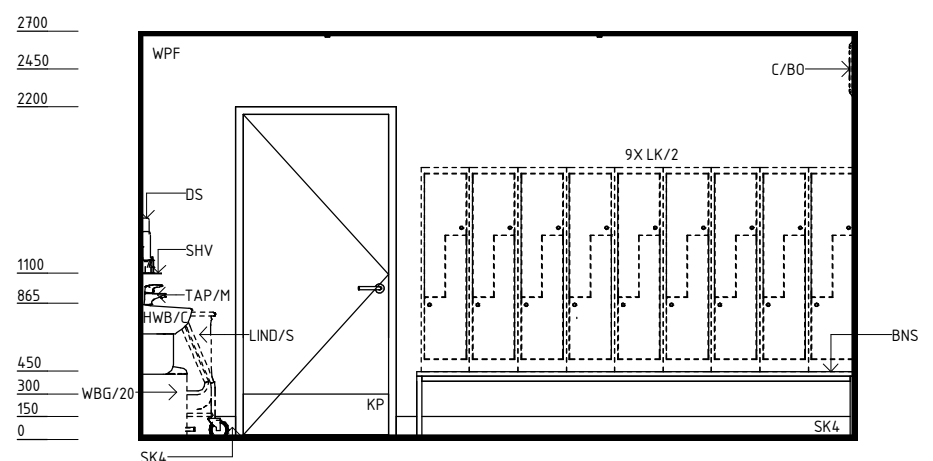

**ELEVATION 2**

REV	DESCRIPTION	DATE	BY	REV	DESCRIPTION	DATE	BY	COMPATIBILITY
1	FIRST ISSUE	19.10.15	NB					
2	GENERAL REVISION	01.03.22	RA					



International Health Facility Guidelines at:  
[www.healthdesign.com.au/iHFG](http://www.healthdesign.com.au/iHFG)  
 Editable version of Standard Components on  
 Health Facility Briefing System (HFBS) at:  
[www.healthdesign.com.au](http://www.healthdesign.com.au) ©TAHPI



DESIGNED	APPROVED	DATE	SCALE(S)	SHEET
RA	RH	01.03.22	1 : 50	1 OF 4
REVIT FILE NAME		PAPER DRAWING ID		ISSUE
chst-20-i		chst-20-i-1		2

# iHFG Standard Components

## Room Layout Sheet

RLS Room Code

chst-20-i

RDS Room Code

chst-20-i

Room Name **Change Room - Staff (Male/Female), 20 m<sup>2</sup>**

BH/PB	BULKHEAD - PLASTERBOARD, PAINT FINISH
BHS	BIDET HANDSET
BNS	BENCH SEAT
C/BO	CLOCK - BATTERY OPERATED
CBT/CS	CABINET - COAT/SHOES VALET
COM/1	COMMUNICATION OUTLET - SINGLE
CSHR	CURTAIN - SHOWER
CTS	CURTAIN TRACK - SHOWER
DTP	DISPENSER - TOILET PAPER
FS	FIXED SHELF
HGR	HANGING RAIL
KP	KICKPLATE
LK/2	LOCKER - 2 TIER
LS/R	LIGHT SWITCH - ROOM
MR	MIRROR
PAR/SHR	PARTITIONS - SHOWER
PAR/T	PARTITIONS - TOILET
S/SHR	SOAP/ SHAMPOO HOLDER - RECESSED
SHR/1M	SHOWER - SINGLE MIXER
SHRF	SHOWER - FIXED ROSE
SK4	FLOOR VINYL COVERED SKIRTING
T/CL	TROLLEY - CLEAN LINEN
TP/WM	TELEPHONE - WALL MOUNTED
WBS	WASTE BIN - SANITARY
WCS	WATER CLOSET - STANDARD
WPF	WALL PAINT FINISH
WV	WALL VINYL

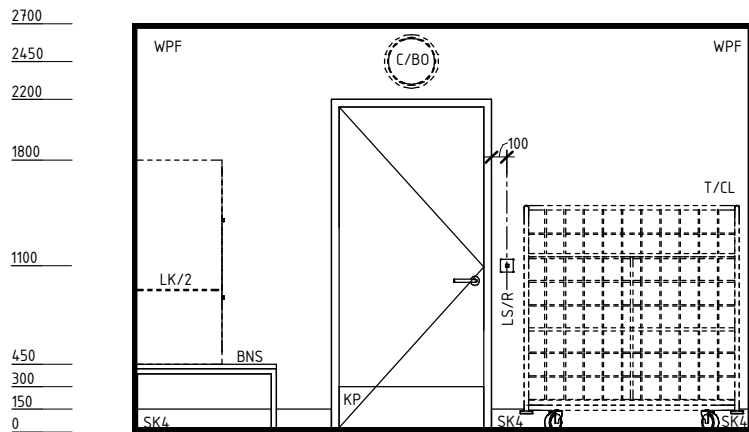

**ELEVATION 3**

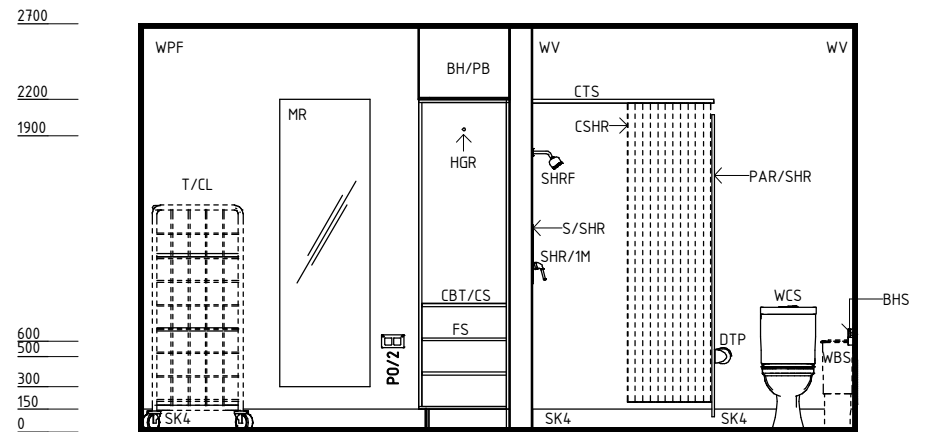

**ELEVATION 4**

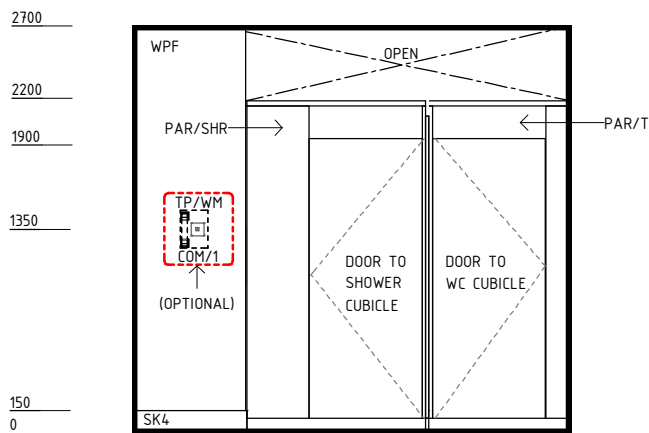

**ELEVATION 5**

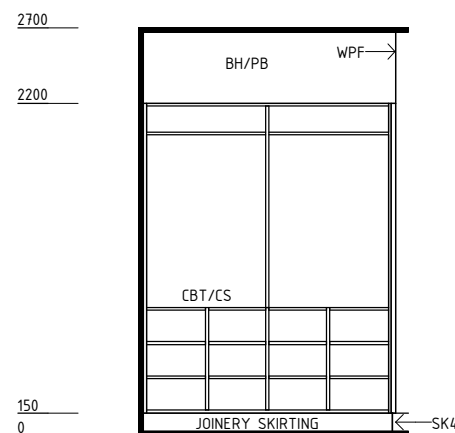

**ELEVATION 6**

REV	DESCRIPTION	DATE	BY	REV	DESCRIPTION	DATE	BY	COMPATIBILITY
1	FIRST ISSUE	19.10.15	NB					
2	GENERAL REVISION	01.03.22	RA					



International Health Facility Guidelines at:  
[www.healthdesign.com.au/iHFG](http://www.healthdesign.com.au/iHFG)  
 Editable version of Standard Components on  
 Health Facility Briefing System (HFBS) at:  
[www.healthdesign.com.au](http://www.healthdesign.com.au) ©TAHPI



DESIGNED	APPROVED	DATE	SCALE(S)	SHEET
RA	RH	01.03.22	1 : 50	2 OF 4
REVIT FILE NAME		PAPER DRAWING ID		ISSUE
chst-20-i		chst-20-i-2		2

# iHFG Standard Components

## Room Layout Sheet

RLS Room Code

chst-20-i

RDS Room Code

chst-20-i

Room Name | **Change Room - Staff (Male/Female), 20 m<sup>2</sup>**

### GENERAL NOTES:

THIS DRAWING TO BE READ IN CONJUNCTION WITH R.D.S. (ROOM DATA SHEETS) WHICH TAKES PRECEDENCE.

ALL SERVICES INDICATED ARE INDICATIVE AND SUBJECTED TO DETAILED PROJECT SPECIFIC ENGINEERING DESIGN.

### CEILING LEGEND:

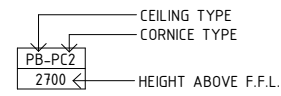

- BH/PB BULKHEAD - PLASTERBOARD, PAINT FINISH
- WPT-PC5 WATER RESISTANT, DROP IN TILES WITH POWDERCOAT ALUMINIUM CORNICE, FLUSHED AGAINST WALL
- TILE CEILING GRID (600 x 600)
- GRID LINE

### ELECTRICAL LEGEND:

- L/DR LIGHT - DOWNLIGHT, RECESSED
- L/LL LIGHT - LED LIGHT

### MECHANICAL LEGEND:

- SUPPLY AIR GRILLE
- EXHAUST GRILLE

### FIRE SERVICES LEGEND:

- SMOKE DETECTOR
- SPRINKLER

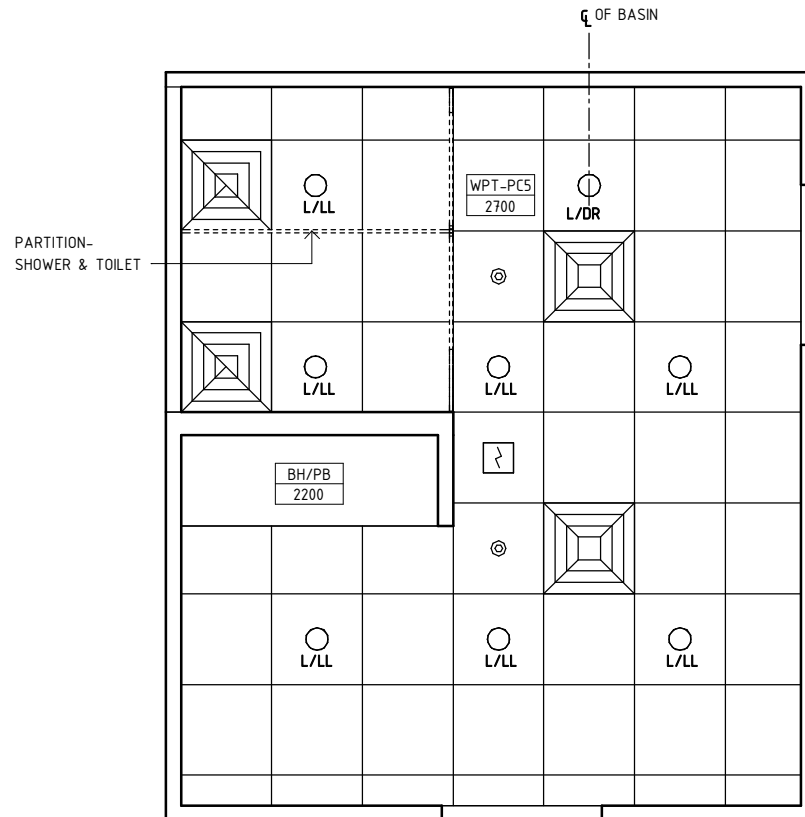

**REFLECTED CEILING PLAN**

REV	DESCRIPTION	DATE	BY	REV	DESCRIPTION	DATE	BY	COMPATIBILITY
1	FIRST ISSUE	19.10.15	NB					iHFG
2	GENERAL REVISION	01.03.22	RA					

DESIGNED	APPROVED	DATE	SCALE(S)	SHEET
RA	RH	01.03.22	1 : 50	3 OF 4

REVIT FILE NAME	PAPER DRAWING ID	ISSUE
chst-20-i	chst-20-i-3	2

# iHFG Standard Components

Room Layout Sheet

RLS Room Code

chst-20-i

RDS Room Code

chst-20-i

Room Name

Change Room - Staff (Male/Female), 20 m<sup>2</sup>

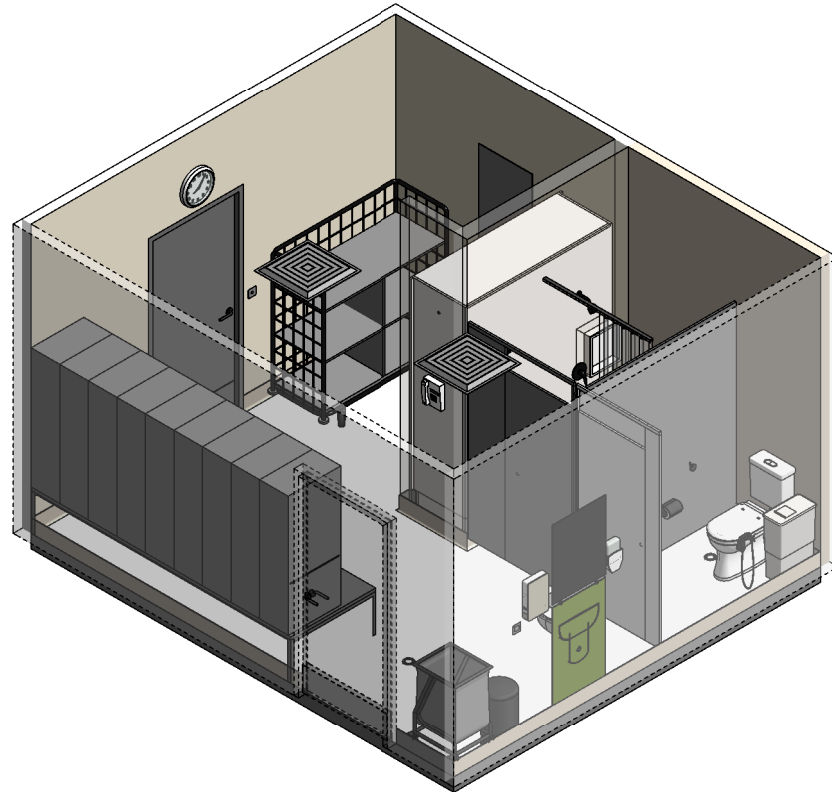

**ISOMETRIC VIEW 01**

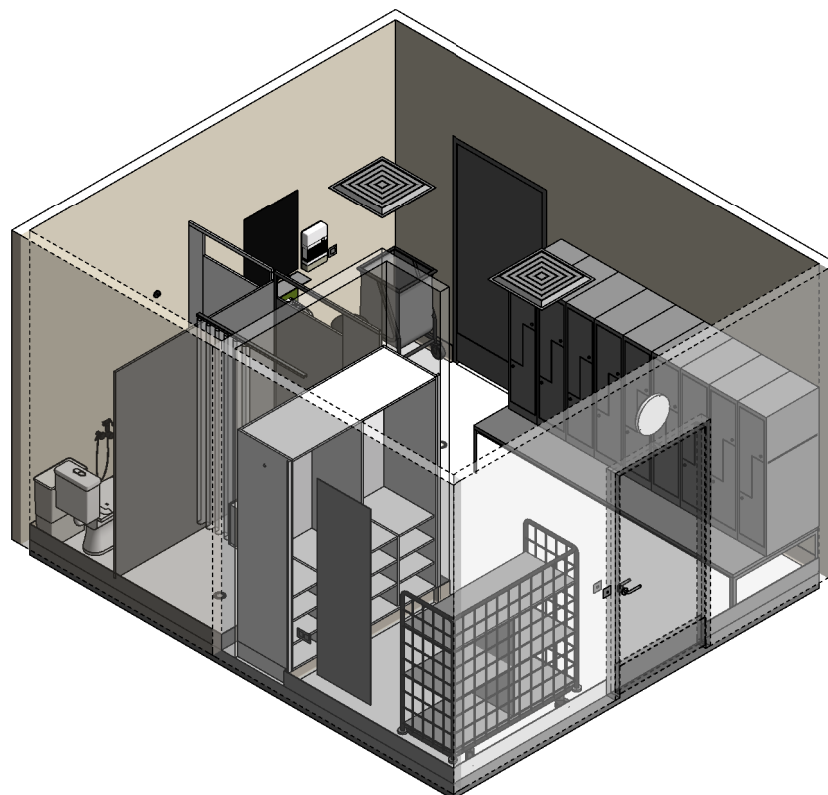

**ISOMETRIC VIEW 02**

REV	DESCRIPTION	DATE	BY	REV	DESCRIPTION	DATE	BY	COMPATIBILITY
1	FIRST ISSUE	19.10.15	NB					
2	GENERAL REVISION	01.03.22	RA					



International Health Facility Guidelines at:  
[www.healthdesign.com.au/iHFG](http://www.healthdesign.com.au/iHFG)  
 Editable version of Standard Components on  
 Health Facility Briefing System (HFBS) at:  
[www.healthdesign.com.au](http://www.healthdesign.com.au) ©TAHPI



DESIGNED	APPROVED	DATE	SCALE(S)	SHEET
RA	RH	01.03.22		4 OF 4
REVIT FILE NAME		PAPER DRAWING ID		ISSUE
chst-20-i		chst-20-i-4		2

This document is for advisory purpose only