

# iHFG Standard Components

Room Layout Sheet

Room Name **Communications Room, 12m2**

RLS Room Code

comm-12-i

RDS Room Code

comm-12-i

- BNL BENCH - LAMINATE
- CAC CABLE ACCESS CAP
- CAT CABLE TRAY
- CHR/E CHAIR - ERGONOMIC, OFFICE
- CMP COMPUTER
- COM/2 COMMUNICATION OUTLET - DOUBLE
- COMBD COMMUNICATION BOARD
- COP/FE CONTROL PANEL - FIRE AND EWIS
- DB DISTRIBUTION BOARD
- KP KICKPLATE
- LS/R LIGHT SWITCH - ROOM
- LVP LAMINATED VERTICAL SUPPORT PANEL
- PO/1S POWER OUTLET - SPECIAL, SINGLE
- PO/1U UNINTERRUPTED POWER SUPPLY - SINGLE
- PO/2 POWER OUTLET - DOUBLE
- RCOM RACK - COMMUNICATION
- SK4 FLOOR VINYL COVERED SKIRTING
- TP/HS TELEPHONE - HANDSET, STANDARD
- V5 VINYL FLOORING, ANTI-STATIC
- WPF WALL PAINT FINISH

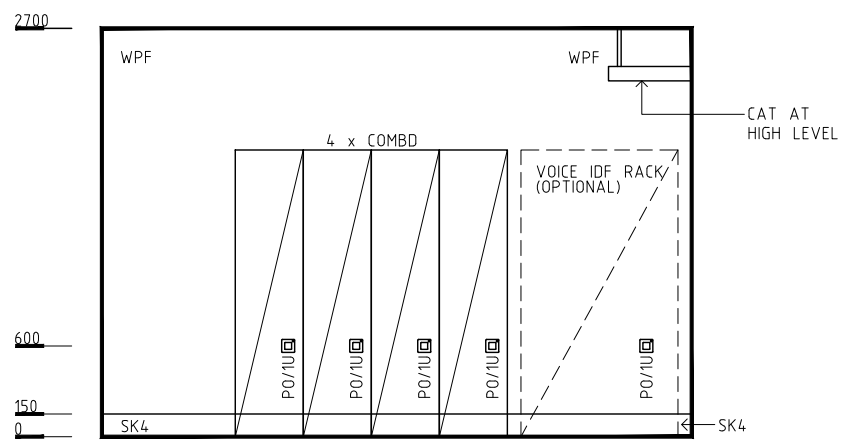
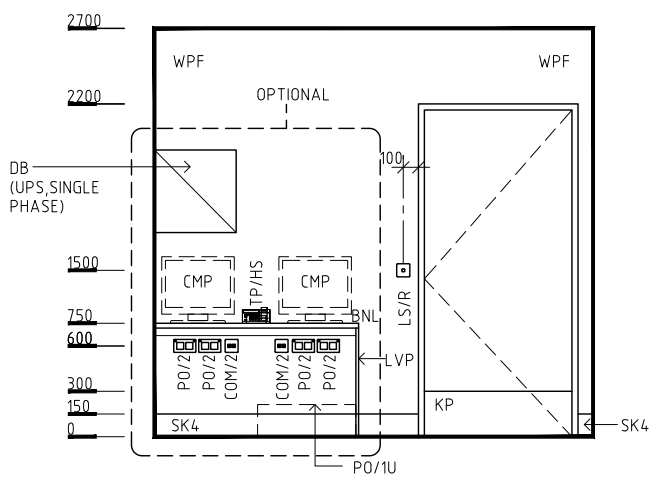
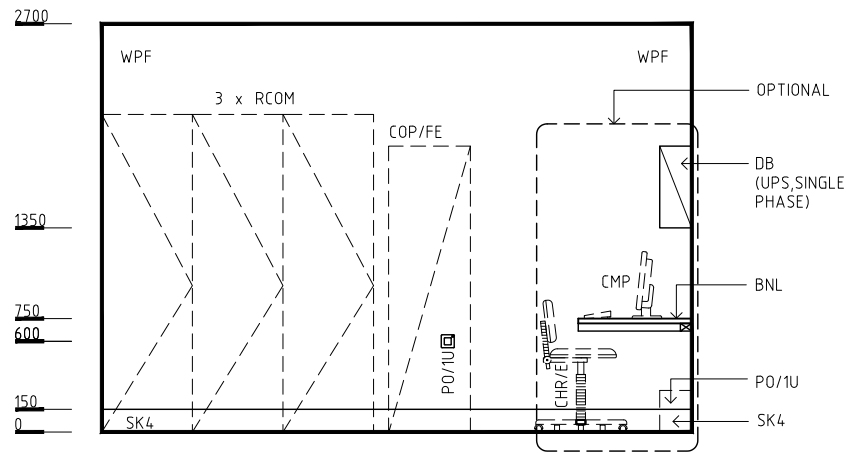
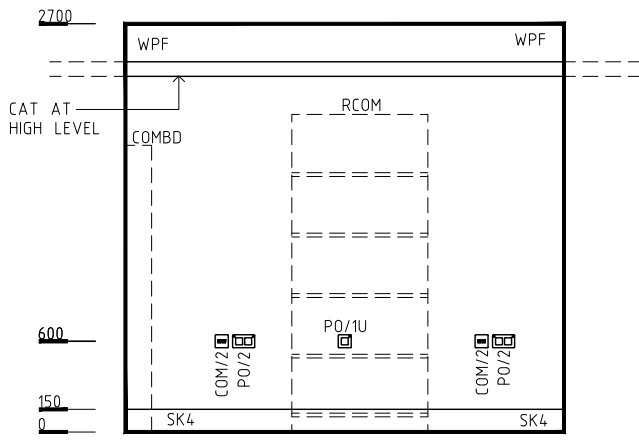
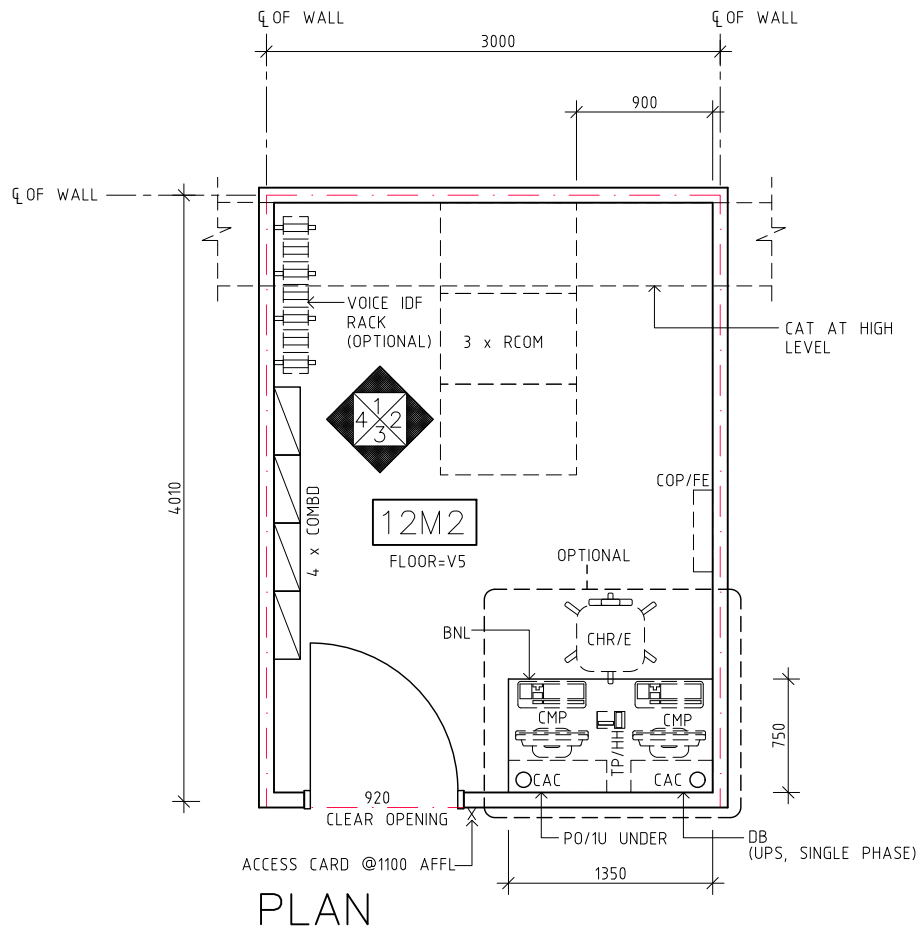

REV	DESCRIPTION	DATE	BY	REV	DESCRIPTION	DATE	BY	COMPATIBILITY
1	FIRST ISSUE	24.10.10	CC	4	GENERAL REVISION	30.12.22	RA	iHFG
2	GENERAL REVISION	30.08.11	ASD					
3	GENERAL REVISION	31.10.12	KC					

# iHFG Standard Components

Room Layout Sheet

Room Name **Communications Room, 12m2**

RLS Room Code

comm-12-i

RDS Room Code

comm-12-i

**GENERAL NOTES:**

THIS DRAWING TO BE READ IN CONJUNCTION WITH R.D.S. (ROOM DATA SHEETS) WHICH TAKES PRECEDENCE.

ALL SERVICES INDICATED ARE INDICATIVE AND SUBJECTED TO DETAILED PROJECT SPECIFIC ENGINEERING DESIGN.

**CEILING LEGEND:**

- PBT PLASTERBOARD DROP-IN CEILING TILES (PREFINISHED)
- PC4 SHADOW ANGLE
- POWDERCOAT ALUMINIUM CORNICE
- TILE CEILING GRID (600 x 600)
- GRID LINE
- CEILING TYPE
- HEIGHT ABOVE F.F.L.

**ELECTRICAL LEGEND:**

- L/LL LIGHT- LED LIGHTING

**MECHANICAL LEGEND:**

- SUPPLY AIR GRILLE
- RETURN AIR OR TRANSFER AIR GRILLE

**FIRE SERVICES LEGEND:**

- SMOKE DETECTOR
- SPRINKLER

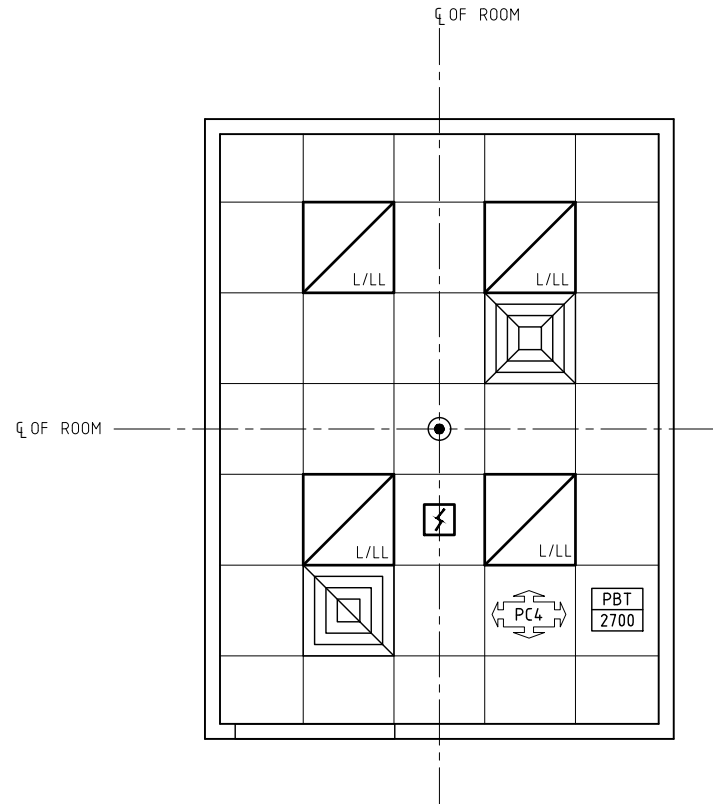

REFLECTED CEILING PLAN

REV	DESCRIPTION	DATE	BY	REV	DESCRIPTION	DATE	BY	COMPATIBILITY
1	FIRST ISSUE	24.10.10	CC	4	GENERAL REVISION	30.12.22	RA	
2	GENERAL REVISION	30.08.11	ASD					
3	GENERAL REVISION	31.10.12	KC					
International Health Facility Guidelines at: <a href="http://www.healthdesign.com.au/iHFG">www.healthdesign.com.au/iHFG</a> Editable version of Standard Components on Health Facility Briefing System (HFBS) at: <a href="http://www.healthdesign.com.au">www.healthdesign.com.au</a> ©TAHPI								
DESIGNED		APPROVED		DATE		SCALE(S)		SHEET
RA		RH		30.12.22		1:50 in A3		2 of 2
CAD FILE NAME				PAPER DRAWING ID				ISSUE
Comm-12-i				comm-12-i-2				4