

iHFG Standard Components

Room Layout Sheet

RLS Room Code

cons-opt-i

RDS Room Code

cons-opt-i

Room Name **Consult / Exam Room - Ophthalmology**

- BH/PB BULKHEAD - PLASTERBOARD, PAINT FINISH
- BLVI BLIND - VENETIAN, INTEGRAL
- BRCBS BRACKET - SUCTION BOTTLE
- CAC CABLE ACCESS CAP
- CBD/W CUPBOARD - WALL MOUNTED
- CHR/E CHAIR - ERGONOMIC, OFFICE
- CHR/VO CHAIR - VISITOR, OFFICE
- CMP COMPUTER
- COH COAT HOOK
- COM/2 COMMUNICATION OUTLET - DOUBLE
- CPT/T CARPET TILES
- DDG DISPENSER - DISPOSABLE GLOVES
- DFP DOOR AND DOOR FRAME PROTECTION
- DHM DISPENSER - HAND MOISTURISER
- DHS DISPENSER - HAND SANITISER
- DHT DISPENSER - PAPER HAND TOWEL
- DK DESK
- DSA DISPENSER - SOAP, ANTISEPTIC
- EC EMERGENCY CALL
- HWB/V HAND WASH BASIN - VANITY
- LS/R LIGHT SWITCH - ROOM
- MA MEDICAL AIR
- O2 OXYGEN
- OP OBSERVATION PANEL
- PC PATIENT CALL
- PCH PATIENT CALL HANDSET
- PN/FC PINBOARD - FABRIC COVERED
- PO/1E POWER OUTLET - EMERGENCY, SINGLE
- PO/2 POWER OUTLET - DOUBLE
- PO/2E POWER OUTLET - EMERGENCY, DOUBLE
- PO/C POWER OUTLET - CLEANER'S
- PRT/N PRINTER - NETWORKED
- S SUCTION
- SAC STAFF ASSIST CALL
- SB SUCTION BOTTLE
- SK1 MDF SKIRTING
- SK4 FLOOR VINYL COVED SKIRTING
- SP SERVICES PANEL
- STAM STOOL - ADJUSTABLE, MOBILE
- TAP/ST TAPWARE - SENSOR TAP
- TP/HH TELEPHONE - HANDSET, HANDSFREE
- V1 VINYL FLOORING, STANDARD SLIP RESISTANT
- V6 VINYL FLOORING, NON SLIP - TEXTURED
- WBC/20 WASTE BIN - CLINICAL, 20 LITRE
- WBG/20 WASTE BIN - GENERAL, 20 LITRE
- WPF WALL PAINT FINISH

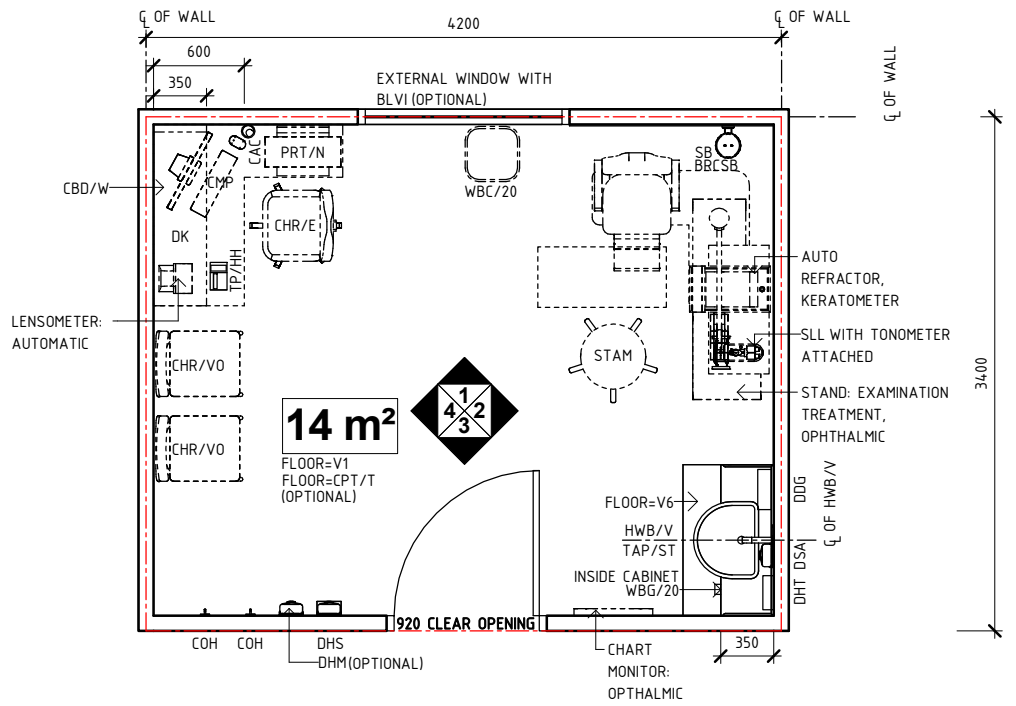

PLAN

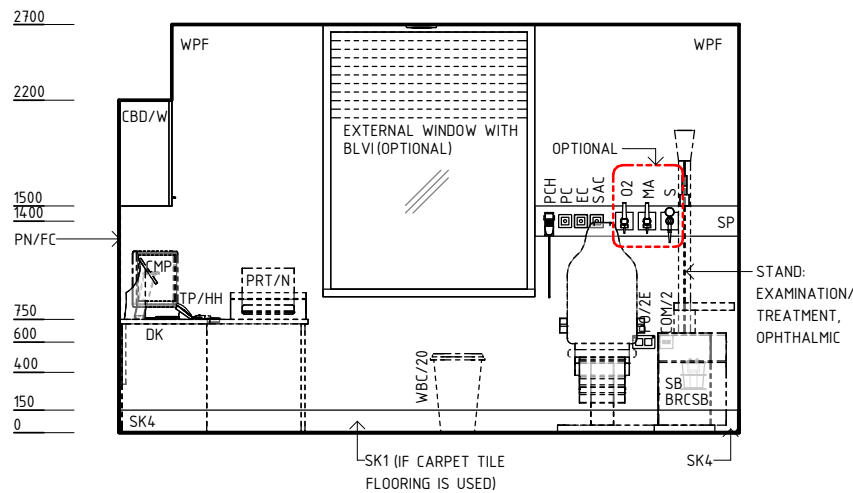

ELEVATION 1

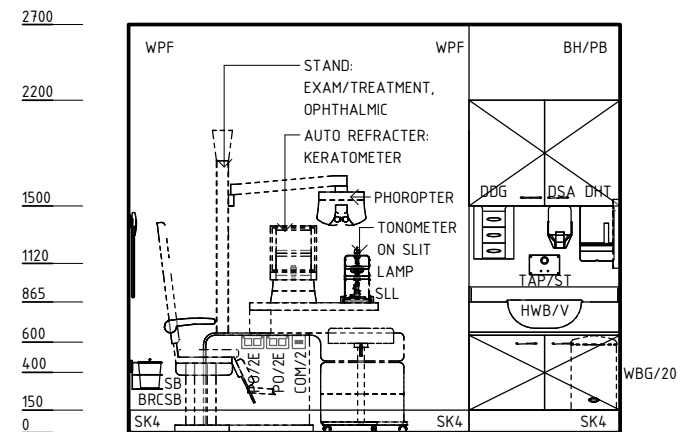

ELEVATION 2

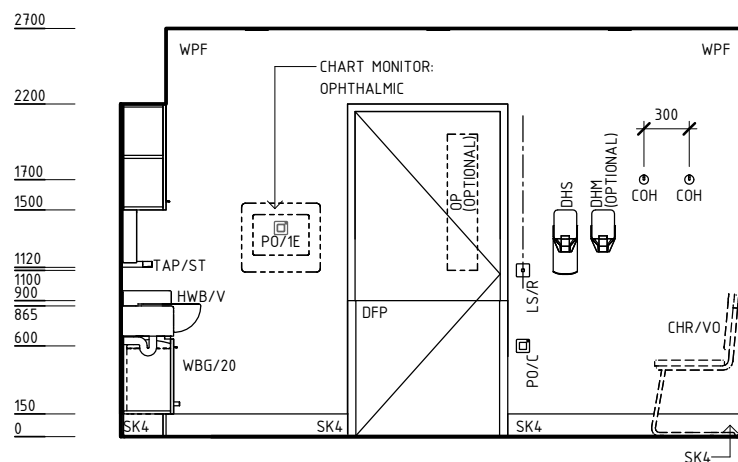

ELEVATION 3

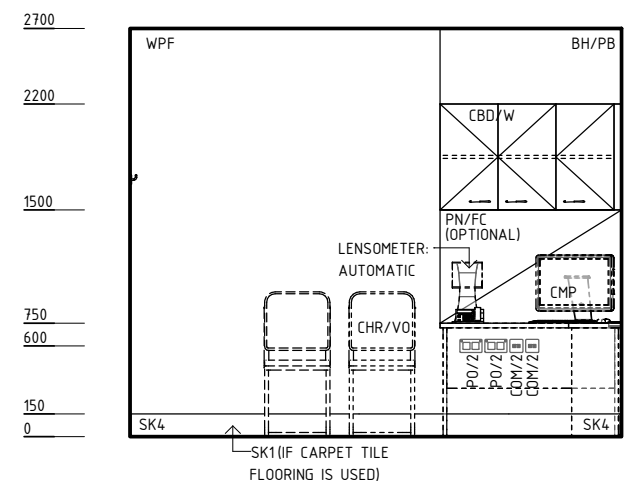

ELEVATION 4

REV	DESCRIPTION	DATE	BY	REV	DESCRIPTION	DATE	BY	COMPATIBILITY
1	FIRST ISSUE	01.04.2024	AK					

	DESIGNED	APPROVED	DATE	SCALE(S)	SHEET
	AK	SS	01.04.24	1 : 50	1 OF 2
	REVIT FILE NAME	PAPER DRAWING ID		ISSUE	
	cons-opt-i	cons-opt-i-1		1	

This document is for advisory purpose only

International Health Facility Guidelines at:
www.healthdesign.com.au/iHFG
 Editable version of Standard Components on
 Health Facility Briefing System (HFBS) at:
www.healthdesign.com.au ©TAHPI



iHFG Standard Components

Room Layout Sheet

RLS Room Code

cons-opt-i

RDS Room Code

cons-opt-i

Room Name | **Consult / Exam Room - Ophthalmology**

GENERAL NOTES:

THIS DRAWING TO BE READ IN CONJUNCTION WITH R.D.S. (ROOM DATA SHEETS) WHICH TAKES PRECEDENCE.

ALL SERVICES INDICATED ARE INDICATIVE AND SUBJECT TO DETAILED PROJECT SPECIFIC ENGINEERING DESIGN.

CEILING LEGEND:

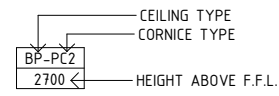

ACT-PC4 ACOUSTIC CEILING TILES WITH POWDERCOAT ALUMINIUM CORNICE, SHADOW LINE
BH/PB PLASTERBOARD BULKHEAD, PAINT FINISH



ELECTRICAL LEGEND:

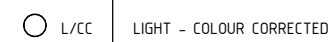

MECHANICAL LEGEND:

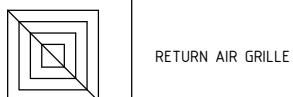

FIRE SERVICES LEGEND:

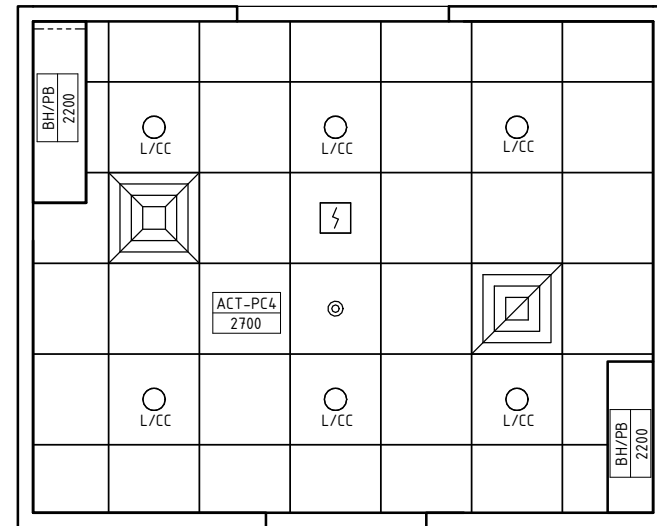
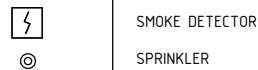

REFLECTED CEILING PLAN

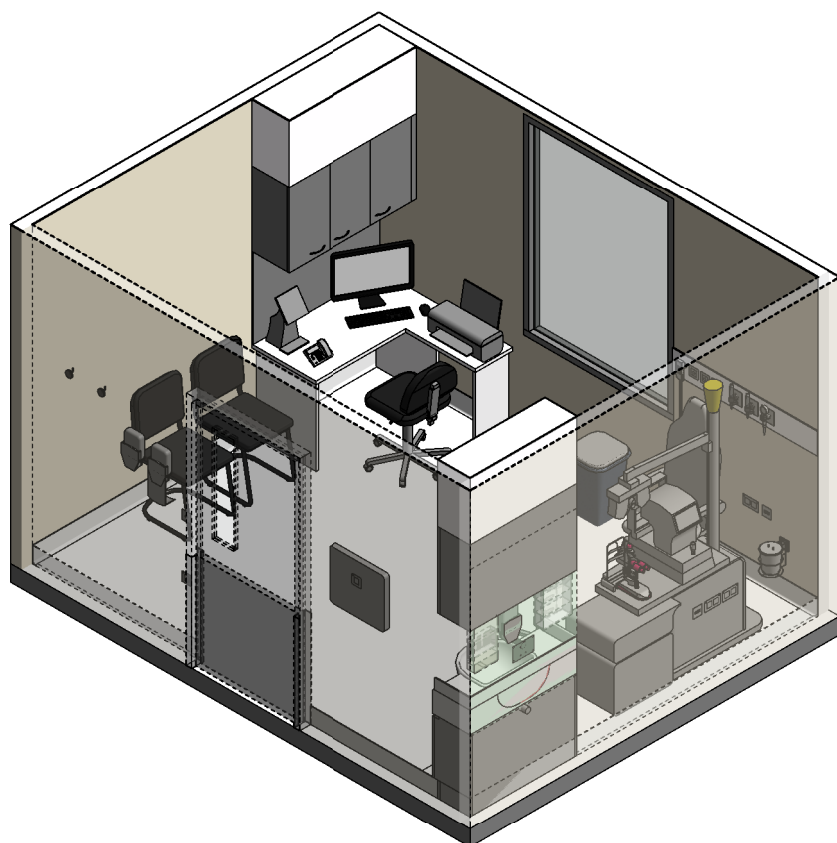

ISOMETRIC VIEW 1

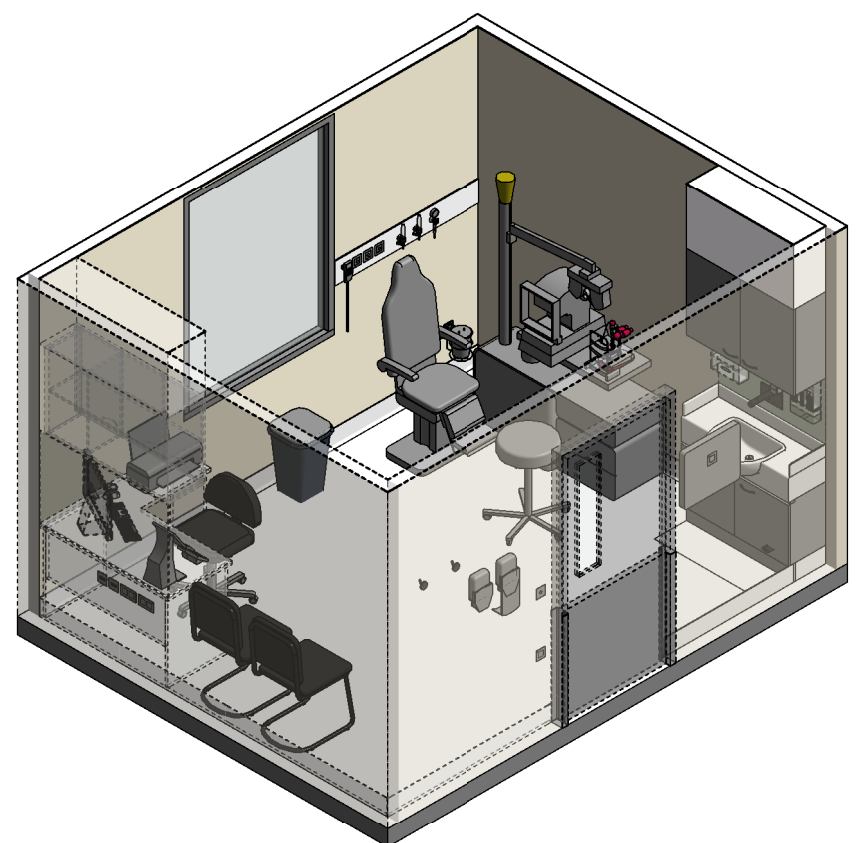

ISOMETRIC VIEW 02

REV	DESCRIPTION	DATE	BY	REV	DESCRIPTION	DATE	BY	COMPATIBILITY																				
1	FIRST ISSUE	01.04.2024	AK					iHFG																				
								<table border="1"> <thead> <tr> <th>DESIGNED</th> <th>APPROVED</th> <th>DATE</th> <th>SCALE(S)</th> <th>SHEET</th> </tr> </thead> <tbody> <tr> <td>AK</td> <td>SS</td> <td>01.04.24</td> <td>1 : 50</td> <td>2 OF 2</td> </tr> <tr> <td colspan="2">REVIT FILE NAME</td> <td colspan="2">PAPER DRAWING ID</td> <td>ISSUE</td> </tr> <tr> <td colspan="2">cons-opt-i</td> <td colspan="2">cons-opt-i-2</td> <td>1</td> </tr> </tbody> </table>	DESIGNED	APPROVED	DATE	SCALE(S)	SHEET	AK	SS	01.04.24	1 : 50	2 OF 2	REVIT FILE NAME		PAPER DRAWING ID		ISSUE	cons-opt-i		cons-opt-i-2		1
DESIGNED	APPROVED	DATE	SCALE(S)	SHEET																								
AK	SS	01.04.24	1 : 50	2 OF 2																								
REVIT FILE NAME		PAPER DRAWING ID		ISSUE																								
cons-opt-i		cons-opt-i-2		1																								