

iHFG Standard Components

Room Layout Sheet

Room Name **CT Scanning - Control Room**

RLS Room Code

ctcr-i

RDS Room Code

ctcr-i

AS	ADJUSTABLE SHELF
CAC	CABLE ACCESS CAP
CHR/E	CHAIR - ERGONOMIC, OFFICE
CMP	COMPUTER
COM/2	COMMUNICATION OUTLET - DOUBLE
FS	FIXED SHELF
GPO/1S	GENERAL POWER OUTLET - SPECIAL
GPO/2	GENERAL POWER OUTLET - DOUBLE
H/H	HOOK - HEAVY DUTY
IM/CC	IMAGING - CONSOLE, CONTROL
INT	INTERCOM
KP	KICKPLATE
LS/R	LIGHT SWITCH - ROOM
OP	OBSERVATION PANEL
SK4	FLOOR VINYL COVERED SKIRTING
SU	SHELVING UNIT
TB/COM	TABLE - COMPUTER
TP/HS	TELEPHONE - HANDSET, STANDARD
V1	VINYL FLOORING, STANDARD SLIP RESISTANT
WB	WHITEBOARD
WPF	WALL PAINT FINISH

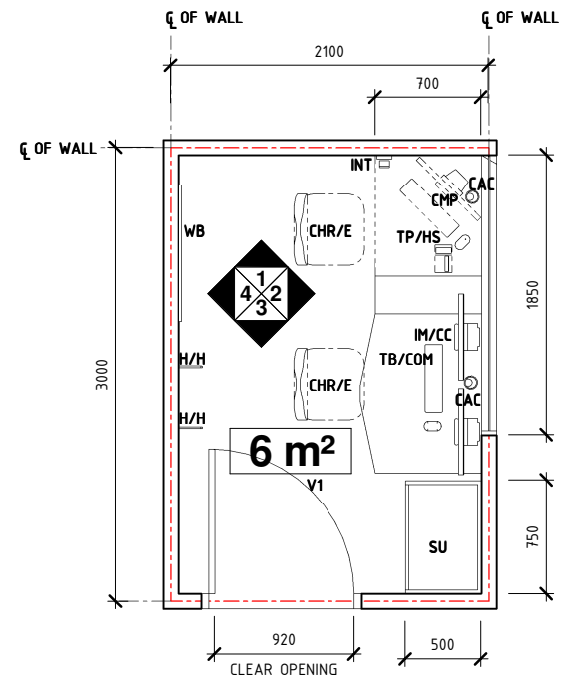

PLAN

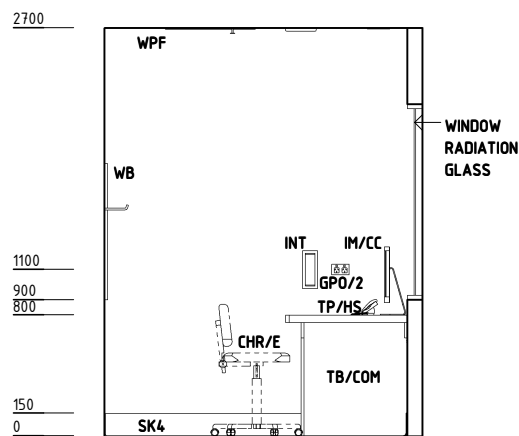

ELEVATION 1

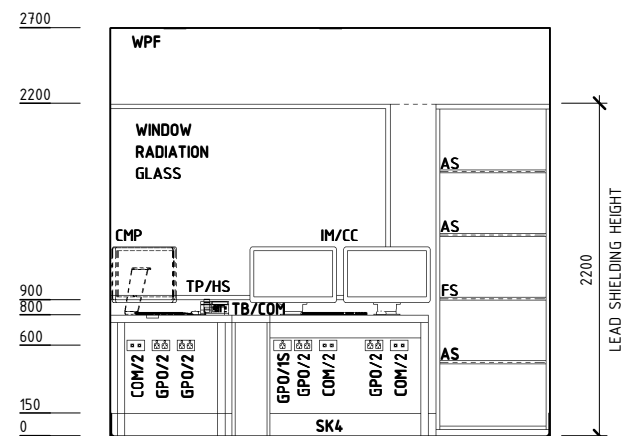

ELEVATION 2

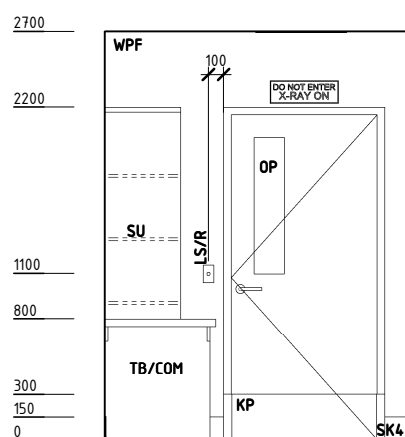

ELEVATION 3

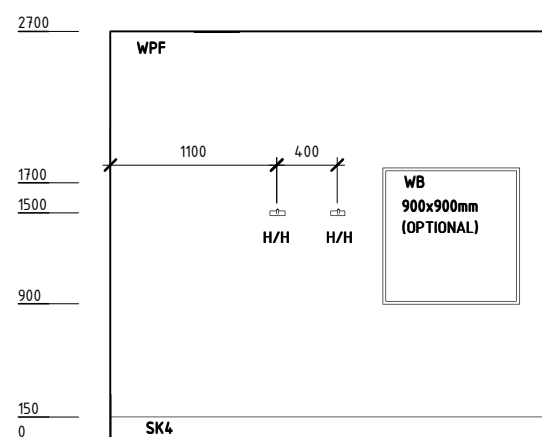

ELEVATION 4

REV	DESCRIPTION	DATE	BY	REV	DESCRIPTION	DATE	BY	COMPATIBILITY					
1	FIRST ISSUE	05.03.2017	RC					iHFG	AHFG	FGI	HBN	HTM	HAAD
								DESIGNED	APPROVED	DATE	SCALE(S)	SHEET	
								RC	DB	05.03.17	1 : 50	1 OF 2	
								REVIT FILE NAME	PAPER DRAWING ID		ISSUE		
								ctcr-i	ctcr-i-1		1		

iHFG Standard Components

Room Layout Sheet

Room Name **CT Scanning - Control Room**

RLS Room Code

ctcr-i

RDS Room Code

ctcr-i

ACT ACOUSTIC CEILING TILES
L/DR LIGHT - DOWNLIGHT, RECESSED
L/GF LIGHT - GENERAL FLUORESCENT

GENERAL NOTES:

THIS DRAWING TO BE READ IN CONJUNCTION WITH R.D.S. (ROOM DATA SHEETS) WHICH TAKES PRECEDENCE.

ALL SERVICES INDICATED ARE INDICATIVE AND SUBJECTED TO DETAILED PROJECT SPECIFIC ENGINEERING DESIGN.

CEILING LEGEND:

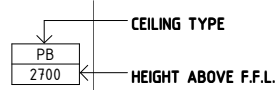

MECHANICAL LEGEND:

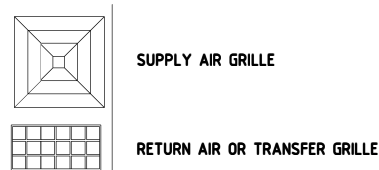

FIRE SERVICES LEGEND:

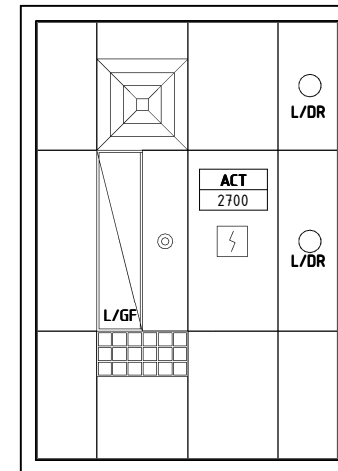

REFLECTED CEILING PLAN

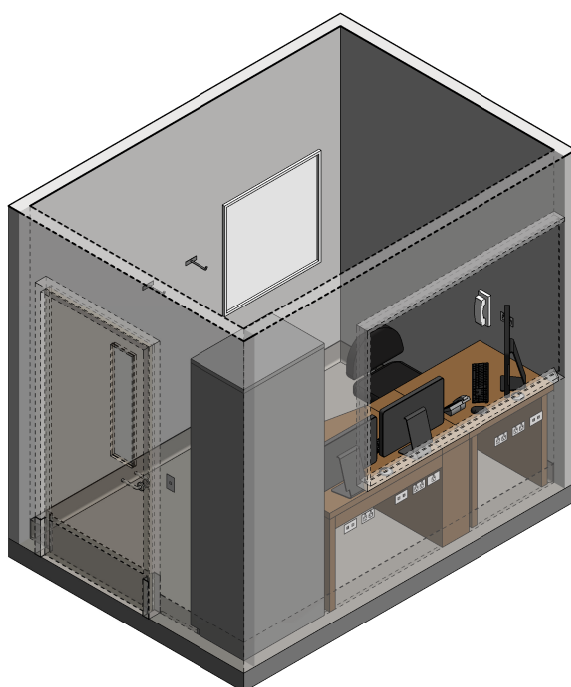

ISOMETRIC VIEW



PERSPECTIVE VIEW

REV	DESCRIPTION	DATE	BY	REV	DESCRIPTION	DATE	BY	COMPATIBILITY					
1	FIRST ISSUE	05.03.2017	RC					iHFG	AHFG	FGI	HBN	HTM	HAAD
								DESIGNED	APPROVED	DATE	SCALE(S)	SHEET	
								RC	DB	05.03.17	1 : 50	2 OF 2	
								REVIT FILE NAME		PAPER DRAWING ID		ISSUE	
								ctcr-i		ctcr-i-2		1	



The International Health Facility Guidelines recommends the use of HFBS “Health Facility Briefing System” to edit all room data sheet information for your project.

HFBS provides edit access to all iHFG standard rooms, and departments, and more than 100 custom report templates.

HFBS Health Facility Briefing System



Briefing Module

The Health Facility Briefing System (HFBS) has numerous modules available via annual subscription. It suits healthcare Architects, Medical Planners, Equipment Planners Project Managers and Health Authorities.

Use the HFBS Briefing Module to quickly drag in health facility departments or pre-configured room templates from the iHFG standard, edit the room features such as finishes, furniture, fittings, fixtures, medical equipment, engineering services. The system can print or download as PDF more than 100 custom reports including room data sheets, schedules, and more...

To learn more about the HFBS web-based Healthcare Briefing and Design Software and to obtain editable versions of the “Standard Components” including Room Data Sheets (RDS) and Room Layout Sheets (RLS) offered on the iHFG website, signup for HFBS using the link below.

Get Started Now:
hfbs.healthdesign.com.au

- ✓ iHFG Room Data Sheets and Departments are instantly editable in the HFBS software available online.
- ✓ You can access hundreds of report templates to print your iHFG room data in HFBS.
- ✓ HFBS has a onetime free 3 day trial available to all new users.

Get Started Now:
hfbs.healthdesign.com.au



HFBS

Health Facility Briefing System

hfbsinfo.com | techsupport@healthdesign.com.au