

# iHFG Standard Components

## Room Layout Sheet

RLS Room Code

elab-i

RDS Room Code

elab-i

Room Name

Electronics Laboratory, 15m2

AS	ADJUSTABLE SHELF
BH/PB	BULKHEAD - PLASTERBOARD, PAINT FINISH
BNL	BENCH - LAMINATE
CBD/UB	CUPBOARD - UNDER BENCH
CBD/WL	CUPBOARD - WALL MOUNTED, LOCKABLE
CHR/EH	CHAIR - ERGONOMIC, HIGH
COM/2	COMMUNICATION OUTLET - DOUBLE
CR	CRASH RAIL
DDG	DISPENSER - DISPOSABLE GLOVES
DFP	DOOR AND DOOR FRAME PROTECTION
DHT	DISPENSER - PAPER HAND TOWEL
DSA	DISPENSER - SOAP, ANTISEPTIC
HWB/B	HAND WASH BASIN - TYPE 'B'
L/PT	LIGHT - PELMET TASK LIGHT
LS/P	LIGHT SWITCH - PELMET TASK LIGHT
LS/R	LIGHT SWITCH - ROOM
OP	OBSERVATION PANEL
PO/2	POWER OUTLET - DOUBLE
PO/S-3PH	POWER OUTLET - SPECIAL, 3 PHASE
PO/S-20A	POWER OUTLET - SPECIAL, 20 AMPS
SBK	SPLASHBACK
SK4	FLOOR VINYL COVERED SKIRTING
TAP/ST	TAPWARE - SENSOR TAP
TP/HS	TELEPHONE - HANDSET, STANDARD
V1	VINYL FLOORING, STANDARD SLIP RESISTANT
V6	VINYL FLOORING, NON SLIP - TEXTURED
WBG/20	WASTE BIN - GENERAL, 20 LITRE
WPF	WALL PAINT FINISH

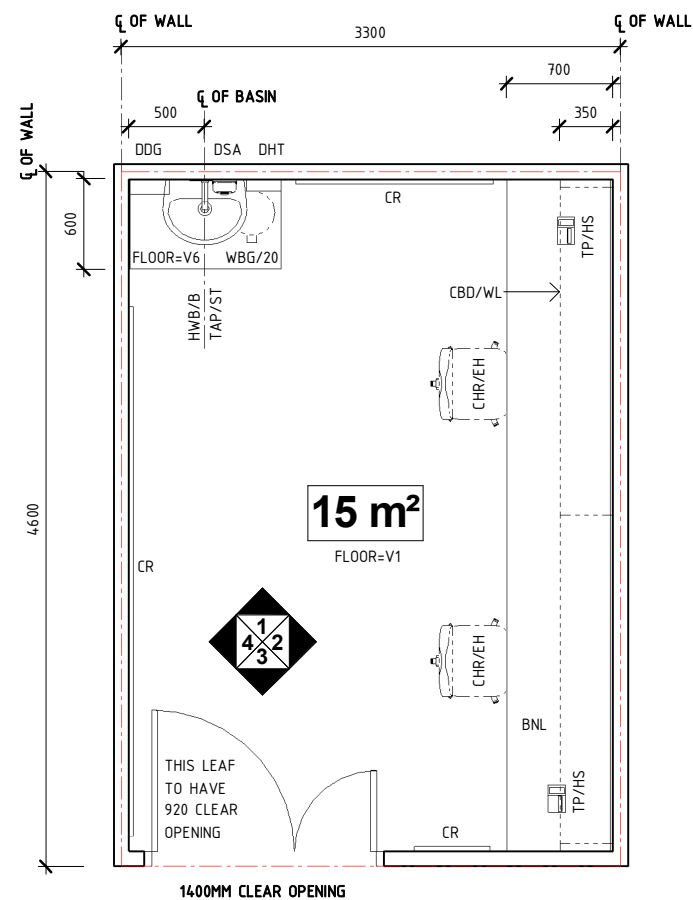

PLAN

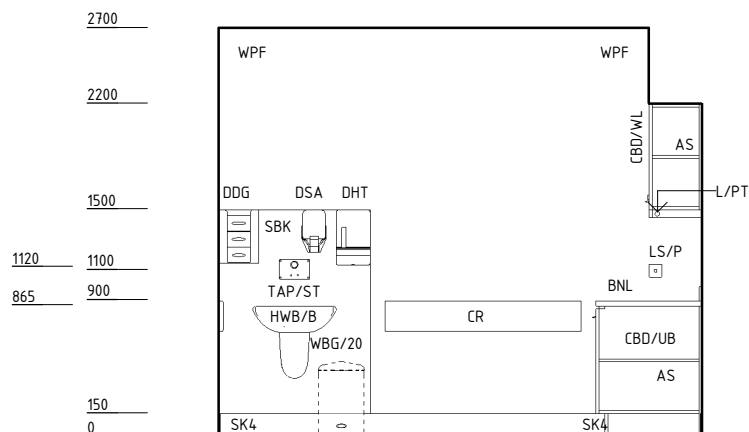

ELEVATION 1

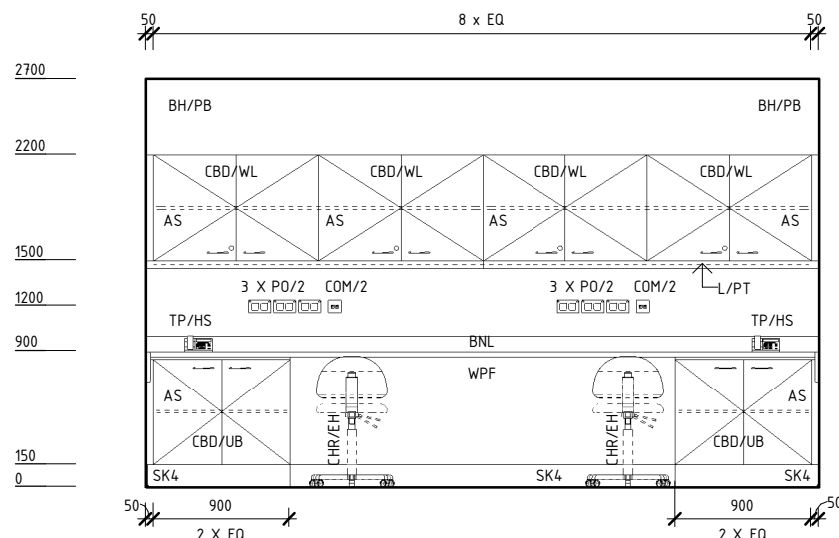

ELEVATION 2

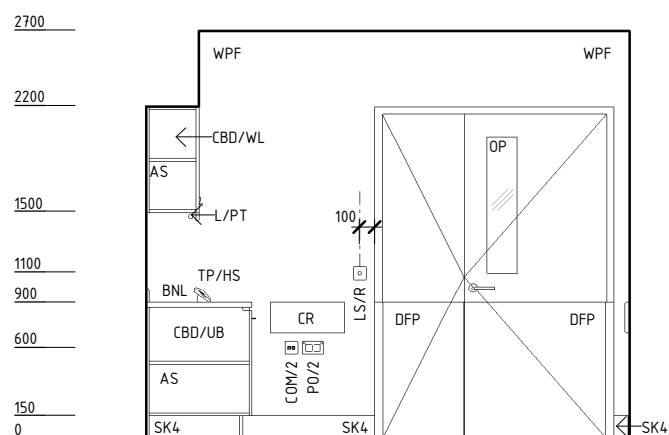

ELEVATION 3

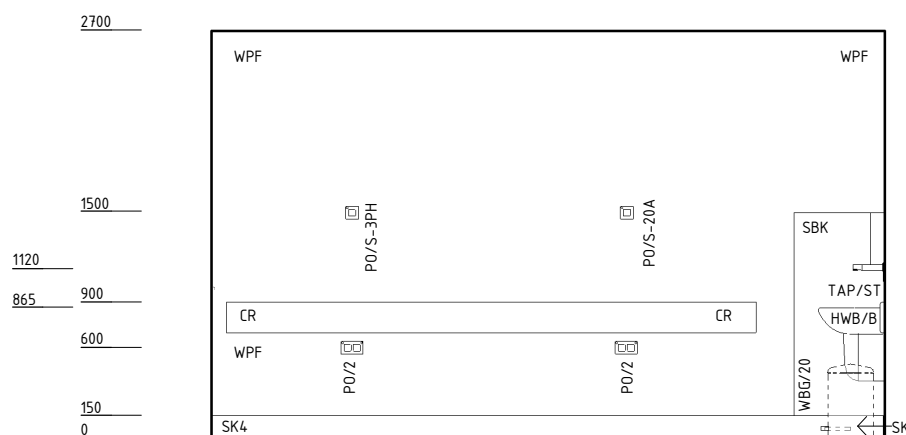

ELEVATION 4

REV	DESCRIPTION	DATE	BY	REV	DESCRIPTION	DATE	BY	COMPATIBILITY
1	FIRST ISSUE	24.10.10	LL	4	GENERAL REVISION	27.01.23	SS	
2	GENERAL REVISION	30.08.11	DJ					
3	GENERAL REVISION	31.10.12	KC					

# iHFG Standard Components

## Room Layout Sheet

RLS Room Code

elab-i

RDS Room Code

elab-i

Room Name | **Electronics Laboratory, 15m2**

### GENERAL NOTES:

THIS DRAWING TO BE READ IN CONJUNCTION WITH R.D.S. (ROOM DATA SHEETS) WHICH TAKES PRECEDENCE.

ALL SERVICES INDICATED ARE INDICATIVE AND SUBJECT TO DETAILED PROJECT SPECIFIC ENGINEERING DESIGN.

### CEILING LEGEND:

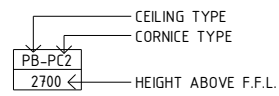

ACT-PC5 ACOUSTIC CEILING TILES WITH POWDERCOAT ALUMINIUM CORNICE, ANGEL FLUSH AGAINST WALL  
BH/PB PLASTERBOARD BULKHEAD, PAINT FINISH

### ELECTRICAL LEGEND:

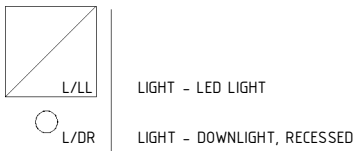

### MECHANICAL LEGEND:

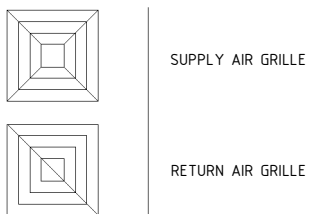

### FIRE SERVICES LEGEND:

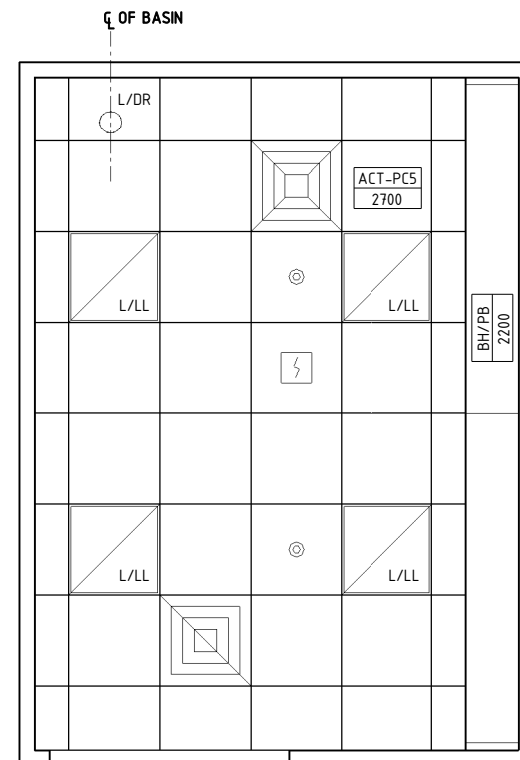
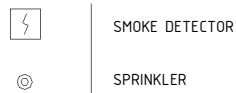

**REFLECTED CEILING PLAN**

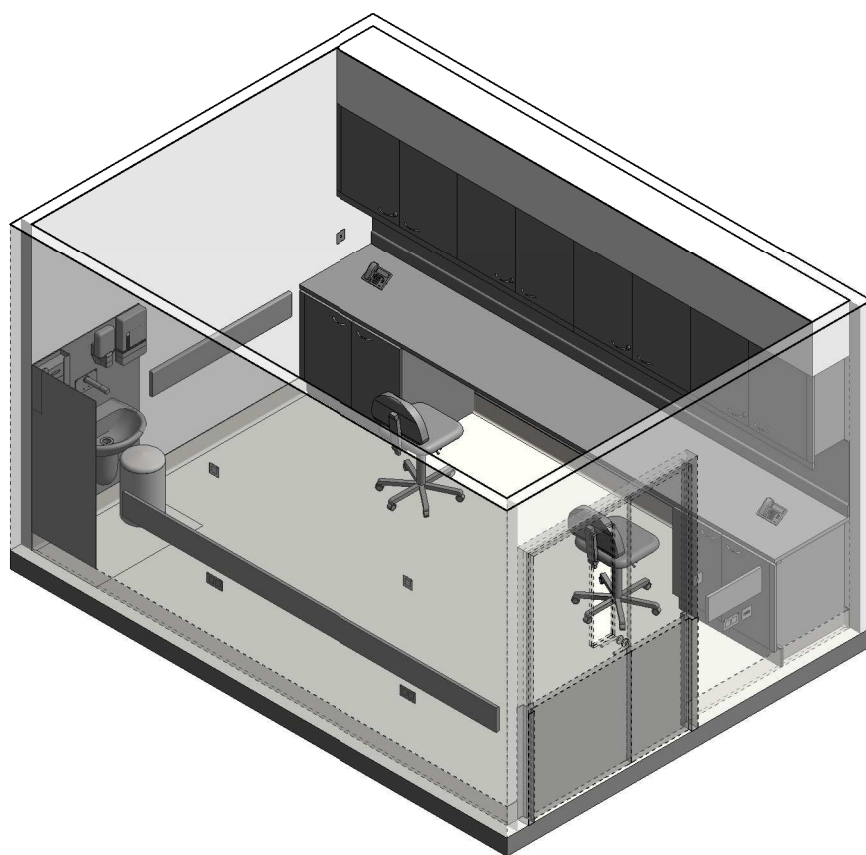

**ISOMETRIC VIEW 1**

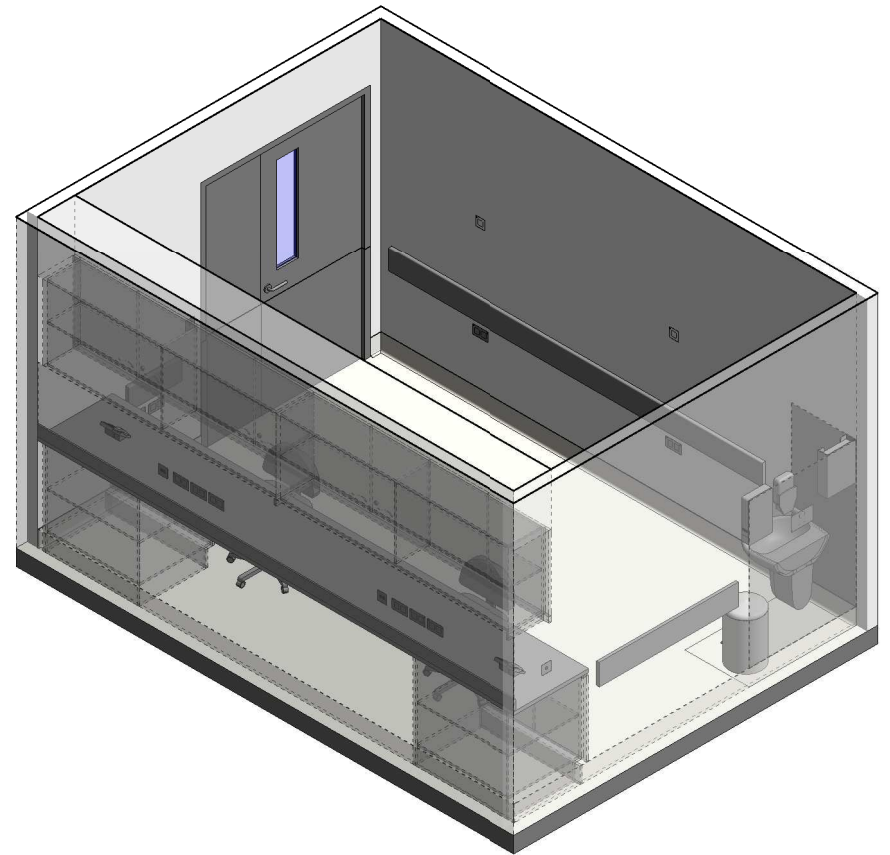

**ISOMETRIC VIEW 2**

REV	DESCRIPTION	DATE	BY	REV	DESCRIPTION	DATE	BY	COMPATIBILITY																				
1	FIRST ISSUE	24.10.10	LL	4	GENERAL REVISION	27.01.23	SS																					
2	GENERAL REVISION	30.08.11	DJ																									
3	GENERAL REVISION	31.10.12	KC																									
International Health Facility Guidelines at <a href="http://www.healthdesign.com.au/iHFG">www.healthdesign.com.au/iHFG</a> Editable version of Standard Components on Health Facility Briefing System (HFBS) at <a href="http://www.healthdesign.com.au">www.healthdesign.com.au</a> ©TAHPI								<table border="1"> <tr> <th>DESIGNED</th> <th>APPROVED</th> <th>DATE</th> <th>SCALE(S)</th> <th>SHEET</th> </tr> <tr> <td>SS</td> <td>SA</td> <td>27.01.23</td> <td>1 : 50</td> <td>2 OF 2</td> </tr> <tr> <th colspan="2">REVIT FILE NAME</th> <th colspan="2">PAPER DRAWING ID</th> <th>ISSUE</th> </tr> <tr> <td colspan="2">elab-i</td> <td colspan="2">elab-i-2</td> <td>4</td> </tr> </table>	DESIGNED	APPROVED	DATE	SCALE(S)	SHEET	SS	SA	27.01.23	1 : 50	2 OF 2	REVIT FILE NAME		PAPER DRAWING ID		ISSUE	elab-i		elab-i-2		4
DESIGNED	APPROVED	DATE	SCALE(S)	SHEET																								
SS	SA	27.01.23	1 : 50	2 OF 2																								
REVIT FILE NAME		PAPER DRAWING ID		ISSUE																								
elab-i		elab-i-2		4																								

This document is for advisory purpose only