

# iHFG Standard Components

## Room Layout Sheet

RLS Room Code

intf-i

RDS Room Code

intf-i

Room Name Interview Room - Family/ Large

AW	ARTWORK
BLR	BLIND - ROLLER
CHR/V	CHAIR - VISITOR
CMP	COMPUTER
COM/2	COMMUNICATION OUTLET - DOUBLE
CPT	CARPET
DFP	DOOR AND DOOR FRAME PROTECTION
DK	DESK
LS/R	LIGHT SWITCH - ROOM
OP	OBSERVATION PANEL
PO/2	POWER OUTLET - DOUBLE
SK7	TIMBER SKIRTING
TB/L	TABLE - LOW
TB/S	TABLE - SMALL
TP/HS	TELEPHONE - HANDSET, STANDARD
WBP/20	WASTE BIN - PAPER, 20 LITRE
WPF	WALL PAINT FINISH

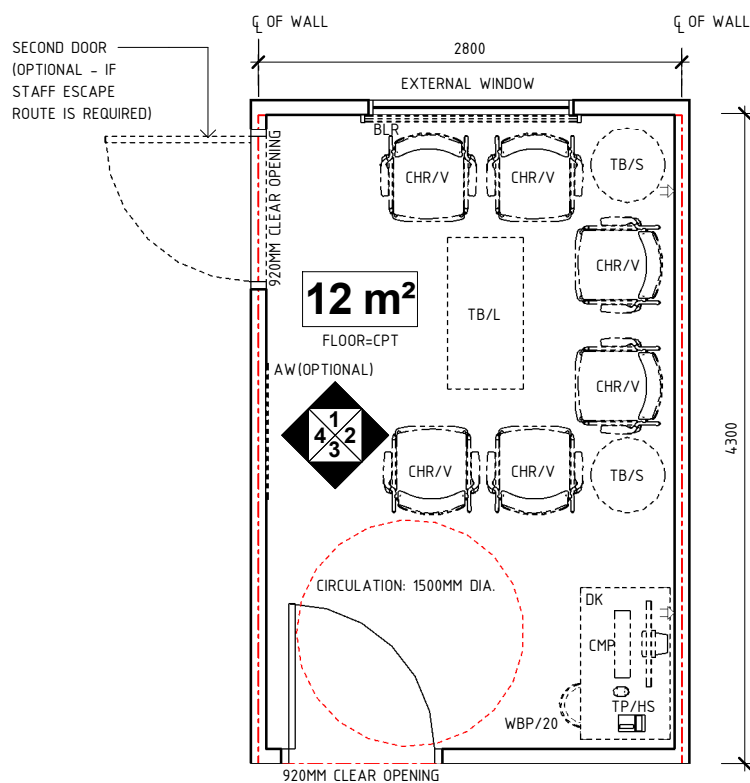

PLAN

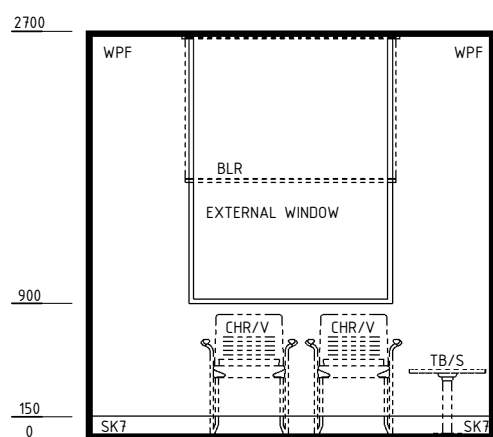

ELEVATION 1

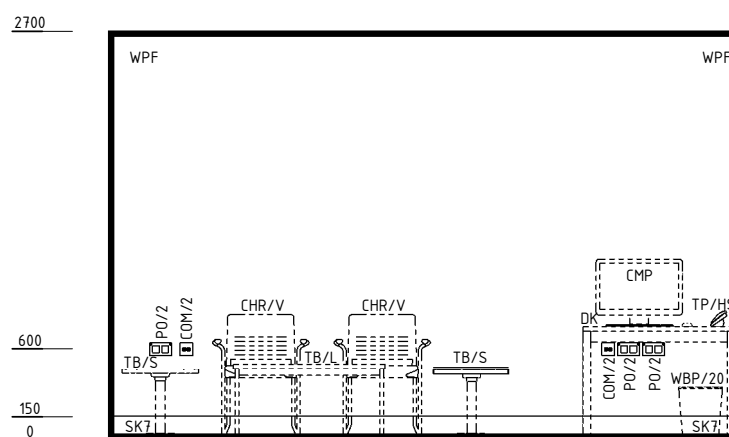

ELEVATION 2

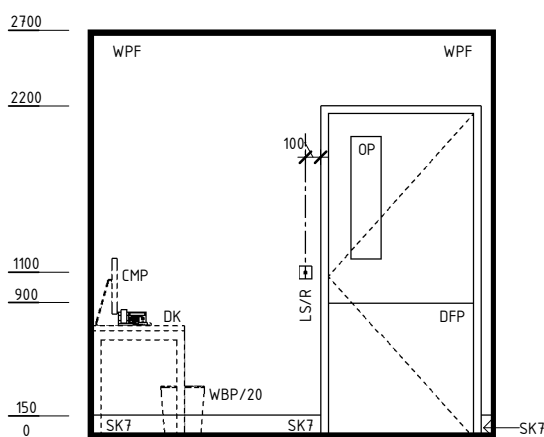

ELEVATION 3

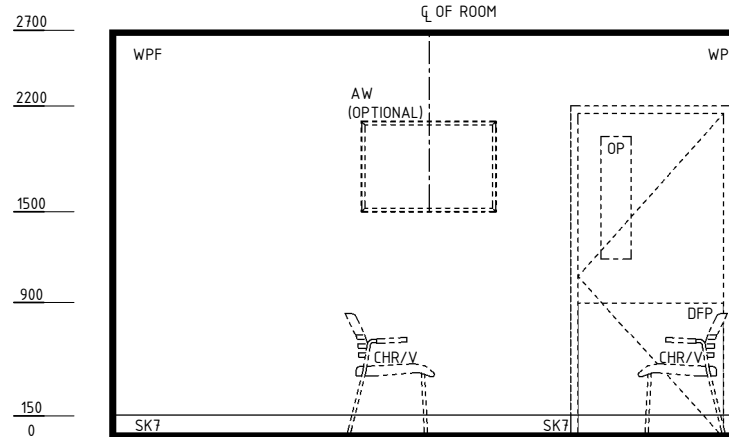

ELEVATION 4

REV	DESCRIPTION	DATE	BY	REV	DESCRIPTION	DATE	BY	COMPATIBILITY
1	FIRST ISSUE	24.10.14	NB					
2	GENERAL REVISION	31.08.22	RA					



International Health Facility Guidelines at:  
[www.healthdesign.com.au/iHFG](http://www.healthdesign.com.au/iHFG)  
 Editable version of Standard Components on  
 Health Facility Briefing System (HFBS) at:  
[www.healthdesign.com.au](http://www.healthdesign.com.au) ©TAHPI



DESIGNED	APPROVED	DATE	SCALE(S)	SHEET
RA	RH	31.08.22	1 : 50	1 OF 2
REVIT FILE NAME		PAPER DRAWING ID		ISSUE
intf-i		intf-i-1		2

# iHFG Standard Components

## Room Layout Sheet

Room Name **Interview Room - Family/ Large**

RLS Room Code

intf-i

RDS Room Code

intf-i

### GENERAL NOTES:

THIS DRAWING TO BE READ IN CONJUNCTION WITH R.D.S. (ROOM DATA SHEETS) WHICH TAKES PRECEDENCE.

ALL SERVICES INDICATED ARE INDICATIVE AND SUBJECTED TO DETAILED PROJECT SPECIFIC ENGINEERING DESIGN.

### CEILING LEGEND:

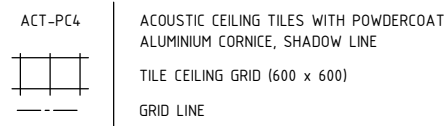
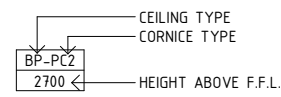

### ELECTRICAL LEGEND:

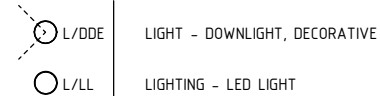

### MECHANICAL LEGEND:

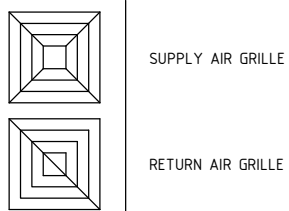

### FIRE SERVICES LEGEND:

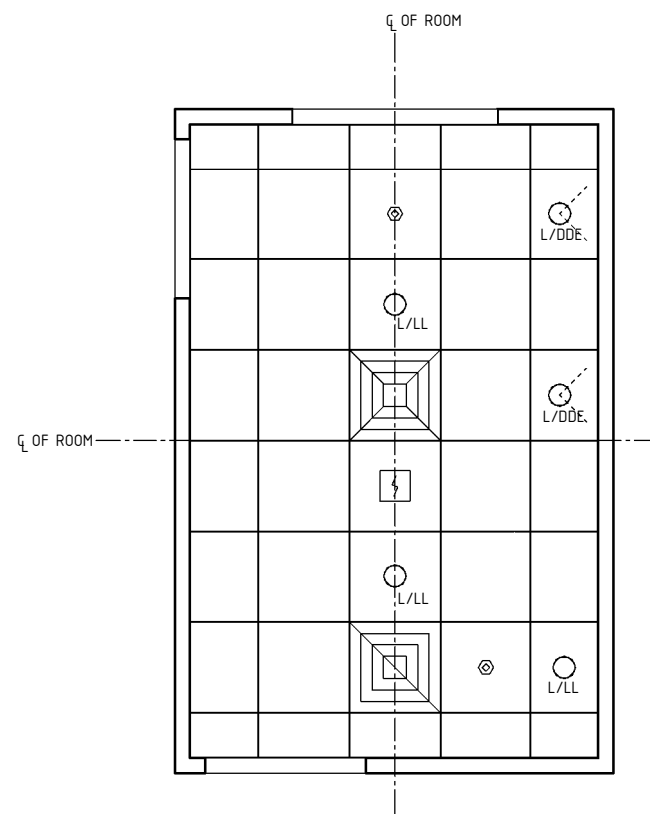
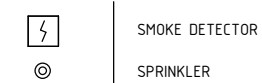

**REFLECTED CEILING PLAN**

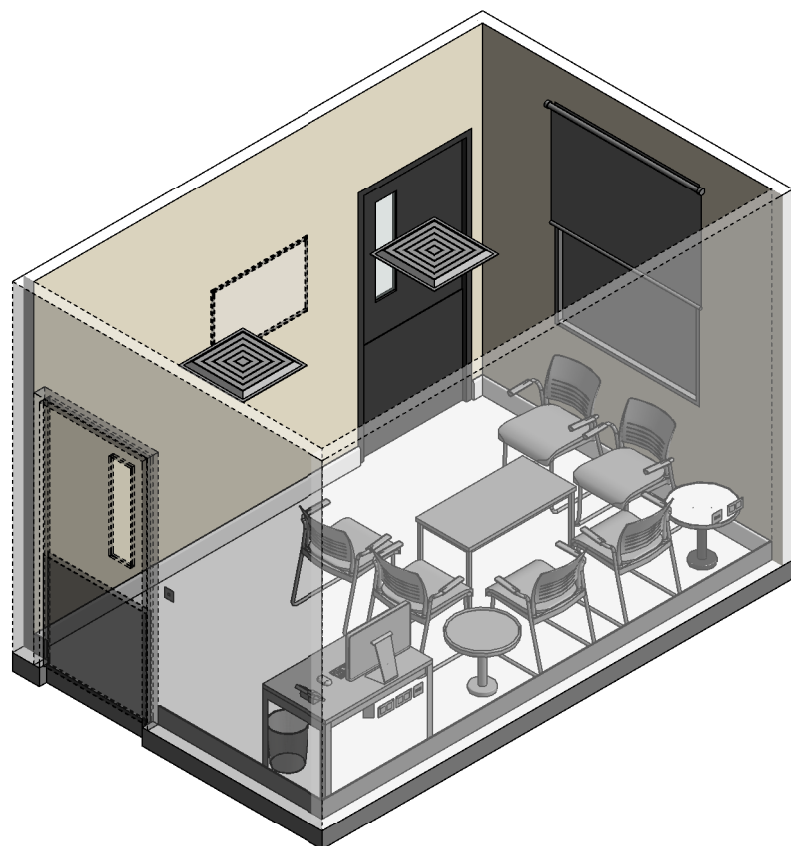

**ISOMETRIC VIEW 01**

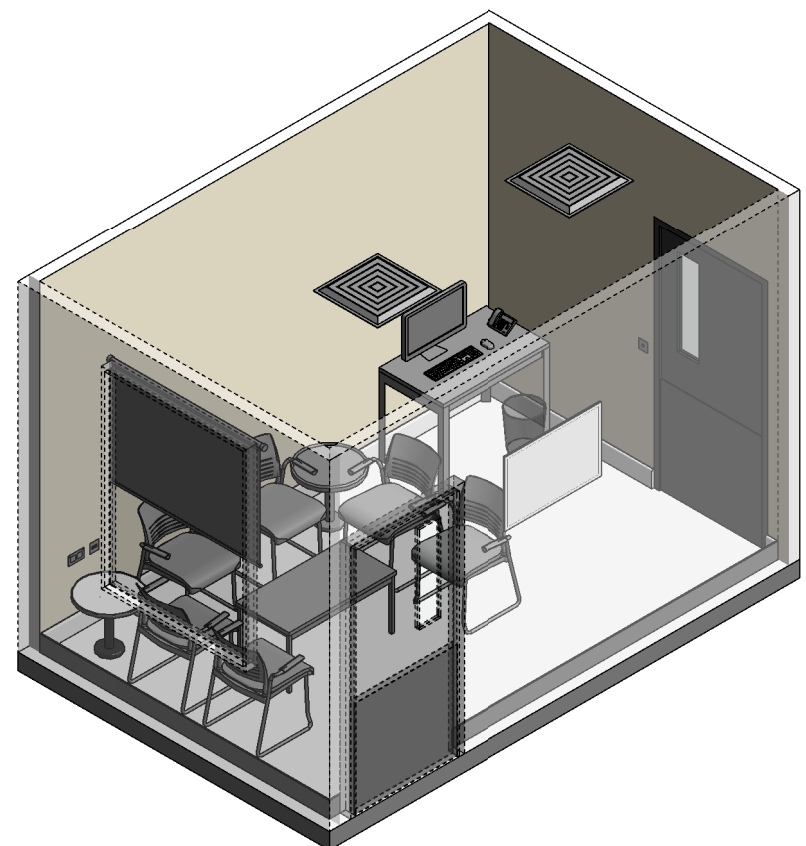

**ISOMETRIC VIEW 02**

REV	DESCRIPTION	DATE	BY	REV	DESCRIPTION	DATE	BY	COMPATIBILITY
1	FIRST ISSUE	24.10.14	NB					
2	GENERAL REVISION	31.08.22	RA					

<b>International Health Facility Guidelines</b>	International Health Facility Guidelines at: <a href="http://www.healthdesign.com.au/iHFG">www.healthdesign.com.au/iHFG</a> Editable version of Standard Components on Health Facility Briefing System (HFBS) at: <a href="http://www.healthdesign.com.au">www.healthdesign.com.au</a> @TAHPI			DESIGNED	APPROVED	DATE	SCALE(S)	SHEET
	RA	RH		31.08.22	1 : 50	2 OF 2		
				REVIT FILE NAME	PAPER DRAWING ID		ISSUE	
				intf-i	intf-i-2		2	