

iHFG Standard Components

Room Layout Sheet

Room Name Lounge - Adolescent, 10m2

RLS Room Code

Inad-10-i

RDS Room Code

Inad-10-i

BLR	BLIND - ROLLER
BRCTVW	BRACKET - TELEVISION, WALL MOUNTED
CHR/E	CHAIR - ERGONOMIC, OFFICE
CHR/V	CHAIR - VISITOR
CMP	COMPUTER
COM/2	COMMUNICATION OUTLET - DOUBLE
COM/IPTV	COMMUNICATION OUTLET - INTERNET PROTOCOL TELEVISION
CPT	CARPET
DFP	DOOR AND DOOR FRAME PROTECTION
DGL	DOUBLE GLAZED
DK	DESK
EC	EMERGENCY CALL
LO/2	LOUNGE - 2 SEAT
LS/R	LIGHT SWITCH - ROOM
OWIN	OBSERVATION WINDOW
PC	PATIENT CALL
PCH	PATIENT CALL HANDSET
PO/1	POWER OUTLET - SINGLE
PO/2	POWER OUTLET - DOUBLE
SAC	STAFF ASSIST CALL
SHL	SHELF - LAMINATED
SK7	TIMBER SKIRTING
TB/L	TABLE - LOW
TV	TELEVISION
WPF	WALL PAINT FINISH

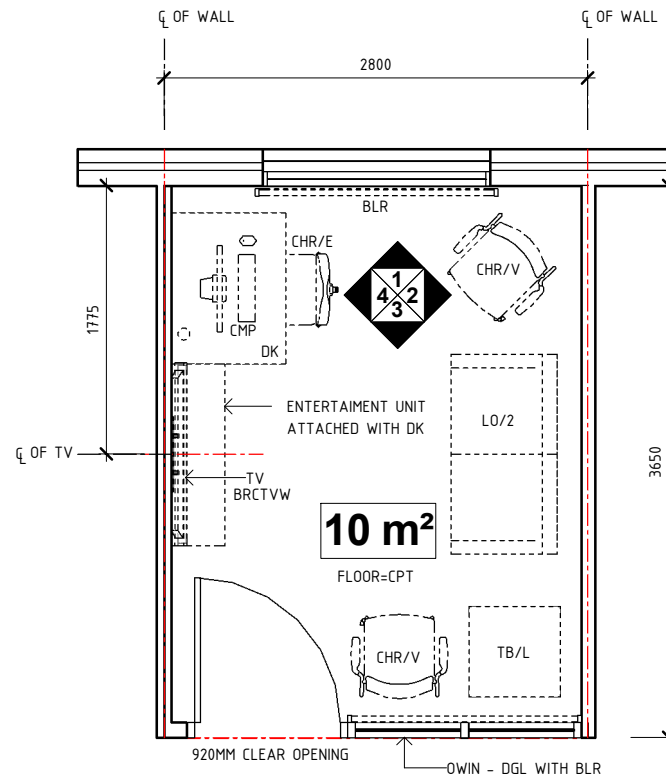

PLAN

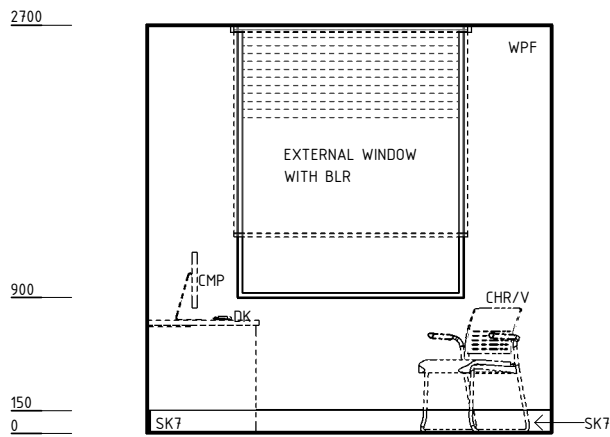

ELEVATION 1

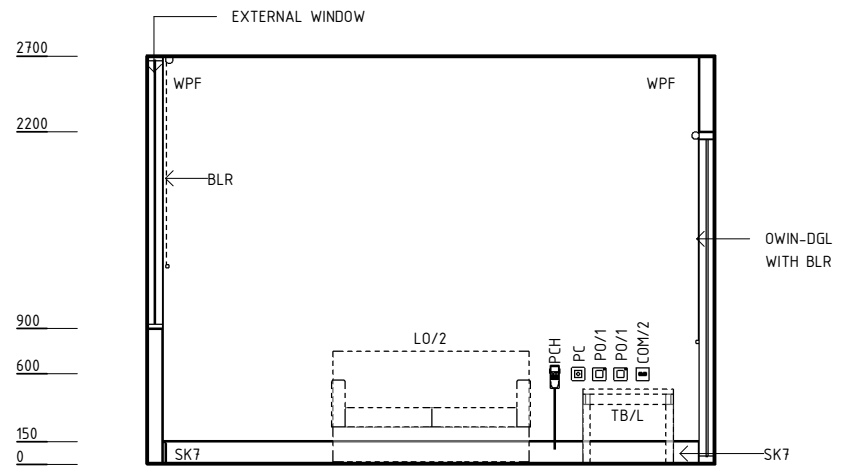

ELEVATION 2

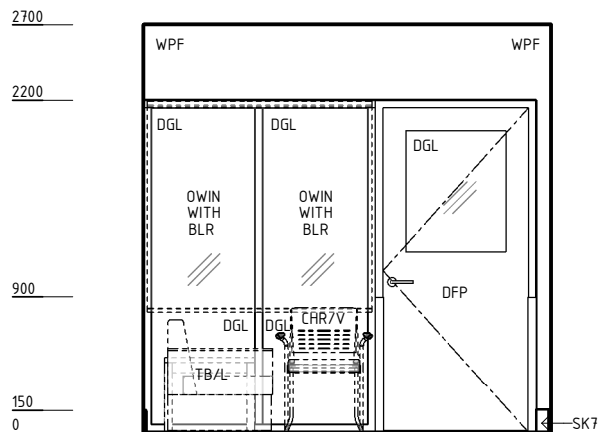

ELEVATION 3

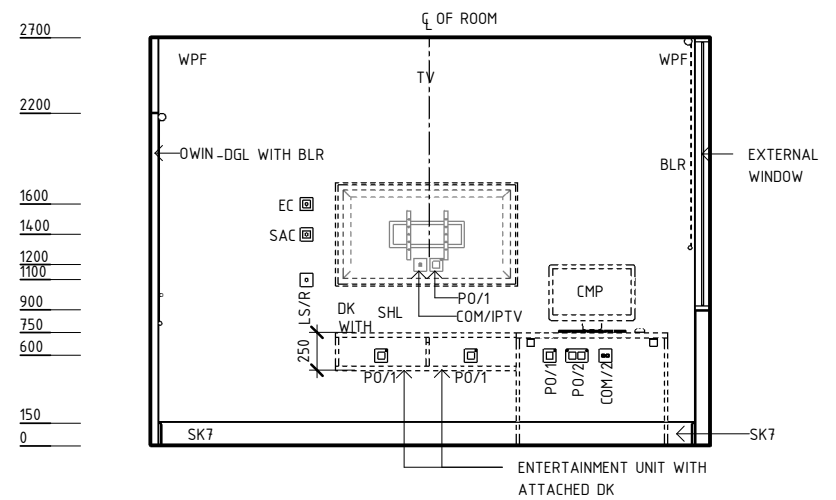

ELEVATION 4

REV	DESCRIPTION	DATE	BY	REV	DESCRIPTION	DATE	BY	COMPATIBILITY
1	FIRST ISSUE	24.10.10	LL	4	GENERAL REVISION	27.01.23	SS	iHFG
2	GENERAL REVISION	30.08.11	SK					
3	GENERAL REVISION	31.10.12	CT					



International Health Facility Guidelines at:
www.healthdesign.com.au/iHFG
 Editable version of Standard Components on
 Health Facility Briefing System (HFBS) at:
www.healthdesign.com.au@TAHPI



DESIGNED	APPROVED	DATE	SCALE(S)	SHEET
SS	SA	25.05.23	1 : 50	1 OF 2
REVIT FILE NAME		PAPER DRAWING ID		ISSUE
Inad-10-i		Inad-10-i-1		4

iHFG Standard Components

Room Layout Sheet

RLS Room Code

Inad-10-i

Room Name

Lounge - Adolescent, 10m2

RDS Room Code

Inad-10-i

GENERAL NOTES:

THIS DRAWING TO BE READ IN CONJUNCTION WITH R.D.S. (ROOM DATA SHEETS) WHICH TAKES PRECEDENCE.

ALL SERVICES INDICATED ARE INDICATIVE AND SUBJECTED TO DETAILED PROJECT SPECIFIC ENGINEERING DESIGN.

CEILING LEGEND:

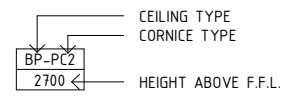

ACT-PC4
ACOUSTIC CEILING TILES WITH SHADOW ANGLE, POWDERCOAT ALUMINIUM CORNICE

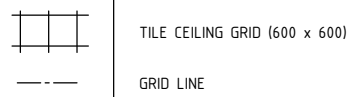

ELECTRICAL LEGEND:

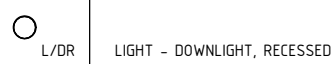

MECHANICAL LEGEND:

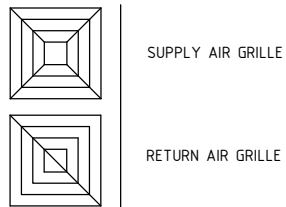

FIRE SERVICES LEGEND:

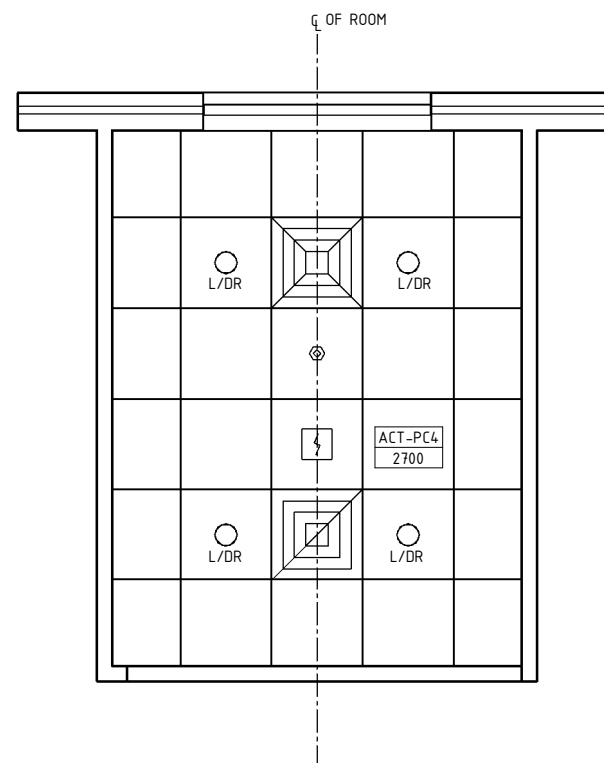
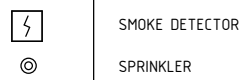

REFLECTED CEILING PLAN

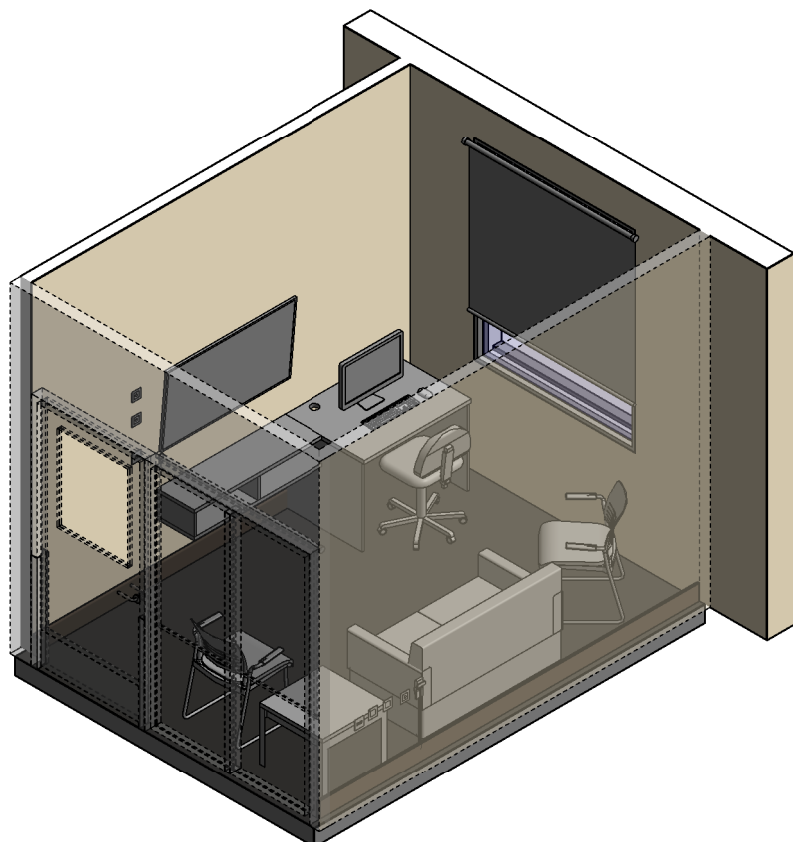

ISOMETRIC VIEW 01

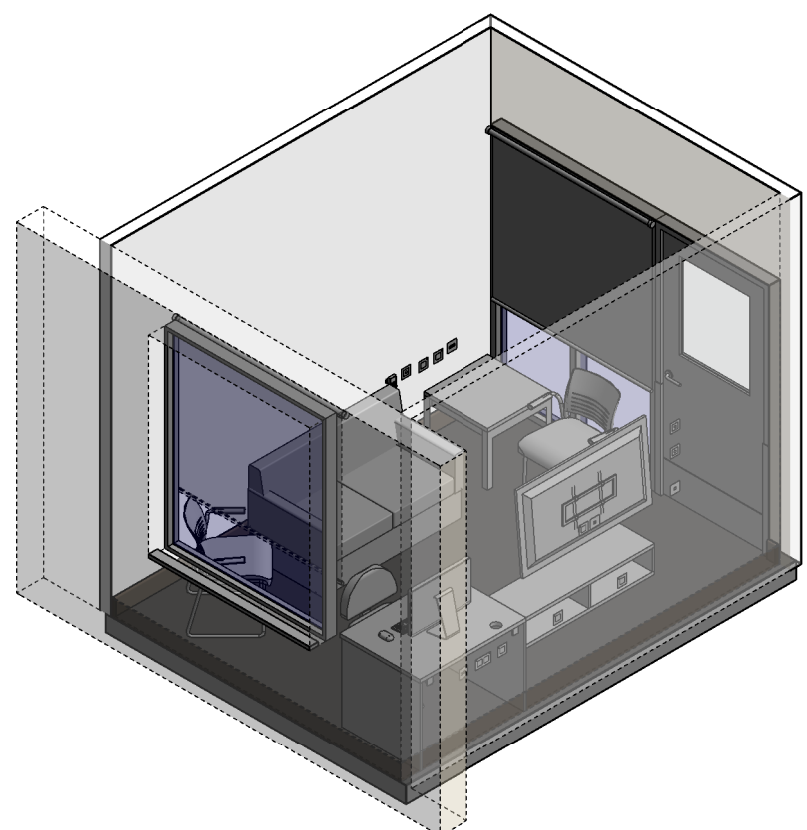

ISOMETRIC VIEW 02

REV	DESCRIPTION	DATE	BY	REV	DESCRIPTION	DATE	BY	COMPATIBILITY																				
1	FIRST ISSUE	24.10.10	LL	4	GENERAL REVISION	27.01.23	SS																					
2	GENERAL REVISION	30.08.11	SK																									
3	GENERAL REVISION	31.10.12	CT																									
International Health Facility Guidelines www.healthdesign.com.au/iHFG Editable version of Standard Components on Health Facility Briefing System (HFBS) at: www.healthdesign.com.au ©TAHPI								<table border="1"> <tr> <th>DESIGNED</th> <th>APPROVED</th> <th>DATE</th> <th>SCALE(S)</th> <th>SHEET</th> </tr> <tr> <td>SS</td> <td>SA</td> <td>25.05.23</td> <td>1 : 50</td> <td>2 OF 2</td> </tr> <tr> <td colspan="2">REVIT FILE NAME</td> <td colspan="2">PAPER DRAWING ID</td> <td>ISSUE</td> </tr> <tr> <td colspan="2">Inad-10-i</td> <td colspan="2">Inad-10-i-2</td> <td>4</td> </tr> </table>	DESIGNED	APPROVED	DATE	SCALE(S)	SHEET	SS	SA	25.05.23	1 : 50	2 OF 2	REVIT FILE NAME		PAPER DRAWING ID		ISSUE	Inad-10-i		Inad-10-i-2		4
DESIGNED	APPROVED	DATE	SCALE(S)	SHEET																								
SS	SA	25.05.23	1 : 50	2 OF 2																								
REVIT FILE NAME		PAPER DRAWING ID		ISSUE																								
Inad-10-i		Inad-10-i-2		4																								

This document is for advisory purpose only