

iHFG Standard Components

Room Layout Sheet

RLS Room Code

Inpt-20-i

RDS Room Code

Inpt-20-i

Room Name

Lounge - Patient, 20m2

AW	ARTWORK
BKC	BOOKCASE
BLR	BLIND - ROLLER
BRCTVW	BRACKET - TELEVISION, WALL MOUNTED
COM/2	COMMUNICATION OUTLET - DOUBLE
COM/IPTV	COMMUNICATION OUTLET - INTERNET PROTOCOL TELEVISION
CPT	CARPET
DFP	DOOR AND DOOR FRAME PROTECTION
EC	EMERGENCY CALL
LO/1	LOUNGE - 1 SEAT
LS/DD	LIGHT SWITCH - DOWNLIGHT DIMMER
LS/R	LIGHT SWITCH - ROOM
OP	OBSERVATION PANEL
OWIN	OBSERVATION WINDOW
PC	PATIENT CALL
PCH	PATIENT CALL HANDSET
PO/1	POWER OUTLET - SINGLE
PO/2	POWER OUTLET - DOUBLE
PO/C	POWER OUTLET - CLEANER'S
SAC	STAFF ASSIST CALL
SK7	TIMBER SKIRTING
TB/L	TABLE - LOW
TP/HS	TELEPHONE - HANDSET, STANDARD
TV	TELEVISION
V1	VINYL FLOORING, STANDARD SLIP RESISTANT
WBF/20	WASTE BIN - FLIPTOP, 20L
WCH	WHEELCHAIR
WPF	WALL PAINT FINISH

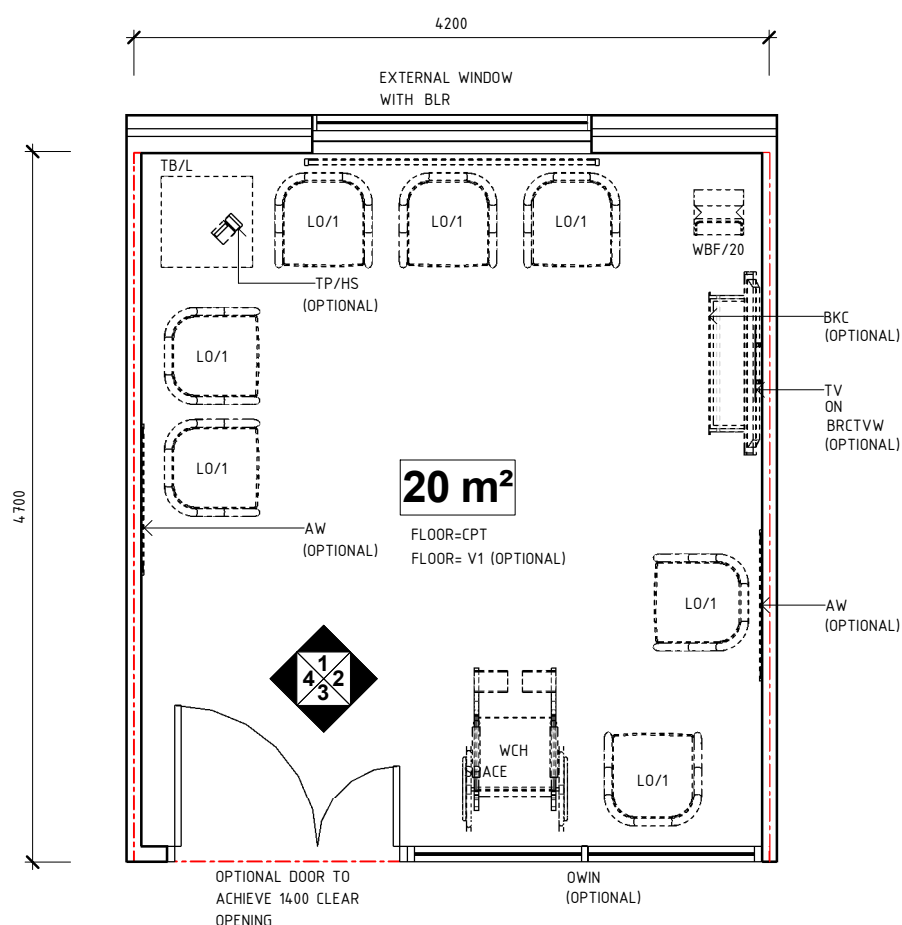

PLAN

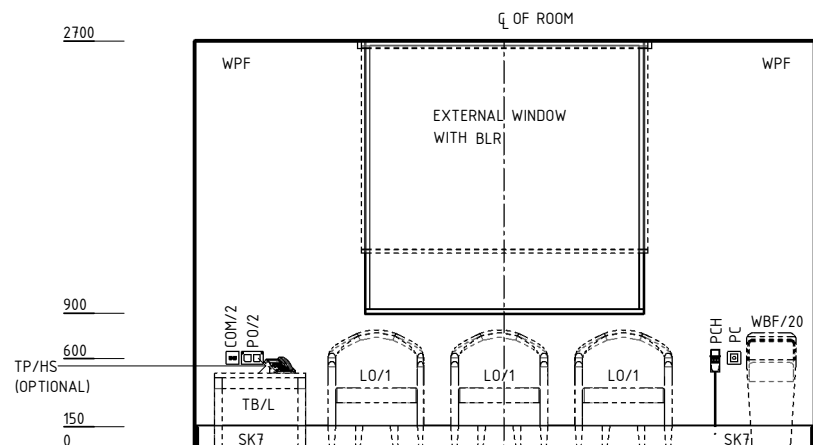

ELEVATION 1

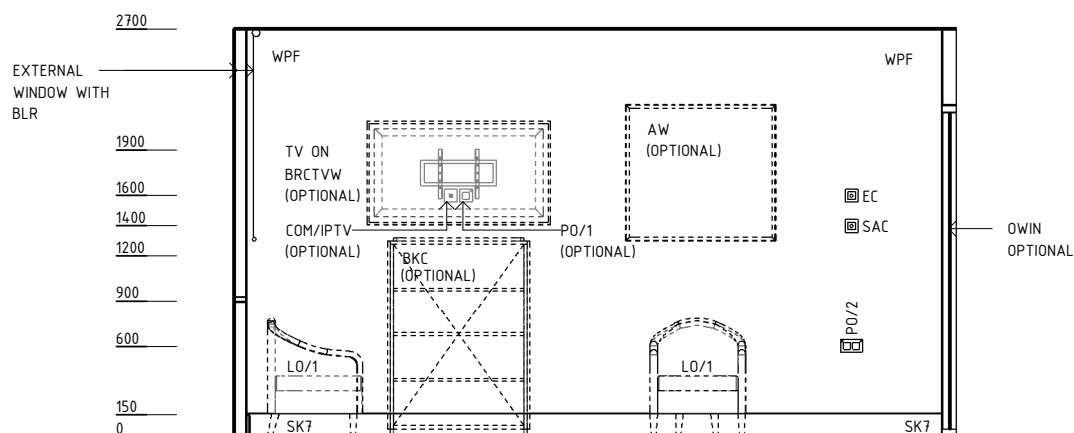

ELEVATION 2

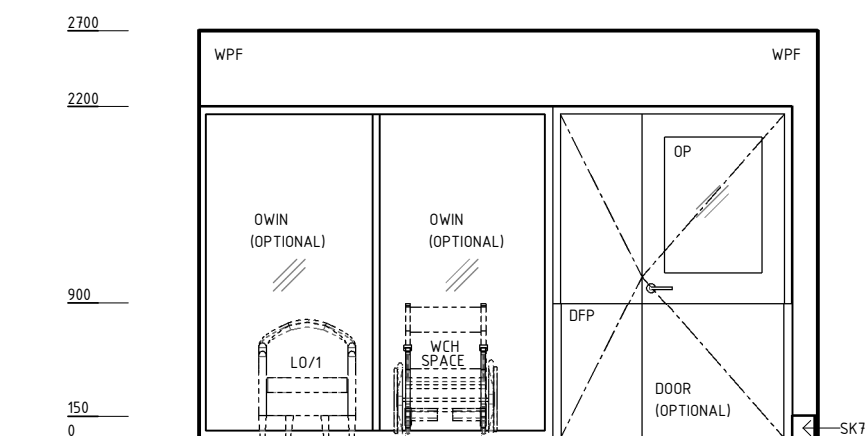

ELEVATION 3

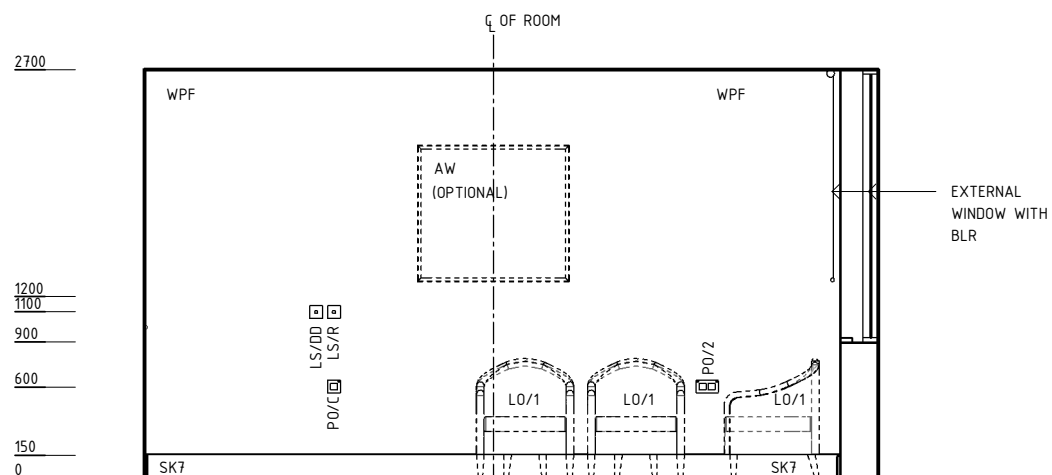

ELEVATION 4

REV	DESCRIPTION	DATE	BY	REV	DESCRIPTION	DATE	BY	COMPATIBILITY
1	FIRST ISSUE	07.01.15	NB					
2	GENERAL REVISION	27.01.23	SS					

iHFG Standard Components

Room Layout Sheet

RLS Room Code

Inpt-20-i

RDS Room Code

Inpt-20-i

Room Name | Lounge - Patient, 20m2

GENERAL NOTES:

THIS DRAWING TO BE READ IN CONJUNCTION WITH R.D.S. (ROOM DATA SHEETS) WHICH TAKES PRECEDENCE.

ALL SERVICES INDICATED ARE INDICATIVE AND SUBJECT TO DETAILED PROJECT SPECIFIC ENGINEERING DESIGN.

CEILING LEGEND:

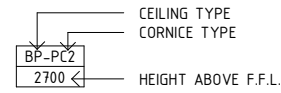

CEILING TYPE
CORNICE TYPE

HEIGHT ABOVE F.F.L.

ACT-PC4

ACOUSTIC CEILING TILES WITH SHADOW ANGLE POWDERCOAT ALUMINIUM CORNICE



TILE CEILING GRID (600 x 600)



GRID LINE

ELECTRICAL LEGEND:



LIGHT - DOWNLIGHT, DIMMABLE



LIGHT - LED LIGHT

MECHANICAL LEGEND:



SUPPLY AIR GRILLE



RETURN AIR GRILLE

FIRE SERVICES LEGEND:



SMOKE DETECTOR



SPRINKLER

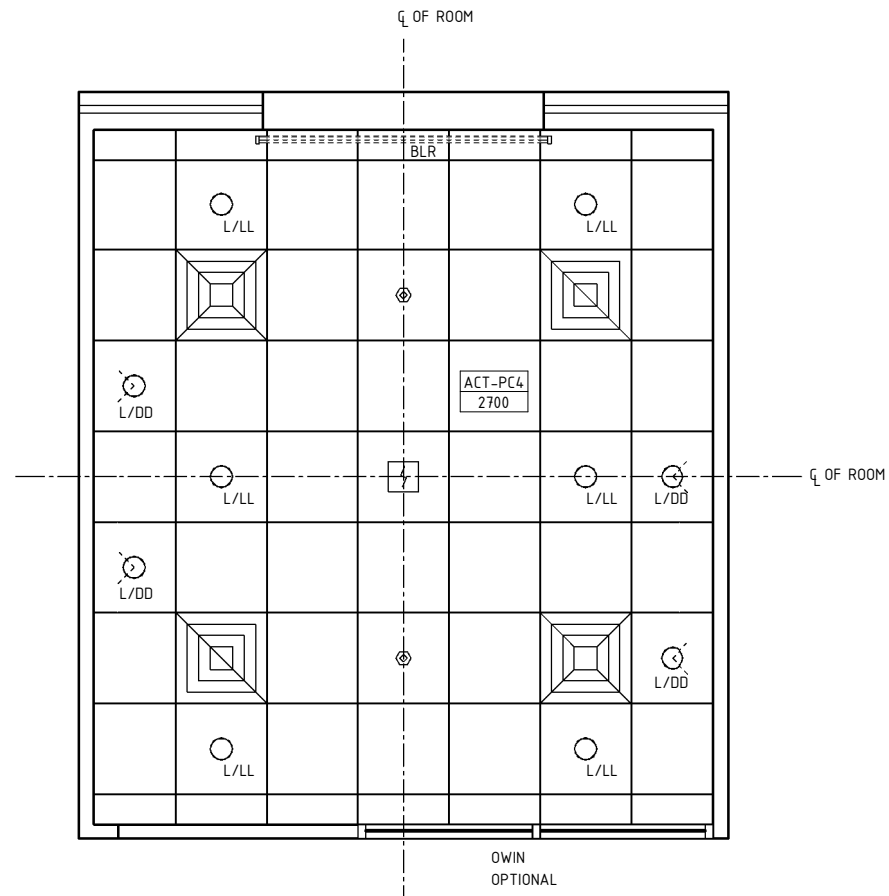

REFLECTED CEILING PLAN

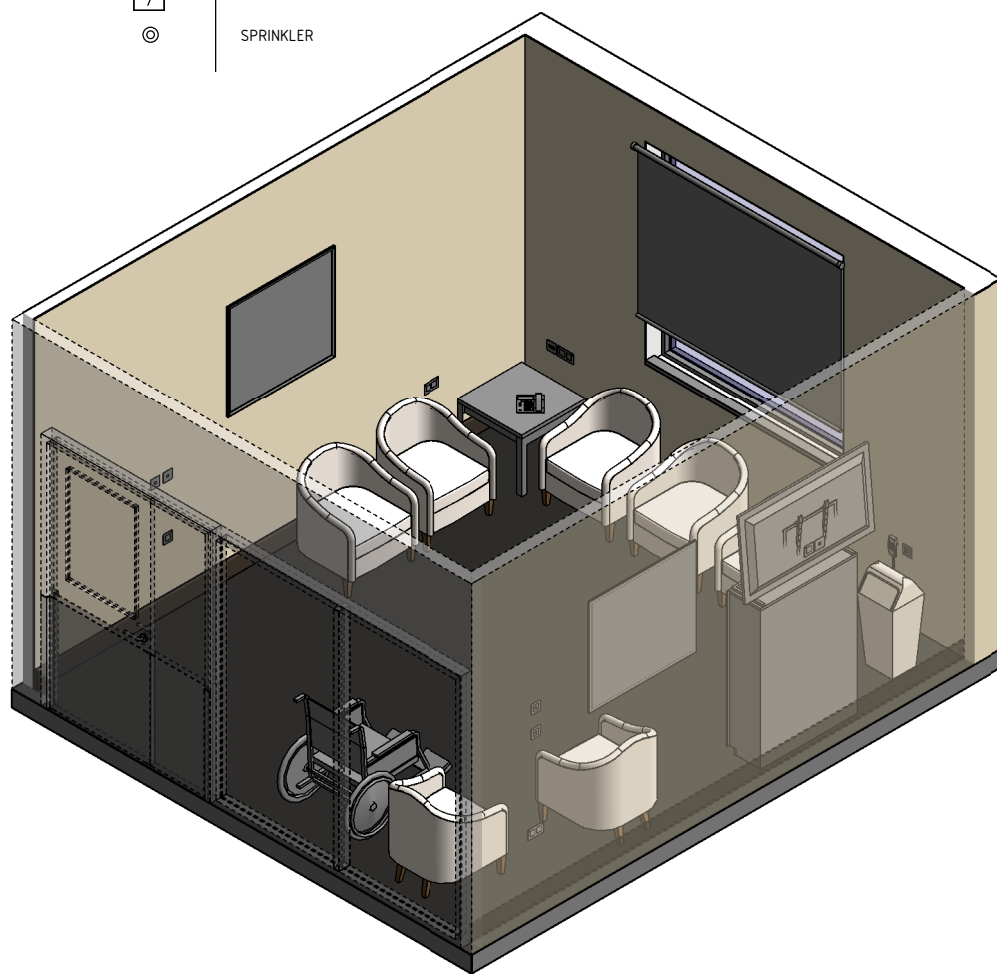

ISOMETRIC VIEW 01

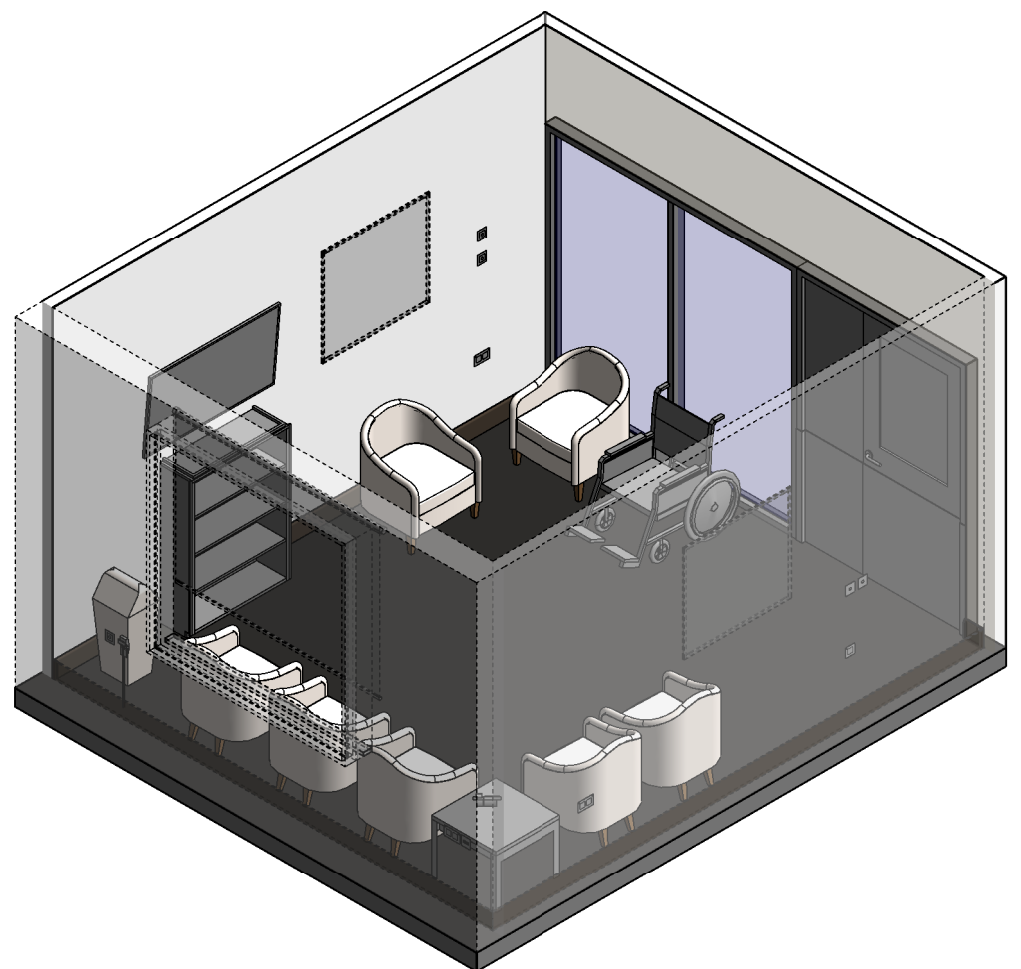

ISOMETRIC VIEW 02

REV	DESCRIPTION	DATE	BY	REV	DESCRIPTION	DATE	BY	COMPATIBILITY
1	FIRST ISSUE	07.01.15	NB					
2	GENERAL REVISION	27.01.23	SS					

iHFG International Health Facility Guidelines

International Health Facility Guidelines at:
www.healthdesign.com.au/iHFG
Editable version of Standard Components on
Health Facility Briefing System (HFBS) at:
www.healthdesign.com.au ©TAHPI



DESIGNED	APPROVED	DATE	SCALE(S)	SHEET
SS	SA	27.01.23	1 : 50	2 OF 2
REVIT FILE NAME		PAPER DRAWING ID		ISSUE
Inpt-20-i		Inpt-20-i-2		2