

iHFG Standard Components

Room Layout Sheet

Room Name Meeting Room - Small, 12m²

RLS Room Code MEET-12-I

RDS Room Code MEET-12-I

Abbreviations

C/BO	CLOCK - BATTERY OPERATED
CHR/M	CHAIR - MEETING ROOM
COM/1	COMMUNICATION OUTLET - SINGLE
COM/2	COMMUNICATION OUTLET - DOUBLE
DA	DURESS ALARM
DFP	DOOR AND DOOR FRAME PROTECTION
DP	DOOR AND DOOR FRAME PROTECTION
GPO/2	GENERAL POWER OUTLET - DOUBLE
GPO/C	GENERAL POWER OUTLET - CLEANER'S
LS/D	LIGHT SWITCH - DIMMER
LS/R	LIGHT SWITCH - ROOM
MATV	MASTER ANTENNA TV
TB/M	TABLE- MEETING
TP/WM	TELEPHONE - WALL MOUNTED
WB	WHITEBOARD
WBP/20	WASTE BIN - PAPER - 20 LITRE
SK7	TIMBER SKIRTING
WPF	WALL PAINT FINISH
CPT	CARPET

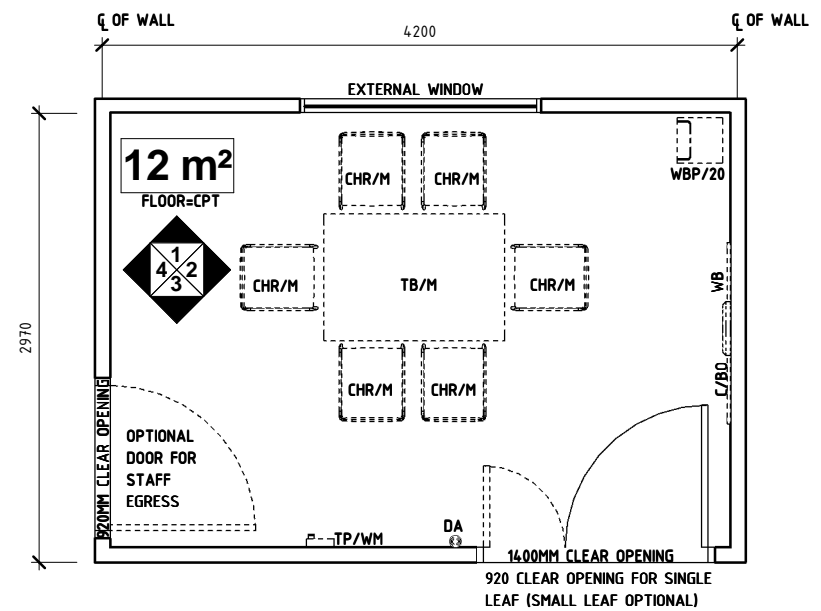

PLAN

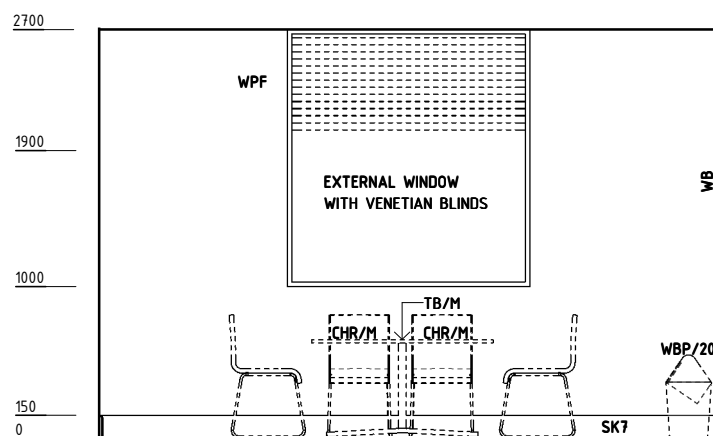

ELEVATION 1

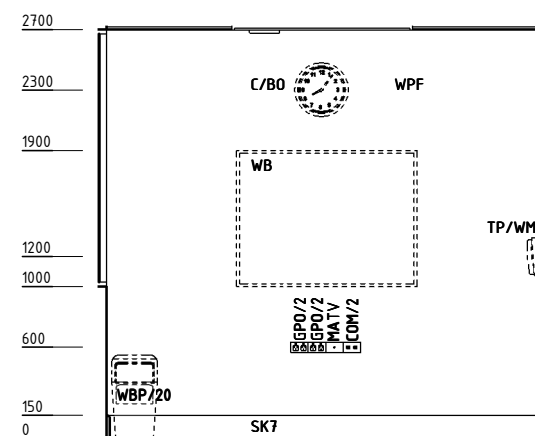

ELEVATION 2

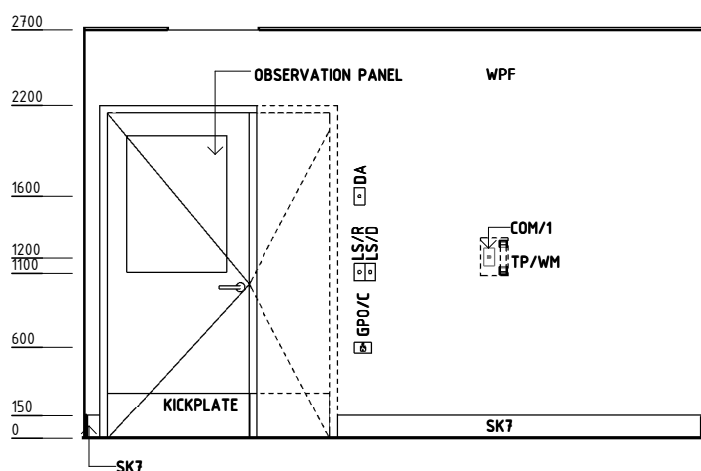

ELEVATION 3

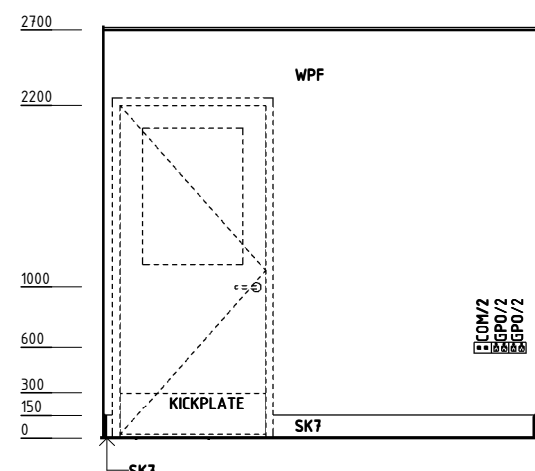

ELEVATION 4

REV	DESCRIPTION	DATE	BY	REV	DESCRIPTION	DATE	BY	REV	DESCRIPTION	DATE	BY
1	FIRST ISSUE #	26.06.2015	NB								

iHFG Standard Components

Room Layout Sheet

Room Name | Meeting Room - Small, 12m²

RLS Room Code MEET-12-I
RDS Room Code MEET-12-I

GENERAL NOTES:

THIS DRAWING TO BE READ IN CONJUNCTION WITH R.D.S. (ROOM DATA SHEETS) WHICH TAKES PRECEDENCE.

ALL SERVICES INDICATED ARE INDICATIVE AND SUBJECT TO DETAILED PROJECT SPECIFIC ENGINEERING DESIGN.

CEILING LEGEND:

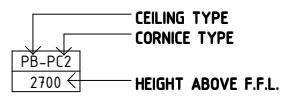

ACT-PC4 ACOUSTIC CEILING TILES WITH POWDERCOAT ALUMINIUM CORNICE, SHADOW LINE

TILE CEILING GRID (1200 x 600)

ELECTRICAL LEGEND:

L/DD LIGHTING - DOWNLIGHT, DIMMABLE

L/GF LIGHTING - GENERAL FLUORESCENT

MECHANICAL LEGEND:

SUPPLY AIR GRILLE

RETURN AIR OR TRANSFER GRILLE

FIRE SERVICES LEGEND:

SMOKE DETECTOR

SPRINKLER

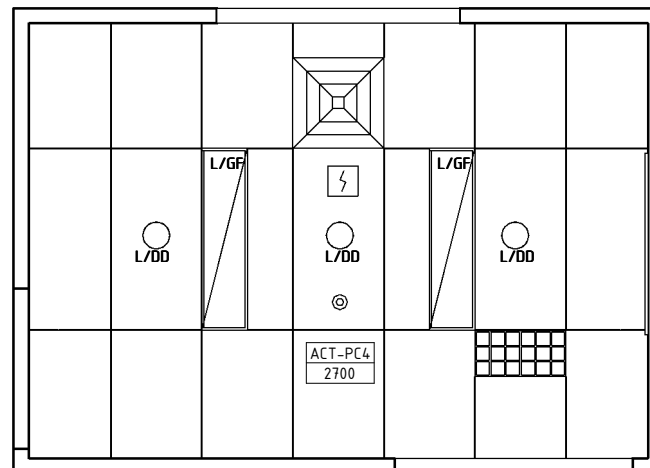

REFLECTED CEILING PLAN

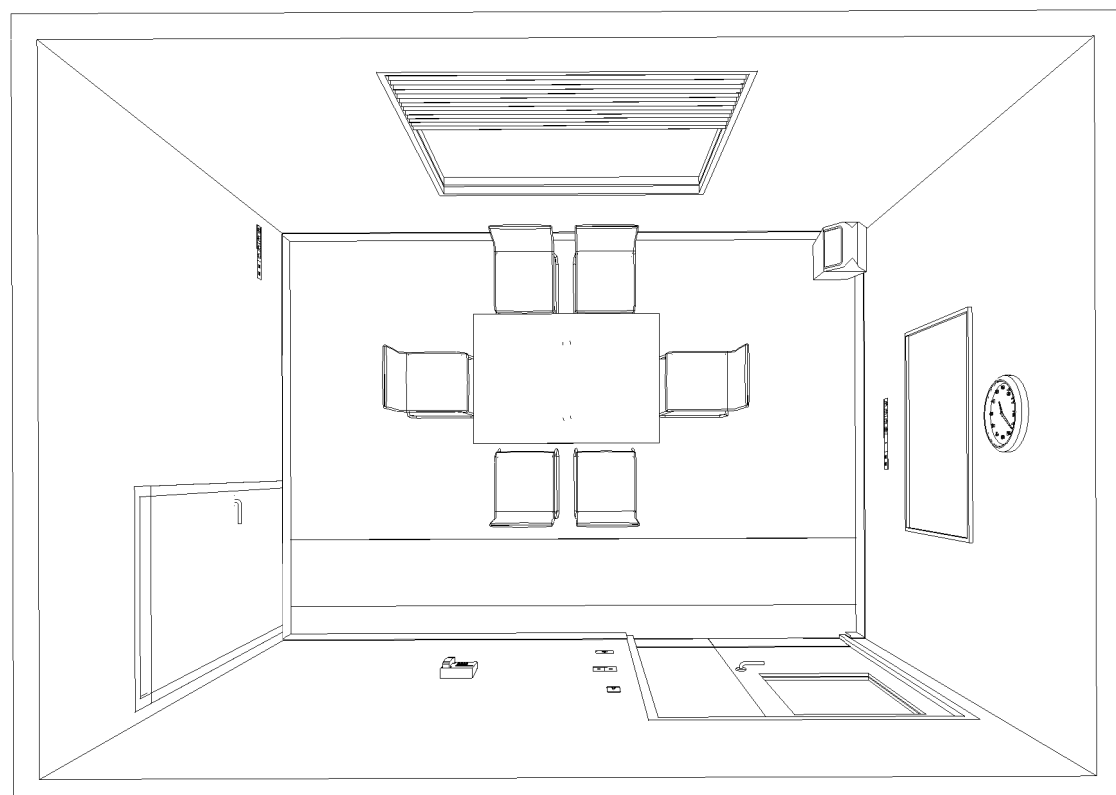

PERSPECTIVE - PLAN VIEW

REV	DESCRIPTION	DATE	BY	REV	DESCRIPTION	DATE	BY	REV	DESCRIPTION	DATE	BY
1	FIRST ISSUE #	26.06.2015	NB								

iHFG Standard Components

Room Layout Sheet

Room Name | Meeting Room - Small, 12m²

RLS Room Code MEET-12-I
RDS Room Code MEET-12-I

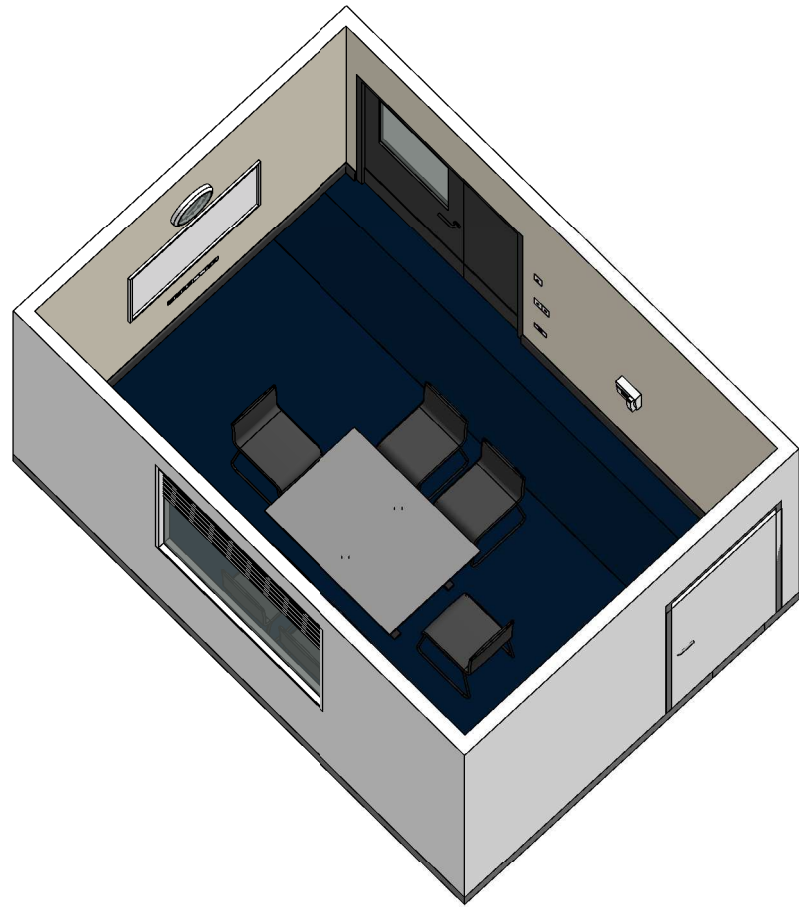

ISOMETRIC VIEW 01

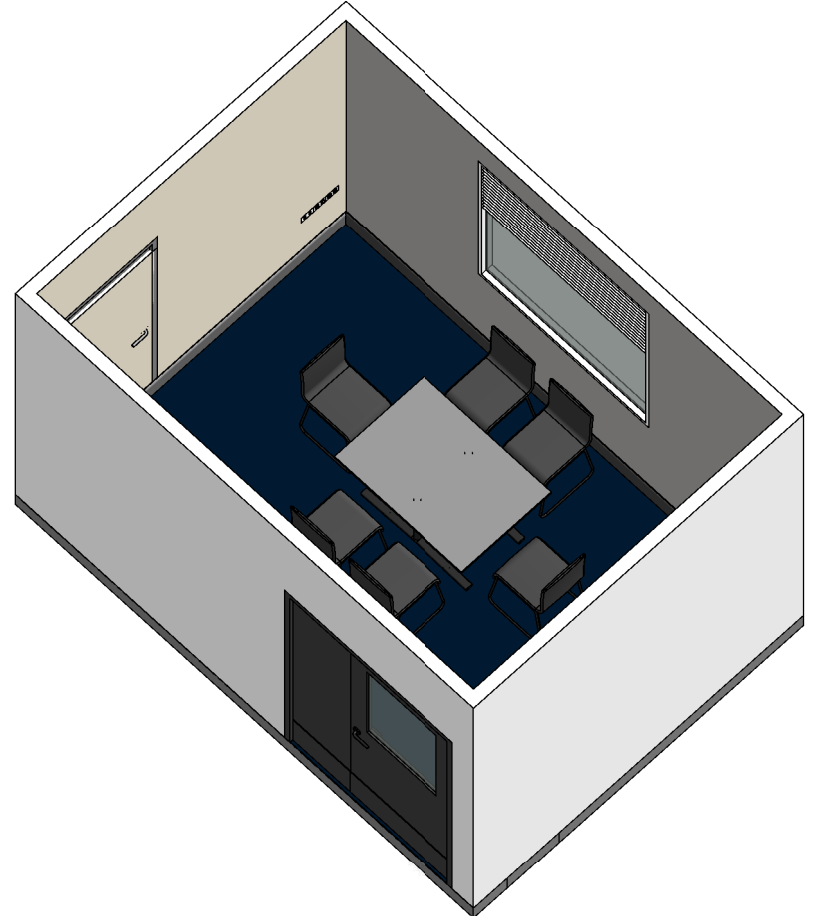

ISOMETRIC VIEW 02



PERSPECTIVE 01

REV	DESCRIPTION	DATE	BY	REV	DESCRIPTION	DATE	BY	REV	DESCRIPTION	DATE	BY
1	FIRST ISSUE #	26.06.2015	NB								



The International Health Facility Guidelines recommends the use of HFBS “Health Facility Briefing System” to edit all room data sheet information for your project.

HFBS provides edit access to all iHFG standard rooms, and departments, and more than 100 custom report templates.

HFBS Health Facility Briefing System



Briefing Module

The Health Facility Briefing System (HFBS) has numerous modules available via annual subscription. It suits healthcare Architects, Medical Planners, Equipment Planners Project Managers and Health Authorities.

Use the HFBS Briefing Module to quickly drag in health facility departments or pre-configured room templates from the iHFG standard, edit the room features such as finishes, furniture, fittings, fixtures, medical equipment, engineering services. The system can print or download as PDF more than 100 custom reports including room data sheets, schedules, and more...

To learn more about the HFBS web-based Healthcare Briefing and Design Software and to obtain editable versions of the “Standard Components” including Room Data Sheets (RDS) and Room Layout Sheets (RLS) offered on the iHFG website, signup for HFBS using the link below.

Get Started Now:
hfbs.healthdesign.com.au

- ✓ iHFG Room Data Sheets and Departments are instantly editable in the HFBS software available online.
- ✓ You can access hundreds of report templates to print your iHFG room data in HFBS.
- ✓ HFBS has a onetime free 3 day trial available to all new users.

Get Started Now:
hfbs.healthdesign.com.au



HFBS

Health Facility Briefing System

hfbsinfo.com | techsupport@healthdesign.com.au