

iHFG Standard Components

Room Layout Sheet

RLS Room Code

nb-is-p-i

RDS Room Code

nb-is-p-i

Room Name Neonatal Bay - Isolation Room - Positive Pressure

BLVI	BLIND - VENETIAN, INTEGRAL
BNL	BENCH - LAMINATE
BRCS	BRACKET - SHARPS
BRCSB	BRACKET - SUCTION BOTTLE
CARP	CARDIAC PROTECTED
CBD/W	CUPBOARD - WALL MOUNTED
CBS	CURTAIN - BED SCREEN
CG	CORNER GUARD
CHR/RE	CHAIR - RECLINER, ELECTRIC
CHR/V	CHAIR - VISITOR
CR	CRASH RAIL
CTBS	CURTAIN TRACK - BED SCREEN
DDG	DISPENSER - DISPOSABLE GLOVES
DHS	DISPENSER - HAND SANITISER
DHT	DISPENSER - PAPER HAND TOWEL
DSA	DISPENSER - SOAP, ANTISEPTIC
HWB/A	HAND WASH BASIN - TYPE 'A'
INC/IN	INCUBATOR - INFANT
IVP	IV POLE
L/EXC	LIGHT - EXAMINATION, CEILING MOUNTED
L/PT	LIGHT - PELMET TASK LIGHT
LIND/S	LINEN CARRIER - DIRTY, SINGLE
LM/PN	LAMP - PHOTOTHERAPY, NEONATAL
PE	PENDANT
PU/IN1	PUMP - INFUSION, SINGLE
SB	SUCTION BOTTLE
SBIN	SHARPS BIN
STAM	STOOL - ADJUSTABLE, MOBILE
T/PR	TROLLEY - PROCEDURE
TAP/ST	TAPWARE - SENSOR TAP
TB/R	TABLE - ROUND
TP/HS	TELEPHONE - HANDSET, STANDARD
V1	VINYL FLOORING, STANDARD SLIP RESISTANT
V6	VINYL FLOORING, NON SLIP - TEXTURED
VR/NP	VENTILATOR - NEONATAL/PAEDIATRIC
WBC/50	WASTE BIN - CLINICAL, 50 LITRE
WBG	WASTE BIN - GENERAL

COM/2	COMMUNICATION OUTLET - DOUBLE
EC	EMERGENCY CALL
MA	MEDICAL AIR
MON/PCN	MONITOR: PHYSIOLOGIC, CRITICAL CARE, NEONATAL
O2	OXYGEN
PO/11	POWER OUTLET - SINGLE, CARDIAC PROTECTED / ISOLATED POWER
S	SUCTION
SAC	STAFF ASSIST CALL
TA/DC	TOOL AIR - DIRECT CONNECTION
VR/NP	Ventilator: Neonatal Pediatric

SUPPLY UNIT - PE

4 X COM/2
1 X EC
3 X MA
1 X MON/PCN
3 X O2
20 X PO/11
3 X S
1 X SAC
1 X TA/DC
1 X VR/NP

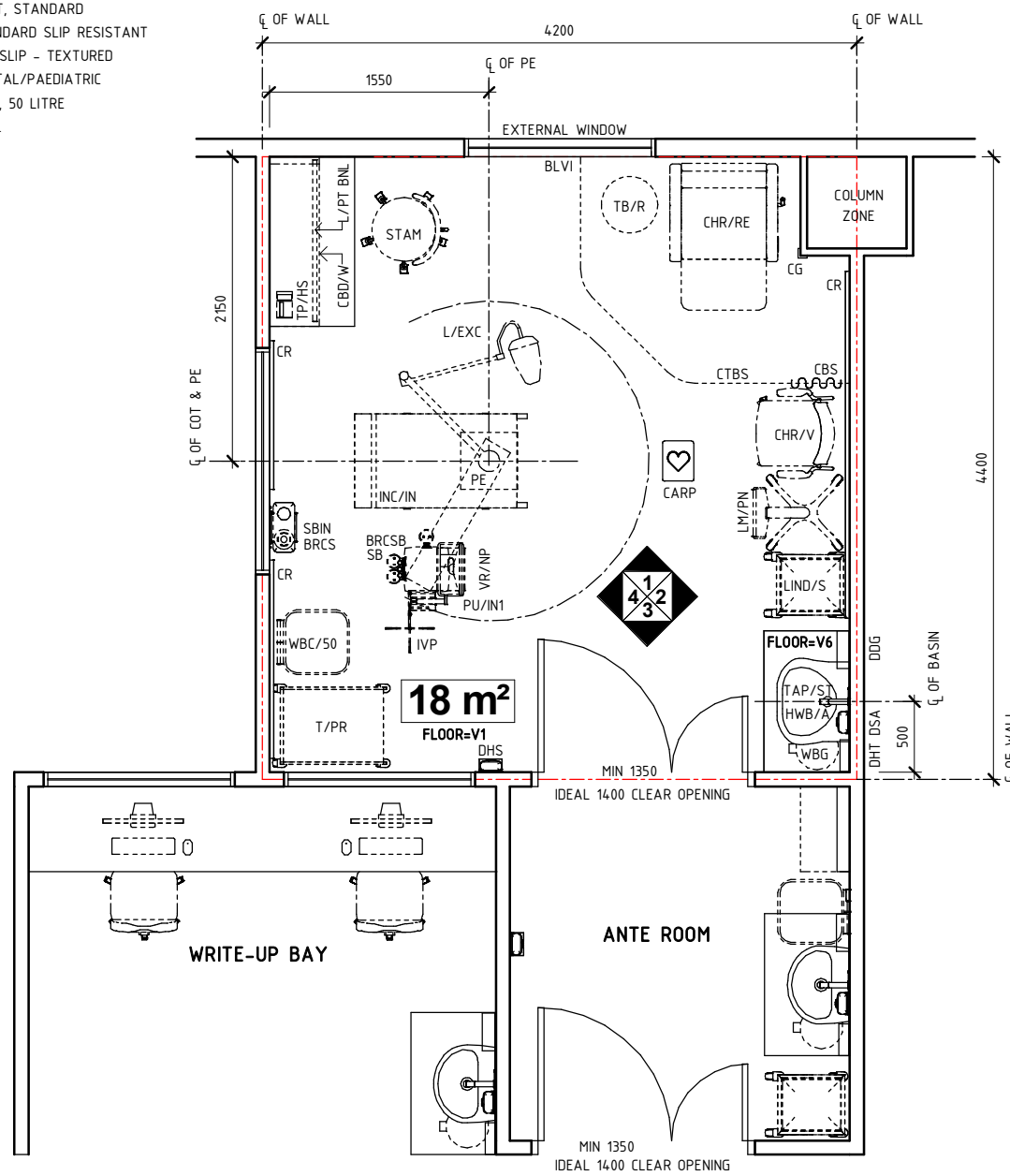

PLAN

REV	DESCRIPTION	DATE	BY	REV	DESCRIPTION	DATE	BY	COMPATIBILITY
1	FIRST ISSUE	15.05.22	AK					



International Health Facility Guidelines at:
www.healthdesign.com.au/iHFG
 Editable version of Standard Components on
 Health Facility Briefing System (HFBS) at:
www.healthdesign.com.au/TAHPI



DESIGNED	APPROVED	DATE	SCALE(S)	SHEET
AK	MM	15.05.22	1 : 50	1 OF 3
REVIT FILE NAME		PAPER DRAWING ID		ISSUE
nb-is-p-i		nb-is-p-i-1		1

iHFG Standard Components

Room Layout Sheet

RLS Room Code

nb-is-p-i

RDS Room Code

nb-is-p-i

Room Name Neonatal Bay - Isolation Room - Positive Pressure

BH/PB	BULKHEAD - PLASTERBOARD, PAINT FINISH
BLVI	BLIND - VENETIAN, INTEGRAL
BNL	BENCH - LAMINATE
BRCPM	BRACKET - PATIENT MONITOR
BRCS	BRACKET - SHARPS
CBD/D	CUPBOARD - DRAWER UNIT
CBD/UB	CUPBOARD - UNDER BENCH
CBD/W	CUPBOARD - WALL MOUNTED
CBS	CURTAIN - BED SCREEN
CG	CORNER GUARD
CHR/RE	CHAIR - RECLINER, ELECTRIC
CHR/V	CHAIR - VISITOR
COM/2	COMMUNICATION OUTLET - DOUBLE
CR	CRASH RAIL
CTBS	CURTAIN TRACK - BED SCREEN
DDG	DISPENSER - DISPOSABLE GLOVES
DFP	DOOR AND DOOR FRAME PROTECTION
DGL	DOUBLE GLAZED
DHS	DISPENSER - HAND SANITISER
DHT	DISPENSER - PAPER HAND TOWEL
DSA	DISPENSER - SOAP, ANTISEPTIC
HWB/A	HAND WASH BASIN - TYPE 'A'
INC/IN	INCUBATOR - INFANT
L/EXC	LIGHT - EXAMINATION, CEILING MOUNTED
L/PT	LIGHT - PELMET TASK LIGHT
LIND/S	LINEN CARRIER - DIRTY, SINGLE
LM/PN	LAMP - PHOTOTHERAPY, NEONATAL
LS/P	LIGHT SWITCH - PELMET TASK LIGHT
LS/R	LIGHT SWITCH - ROOM
MON/PCN	MONITOR - PHYSIOLOGIC, CRITICAL CARE, NEONATAL
OPV	OBSERVATION PANEL WITH INTEGRAL VENETIAN BLINDS
OWIN	OBSERVATION WINDOW
PE	PENDANT
PO/1	POWER OUTLET - SINGLE
PO/2	POWER OUTLET - DOUBLE
PO/C	POWER OUTLET - CLEANER'S
SBIN	SHARPS BIN
SBK	SPLASHBACK
SG	SAFETY GLASS
SK4	FLOOR VINYL COVED SKIRTING
STAM	STOOL - ADJUSTABLE, MOBILE
T/PR	TROLLEY - PROCEDURE
TAP/ST	TAPWARE - SENSOR TAP
TB/R	TABLE - ROUND
TG	TOUGHENED GLASS
TP/HS	TELEPHONE - HANDSET, STANDARD
VR/NP	VENTILATOR - NEONATAL/PAEDIATRIC
WBC/50	WASTE BIN - CLINICAL, 50 LITRE
WBG	WASTE BIN - GENERAL
WPF	WALL PAINT FINISH

SUPPLY UNIT - PE

- 4 X COM/2
- 1 X EC
- 3 X MA
- 1 X MON/PCN
- 3 X O2
- 20 X PO/1I
- 3 X S
- 1 X SAC
- 1 X TA/DC
- 1 X VR/NP

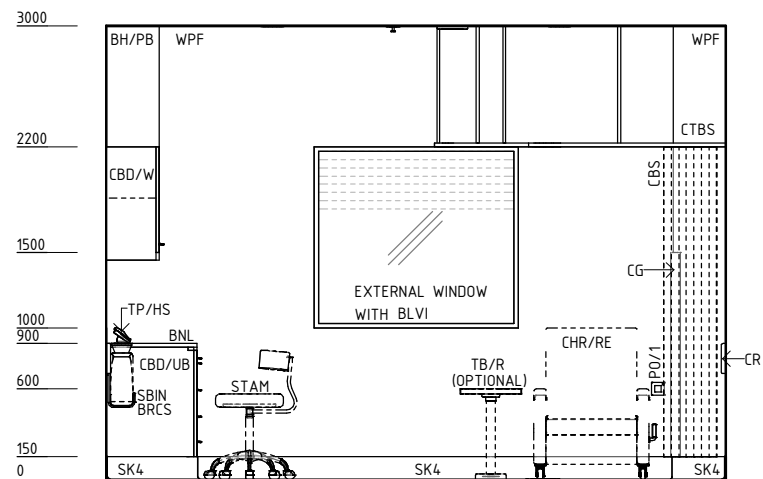

ELEVATION 1

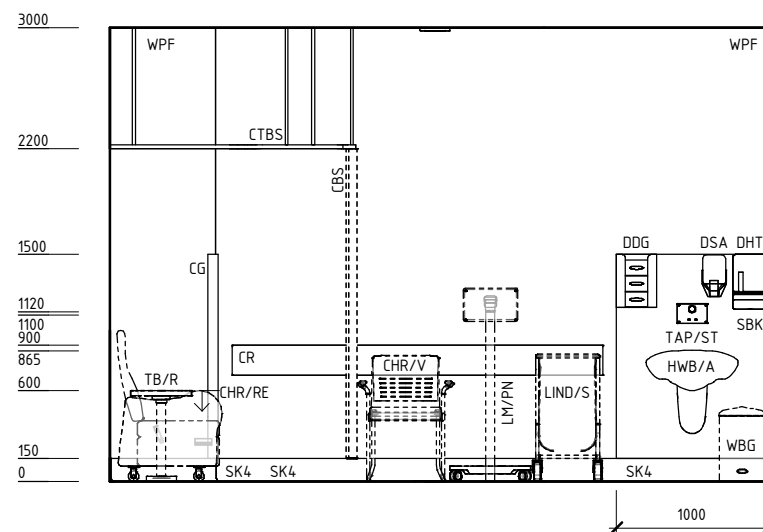

ELEVATION 2

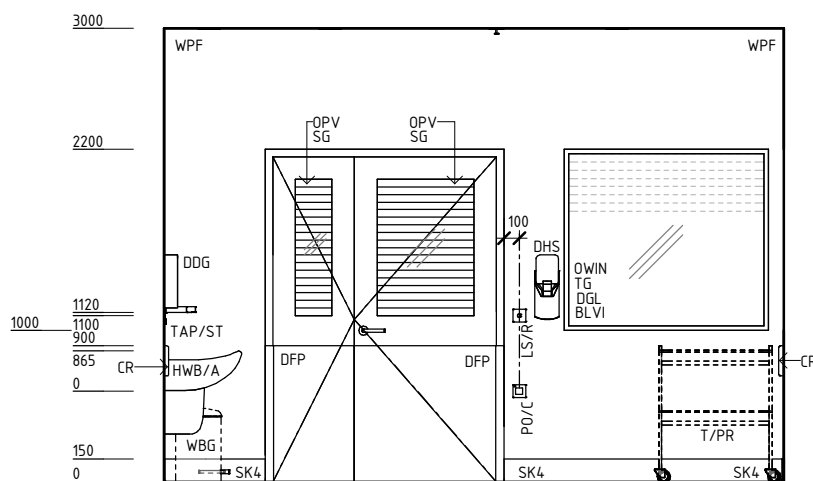

ELEVATION 3

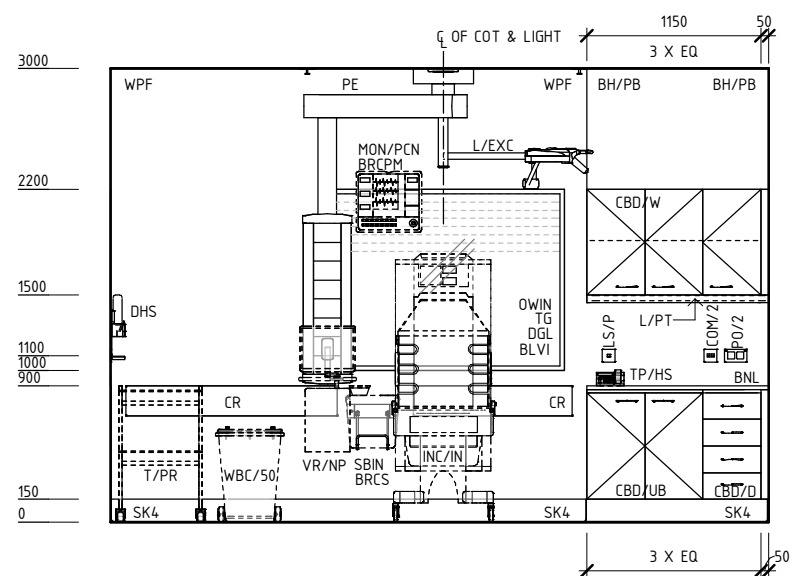

ELEVATION 4

REV	DESCRIPTION	DATE	BY	REV	DESCRIPTION	DATE	BY	COMPATIBILITY
1	FIRST ISSUE	15.05.22	AK					iHFG



International Health Facility Guidelines at:
www.healthdesign.com.au/iHFG
 Editable version of Standard Components on
 Health Facility Briefing System (HFBS) at:
www.healthdesign.com.au ©TAHPI



DESIGNED	APPROVED	DATE	SCALE(S)	SHEET
AK	MM	15.05.22	1 : 50	2 OF 3
REVIT FILE NAME		PAPER DRAWING ID		ISSUE
nb-is-p-i		nb-is-p-i-2		1

iHFG Standard Components

Room Layout Sheet

RLS Room Code

nb-is-p-i

RDS Room Code

nb-is-p-i

Room Name **Neonatal Bay - Isolation Room - Positive Pressure**

GENERAL NOTES:

THIS DRAWING TO BE READ IN CONJUNCTION WITH R.D.S. (ROOM DATA SHEETS) WHICH TAKES PRECEDENCE.

ALL SERVICES INDICATED ARE INDICATIVE AND SUBJECT TO DETAILED PROJECT SPECIFIC ENGINEERING DESIGN.

CEILING LEGEND:

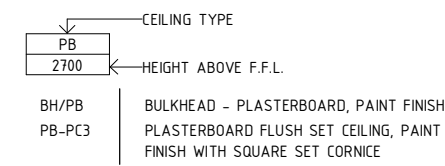

ELECTRICAL LEGEND:

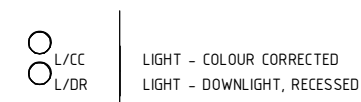

MECHANICAL LEGEND:

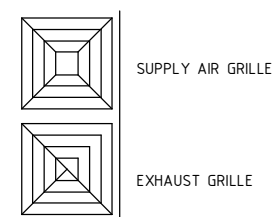

FIRE SERVICES LEGEND:

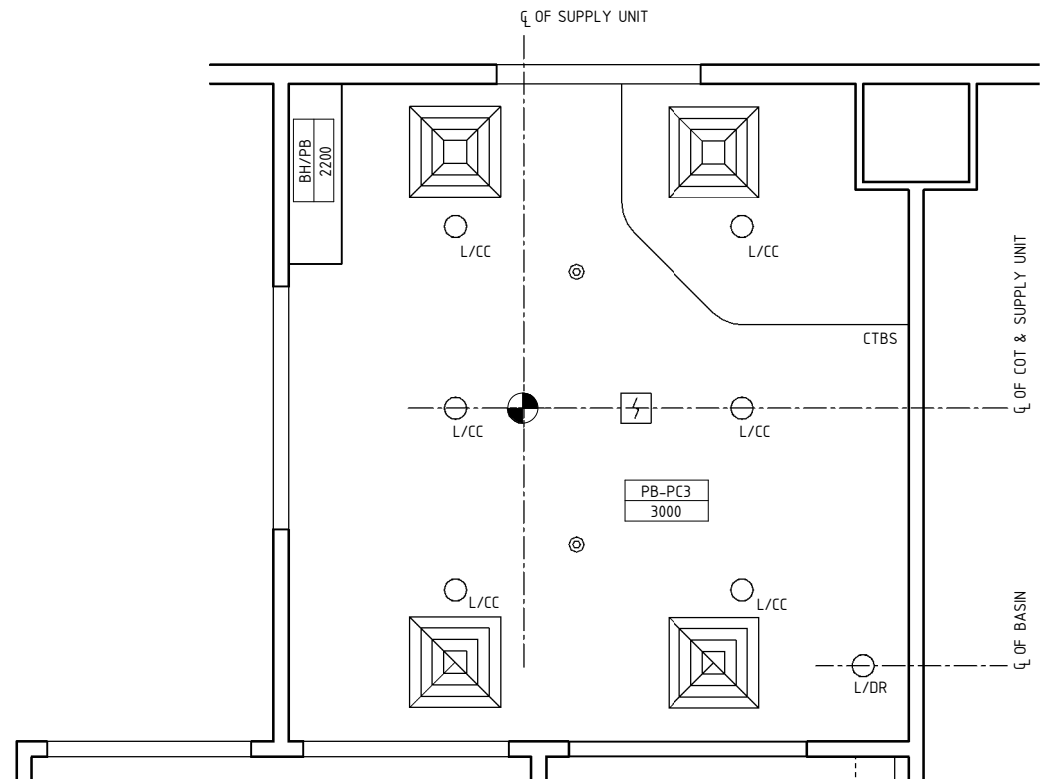

REFLECTED CEILING PLAN

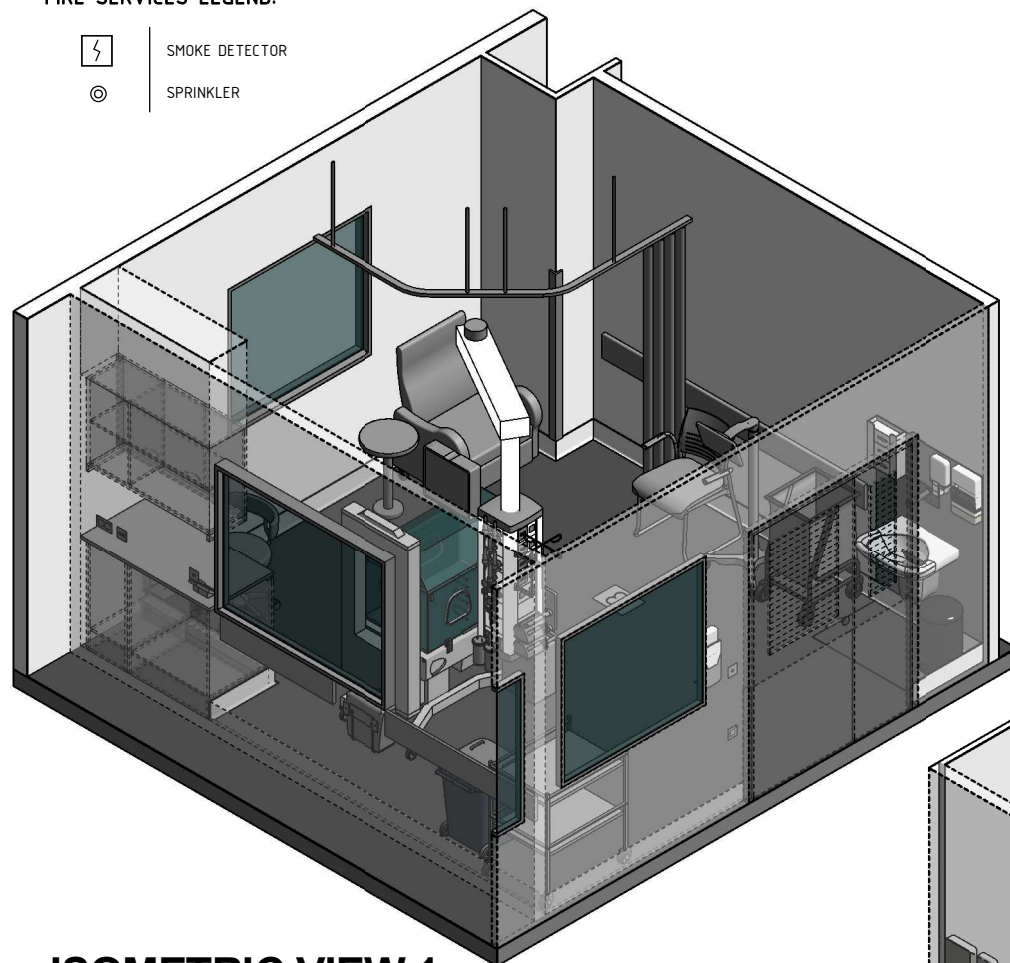

ISOMETRIC VIEW 1

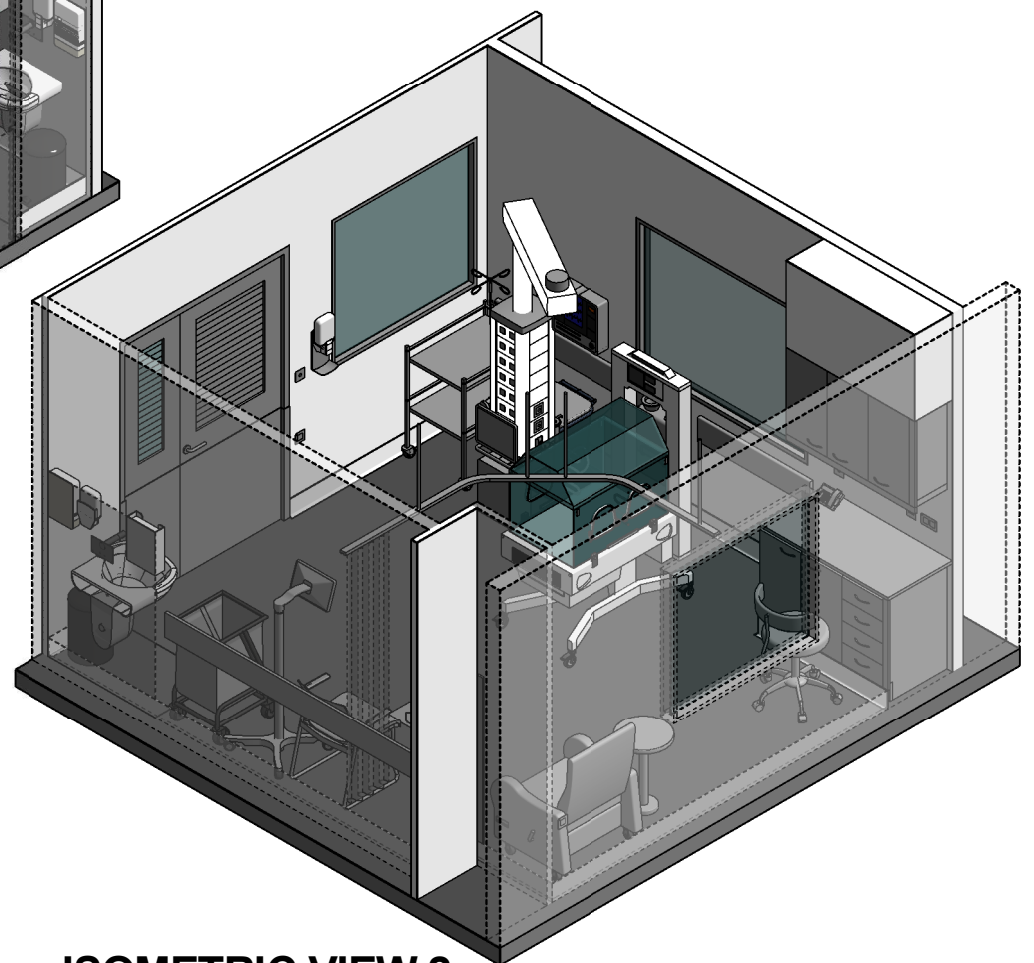

ISOMETRIC VIEW 2

REV	DESCRIPTION	DATE	BY	REV	DESCRIPTION	DATE	BY	COMPATIBILITY																				
1	FIRST ISSUE	15.05.22	AK					iHFG																				
								<table border="1"> <thead> <tr> <th>DESIGNED</th> <th>APPROVED</th> <th>DATE</th> <th>SCALE(S)</th> <th>SHEET</th> </tr> </thead> <tbody> <tr> <td>AK</td> <td>MM</td> <td>15.05.22</td> <td>1 : 50</td> <td>3 OF 3</td> </tr> <tr> <td colspan="2">REVIT FILE NAME</td> <td colspan="2">PAPER DRAWING ID</td> <td>ISSUE</td> </tr> <tr> <td colspan="2">nb-is-p-i</td> <td colspan="2">nb-is-p-i-3</td> <td>1</td> </tr> </tbody> </table>	DESIGNED	APPROVED	DATE	SCALE(S)	SHEET	AK	MM	15.05.22	1 : 50	3 OF 3	REVIT FILE NAME		PAPER DRAWING ID		ISSUE	nb-is-p-i		nb-is-p-i-3		1
DESIGNED	APPROVED	DATE	SCALE(S)	SHEET																								
AK	MM	15.05.22	1 : 50	3 OF 3																								
REVIT FILE NAME		PAPER DRAWING ID		ISSUE																								
nb-is-p-i		nb-is-p-i-3		1																								