

iHFG Standard Components

Room Layout Sheet

Room Name **Office - Executive**

RLS Room Code

off-exec-i

RDS Room Code

off-exec-i

| | |
|--------|--|
| AW | ARTWORK |
| BKC | BOOKCASE |
| BLR | BLIND - ROLLER |
| CBD/FA | CUPBOARD - FULL HEIGHT, ADJUSTABLE SHELVES |
| CHR/E | CHAIR - ERGONOMIC, OFFICE |
| CHR/VO | CHAIR - VISITOR, OFFICE |
| CMP | COMPUTER |
| COM/2 | COMMUNICATION OUTLET - DOUBLE |
| CPT | CARPET |
| CRZ | CREDENZA |
| DK/C | DESK - WITH CONFERENCE END |
| DK/R | DESK, RETURN |
| KP | KICKPLATE |
| LS/R | LIGHT SWITCH - ROOM |
| PO/2 | POWER OUTLET - DOUBLE |
| SK7 | TIMBER SKIRTING |
| TP/HH | TELEPHONE - HANDSET, HANDSFREE |
| WBP/20 | WASTE BIN - PAPER, 20 LITRE |
| WPF | WALL PAINT FINISH |

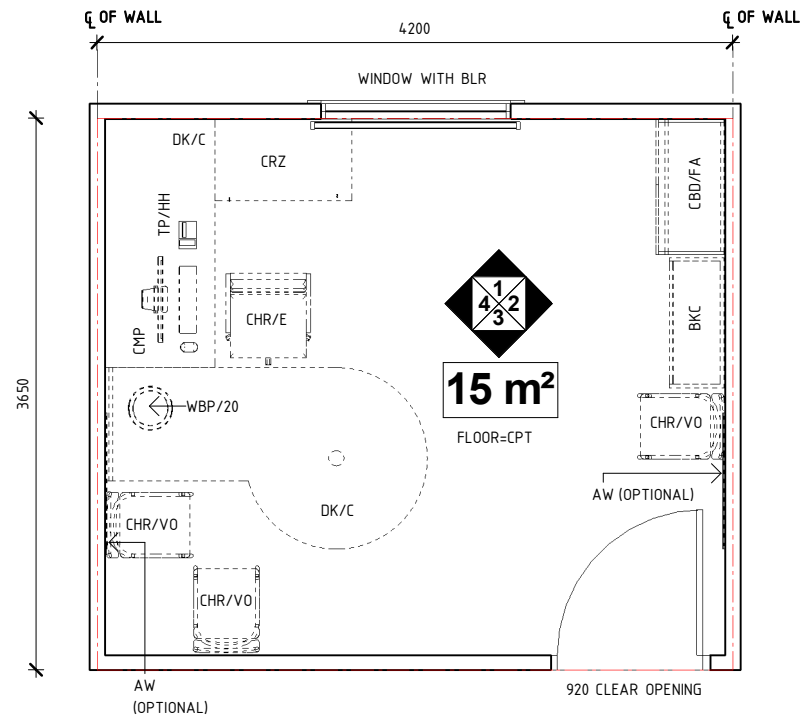

PLAN

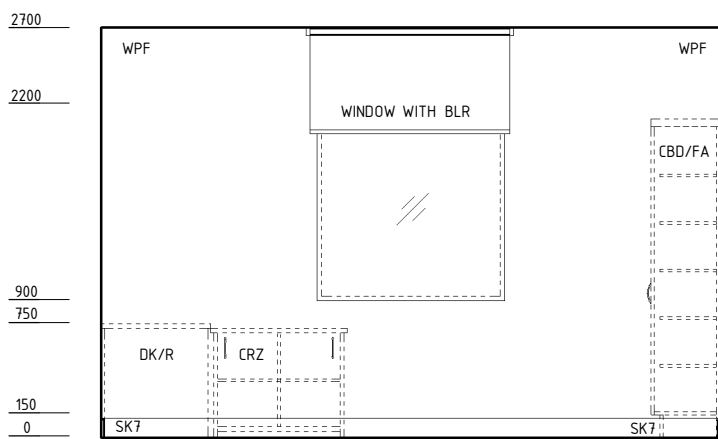

ELEVATION 1

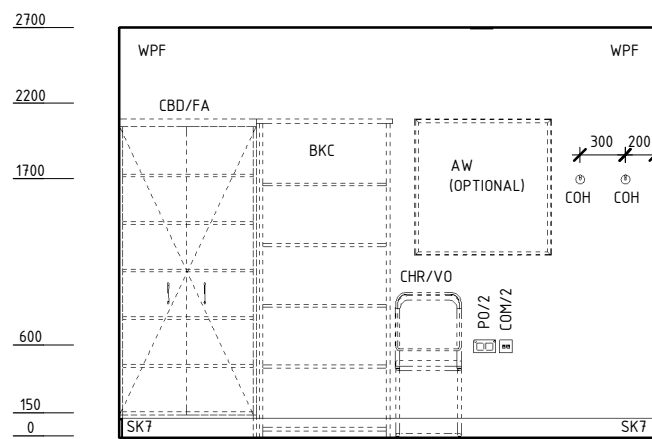

ELEVATION 2

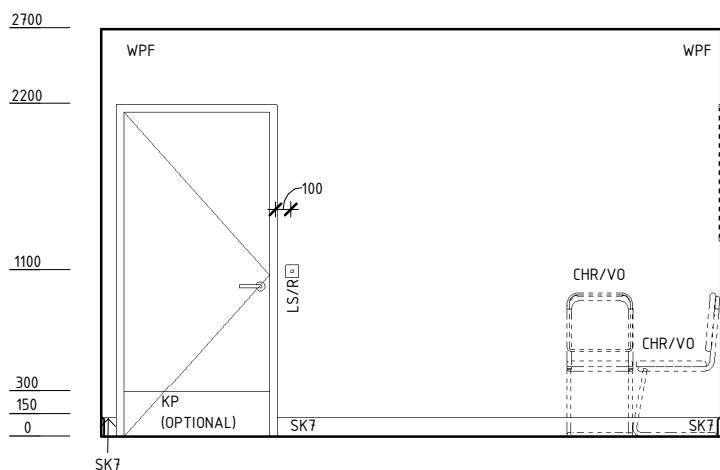

ELEVATION 3

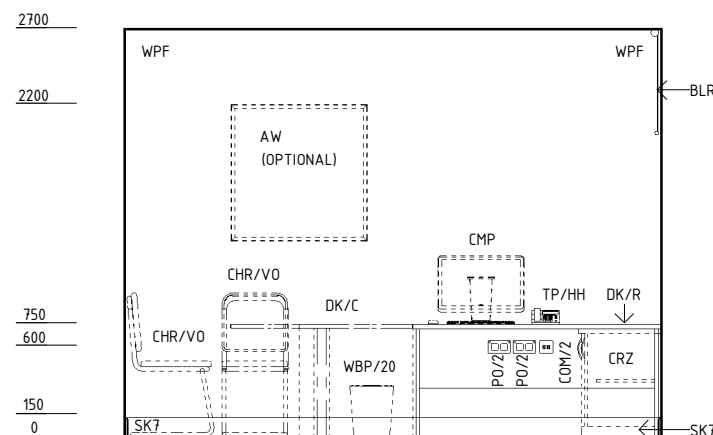

ELEVATION 4

| REV | DESCRIPTION | DATE | BY | REV | DESCRIPTION | DATE | BY | COMPATIBILITY |
|-----|-------------|----------|----|-----|-------------|------|----|---------------|
| 1 | FIRST ISSUE | 25.05.23 | SS | | | | | |



International Health Facility Guidelines at:
www.healthdesign.com.au/iHFG
Editable version of Standard Components on
Health Facility Briefing System (HFBS) at:
www.healthdesign.com.au ©TAHPI



| DESIGNED | APPROVED | DATE | SCALE(S) | SHEET |
|-----------------|----------|------------------|----------|--------|
| SS | SA | 25.05.23 | 1 : 50 | 1 OF 2 |
| REVIT FILE NAME | | PAPER DRAWING ID | | ISSUE |
| off-exec-i | | off-exec-i-1 | | 1 |

