

# iHFG Standard Components

Room Layout Sheet

Room Name	<b>Operating Room - ENT / Ophthalmology</b>	RLS Room Code	or-ent-oph-i
		RDS Room Code	or-ent-oph-i

ANMM	ANAESTHETIC MACHINE WITH ANAESTHETIC MONITOR	PU/IR	PUMP - INFUSION, RAPID		
AV	AUDIO VISUAL OUTLET	PU/S	PUMP - SYRINGE	SUPPLY UNIT - SURGICAL (SUP/S)	4 x AV
AV/DC	AUDIO VISUAL OUTLET - DIRECT CONNECTION	PU/SAM	PUMP - SUCTION, ASPIRATOR - MOBILE		4 x COM/2
BH	BULKHEAD	PU/SAP	PUMP - SUCTION, ASPIRATOR - PORTABLE		2 x O2
BNR	BENCH - RESINATE	RAG	RETURN AIR GRILLE		1 x MA
BRCCM	BRACKET - CARDIAC MONITOR	S	SUCTION		2 x SA (FOR DRILLS)
BS1	BOWL STAND - SINGLE	SA	SURGICAL AIR		2 x S
CARP	CARDIAC PROTECTED	SAC	STAFF ASSIST CALL		1 x CO2 (OPTIONAL)
CBT/BFW	CABINET - BLANKET/FLUID WARMING	SB	SUCTION BOTTLE		12 x PO/1I
CBT/STO	CABINET - STORAGE, OPERATING THEATRE INSTRUMENT	SBC	SUCTION BOTTLE CARRIER		1 x DCE
CBT/SER	CABINET - SERVER, OPERATING THEATRE INTEGRATION	SC	SCAVENGE OUTLET		1 x TA/DC (FOR BRAKE OF SUPPLY UNIT)
CHR/A	CHAIR - ANAESTHETIST	SK4	FLOOR VINYL COVERED SKIRTING		
CMP	COMPUTER	ST/O	STOOL - OPERATING, MOBILE	L/02M (IN CEILING OUTLETS)	1 x AV (MON/D)
COM/1	COMMUNICATION OUTLET - SINGLE	SUP/A	SUPPLY UNIT - ANAESTHETIC		1 x COM/2 (MON/D)
COM/2	COMMUNICATION OUTLET - DOUBLE	SUP/S	SUPPLY UNIT - SURGICAL		1 x DC/1U
COM/DC	COMMUNICATION OUTLET - DIRECT CONNECTION	T/A	TROLLEY - ANAESTHETIC		1 x PO/2U (MON/D)
CONP/SR	CONTROL PANEL - SURGICAL, RECESSED	T/AMD	TROLLEY - AUTOMATED MEDICATION DISPENSING, ANAESTHESIA		
DCE	DIRECT CONNECTION - EMERGENCY POWER SUPPLY	T/G	TROLLEY - GOWNS		
DC/1U	DIRECT CONNECTION - UNINTERRUPTED POWER SUPPLY - SINGLE	T/I	TROLLEY - INSTRUMENTS	CONP/SR	1 x DC/1U
DDG	DISPENSER - DISPOSABLE GLOVE	T/R	TROLLEY - RESUSCITATION, ADULT		1 x COM/DC
DFP	DOOR AND FRAME PROTECTION	TA/DC	TOOL AIR - DIRECT CONNECTION		
DFR	DEFIBRILLATOR	TB/MY	TABLE MAYO	L/03CM2 (IN CEILING OUTLETS)	2 x AV (MON/TS & MON/D)
EC	EMERGENCY CALL	TP/HH	TELEPHONE - HANDSET, HANDSFREE		2 x COM/2 (1 PER MONITOR)
HHU	HYPO - HYPERTHERMIA UNIT	V1	VINYL FLOORING, STANDARD SLIP RESISTANT		1 x DC/1U
IVS	IV STAND: MOBILE	WPFSR	WALL PAINT FINISH, SCRUB RESISTANT		2 x PO/2U (MON/TS & MON/D)
KB	KICKBUCKET & STAND				1 x COM/DC (IN LIGHT CAMERA)
L/02M	LIGHT OPERATING, 2-ARM, 1 LIGHT / 1 MONITOR				
L/03CM2	LIGHT OPERATING, 3-ARM, 1 LIGHT WITH CAMERA/ 2 MONITORS				
L/LA	LIGHT - 'LASER IN USE'	OR INTEGRATION SYSTEM PARTS			
LIND/S	LINEN CARRIER - DIRTY, SINGLE	MON/D	MONITOR - DISPLAY	MON/D 55" (BOTH)	2 x AV (1 PER MONITOR)
MA	MEDICAL AIR	MON/TS	MONITOR - TOUCH SCREEN		2 x COM/2 (1 PER MONITOR)
MON/C	MONITOR - CARDIAC	PTZ CCTV	PAN-TILT-ZOOM CAMERA, CLOSED CIRCUIT TELEVISION		2 x PO/2U (1 PER MONITOR)
N2O	NITROUS OXIDE				
O2	OXYGEN	SUPPLY UNIT - ANAESTHETIC (SUP/A)	4 x AV (2 PER ARM)		1 x AV (WALL MOUNTED, FULLY RECESSED)
O2F	OXYGEN FLOWMETER		4 x COM/2 (2 PER ARM)		1 x COM/2
OPC	ORDERLY/ PORTER CALL		2 x O2 (1 PER ARM)		1 x PO/2U
OPS/R	OBSERVATION PANEL W/ SLIDING PANEL - RADIATION SHIELDING		2 x N2O (1 PER ARM)		
OTA/M	OPERATING TABLE - MOBILE, ELECTRIC		1 x MA		
OTMM	OPERATING MICROSCOPE, MOBILE		2 x S (1 PER ARM)		
PC2	PLASTERBOARD CORNICE, FLUSH COVERED		2 x SC (1 PER ARM)		
PO/1-32A	POWER OUTLET - SINGLE, 32 AMPS		1 x EC		
PO/1I	ISOLATED POWER SUPPLY - SINGLE		1 x SAC		
PO/2E	POWER OUTLET - EMERGENCY, DOUBLE		1 x OPC (OPTIONAL)		
PO/2U	UNINTERRUPTED POWER OUTLET - DOUBLE		12 x PO/1I (6 PER ARM)		
PO/C	POWER OUTLET - CLEANER'S		1 x DCE		
PU/IN1	PUMP - INFUSION, SINGLE		1 x TA/DC (FOR BRAKE OF SUPPLY UNIT)		

NOTE:  
RADIATION SHIELDING REQUIREMENTS TO BE PROVIDED BY A QUALIFIED RADIATION SHIELDING CONSULTANT

NOTE:  
NUMBER OF REQUIRED SERVICES PER PENDANT TO BE ADJUSTED TO MEET PROJECT REQUIREMENTS BUT NOT TO BE LESS THAN THE NUMBERS SHOWN HERE.

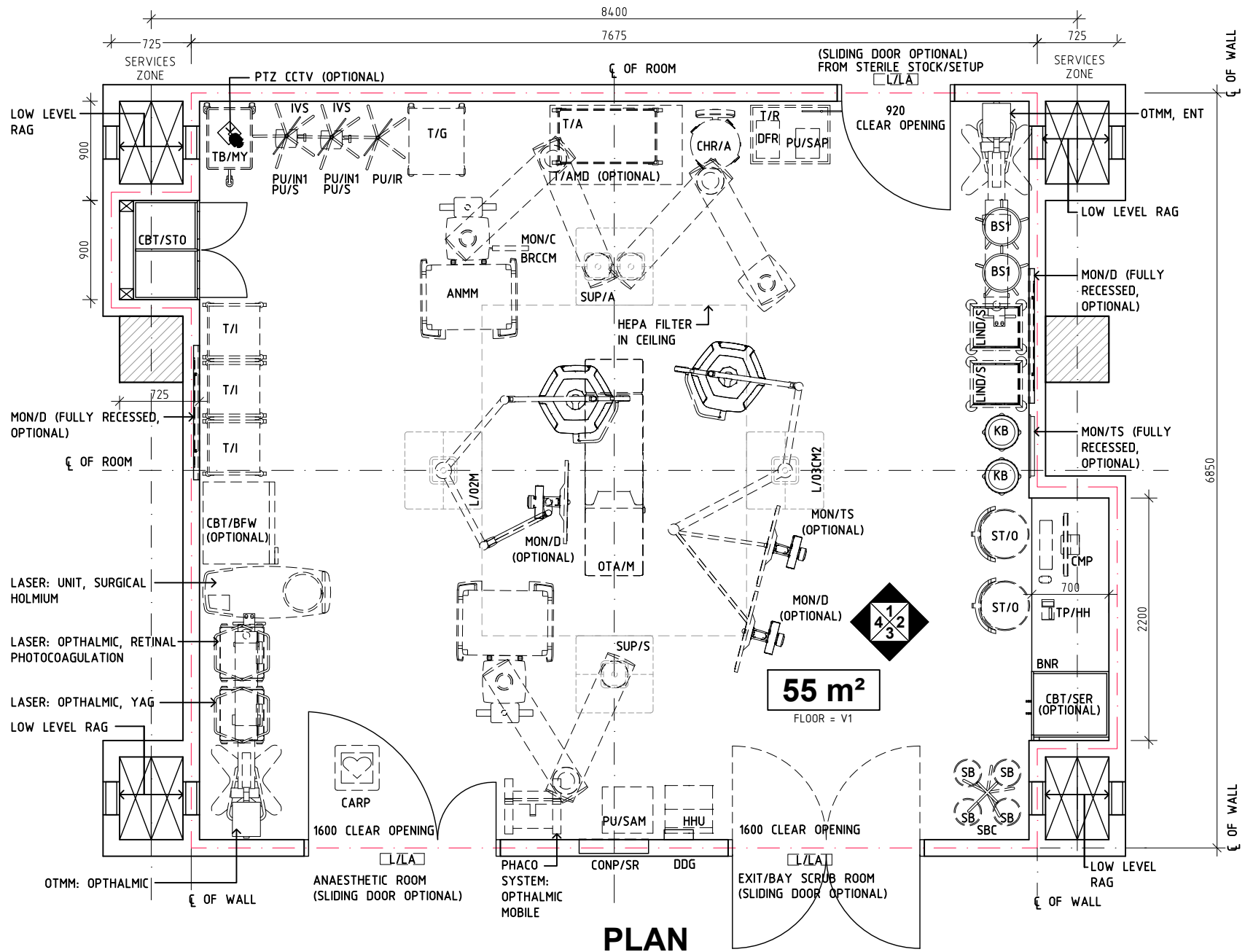

**PLAN**

REV	DESCRIPTION	DATE	BY	REV	DESCRIPTION	DATE	BY	COMPATIBILITY
1	FIRST ISSUE	23.02.23	AK					iHFG

DESIGNED	APPROVED	DATE	SCALE(S)	SHEET
AK	RH	23.02.23	1:50 in A3	1 OF 3
CAD FILE NAME	PAPER DRAWING ID	ISSUE		
or-ent-oph-i	or-ent-oph-i-1	1		

International Health Facility Guidelines at:  
www.healthdesign.com.au/iHFG  
Editable version of Standard Components on  
Health Facility Briefing System (HFBS) at:  
www.healthdesign.com.au ©TAHPI

**ISO 9001**  
QUALITY  
MANAGEMENT SYSTEM

This document is for advisory purpose only

# iHFG Standard Components

Room Layout Sheet

Room Name **Operating Room - ENT / Ophthalmology**

RLS Room Code

or-ent-oph-i

RDS Room Code

or-ent-oph-i

- ANMM ANAESTHETIC MACHINE WITH ANAESTHETIC MONITOR
- AV AUDIO VISUAL OUTLET
- AV/DC AUDIO VISUAL OUTLET - DIRECT CONNECTION
- BH BULKHEAD
- BNR BENCH - RESINATE
- BRCCM BRACKET - CARDIAC MONITOR
- BS1 BOWL STAND - SINGLE
- CARP CARDIAC PROTECTED
- CBT/BFW CABINET - BLANKET/FLUID WARMING
- CBT/STO CABINET - STORAGE, OPERATING THEATRE INSTRUMENT
- CBT/SER CABINET - SERVER, OPERATING THEATRE INTEGRATION
- CHR/A CHAIR - ANAESTHETIST
- CMP COMPUTER
- COM/1 COMMUNICATION OUTLET - SINGLE
- COM/2 COMMUNICATION OUTLET - DOUBLE
- COM/DC COMMUNICATION OUTLET - DIRECT CONNECTION
- CONP/SR CONTROL PANEL - SURGICAL, RECESSED
- DCE DIRECT CONNECTION - EMERGENCY POWER SUPPLY
- DC/1U DIRECT CONNECTION - UNINTERRUPTED POWER SUPPLY - SINGLE
- DDG DISPENSER - DISPOSABLE GLOVE
- DFP DOOR AND FRAME PROTECTION
- DFR DEFIBRILLATOR
- EC EMERGENCY CALL
- HHU HYPO - HYPERTHERMIA UNIT
- IVS IV STAND: MOBILE
- KB KICKBUCKET & STAND
- L/02M LIGHT OPERATING, 2-ARM, 1 LIGHT / 1 MONITOR
- L/03CM2 LIGHT OPERATING, 3-ARM, 1 LIGHT WITH CAMERA/ 2 MONITOR
- L/LA LIGHT - 'LASER IN USE'
- LIND/S LINEN CARRIER - DIRTY, SINGLE
- MA MEDICAL AIR
- MON/C MONITOR - CARDIAC
- N20 NITROUS OXIDE
- O2 OXYGEN
- O2F OXYGEN FLOWMETER
- OPC ORDERLY/ PORTER CALL
- OPS/R OBSERVATION PANEL W/ SLIDING PANEL - RADIATION SHIELDING
- OTA/M OPERATING TABLE - MOBILE, ELECTRIC
- OTMM OPERATING MICROSCOPE, MOBILE
- PC2 PLASTERBOARD CORNICE, FLUSH COVERED
- PO/1-32A POWER OUTLET - SINGLE, 32 AMPS
- PO/1I ISOLATED POWER SUPPLY - SINGLE
- PO/2E POWER OUTLET - EMERGENCY, DOUBLE
- PO/2U UNINTERRUPTED POWER OUTLET - DOUBLE
- PO/C POWER OUTLET - CLEANER'S
- PU/IN1 PUMP - INFUSION, SINGLE
- PU/IR PUMP - INFUSION, RAPID
- PU/S PUMP - SYRINGE
- PU/SAM PUMP - SUCTION, ASPIRATOR - MOBILE
- PU/SAP PUMP - SUCTION, ASPIRATOR - PORTABLE
- RAG RETURN AIR GRILLE
- S SUCTION
- SA SURGICAL AIR
- SAC STAFF ASSIST CALL
- SB SUCTION BOTTLE
- SBC SUCTION BOTTLE CARRIER
- SC SCAVENGE OUTLET
- SK4 FLOOR VINYL COVERED SKIRTING
- ST/O STOOL - OPERATING, MOBILE
- SUP/A SUPPLY UNIT - ANAESTHETIC
- SUP/S SUPPLY UNIT - SURGICAL
- T/A TROLLEY - ANAESTHETIC
- T/AMD TROLLEY - AUTOMATED MEDICATION DISPENSING, ANAESTHESIA
- T/G TROLLEY - GOWNS
- T/I TROLLEY - INSTRUMENTS
- T/R TROLLEY - RESUSCITATION, ADULT
- TA/DC TOOL AIR - DIRECT CONNECTION
- TB/MY TABLE MAYO
- TP/HH TELEPHONE - HANDSET, HANDSFREE
- V1 VINYL FLOORING, STANDARD SLIP RESISTANT
- WPFSSR WALL PAINT FINISH, SCRUB RESISTANT

- OR INTEGRATION SYSTEM PARTS
- MON/D MONITOR - DISPLAY
- MON/TS MONITOR - TOUCH SCREEN
- PTZ CCTV PAN-TILT-ZOOM CAMERA, CLOSED CIRCUIT TELEVISION

- SUPPLY UNIT - ANAESTHETIC (SUP/A)
- 4 x AV (2 PER ARM)
- 4 x COM/2 (2 PER ARM)
- 2 x O2 (1 PER ARM)
- 2 x N2O (1 PER ARM)
- 1 x MA
- 2 x S (1 PER ARM)
- 2 x SC (1 PER ARM)
- 1 x EC
- 1 x SAC
- 1 x OPC (OPTIONAL)
- 12 x PO/1I (6 PER ARM)
- 1 x DCE
- 1 x TA/DC (FOR BRAKE OF SUPPLY UNIT)

- SUPPLY UNIT - SURGICAL (SUP/S)
- 4 x AV
- 4 x COM/2
- 2 x O2
- 1 x MA
- 2 x SA (FOR DRILLS)
- 2 x S
- 1 x CO2 (OPTIONAL)
- 12 x PO/1I
- 1 x DCE
- 1 x TA/DC (FOR BRAKE OF SUPPLY UNIT)

- L/03CM2 (IN CEILING OUTLETS)
- 2 x AV (MON/TS & MON/D)
- 2 x COM/2 (MON/TS & MON/D)
- 1 x DC/1U
- 2 x PO/2U (MON/TS & MON/D)
- 1 x COM/DC (IN LIGHT CAMERA)

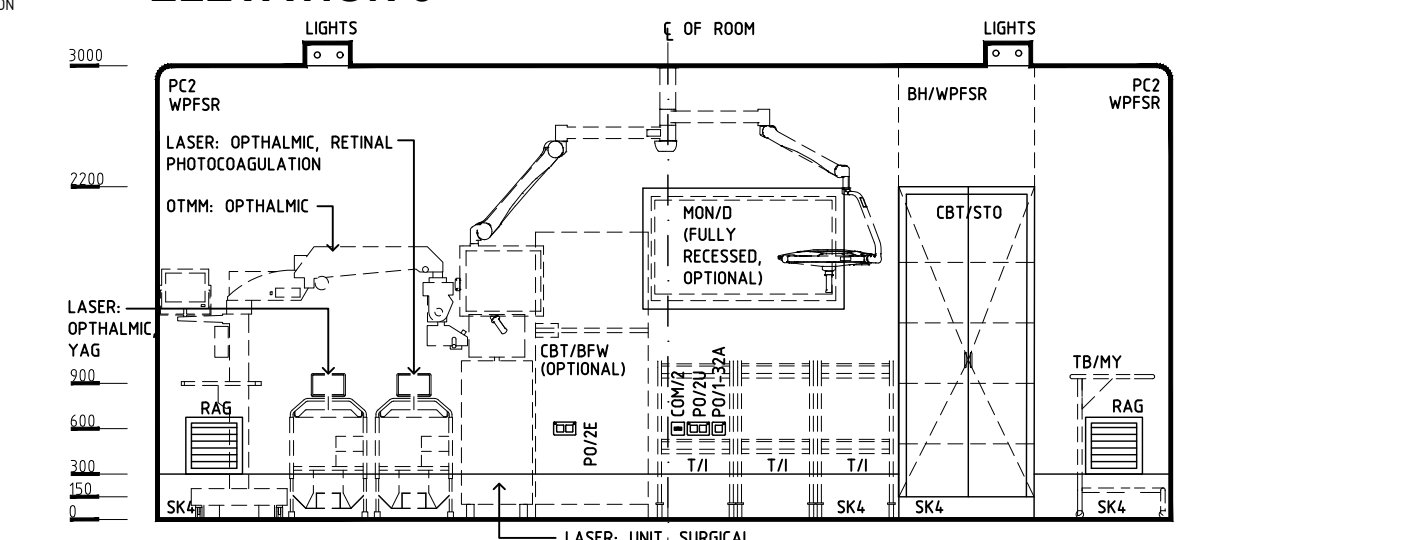
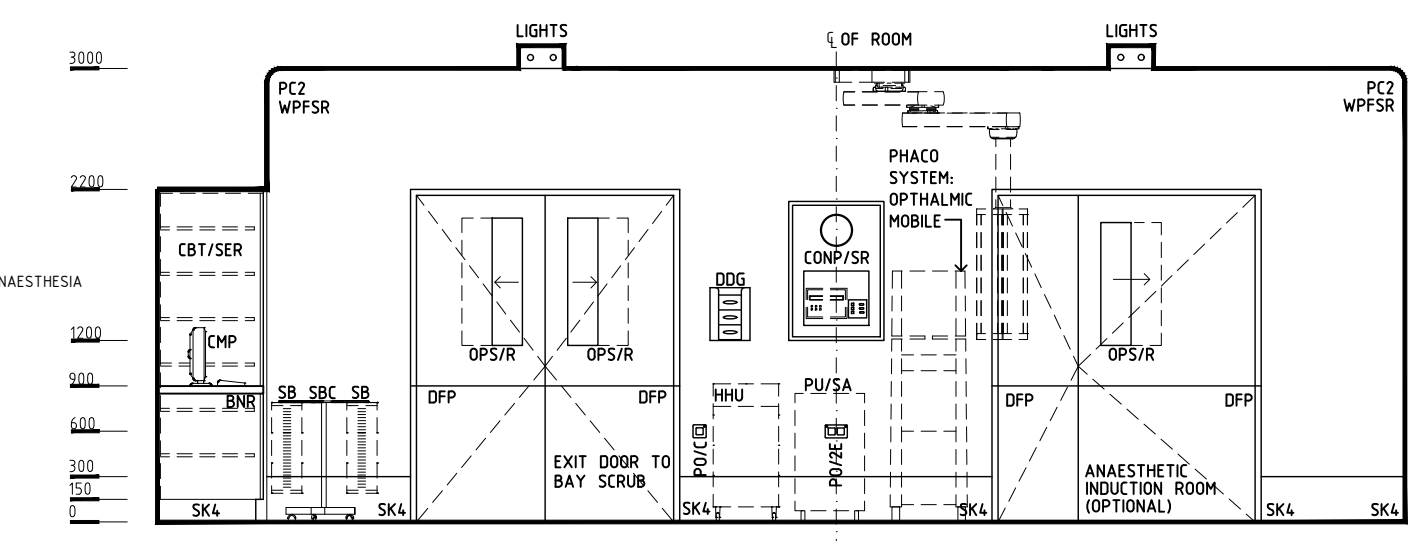
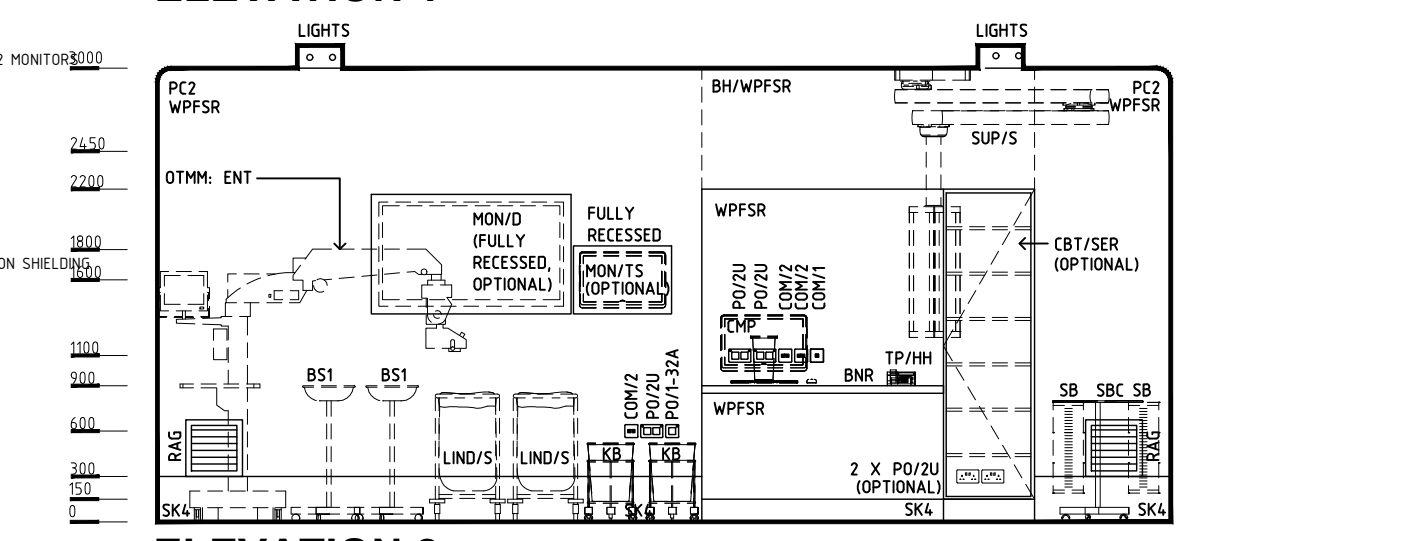
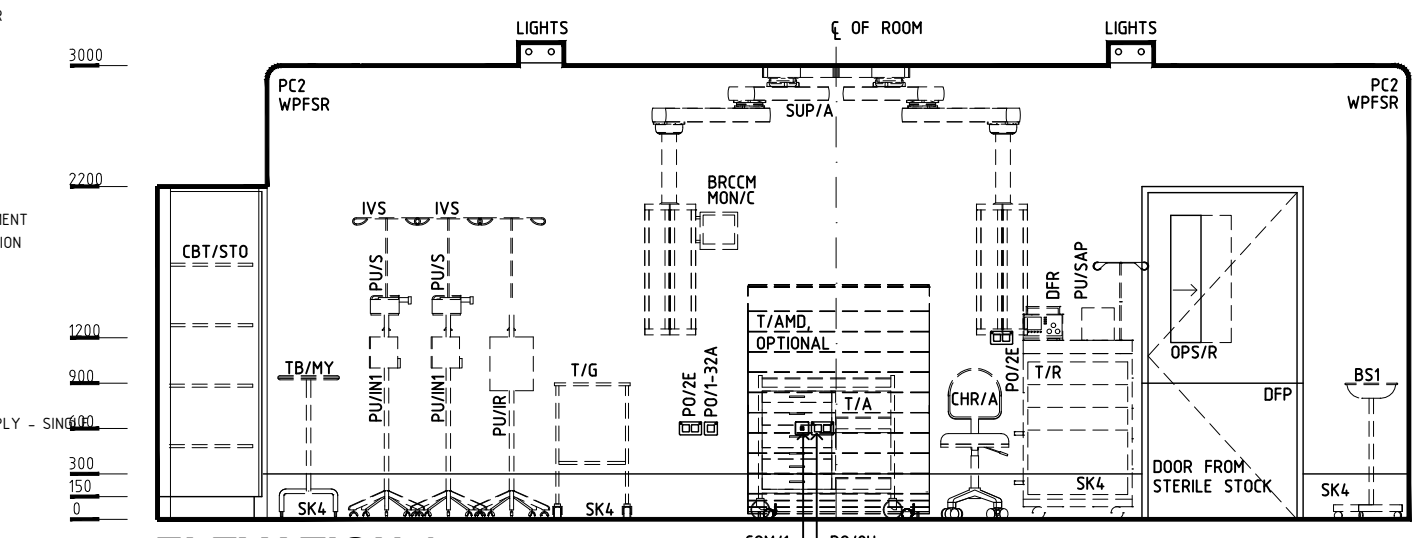

- L/02M (IN CEILING OUTLETS)
- 1 x AV (MON/D)
- 1 x COM/2 (MON/D)
- 1 x DC/1U
- 1 x PO/2U (MON/D)
- CONP/SR
- 1 x DC/1U
- 1 x COM/DC

REV	DESCRIPTION	DATE	BY	REV	DESCRIPTION	DATE	BY	COMPATIBILITY
1	FIRST ISSUE	23.02.23	AK					iHFG

	<b>International Health Facility Guidelines</b>	International Health Facility Guidelines at: <a href="http://www.healthdesign.com.au/iHFG">www.healthdesign.com.au/iHFG</a> Editable version of Standard Components on Health Facility Briefing System (HFBS) at: <a href="http://www.healthdesign.com.au/TAHPI">www.healthdesign.com.au/TAHPI</a>		DESIGNED AK	APPROVED RH	DATE 23.02.23	SCALE(S) 1:50 in A3	SHEET 2 OF 3
	CAD FILE NAME or-ent-oph-i		PAPER DRAWING ID or-ent-oph-i-2		ISSUE 1			

This document is for advisory purpose only

# iHFG Standard Components

Room Layout Sheet

Room Name **Operating Room - ENT / Ophthalmology**

RLS Room Code

or-ent-oph-i

RDS Room Code

or-ent-oph-i

**GENERAL NOTES:**

THIS DRAWING TO BE READ IN CONJUNCTION WITH R.D.S. (ROOM DATA SHEETS) WHICH TAKES PRECEDENCE.

ALL SERVICES INDICATED ARE INDICATIVE AND SUBJECT TO DETAILED PROJECT SPECIFIC ENGINEERING DESIGN.

**CEILING LEGEND:**

- BH/PBSR BULKHEAD - PLASTERBOARD FLUSH SET CEILING, SCRUB RESISTANT PAINT FINISH
- PBSR PLASTERBOARD FLUSH SET CEILING, SCRUB RESISTANT PAINT FINISH
- PC2 90mm. PLASTERBOARD CORNICE, FLUSH COVERED
- GRID LINE

PB	←	CEILING TYPE
3000	←	HEIGHT ABOVE F.F.L.

**ELECTRICAL LEGEND:**

- LED - COLOUR CORRECTED, CYANOSIS
- LIGHT - COLOUR CORRECTED, DIMMABLE

**MECHANICAL LEGEND:**

- HEPA FILTER GRILLE

**FIRE SERVICES LEGEND:**

- SMOKE DETECTOR
- SPRINKLER

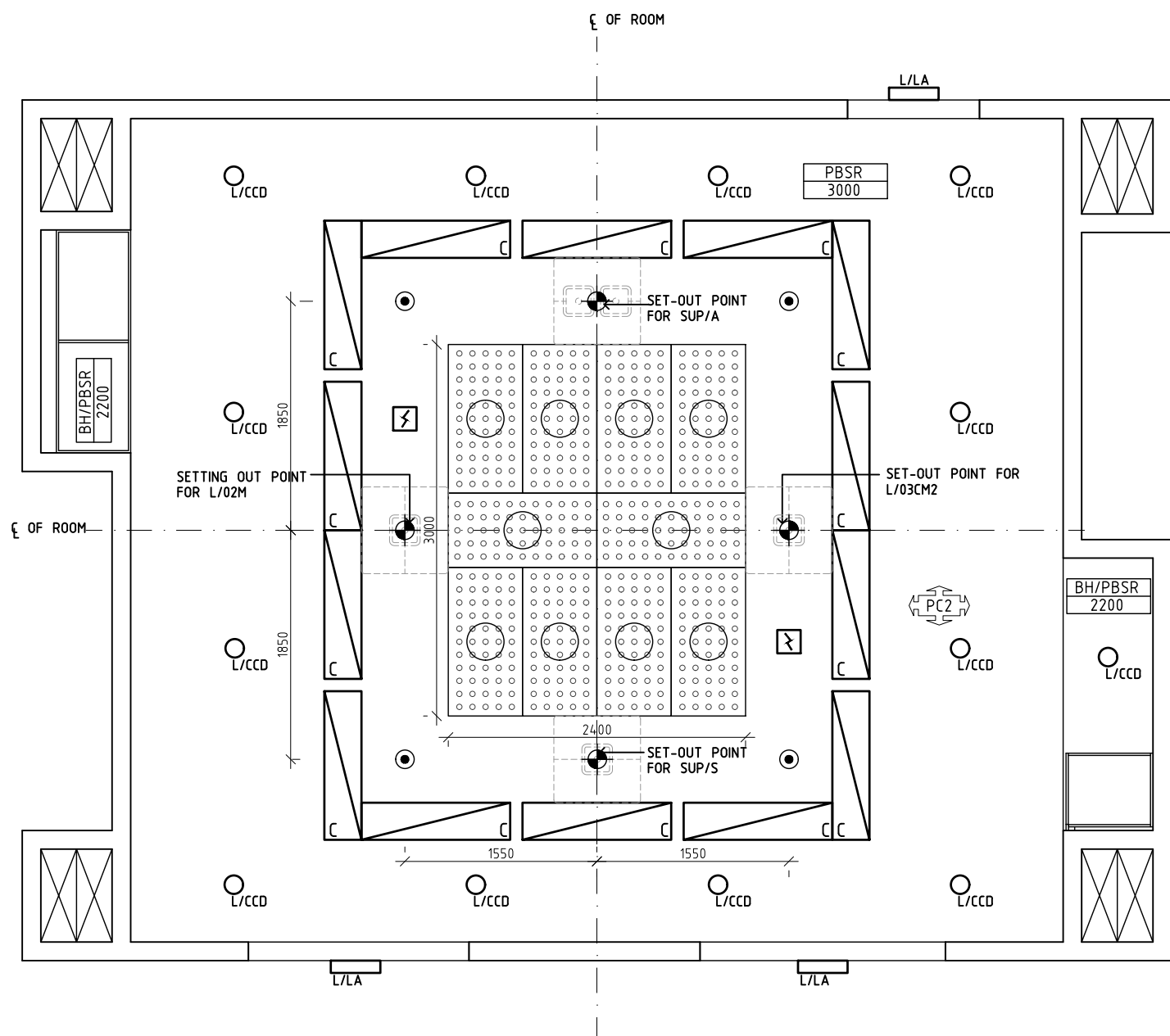

**REFLECTED CEILING PLAN**

REV	DESCRIPTION	DATE	BY	REV	DESCRIPTION	DATE	BY	COMPATIBILITY																				
1	FIRST ISSUE	23.02.23	AK					iHFG																				
								<table border="1"> <tr> <th>DESIGNED</th> <th>APPROVED</th> <th>DATE</th> <th>SCALE(S)</th> <th>SHEET</th> </tr> <tr> <td>AK</td> <td>RH</td> <td>23.02.23</td> <td>1:50 in A3</td> <td>3 OF 3</td> </tr> <tr> <td colspan="2">CAD FILE NAME</td> <td colspan="2">PAPER DRAWING ID</td> <td>ISSUE</td> </tr> <tr> <td colspan="2">or-ent-oph-i</td> <td colspan="2">or-ent-oph-i-3</td> <td>1</td> </tr> </table>	DESIGNED	APPROVED	DATE	SCALE(S)	SHEET	AK	RH	23.02.23	1:50 in A3	3 OF 3	CAD FILE NAME		PAPER DRAWING ID		ISSUE	or-ent-oph-i		or-ent-oph-i-3		1
DESIGNED	APPROVED	DATE	SCALE(S)	SHEET																								
AK	RH	23.02.23	1:50 in A3	3 OF 3																								
CAD FILE NAME		PAPER DRAWING ID		ISSUE																								
or-ent-oph-i		or-ent-oph-i-3		1																								