

iHFG Standard Components

Room Layout Sheet

Room Name | **Operating Room - Minor**

RLS Room Code

or-ms-i

RDS Room Code

or-ms-i

ANMM	ANAESTHETIC - MACHINE WITH ANAESTHETIC MONITOR
AS	ADJUSTABLE SHELF
AV	AUDIO VISUAL OUTLET
AV/DC	AUDIO VISUAL OUTLET - DIRECT CONNECTION
BH	BULKHEAD
BLVI	BLIND - VENETIAN, INTEGRAL
BNR	BENCH - RESINATE
BRCCM	BRACKET - CARDIAC MONITOR
BS1	BOWL STAND - SINGLE
CARP	CARDIAC PROTECTED
CBD/UB	CUPBOARD - UNDER BENCH
CBD/WG	CUPBOARD - WALL MOUNTED, GLASS DOORS
CBT/BW	CABINET - BLANKET WARMING
CBT/STO	CABINET - STORAGE, OPERATING THEATRE INSTRUMENT
CHR/A	CHAIR - ANAESTHETIST
CMP	COMPUTER
CO2	CARBON DIOXIDE
COM/1	COMMUNICATION OUTLET - SINGLE
COM/2	COMMUNICATION OUTLET - DOUBLE
COM/DC	COMMUNICATION OUTLET - DIRECT CONNECTION
CONP/SR	CONTROL PANEL - SURGICAL, RECESSED
DCE	DIRECT CONNECTION - EMERGENCY POWER SUPPLY
DCU/1	DIRECT CONNECTION - UNINTERRUPTED POWER SUPPLY, SINGLE
DDG	DISPENSER - DISPOSABLE GLOVES
DFP	DOOR AND DOOR FRAME PROTECTION
DFR	DEFIBRILLATOR
DGL	DOUBLE GLAZED
FST	FOOTSTOOL
IVS	IV STAND - MOBILE
KB	KICKBUCKET & STAND
L/CCD	LIGHT - COLOUR CORRECTED, DIMMABLE
L/LA	LIGHT - 'LASER IN USE'
L/O	LIGHT - OPERATING
L/O2CM	LIGHT - OPERATING, 2-ARM, 1 LIGHT WITH CAMERA / 1 MONITOR
LIND/S	LINEN CARRIER - DIRTY, SINGLE
MON/C	MONITOR - CARDIAC
MON/D	MONITOR - DISPLAY
OP/R	OBSERVATION PANEL - RADIATION SHIELDING
OTA/M	OPERATING TABLE - MOBILE, ELECTRIC
PC2	PLASTERBOARD CORNICE, FLUSHED COVERED
PO/1-32A	POWER OUTLET - SINGLE, 32 AMPS
PO/2E	POWER OUTLET - EMERGENCY, DOUBLE
PO/2U	UNINTERRUPTED POWER SUPPLY - DOUBLE

PO/C	POWER OUTLET - CLEANER'S
PTZ	PAN-TILT-ZOOM CAMERA
PU/IN1	PUMP - INFUSION, SINGLE
PU/IR	PUMP - INFUSION, RAPID
PU/S	PUMP - SYRINGE
PU/SAM	PUMP - SUCTION, ASPIRATOR, MOBILE
PU/SAP	PUMP - SUCTION, ASPIRATOR, PORTABLE
RAG	RETURN AIR GRILLE
SB	SUCTION BOTTLE
SBC	SUCTION BOTTLE CARRIER
SK4	FLOOR VINYL COVERED SKIRTING
SPE/A	SERVICES PENDANT - ANAESTHESIA
SPE/S	SERVICES PENDANT - SURGICAL
ST/O	STOOL - OPERATING, MOBILE
T	TROLLEY
T/A	TROLLEY - ANAESTHETIC
T/G	TROLLEY - GOWNS
T/I	TROLLEY - INSTRUMENT
T/R	TROLLEY - RESUSCITATION, ADULT
TA/DC	TOOL AIR - DIRECT CONNECTION
TB/MY	TABLE - MAYO
TP/HH	TELEPHONE - HANDSET, HANDSFREE
V1	VINYL FLOORING, STANDARD SLIP RESISTANT
WPFSR	WALL PAINT FINISH, SCRUB RESISTANT

SERVICE PENDANT - SURGICAL (SPE/S)	2 x AV 2 x COM/2 2 x O2 1 x MA 2 x S 1 x SA (OPTIONAL) 1 x CO2 (OPTIONAL) 8 x PO/1 1 x DCE 1 x TA/DC (FOR SUPPLY UNIT BRAKES)
L/O2CM (IN CEILING OUTLETS)	1 x AV (MON/D) 1 x COM/2 (MON/D) 1 x DCU/1 1 x PO/2U (MON/D) 1 x COM/DC (IN LIGHT CAMERA, OPTIONA:L)
CONP/SR	1 x DCU/1 1 x COM/DC
MON/D (42 INCH)	1 x AV/DC 1 x COM/2 1 x PO/2U

SERVICE PENDANT - ANAESTHETIC (SPE/A)	2 x AV 2 x COM/2 2 x O2 2 x N2O 1 x MA 2 x S 2 x SC 1 x EC 1 x SAC 1 x OPC (OPTIONAL) 8 x PO/1 1 x DCE 1 x TA/DC (FOR SUPPLY UNIT BRAKES)
---------------------------------------	---

NOTE:
RADIATION SHIELDING REQUIREMENTS TO BE PROVIDED BY A QUALIFIED RADIATION SHIELDING CONSULTANT

NOTE:
NUMBER OF REQUIRED SERVICES PER PENDANT TO BE ADJUSTED TO MEET PROJECT REQUIREMENTS BUT NOT TO BE LESS THAN THE NUMBERS SHOWN HERE.

NOTE:
WALL FINISH: FULL HEIGHT WALL VINYL OR EPOXY PAINT OR WPFSR.
DOOR: LAMINATED DOOR PANEL WITH ENAMEL PAINT FINISH ON METAL DOOR FRAME

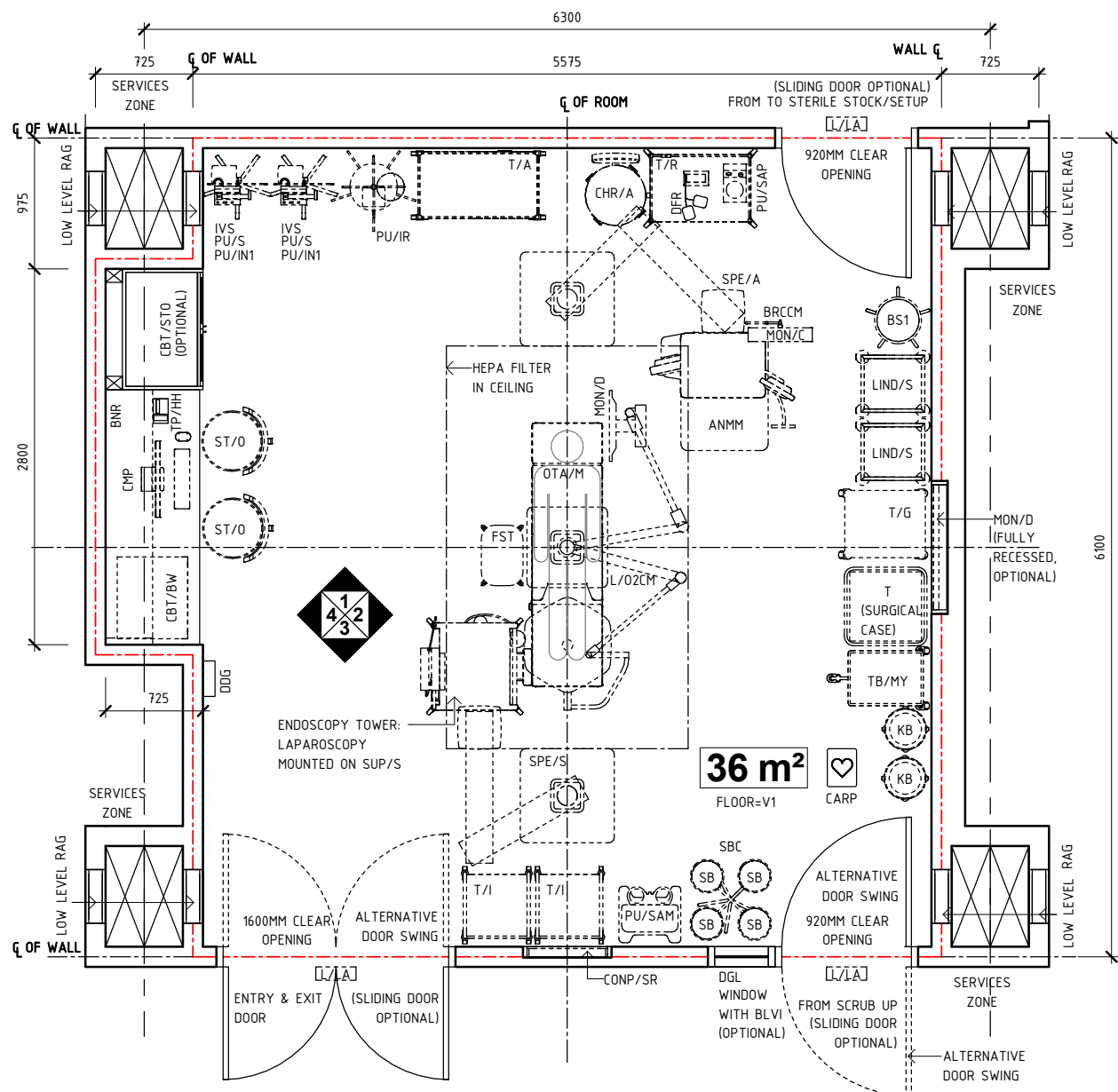

PLAN

REV	DESCRIPTION	DATE	BY	REV	DESCRIPTION	DATE	BY	COMPATIBILITY
1	FIRST ISSUE	24.10.10	LL	4	GENERAL REVISION	26.10.15	PJ	iHFG
2	GENERAL REVISION	30.08.11	SD	5	GENERAL REVISION	31.10.22	AM	
3	GENERAL REVISION	31.10.12	CT					

DESIGNED	APPROVED	DATE	SCALE(S)	SHEET
AK	RH	31.10.22	1 : 50	1 OF 4
REVIT FILE NAME		PAPER DRAWING ID		ISSUE
or-ms-i		or-ms-i-1		5



International Health Facility Guidelines at:
www.healthdesign.com.au/iHFG
Editable version of Standard Components on
Health Facility Briefing System (HFBS) at:
www.healthdesign.com.au ©TAHPI



iHFG Standard Components

Room Layout Sheet

Room Name **Operating Room - Minor**

RLS Room Code

or-ms-i

RDS Room Code

or-ms-i

AS	ADJUSTABLE SHELF
BLVI	BLIND - VENETIAN, INTEGRAL
BNR	BENCH - RESINATE
BS1	BOWL STAND - SINGLE
CBD/UB	CUPBOARD - UNDER BENCH
CBD/WG	CUPBOARD - WALL MOUNTED, GLASS DOORS
CBT/BW	CABINET - BLANKET WARMING
CBT/STO	CABINET - STORAGE, OPERATING THEATRE INSTRUMENT
CHR/A	CHAIR - ANAESTHETIST
CMP	COMPUTER
COM/1	COMMUNICATION OUTLET - SINGLE
COM/2	COMMUNICATION OUTLET - DOUBLE
CONP/SR	CONTROL PANEL - SURGICAL, RECESSED
DDG	DISPENSER - DISPOSABLE GLOVES
DFP	DOOR AND DOOR FRAME PROTECTION
DFR	DEFIBRILLATOR
IVS	IV STAND - MOBILE
KB	KICKBUCKET & STAND
L/O2CM	LIGHT - OPERATING, 2-ARM, 1 LIGHT WITH CAMERA / 1 MONITOR
LIND/S	LINEN CARRIER - DIRTY, SINGLE
MON/D	MONITOR - DISPLAY
OP/R	OBSERVATION PANEL - RADIATION SHIELDING
PC2	PLASTERBOARD CORNICE, FLUSHED COVERED
PO/1-32A	POWER OUTLET - SINGLE, 32 AMPS
PO/2E	POWER OUTLET - EMERGENCY, DOUBLE
PO/2U	UNINTERRUPTED POWER SUPPLY - DOUBLE
PO/C	POWER OUTLET - CLEANER'S
PTZ	PAN-TILT-ZOOM CAMERA
PU/IN1	PUMP - INFUSION, SINGLE
PU/IR	PUMP - INFUSION, RAPID
PU/S	PUMP - SYRINGE
PU/SAM	PUMP - SUCTION, ASPIRATOR, MOBILE
PU/SAP	PUMP - SUCTION, ASPIRATOR, PORTABLE
RAG	RETURN AIR GRILLE
SB	SUCTION BOTTLE
SBC	SUCTION BOTTLE CARRIER
SK4	FLOOR VINYL COVERED SKIRTING
T	TROLLEY
T/A	TROLLEY - ANAESTHETIC
T/G	TROLLEY - GOWNS
T/R	TROLLEY - RESUSCITATION, ADULT
TB/MY	TABLE - MAYO
TP/HH	TELEPHONE - HANDSET, HANDSFREE
WPFSR	WALL PAINT FINISH, SCRUB RESISTANT

SERVICE	2 x AV
PENDANT - ANAESTHETIC (SPE/A)	2 x COM/2
	2 x O2
	2 x N2O
	1 x MA
	2 x S
	2 x SC
	1 x EC
	1 x SAC
	1 x OPC (OPTIONAL)
	8 x PO/1/1
	1 x DCE
	1 x TA/DC (FOR SUPPLY UNIT BRAKES)

SERVICE	2 x AV
PENDANT - SURGICAL (SPE/S)	2 x COM/2
	2 x O2
	1 x MA
	2 x S
	1 x SA (OPTIONAL)
	1 x CO2 (OPTIONAL)
	8 x PO/1/1
	1 x DCE
	1 x TA/DC (FOR SUPPLY UNIT BRAKES)

L/O2CM (IN CEILING OUTLETS)	1 x AV (MON/D)
	1 x COM/2 (MON/D)
	1 x DCU/1
	1 x PO/2U (MON/D)
	1 x COM/DC (IN LIGHT CAMERA, OPTIONA;L)

CONP/SR	1 x DCU/1
	1 x COM/DC

MON/D (42 INCH)	1 x AV/DC
	1 x COM/2
	1 x PO/2U

NOTE:
RADIATION SHIELDING REQUIREMENTS TO BE PROVIDED BY A QUALIFIED RADIATION SHIELDING CONSULTANT

NOTE:
NUMBER OF REQUIRED SERVICES PER PENDANT TO BE ADJUSTED TO MEET PROJECT REQUIREMENTS BUT NOT TO BE LESS THAN THE NUMBERS SHOWN HERE.

NOTE:
WALL FINISH: FULL HEIGHT WALL VINYL OR EPOXY PAINT OR WPFSR.
DOOR: LAMINATED DOOR PANEL WITH ENAMEL PAINT FINISH ON METAL DOOR FRAME

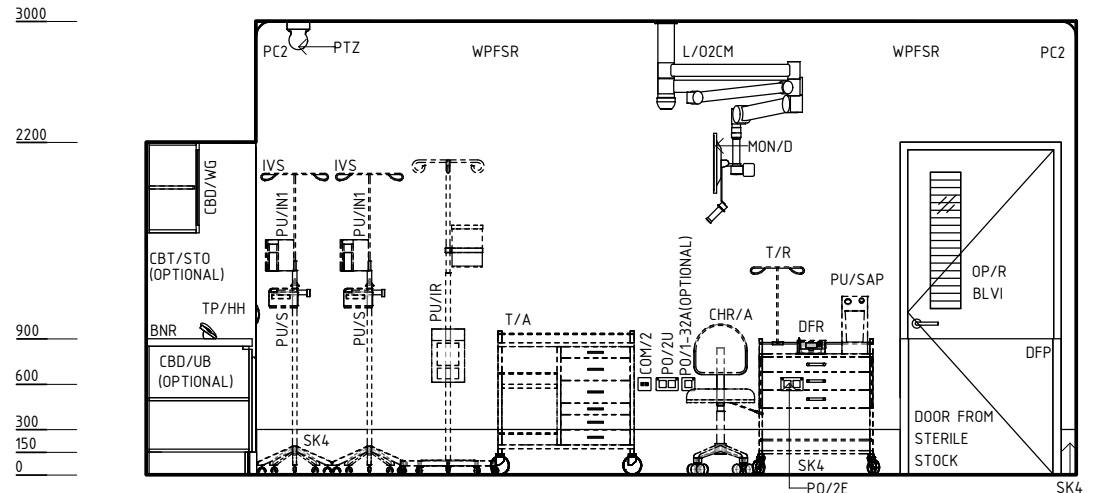

ELEVATION 1

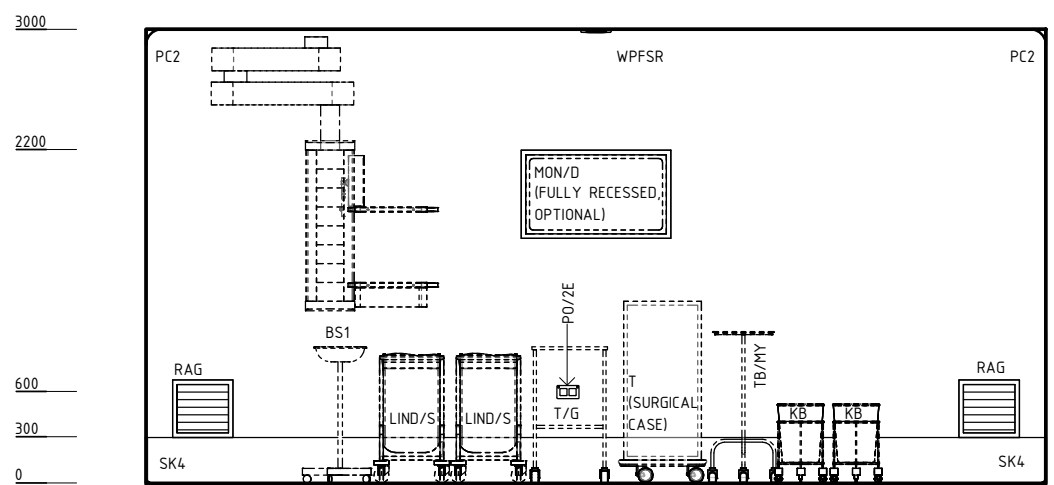

ELEVATION 2

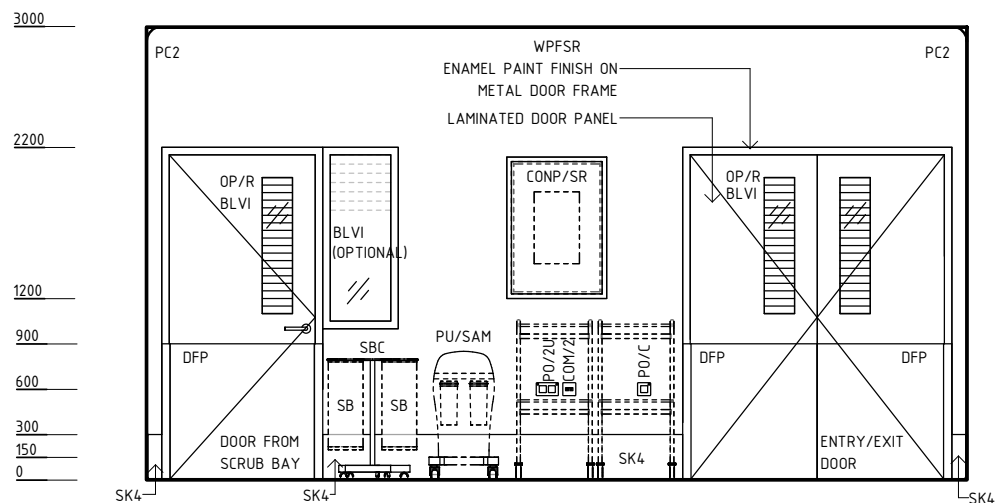

ELEVATION 3

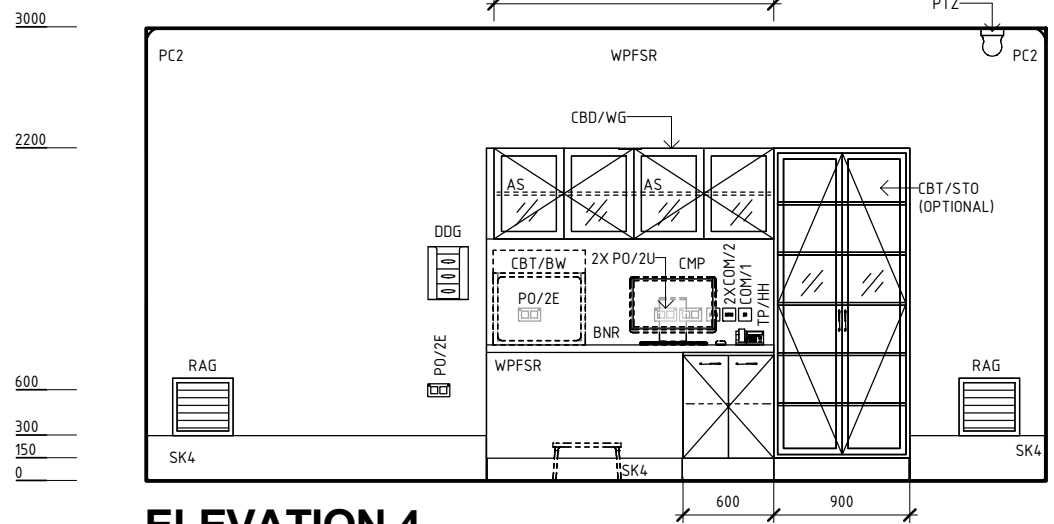

ELEVATION 4

REV	DESCRIPTION	DATE	BY	REV	DESCRIPTION	DATE	BY	COMPATIBILITY
1	FIRST ISSUE	24.10.10	LL	4	GENERAL REVISION	26.10.15	PJ	iHFG
2	GENERAL REVISION	30.08.11	SD	5	GENERAL REVISION	31.10.22	AM	
3	GENERAL REVISION	31.10.12	CT					

iHFG Standard Components

Room Layout Sheet

RLS Room Code

or-ms-i

RDS Room Code

or-ms-i

Room Name

Operating Room - Minor

GENERAL NOTES:

THIS DRAWING TO BE READ IN CONJUNCTION WITH R.D.S. (ROOM DATA SHEETS) WHICH TAKES PRECEDENCE.

ALL SERVICES INDICATED ARE INDICATIVE AND SUBJECT TO DETAILED PROJECT SPECIFIC ENGINEERING DESIGN.

CEILING LEGEND:

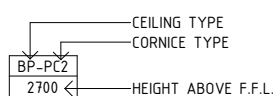

BH-PBSR BULKHEAD - PLASTERBOARD, SCRUB RESISTANT PAINT FINISH
 PBSR-PC2 PLASTERBOARD FLUSH SET CEILING, SCRUB RESISTANT PAINT FINISH WITH PLASTERBOARD CORNICE, FLUSHED COVED

--- GRID LINE

ELECTRICAL LEGEND:

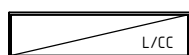

L/CC LIGHT - COLOUR CORRECTED



L/CCD LIGHT - COLOUR CORRECTED, DIMMABLE

MECHANICAL LEGEND:

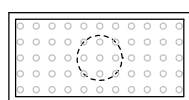

HEPA FILTER GRILLE

FIRE SERVICES LEGEND:



SMOKE DETECTOR



SPRINKLER

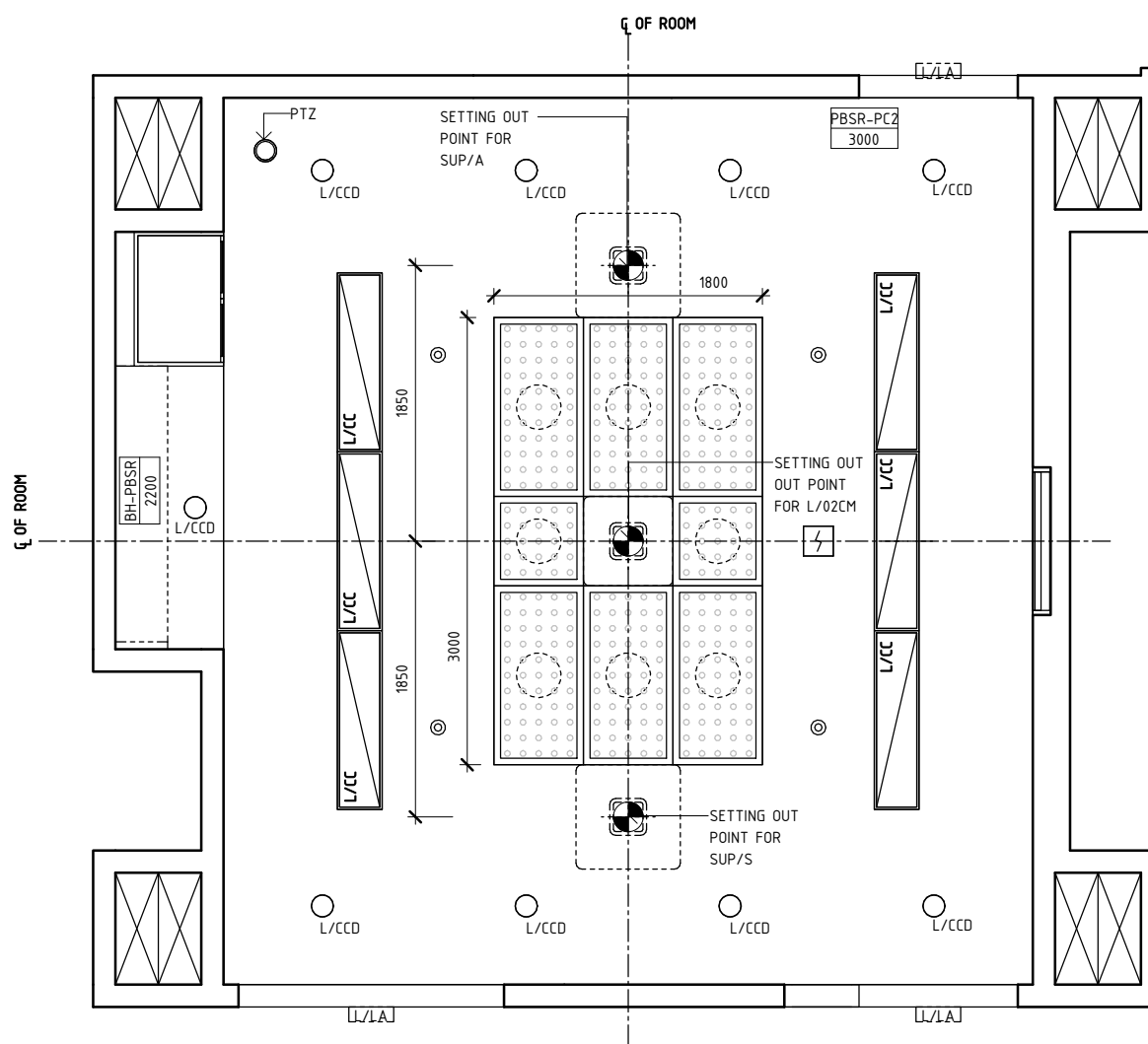

REFLECTED CEILING PLAN

REV	DESCRIPTION	DATE	BY	REV	DESCRIPTION	DATE	BY	COMPATIBILITY
1	FIRST ISSUE	24.10.10	LL	4	GENERAL REVISION	26.10.15	PJ	iHFG
2	GENERAL REVISION	30.08.11	SD	5	GENERAL REVISION	31.10.22	AM	
3	GENERAL REVISION	31.10.12	CT					

DESIGNED	APPROVED	DATE	SCALE(S)	SHEET
AK	RH	31.10.22	1 : 50	3 OF 4
REVIT FILE NAME		PAPER DRAWING ID		ISSUE
or-ms-i		or-ms-i-3		5

iHFG Standard Components

Room Layout Sheet

RLS Room Code

or-ms-i

RDS Room Code

or-ms-i

Room Name

Operating Room - Minor

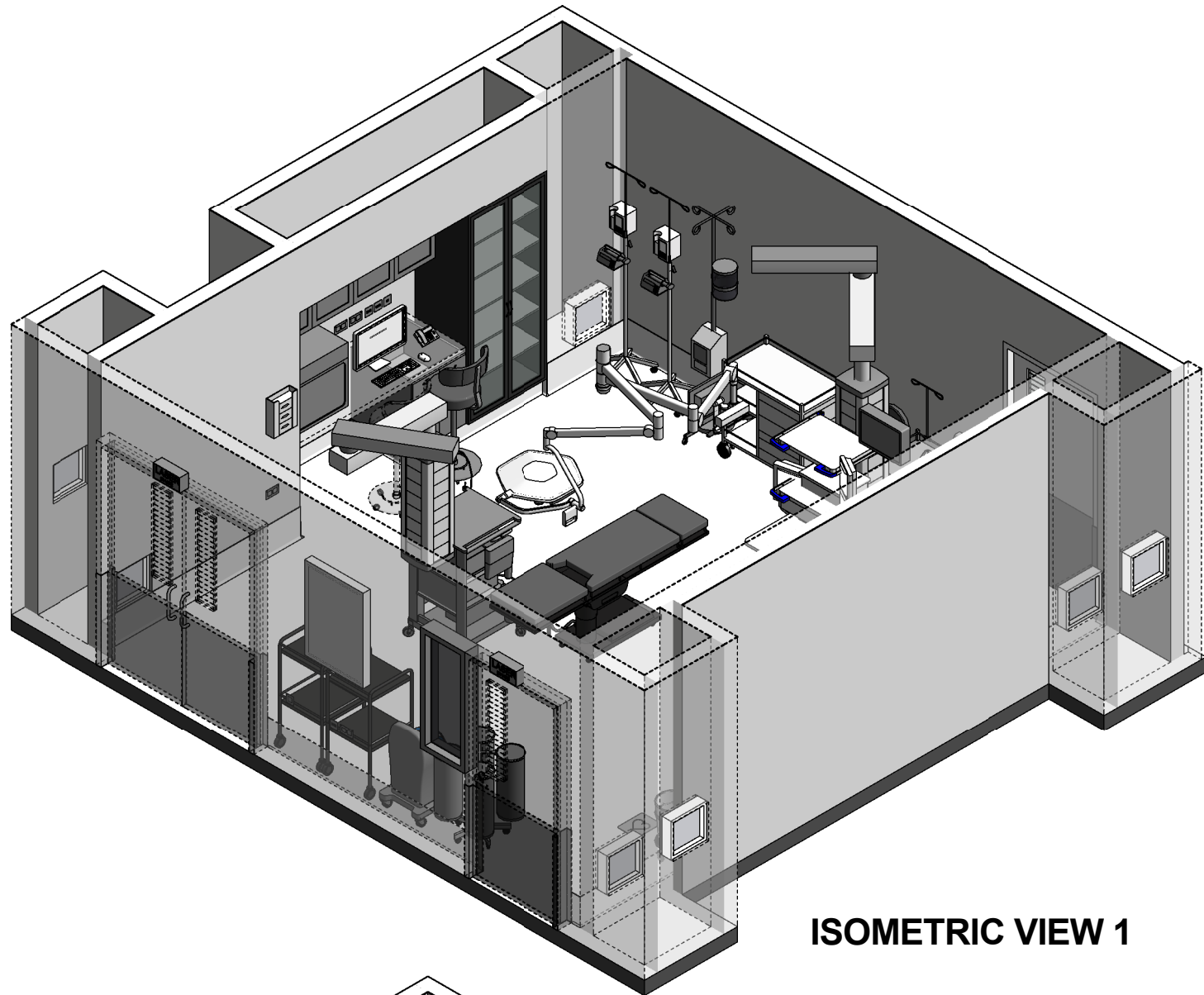

ISOMETRIC VIEW 1

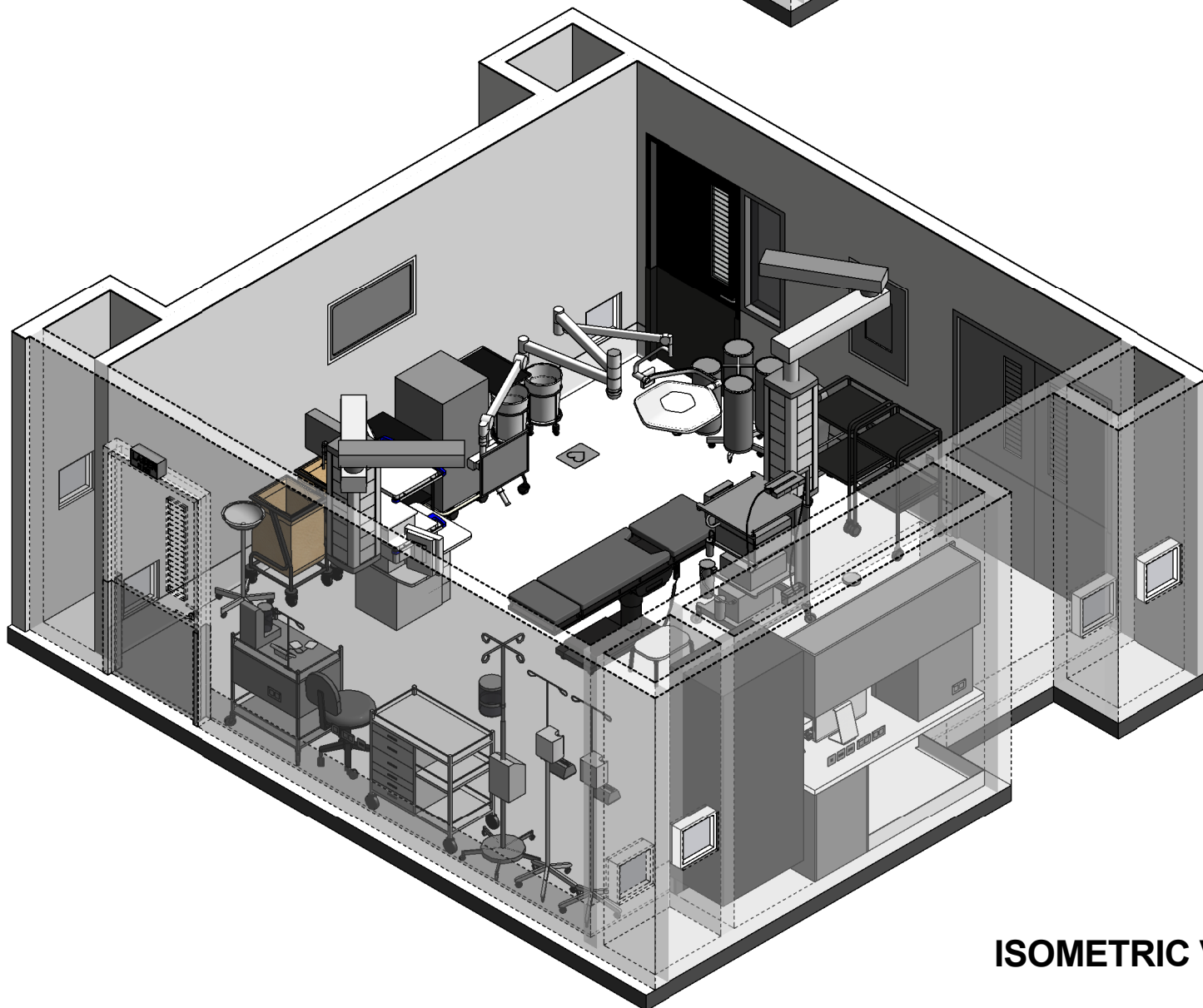

ISOMETRIC VIEW 2

REV	DESCRIPTION	DATE	BY	REV	DESCRIPTION	DATE	BY	COMPATIBILITY
1	FIRST ISSUE	24.10.10	LL	4	GENERAL REVISION	26.10.15	PJ	iHFG
2	GENERAL REVISION	30.08.11	SD	5	GENERAL REVISION	31.10.22	AM	
3	GENERAL REVISION	31.10.12	CT					

DESIGNED	APPROVED	DATE	SCALE(S)	SHEET
AK	RH	31.10.22		4 OF 4
REVIT FILE NAME		PAPER DRAWING ID		ISSUE
or-ms-i		or-ms-i-4		5