

iHFG Standard Components

Room Layout Sheet

Room Name | Parenting Room, 6m²

RLS Room Code PAR-I
RDS Room Code PAR-I

Abbreviations

BCHT	BABY CHANGE TABLE
BN/L	BENCHTOP - LAMINATE
CHR/L	CHAIR - LOUNGE
COH	COAT HOOK
DFP	DOOR AND DOOR FRAME PROTECTION
DHT	DISPENSER - HAND TOWEL
DS	DISPENSER - SOAP
GPO/2	GENERAL POWER OUTLET - DOUBLE
LS/R	LIGHT SWITCH - ROOM
MR	MIRROR
OMW	OVEN: MICROWAVE
SBK	SPLASHBACK
SNK	STAINLESS STEEL SINK
TMSL	TAP MIXER, SINGLE LEVER
WBP	WASTE BIN, PAPER
V1	VINYL FLOORING, STANDARD SLIP RESISTANT
SK4	FLOOR VINYL COVERED SKIRTING
WPF	WALL PAINT FINISH

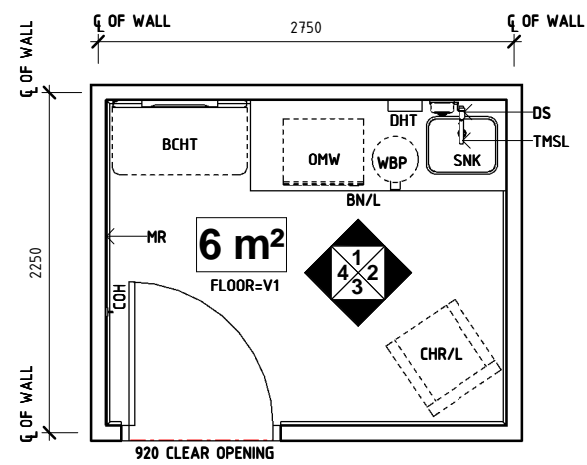

PLAN

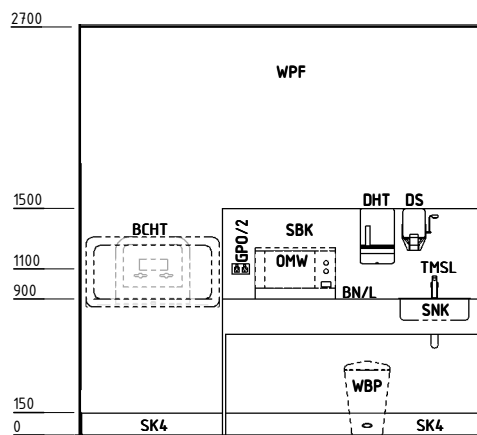

ELEVATION 1

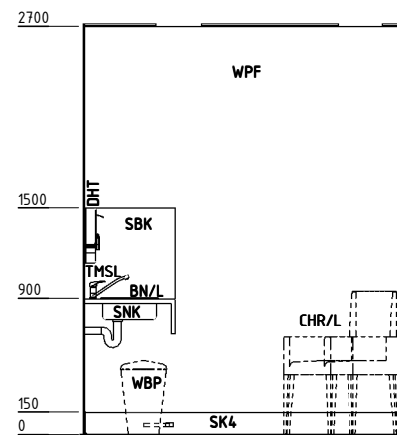

ELEVATION 2

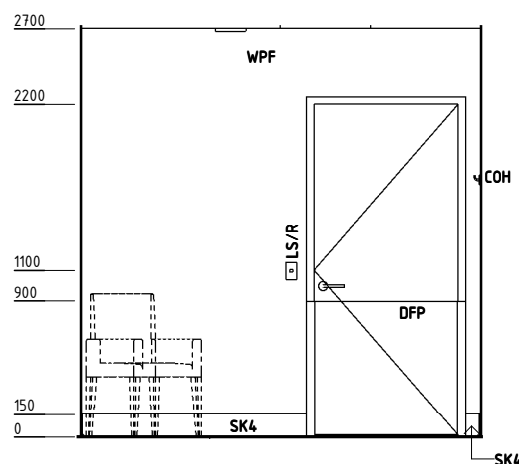

ELEVATION 3

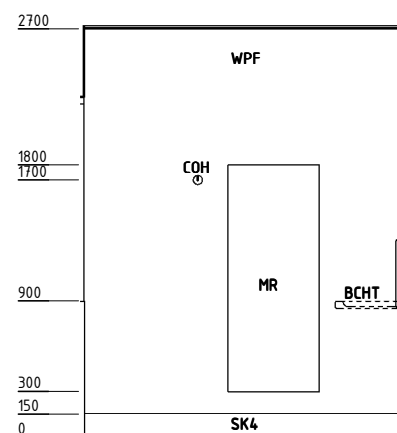

ELEVATION 4

REV	DESCRIPTION	DATE	BY	REV	DESCRIPTION	DATE	BY	REV	DESCRIPTION	DATE	BY
1	FIRST ISSUE	26.06.2015	TT								

iHFG Standard Components

Room Layout Sheet

Room Name | Parenting Room, 6m²

RLS Room Code | PAR-I
RDS Room Code | PAR-I

GENERAL NOTES:

THIS DRAWING TO BE READ IN CONJUNCTION WITH R.D.S. (ROOM DATA SHEETS) WHICH TAKES PRECEDENCE.

ALL SERVICES INDICATED ARE INDICATIVE AND SUBJECT TO DETAILED PROJECT SPECIFIC ENGINEERING DESIGN.

CEILING LEGEND:

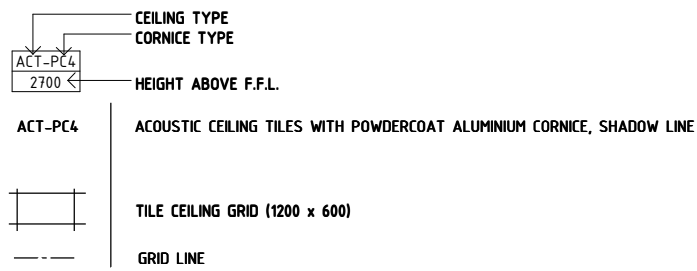

ELECTRICAL LEGEND:

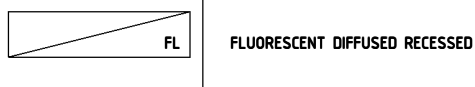

MECHANICAL LEGEND:

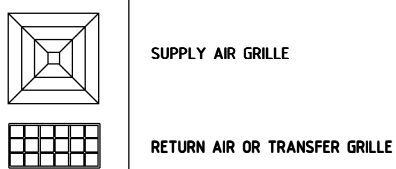

FIRE SERVICES LEGEND:

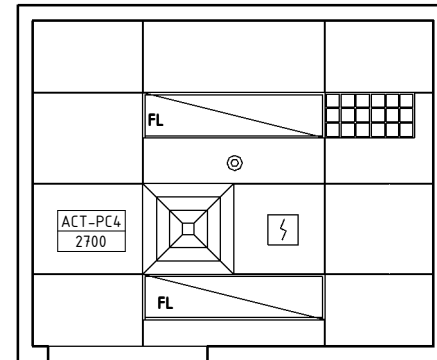
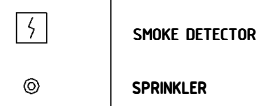

REFLECTED CEILING PLAN

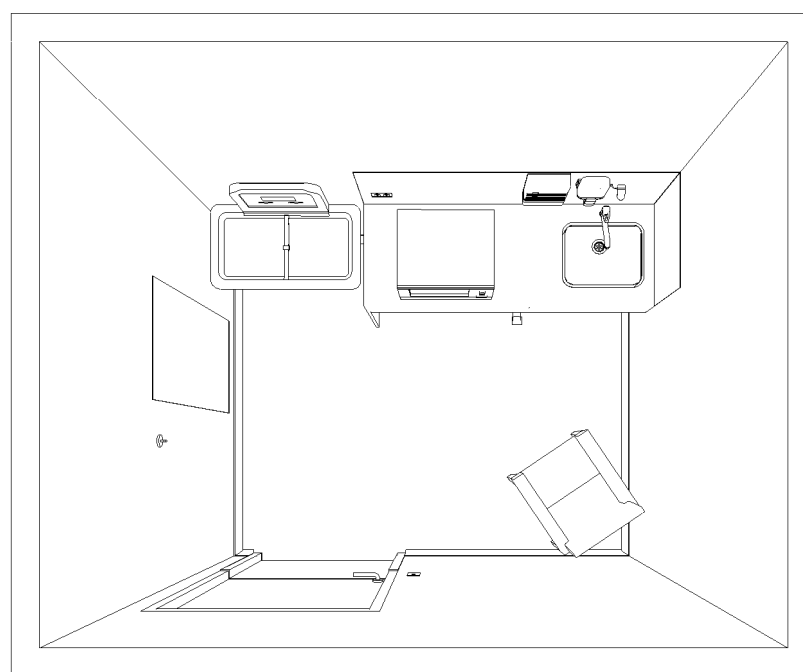

PERSPECTIVE - PLAN VIEW

REV	DESCRIPTION	DATE	BY	REV	DESCRIPTION	DATE	BY	REV	DESCRIPTION	DATE	BY
1	FIRST ISSUE	26.06.2015	TT								

iHFG Standard Components

Room Layout Sheet

Room Name | Parenting Room, 6m²

RLS Room Code PAR-I
RDS Room Code PAR-I

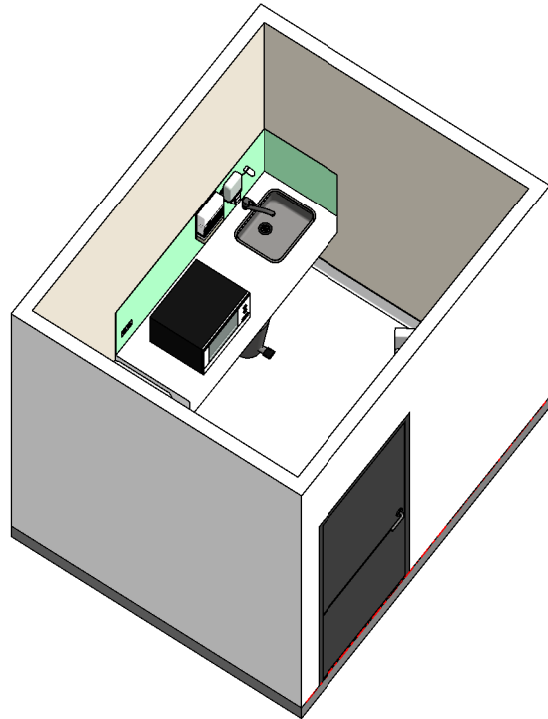

ISOMETRIC VIEW 01

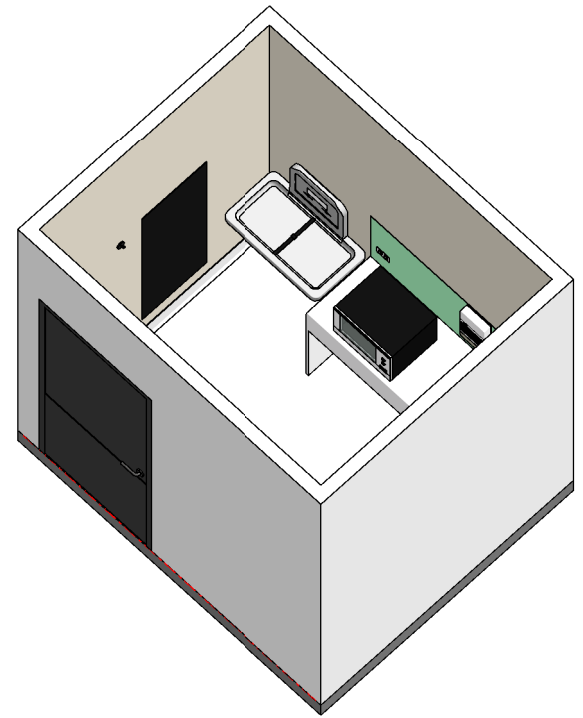

ISOMETRIC VIEW 02



PERSPECTIVE 01

REV	DESCRIPTION	DATE	BY	REV	DESCRIPTION	DATE	BY	REV	DESCRIPTION	DATE	BY
1	FIRST ISSUE	26.06.2015	TT								



The International Health Facility Guidelines recommends the use of HFBS “Health Facility Briefing System” to edit all room data sheet information for your project.

HFBS provides edit access to all iHFG standard rooms, and departments, and more than 100 custom report templates.

HFBS Health Facility Briefing System



Briefing Module

The Health Facility Briefing System (HFBS) has numerous modules available via annual subscription. It suits healthcare Architects, Medical Planners, Equipment Planners Project Managers and Health Authorities.

Use the HFBS Briefing Module to quickly drag in health facility departments or pre-configured room templates from the iHFG standard, edit the room features such as finishes, furniture, fittings, fixtures, medical equipment, engineering services. The system can print or download as PDF more than 100 custom reports including room data sheets, schedules, and more...

To learn more about the HFBS web-based Healthcare Briefing and Design Software and to obtain editable versions of the “Standard Components” including Room Data Sheets (RDS) and Room Layout Sheets (RLS) offered on the iHFG website, signup for HFBS using the link below.

Get Started Now:
hfbs.healthdesign.com.au

- ✓ iHFG Room Data Sheets and Departments are instantly editable in the HFBS software available online.
- ✓ You can access hundreds of report templates to print your iHFG room data in HFBS.
- ✓ HFBS has a onetime free 3 day trial available to all new users.

Get Started Now:
hfbs.healthdesign.com.au



HFBS

Health Facility Briefing System

hfbsinfo.com | techsupport@healthdesign.com.au