

# iHFG Standard Components

## Room Layout Sheet

Room Name **Podiatry Treatment, 15m2**

RLS Room Code

podt-15-i

RDS Room Code

podt-15-i

- AS ADJUSTABLE SHELF
- BH/PB BULKHEAD - PLASTERBOARD, PAINT FINISH
- BLR BLIND - ROLLER
- BNL BENCH - LAMINATE
- BRCS BRACKET - SHARPS
- BRCSB BRACKET - SUCTION BOTTLE
- CBD/UB CUPBOARD - UNDER BENCH
- CBD/WL CUPBOARD - WALL MOUNTED, LOCKABLE
- CHR/PE CHAIR - PODIATRY, ELECTRIC
- CMP COMPUTER
- COM/1 COMMUNICATION OUTLET - SINGLE
- COM/2 COMMUNICATION OUTLET - DOUBLE
- DDG DISPENSER - DISPOSABLE GLOVES
- DFP DOOR AND DOOR FRAME PROTECTION
- DHT DISPENSER - PAPER HAND TOWEL
- DM DISPENSER - MASK
- DSA DISPENSER - SOAP, ANTISEPTIC
- EC EMERGENCY CALL
- HWB/B HAND WASH BASIN - TYPE 'B'
- L/EXC LIGHT - EXAMINATION, CEILING MOUNTED
- L/PT LIGHT - PELMET TASK LIGHT
- LS/EL LIGHT SWITCH - EXAMINATION LIGHT
- LS/P LIGHT SWITCH - PELMET TASK LIGHT
- LS/R LIGHT SWITCH - ROOM
- MA MEDICAL AIR
- MON/PVO MONITOR - PHYSIOLOGIC, VITAL SIGNS, ON STAND
- O2 OXYGEN
- OP OBSERVATION PANEL
- PC PATIENT CALL
- PCH PATIENT CALL HANDSET
- PO/1 POWER OUTLET - SINGLE
- PO/1E POWER OUTLET - EMERGENCY, SINGLE
- PO/2 POWER OUTLET - DOUBLE
- PO/2E POWER OUTLET - EMERGENCY, DOUBLE
- PO/C POWER OUTLET - CLEANER'S
- PT PLASTER TRAP
- S SUCTION
- SAC STAFF ASSIST CALL
- SB SUCTION BOTTLE
- SBIN SHARPS BIN
- SBK SPLASHBACK
- SK4 FLOOR VINYL COVERED SKIRTING
- SNK12 SINK WITH DRAINER - SINGLE
- SP SERVICES PANEL
- STAM STOOL - ADJUSTABLE, MOBILE
- T/MUL TROLLEY - MULTIPURPOSE
- TAP/M TAPWARE - MIXER

- TAP/ST TAPWARE - SENSOR TAP
- TP/HS TELEPHONE - HANDSET, STANDARD
- V1 VINYL FLOORING, STANDARD SLIP RESISTANT
- V6 VINYL FLOORING, NON SLIP - TEXTURED
- WBC/50 WASTE BIN - CLINICAL, 50 LITRE
- WBG/20 WASTE BIN - GENERAL, 20 LITRE
- WPF WALL PAINT FINISH

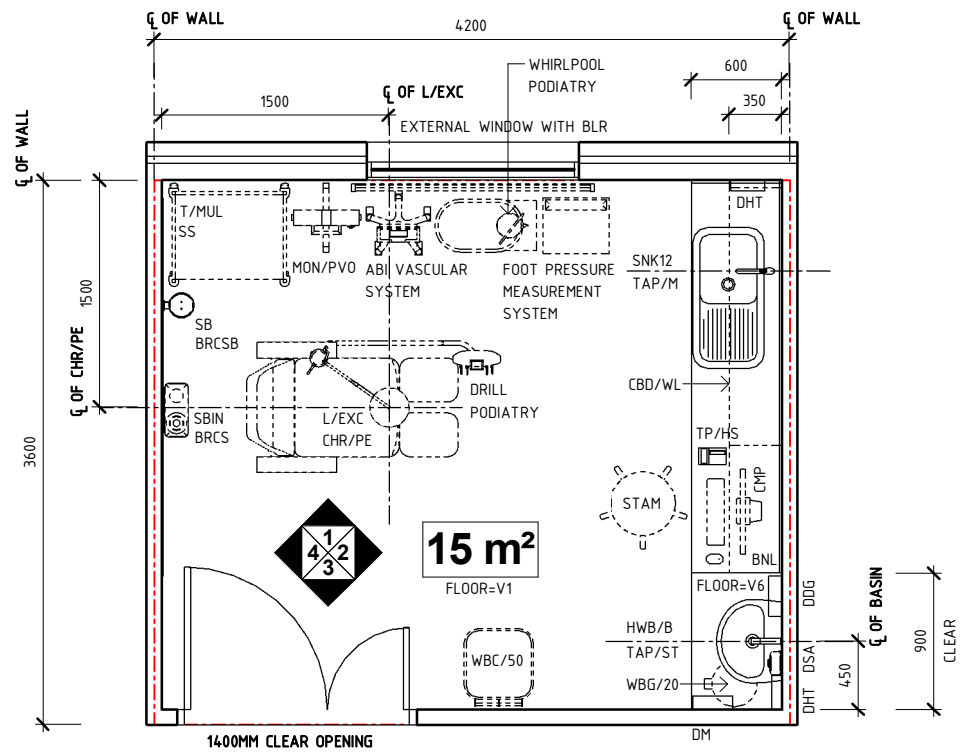

**PLAN**

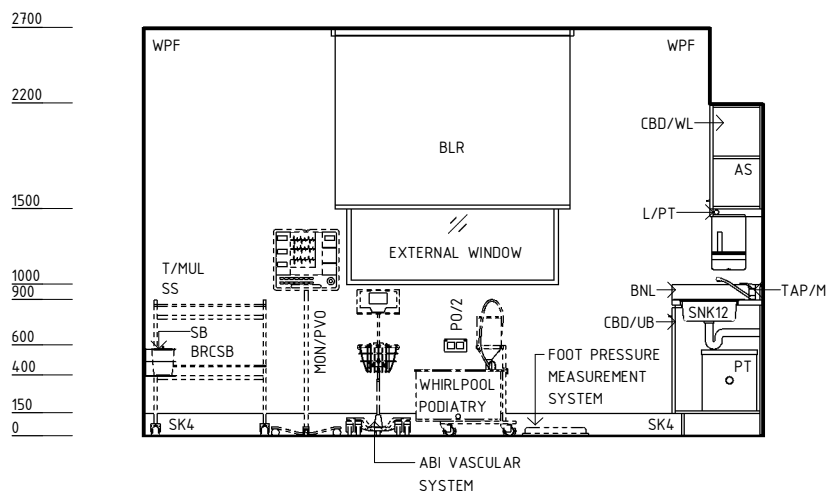

**ELEVATION 1**

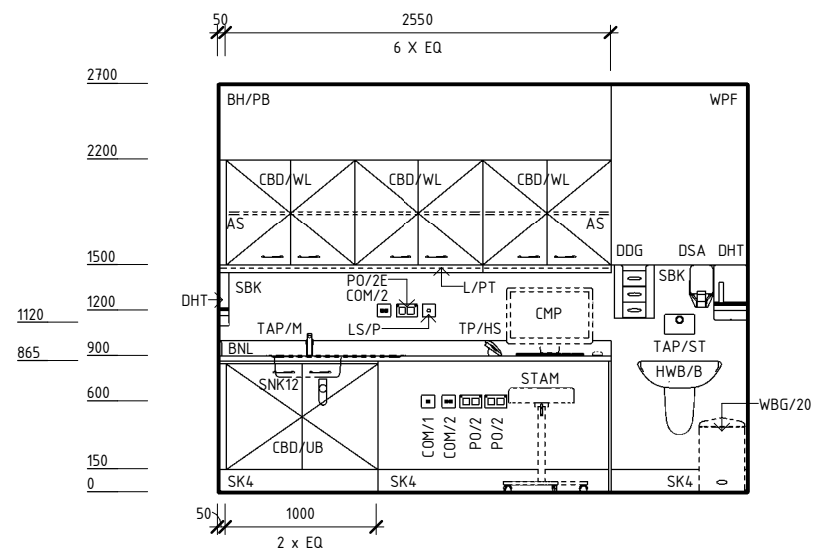

**ELEVATION 2**

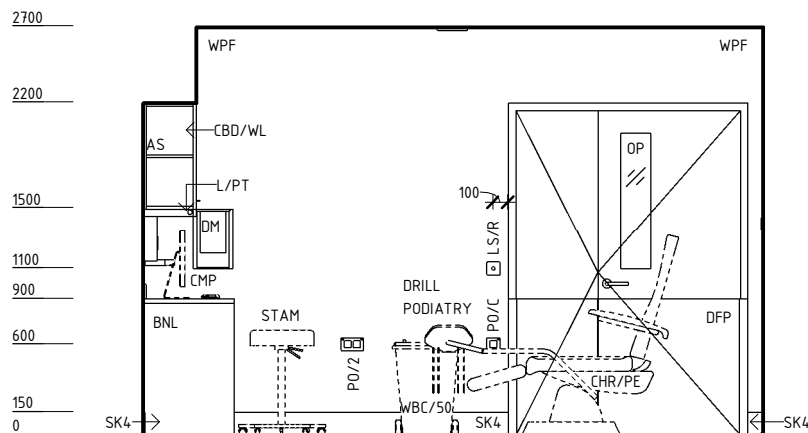

**ELEVATION 3**

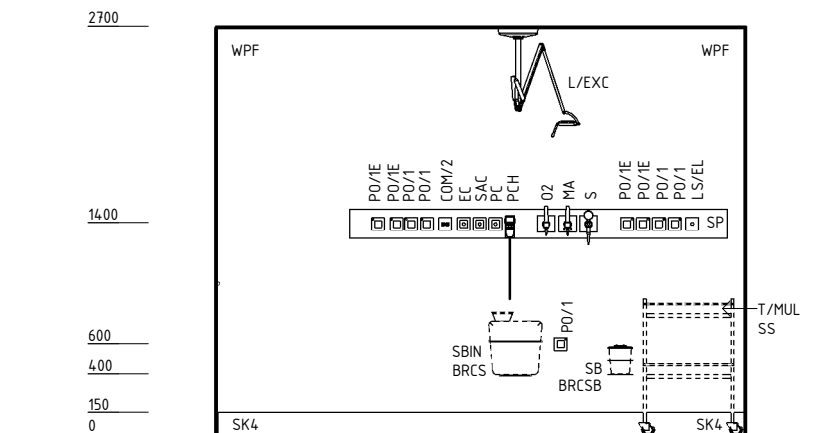

**ELEVATION 4**

| REV | DESCRIPTION      | DATE     | BY | REV | DESCRIPTION      | DATE     | BY | COMPATIBILITY |
|-----|------------------|----------|----|-----|------------------|----------|----|---------------|
| 1   | FIRST ISSUE      | 24.10.10 | LL | 4   | GENERAL REVISION | 27.01.23 | AM | iHFG          |
| 2   | GENERAL REVISION | 30.08.11 | SK |     |                  |          |    |               |
| 3   | GENERAL REVISION | 31.10.12 | CT |     |                  |          |    |               |



International Health Facility Guidelines at:  
www.healthdesign.com.au/iHFG  
Editable version of Standard Components on  
Health Facility Briefing System (HFBS) at:  
www.healthdesign.com.au ©TAHPI



| DESIGNED        | APPROVED | DATE             | SCALE(S) | SHEET  |
|-----------------|----------|------------------|----------|--------|
| AM              | SA       | 27.01.23         | 1 : 50   | 1 OF 2 |
| REVIT FILE NAME |          | PAPER DRAWING ID |          | ISSUE  |
| podt-15-i       |          | podt-15-i-1      |          | 4      |

# iHFG Standard Components

## Room Layout Sheet

RLS Room Code

podt-15-i

RDS Room Code

podt-15-i

Room Name

Podiatry Treatment, 15m2

### GENERAL NOTES:

THIS DRAWING TO BE READ IN CONJUNCTION WITH R.D.S. (ROOM DATA SHEETS) WHICH TAKES PRECEDENCE.

ALL SERVICES INDICATED ARE INDICATIVE AND SUBJECT TO DETAILED PROJECT SPECIFIC ENGINEERING DESIGN.

### CEILING LEGEND:

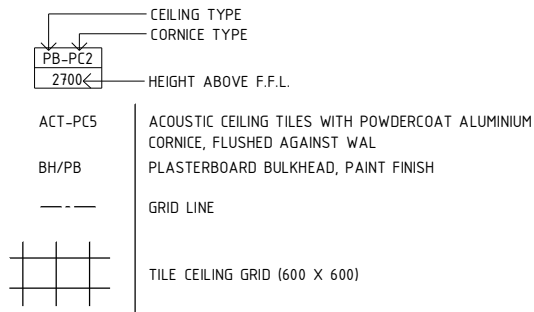

### ELECTRICAL LEGEND:

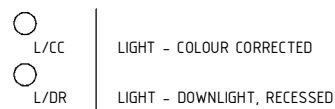

### MECHANICAL LEGEND:

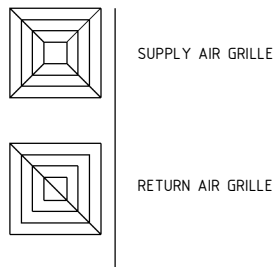

### FIRE SERVICES LEGEND:

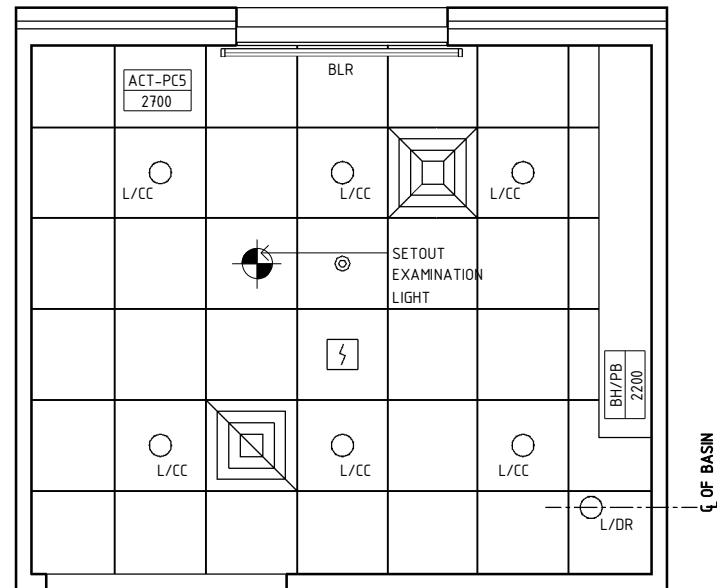
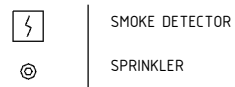

REFLECTED CEILING PLAN



ISOMETRIC VIEW 01

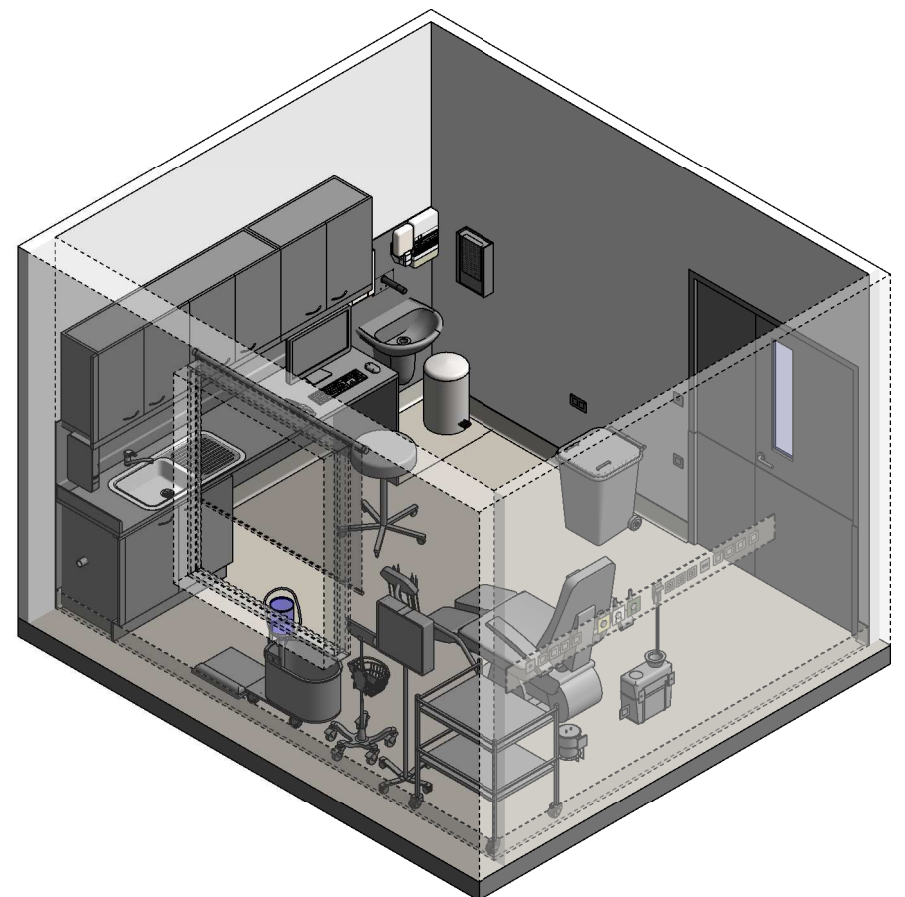

ISOMETRIC VIEW 02

| REV | DESCRIPTION      | DATE     | BY | REV | DESCRIPTION      | DATE     | BY | COMPATIBILITY   |          |                  |          |        |
|-----|------------------|----------|----|-----|------------------|----------|----|-----------------|----------|------------------|----------|--------|
| 1   | FIRST ISSUE      | 24.10.10 | LL | 4   | GENERAL REVISION | 27.01.23 | AM | iHFG            |          |                  |          |        |
| 2   | GENERAL REVISION | 30.08.11 | SK |     |                  |          |    |                 |          |                  |          |        |
| 3   | GENERAL REVISION | 31.10.12 | CT |     |                  |          |    |                 |          |                  |          |        |
|     |                  |          |    |     |                  |          |    | DESIGNED        | APPROVED | DATE             | SCALE(S) | SHEET  |
|     |                  |          |    |     |                  |          |    | AM              | SA       | 27.01.23         | 1 : 50   | 2 OF 2 |
|     |                  |          |    |     |                  |          |    | REVIT FILE NAME |          | PAPER DRAWING ID |          | ISSUE  |
|     |                  |          |    |     |                  |          |    | podt-15-i       |          | podt-15-i-2      |          | 4      |