

iHFG Standard Components

Room Layout Sheet

Room Name | Reception/ Clerical, 15m2

RLS Room Code

recl-15-i

RDS Room Code

recl-15-i

| | |
|--------|---------------------------------------|
| AS | ADJUSTABLE SHELF |
| BH/PB | BULKHEAD - PLASTERBOARD, PAINT FINISH |
| BNL | BENCH - LAMINATE |
| CAC | CABLE ACCESS CAP |
| CBD/UB | CUPBOARD - UNDER BENCH |
| CBD/W | CUPBOARD - WALL MOUNTED |
| CHR/E | CHAIR - ERGONOMIC, OFFICE |
| CMP | COMPUTER |
| COM/2 | COMMUNICATION OUTLET - DOUBLE |
| COU/DA | COUNTER - DISABLED ACCESS |
| CPT | CARPET |
| CTRT | COUNTER TOP |
| DA | DURESS ALARM |
| DFP | DOOR AND FRAME PROTECTION |
| L/PT | LIGHT - PELMET TASK LIGHT |
| LS/P | LIGHT SWITCH - PELMET TASK LIGHT |
| LVP | LAMINATED VERTICAL SUPPORT PANEL |
| PFU/M | PEDESTAL FILING UNIT - MOBILE |
| PO/2 | POWER OUTLET - DOUBLE |
| PO/C | POWER OUTLET - CLEANER'S |
| PPFS | PRINTER / PHOTOCOPIER / FAX / SCANNER |
| PRT/N | PRINTER - NETWORKED |
| REC/LT | RECEPTION DESK - LAMINATE/ TIMBER |
| SK7 | TIMBER SKIRTING |
| SK10 | LAMINATE SKIRTING |
| SSSG | SECURITY SCREEN - SAFETY GLASS |
| TP/HS | TELEPHONE - HANDSET, STANDARD |
| WBP/20 | WASTE BIN - PAPER, 20 LITRE |
| WCH | WHEELCHAIR |
| WPF | WALL PAINT FINISH |

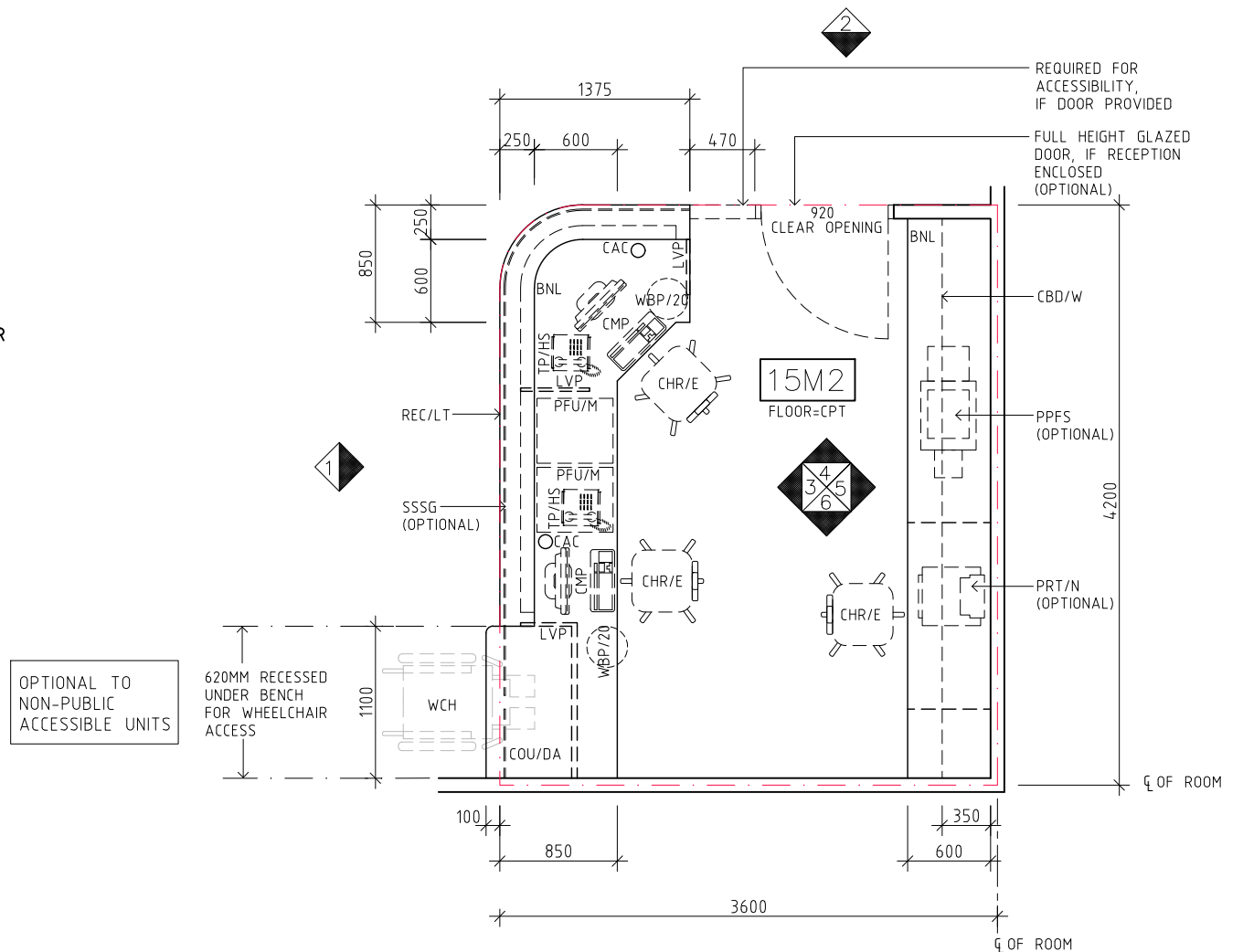

PLAN

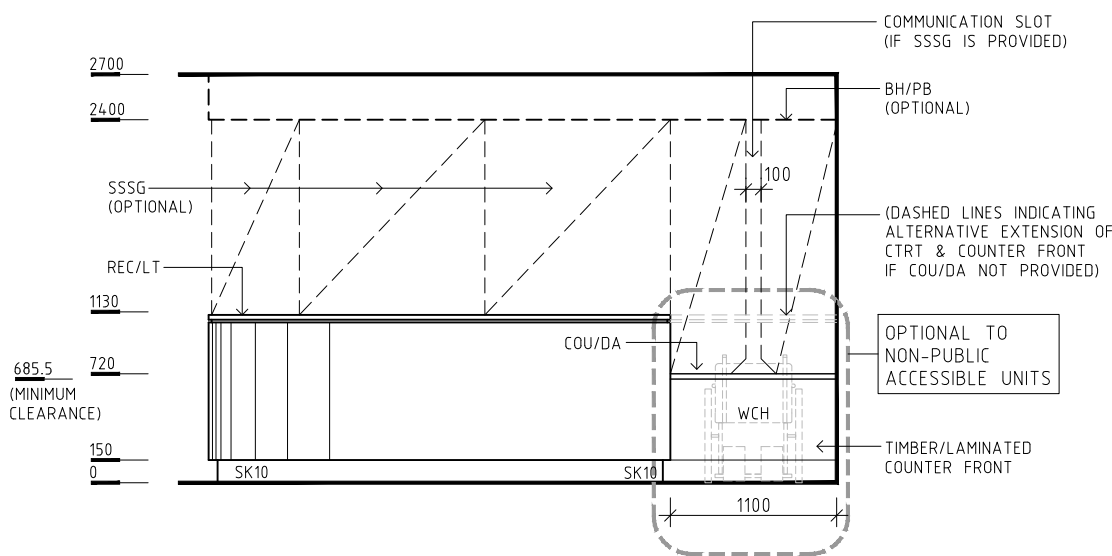

ELEVATION 1

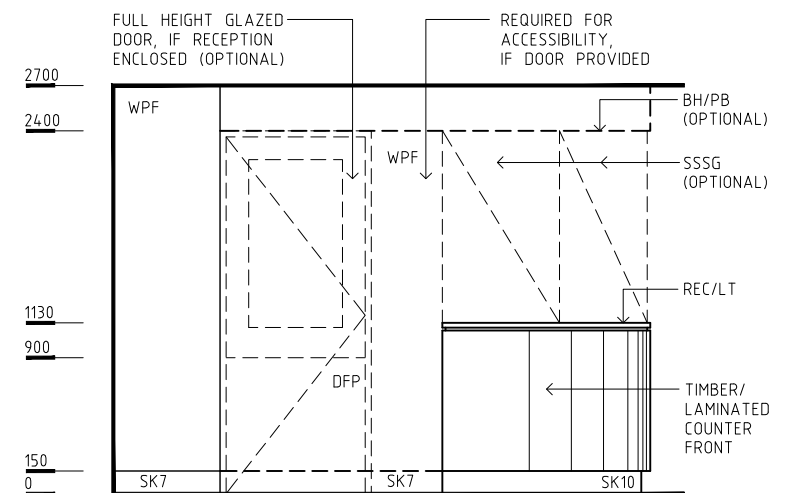

ELEVATION 2

| REV | DESCRIPTION | DATE | BY | REV | DESCRIPTION | DATE | BY | COMPATIBILITY |
|-----|------------------|----------|----|-----|------------------|----------|----|---------------|
| 1 | FIRST ISSUE | 24.10.10 | CC | 4 | GENERAL REVISION | 30.12.22 | RA | |
| 2 | GENERAL REVISION | 30.08.11 | SK | | | | | |
| 3 | GENERAL REVISION | 31.10.12 | KC | | | | | |

iHFG Standard Components

Room Layout Sheet

Room Name | Reception/ Clerical, 15m2

RLS Room Code

recl-15-i

RDS Room Code

recl-15-i

| | |
|--------|---------------------------------------|
| AS | ADJUSTABLE SHELF |
| BH/PB | BULKHEAD - PLASTERBOARD, PAINT FINISH |
| BNL | BENCH - LAMINATE |
| CAC | CABLE ACCESS CAP |
| CBD/UB | CUPBOARD - UNDER BENCH |
| CBD/W | CUPBOARD - WALL MOUNTED |
| CHR/E | CHAIR - ERGONOMIC, OFFICE |
| CMP | COMPUTER |
| COM/2 | COMMUNICATION OUTLET - DOUBLE |
| COU/DA | COUNTER - DISABLED ACCESS |
| CPT | CARPET |
| CTRT | COUNTER TOP |
| DA | DURESS ALARM |
| DFP | DOOR AND FRAME PROTECTION |
| L/PT | LIGHT - PELMET TASK LIGHT |
| LS/P | LIGHT SWITCH - PELMET TASK LIGHT |
| LVP | LAMINATED VERTICAL SUPPORT PANEL |
| PFU/M | PEDESTAL FILING UNIT - MOBILE |
| PO/2 | POWER OUTLET - DOUBLE |
| PO/C | POWER OUTLET - CLEANER'S |
| PPFS | PRINTER / PHOTOCOPIER / FAX / SCANNER |
| PRT/N | PRINTER - NETWORKED |
| REC/LT | RECEPTION DESK - LAMINATE/ TIMBER |
| SK7 | TIMBER SKIRTING |
| SK10 | LAMINATE SKIRTING |
| SSSG | SECURITY SCREEN - SAFETY GLASS |
| TP/HS | TELEPHONE - HANDSET, STANDARD |
| WBP/20 | WASTE BIN - PAPER, 20 LITRE |
| WCH | WHEELCHAIR |
| WPF | WALL PAINT FINISH |

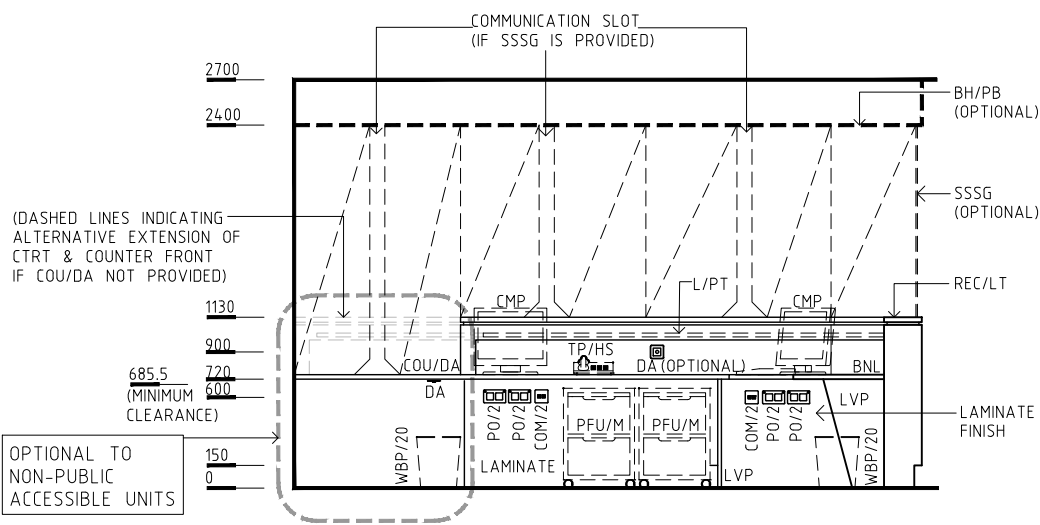

ELEVATION 3

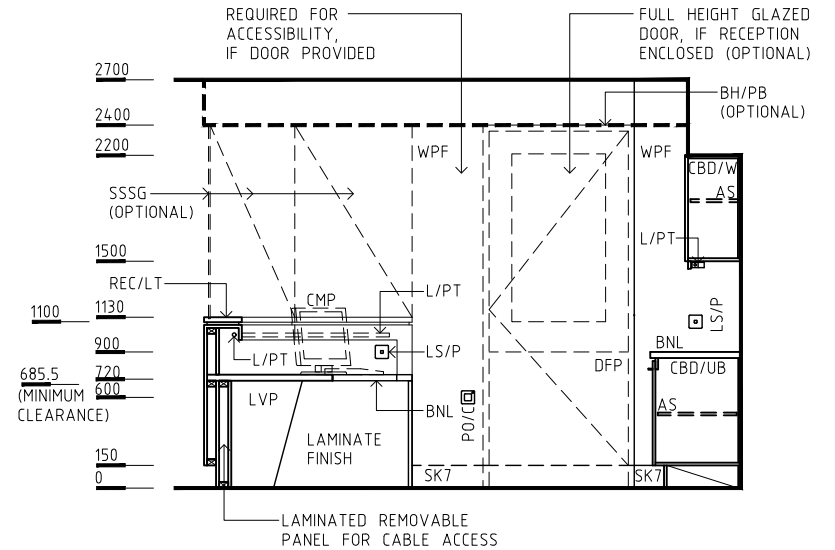

ELEVATION 4

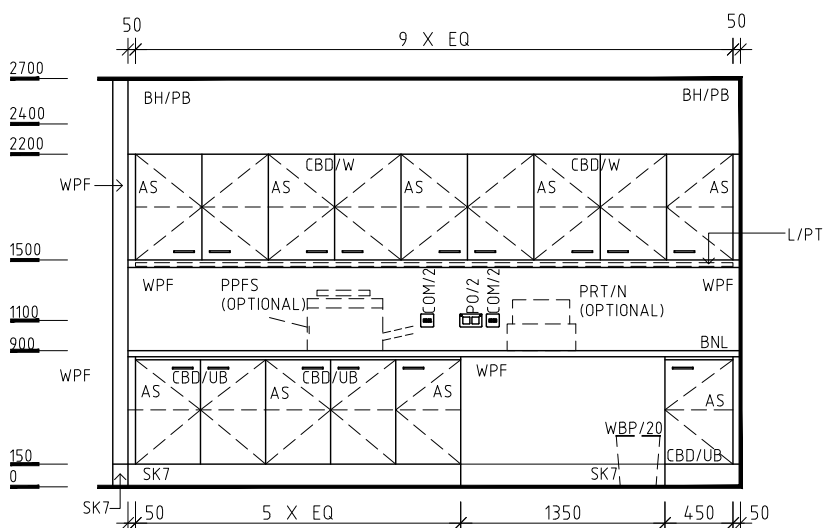

ELEVATION 5

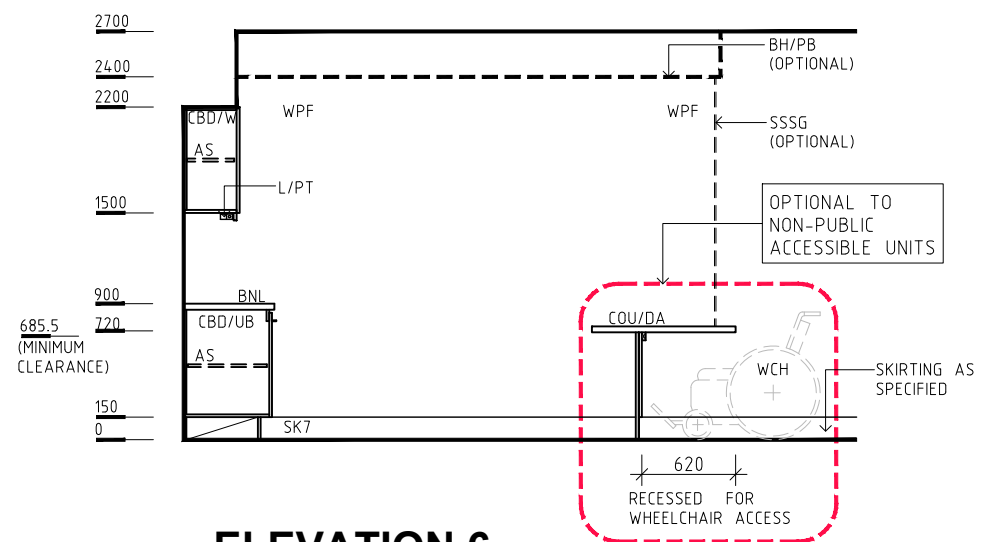

ELEVATION 6

| REV | DESCRIPTION | DATE | BY | REV | DESCRIPTION | DATE | BY | COMPATIBILITY |
|-----|------------------|----------|----|-----|------------------|----------|----|---------------|
| 1 | FIRST ISSUE | 24.10.10 | CC | 4 | GENERAL REVISION | 30.12.22 | RA | iHFG |
| 2 | GENERAL REVISION | 30.08.11 | SK | | | | | |
| 3 | GENERAL REVISION | 31.10.12 | KC | | | | | |

iHFG Standard Components

Room Layout Sheet

Room Name **Reception/ Clerical, 15m2**

RLS Room Code

recl-15-i

RDS Room Code

recl-15-i

GENERAL NOTES:

THIS DRAWING TO BE READ IN CONJUNCTION WITH R.D.S. (ROOM DATA SHEETS) WHICH TAKES PRECEDENCE.

ALL SERVICES INDICATED ARE INDICATIVE AND SUBJECTED TO DETAILED PROJECT SPECIFIC ENGINEERING DESIGN.

CEILING LEGEND:

- ACT ACOUSTIC CEILING TILES
 - BH/PB BULKHEAD - PLASTERBOARD, PAINT FINISH
 - PB PLASTERBOARD FLUSH SET CEILING, PAINT
 - PC4 SHADOW ANGLE, POWDERCOAT ALUMINIUM CORNICE
- PB CEILING TYPE
2700 HEIGHT ABOVE F.F.L.

ELECTRICAL LEGEND:

- LIGHT - DOWNLIGHT, RECESSED
- LIGHT- LED LIGHT

MECHANICAL LEGEND:

- SUPPLY AIR GRILLE
- RETURN AIR GRILLE

FIRE SERVICES LEGEND:

- SMOKE DETECTOR
- SPRINKLER

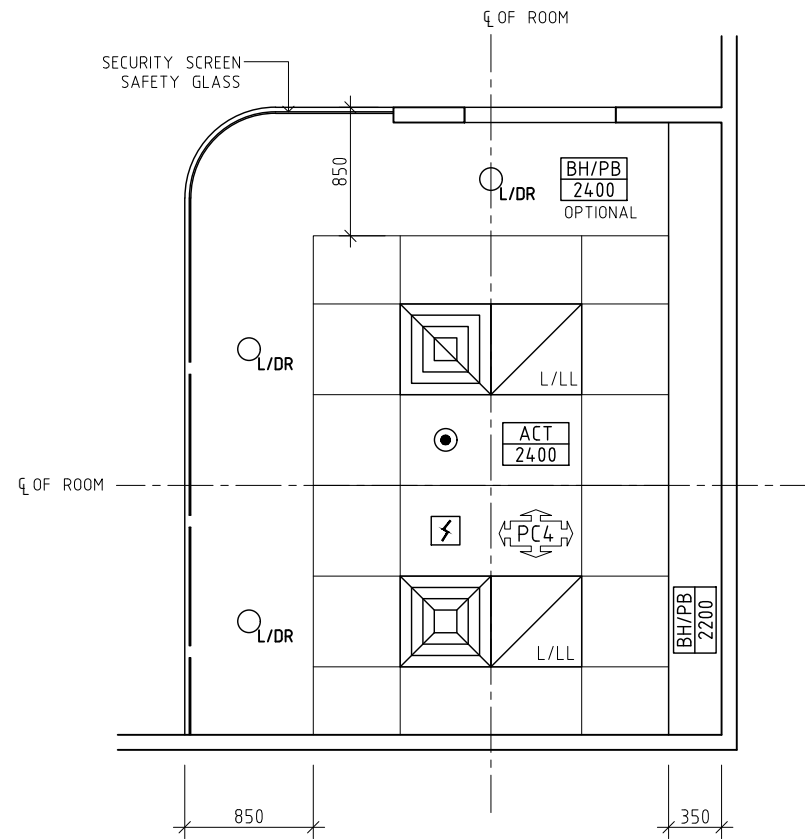

REFLECTED CEILING PLAN

| REV | DESCRIPTION | DATE | BY | REV | DESCRIPTION | DATE | BY | COMPATIBILITY |
|-----|------------------|----------|----|-----|------------------|----------|----|---------------|
| 1 | FIRST ISSUE | 24.10.10 | CC | 4 | GENERAL REVISION | 30.12.22 | RA | |
| 2 | GENERAL REVISION | 30.08.11 | SK | | | | | |
| 3 | GENERAL REVISION | 31.10.12 | KC | | | | | |

| DESIGNED | APPROVED | DATE | SCALE(S) | SHEET |
|---------------|----------|------------------|------------|--------|
| RA | RH | 30.12.22 | 1:50 in A3 | 3 OF 3 |
| CAD FILE NAME | | PAPER DRAWING ID | | ISSUE |
| recl-15-i | | recl-15-i-3 | | 1 |