

# iHFG Standard Components

## Room Layout Sheet

RLS Room Code

steq-10-i

RDS Room Code

steq-10-i

Room Name | **Store - Equipment, 10m<sup>2</sup>**

- CR CRASH RAIL
- H/EQ HOOK - EQUIPMENT
- LS LIGHT SWITCH
- PO/2 POWER OUTLET - DOUBLE
- SHM METAL SHELVING
- SK4 FLOOR VINYL COVERED SKIRTING
- V1 VINYL FLOORING, STANDARD SLIP RESISTANT
- WPF WALL PAINT FINISH

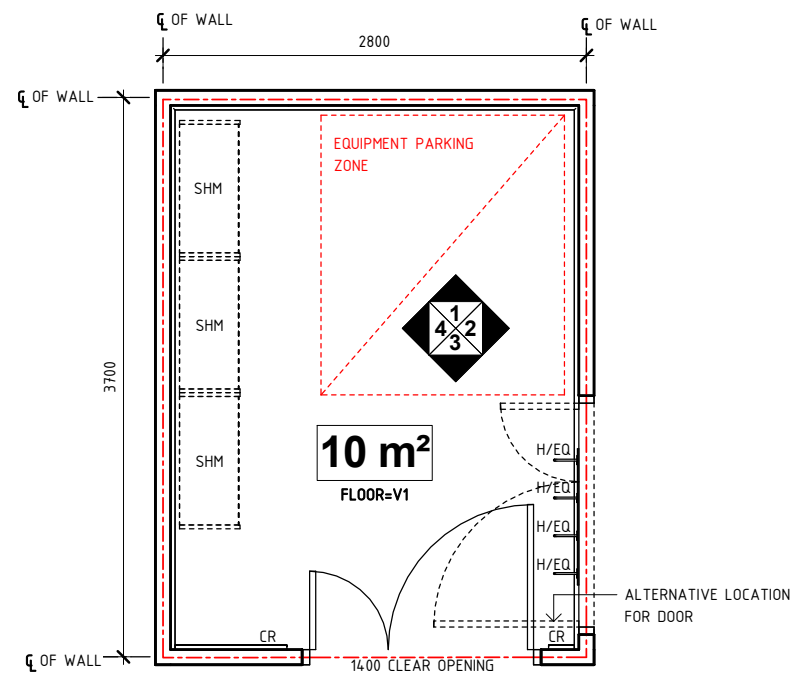

**PLAN**

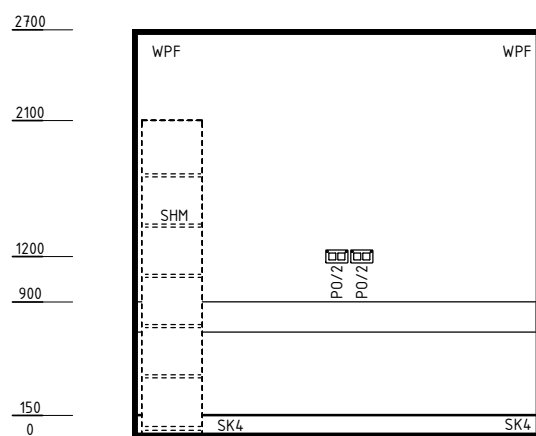

**ELEVATION 1**

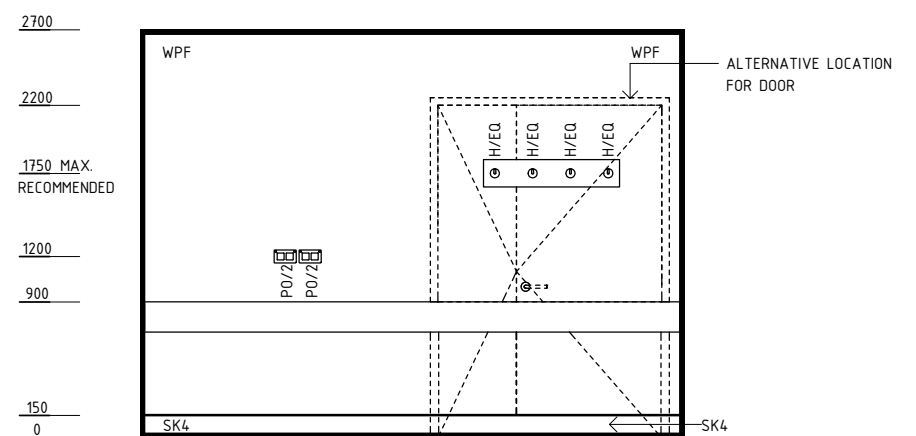

**ELEVATION 2**

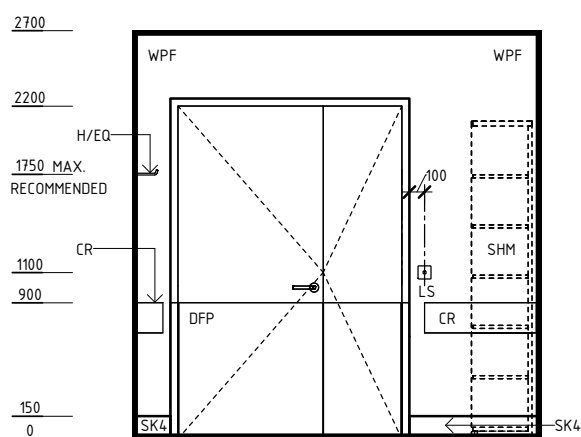

**ELEVATION 3**

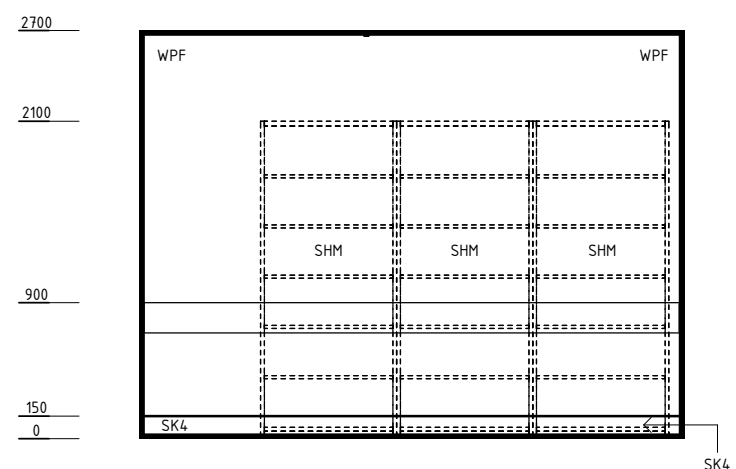

**ELEVATION 4**

REV	DESCRIPTION	DATE	BY	REV	DESCRIPTION	DATE	BY	COMPATIBILITY																				
1	FIRST ISSUE	24.10.10	CC	4	GENERAL REVISION	30.12.22	RA																					
2	GENERAL REVISION	30.08.11	SK																									
3	GENERAL REVISION	31.10.12	KC																									
								<table border="1"> <tr> <th>DESIGNED</th> <th>APPROVED</th> <th>DATE</th> <th>SCALE(S)</th> <th>SHEET</th> </tr> <tr> <td>RA</td> <td>RH</td> <td>30.12.22</td> <td>1 : 50</td> <td>1 OF 2</td> </tr> <tr> <th colspan="2">REVIT FILE NAME</th> <th colspan="2">PAPER DRAWING ID</th> <th>ISSUE</th> </tr> <tr> <td colspan="2">steq-10-i</td> <td colspan="2">steq-10-i-1</td> <td>4</td> </tr> </table>	DESIGNED	APPROVED	DATE	SCALE(S)	SHEET	RA	RH	30.12.22	1 : 50	1 OF 2	REVIT FILE NAME		PAPER DRAWING ID		ISSUE	steq-10-i		steq-10-i-1		4
DESIGNED	APPROVED	DATE	SCALE(S)	SHEET																								
RA	RH	30.12.22	1 : 50	1 OF 2																								
REVIT FILE NAME		PAPER DRAWING ID		ISSUE																								
steq-10-i		steq-10-i-1		4																								

# iHFG Standard Components

## Room Layout Sheet

RLS Room Code

steq-10-i

RDS Room Code

steq-10-i

Room Name | Store - Equipment, 10m<sup>2</sup>

### GENERAL NOTES:

THIS DRAWING TO BE READ IN CONJUNCTION WITH R.D.S. (ROOM DATA SHEETS) WHICH TAKES PRECEDENCE.

ALL SERVICES INDICATED ARE INDICATIVE AND SUBJECT TO DETAILED PROJECT SPECIFIC ENGINEERING DESIGN.

### CEILING LEGEND:

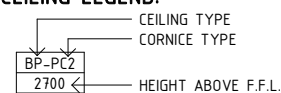

- PBT-PC4 | PLASTERBOARD DROP-IN CEILING TILES (PREFINISHED) WITH POWDERCOAT ALUMINIUM CORNICE, SHADOW ANGLE 24mm
- | TILE CEILING GRID (600 x 600)
- | GRID LINE

### ELECTRICAL LEGEND:

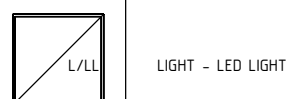

### MECHANICAL LEGEND:

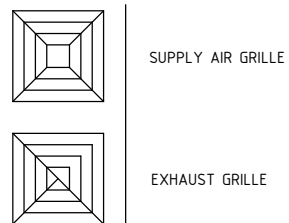

### FIRE SERVICES LEGEND:

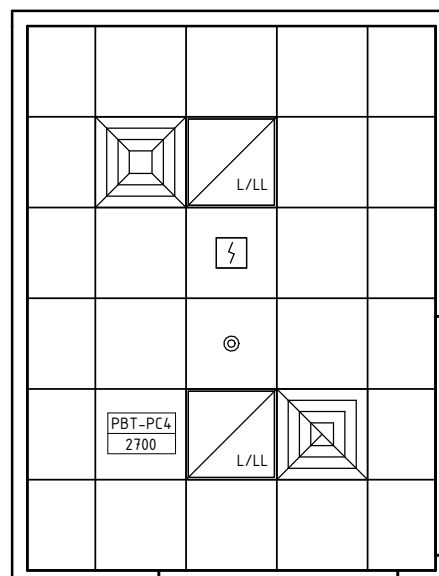
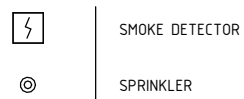

REFLECTED CEILING PLAN

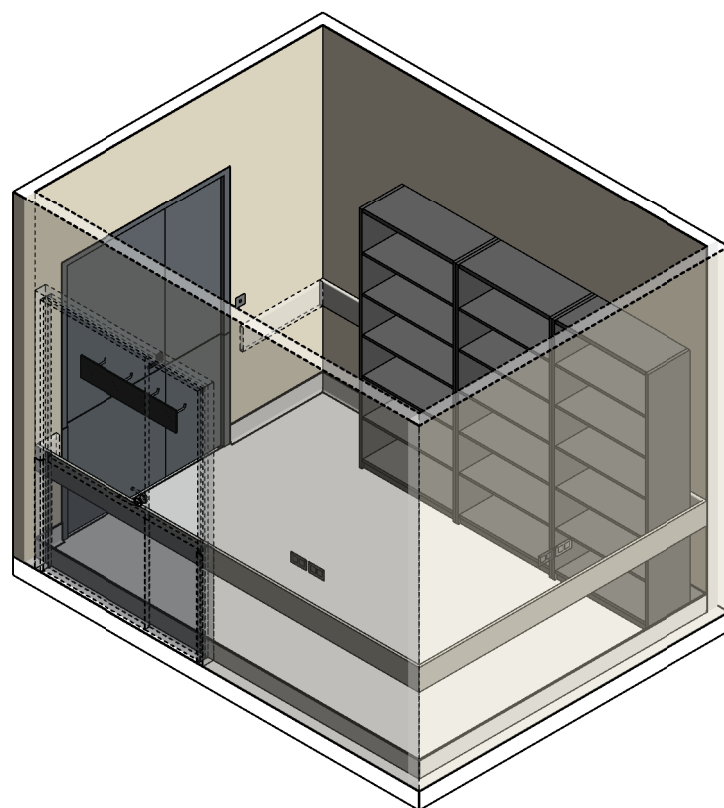

ISOMETRIC VIEW 01

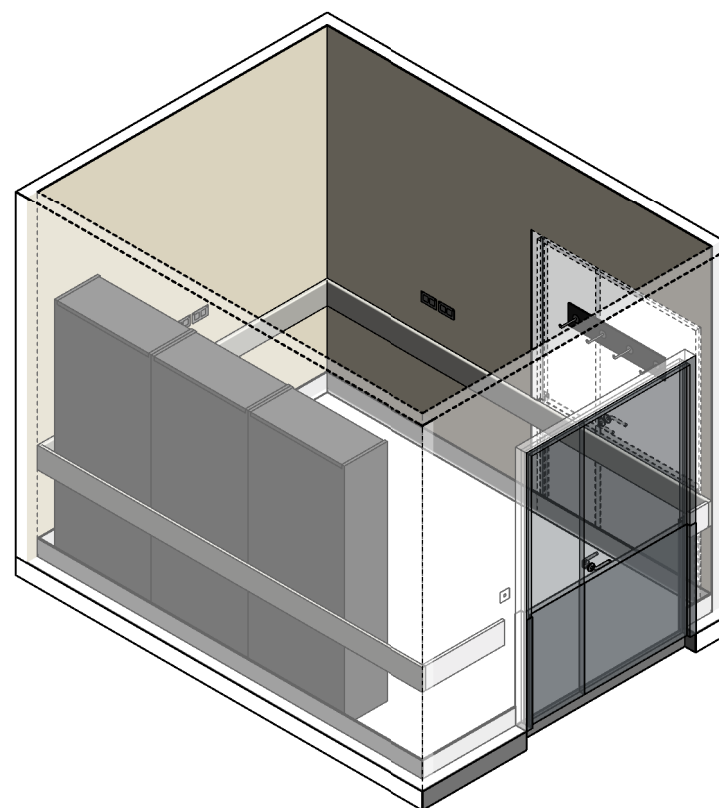

ISOMETRIC VIEW 02

REV	DESCRIPTION	DATE	BY	REV	DESCRIPTION	DATE	BY	COMPATIBILITY																				
1	FIRST ISSUE	24.10.10	CC	4	GENERAL REVISION	30.12.22	RA																					
2	GENERAL REVISION	30.08.11	SK																									
3	GENERAL REVISION	31.10.12	KC																									
International Health Facility Guidelines www.healthdesign.com.au/iHFG Editable version of Standard Components on Health Facility Briefing System (HFBS) at: www.healthdesign.com.au @TAHPI								<table border="1"> <tr> <th>DESIGNED</th> <th>APPROVED</th> <th>DATE</th> <th>SCALE(S)</th> <th>SHEET</th> </tr> <tr> <td>RA</td> <td>RH</td> <td>30.12.22</td> <td>1 : 50</td> <td>2 OF 2</td> </tr> <tr> <th colspan="2">REVIT FILE NAME</th> <th colspan="2">PAPER DRAWING ID</th> <th>ISSUE</th> </tr> <tr> <td colspan="2">steq-10-i</td> <td colspan="2">steq-10-i-2</td> <td>4</td> </tr> </table>	DESIGNED	APPROVED	DATE	SCALE(S)	SHEET	RA	RH	30.12.22	1 : 50	2 OF 2	REVIT FILE NAME		PAPER DRAWING ID		ISSUE	steq-10-i		steq-10-i-2		4
DESIGNED	APPROVED	DATE	SCALE(S)	SHEET																								
RA	RH	30.12.22	1 : 50	2 OF 2																								
REVIT FILE NAME		PAPER DRAWING ID		ISSUE																								
steq-10-i		steq-10-i-2		4																								