

# iHFG Standard Components

## Room Layout Sheet

RLS Room Code

steq-20-i

RDS Room Code

steq-20-i

Room Name **Store - Equipment, 20m<sup>2</sup>**

CR	CRASH RAIL
H/EQ	HOOK - EQUIPMENT
LS	LIGHT SWITCH
P0/2	POWER OUTLET - DOUBLE
RL/E	RAIL - EQUIPMENT
SHM	METAL SHELVING
SK4	FLOOR VINYL COVERED SKIRTING
V1	VINYL FLOORING, STANDARD SLIP RESISTANT
WPF	WALL PAINT FINISH

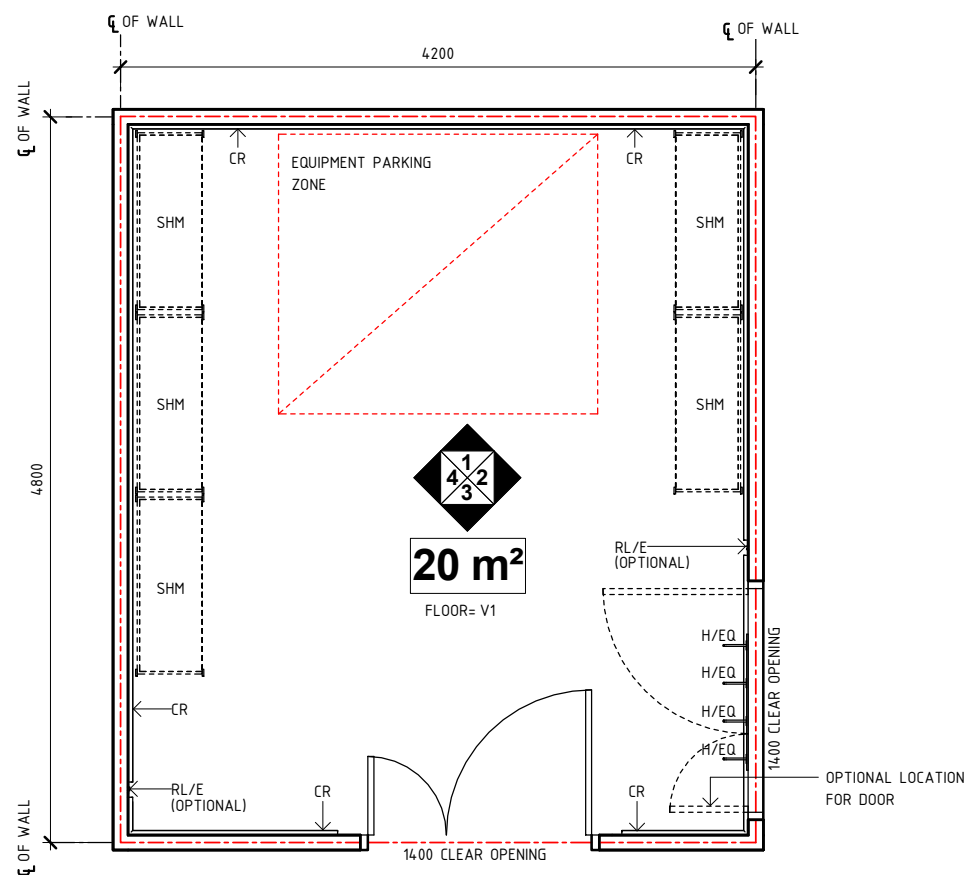

**PLAN**

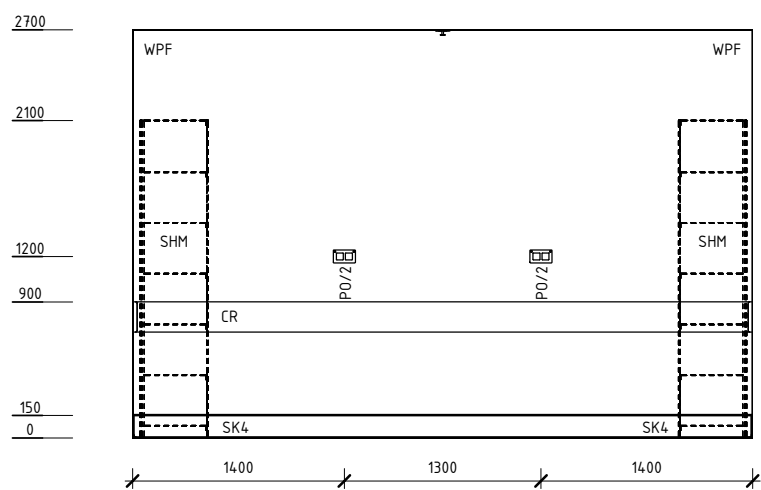

**ELEVATION 1**

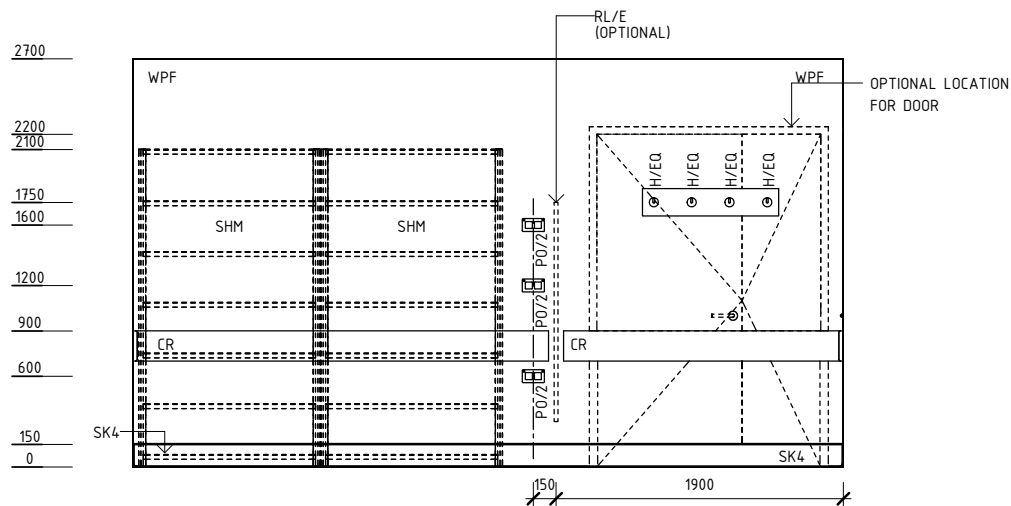

**ELEVATION 2**

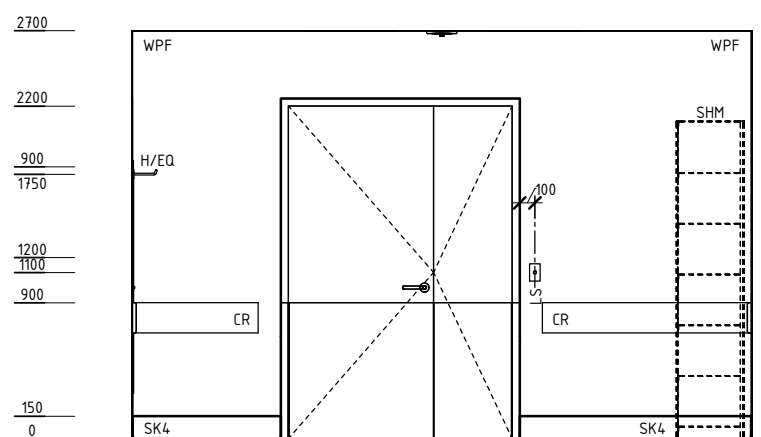

**ELEVATION 3**

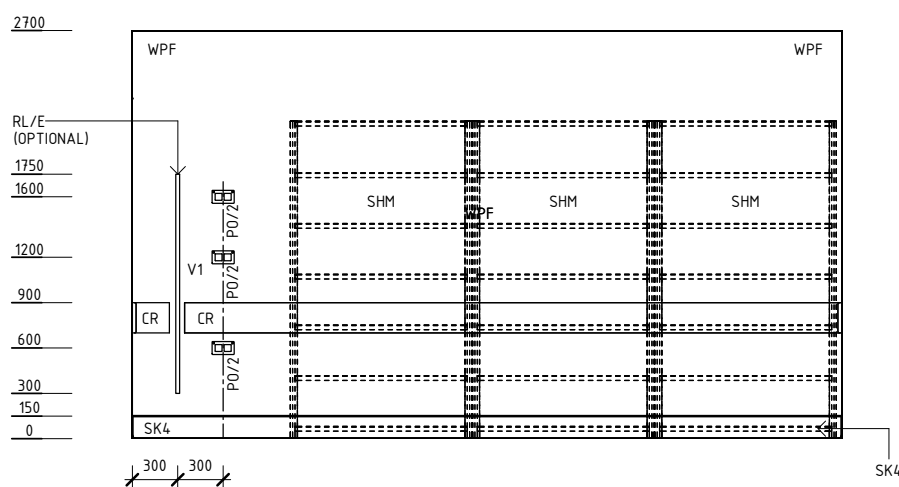

**ELEVATION 4**

REV	DESCRIPTION	DATE	BY	REV	DESCRIPTION	DATE	BY	COMPATIBILITY
1	FIRST ISSUE	08.01.14	NB					
2	GENERAL REVISION	30.12.22	RA					



International Health Facility Guidelines at:  
[www.healthdesign.com.au/iHFG](http://www.healthdesign.com.au/iHFG)  
 Editable version of Standard Components on  
 Health Facility Briefing System (HFBS) at:  
[www.healthdesign.com.au](http://www.healthdesign.com.au) ©TAHPI



DESIGNED	APPROVED	DATE	SCALE(S)	SHEET
RA	RH	30.12.22	1 : 50	1 OF 3
REVIT FILE NAME		PAPER DRAWING ID		ISSUE
steq-20-i		steq-20-i-1		2

# iHFG Standard Components

## Room Layout Sheet

RLS Room Code

steq-20-i

RDS Room Code

steq-20-i

Room Name

Store - Equipment, 20m<sup>2</sup>

### GENERAL NOTES:

THIS DRAWING TO BE READ IN CONJUNCTION WITH R.D.S. (ROOM DATA SHEETS) WHICH TAKES PRECEDENCE.

ALL SERVICES INDICATED ARE INDICATIVE AND SUBJECTED TO DETAILED PROJECT SPECIFIC ENGINEERING DESIGN.

### CEILING LEGEND:

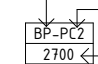
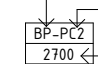
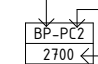
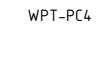
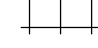
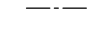
-  CEILING TYPE
-  CORNICE TYPE
-  HEIGHT ABOVE F.F.L.
-  WATER RESISTANT, DROP IN TILES WITH POWDERCOAT ALUMINIUM CORNICE, SHADOW ANGLE 24mm
-  TILE CEILING GRID (600 x 600)
-  GRID LINE

### ELECTRICAL LEGEND:

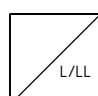
-  LIGHT - LED LIGHT

### MECHANICAL LEGEND:

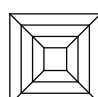
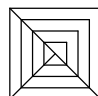
-  SUPPLY AIR GRILLE
-  EXHAUST GRILLE

### FIRE SERVICES LEGEND:

-  SMOKE DETECTOR
-  SPRINKLER

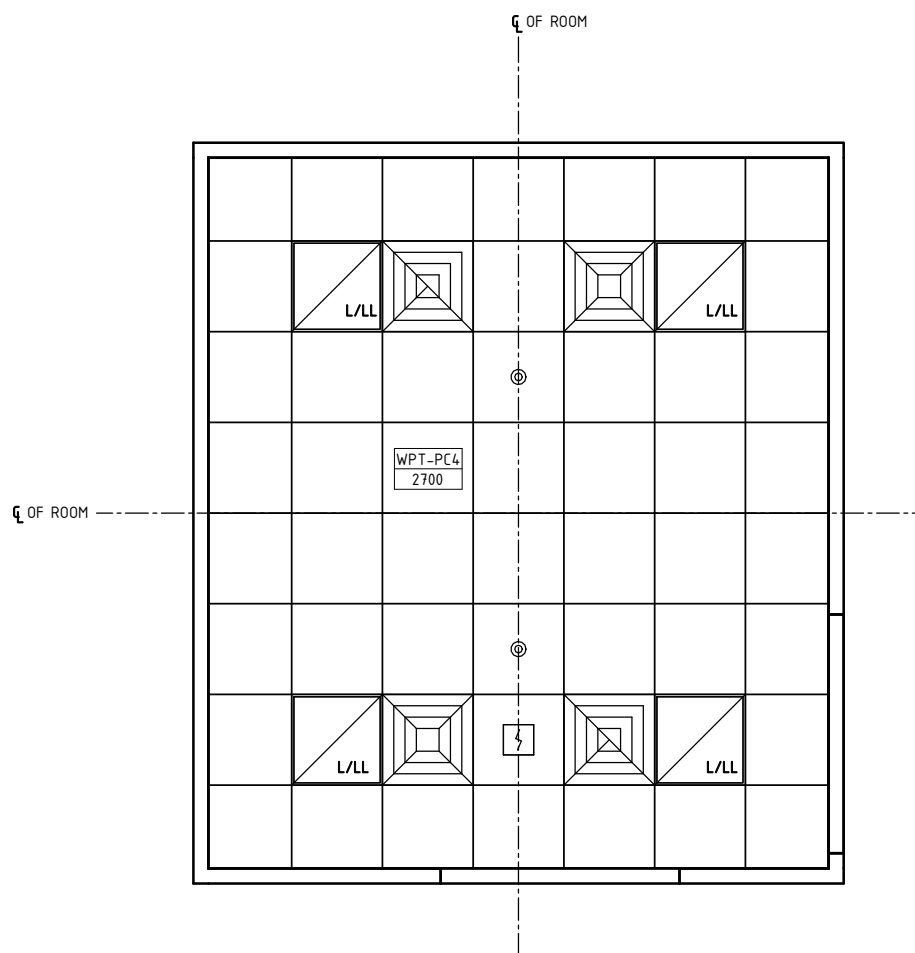

**REFLECTED CEILING PLAN**

REV	DESCRIPTION	DATE	BY	REV	DESCRIPTION	DATE	BY	COMPATIBILITY
1	FIRST ISSUE	08.01.14	NB					iHFG
2	GENERAL REVISION	30.12.22	RA					

DESIGNED	APPROVED	DATE	SCALE(S)	SHEET
RA	RH	30.12.22	1 : 50	2 OF 3

REVIT FILE NAME	PAPER DRAWING ID	ISSUE
steq-20-i	steq-20-i-2	2

# iHFG Standard Components

Room Layout Sheet

RLS Room Code

steq-20-i

RDS Room Code

steq-20-i

Room Name

Store - Equipment, 20m<sup>2</sup>

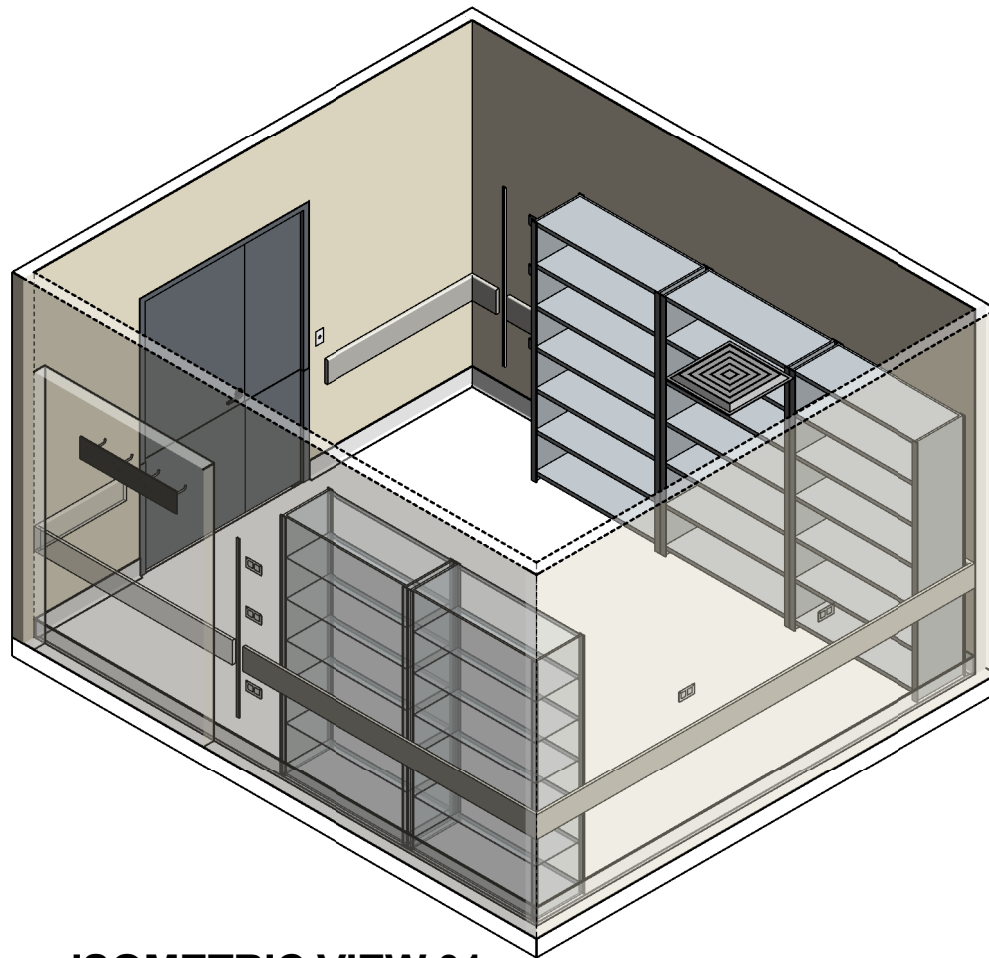

**ISOMETRIC VIEW 01**

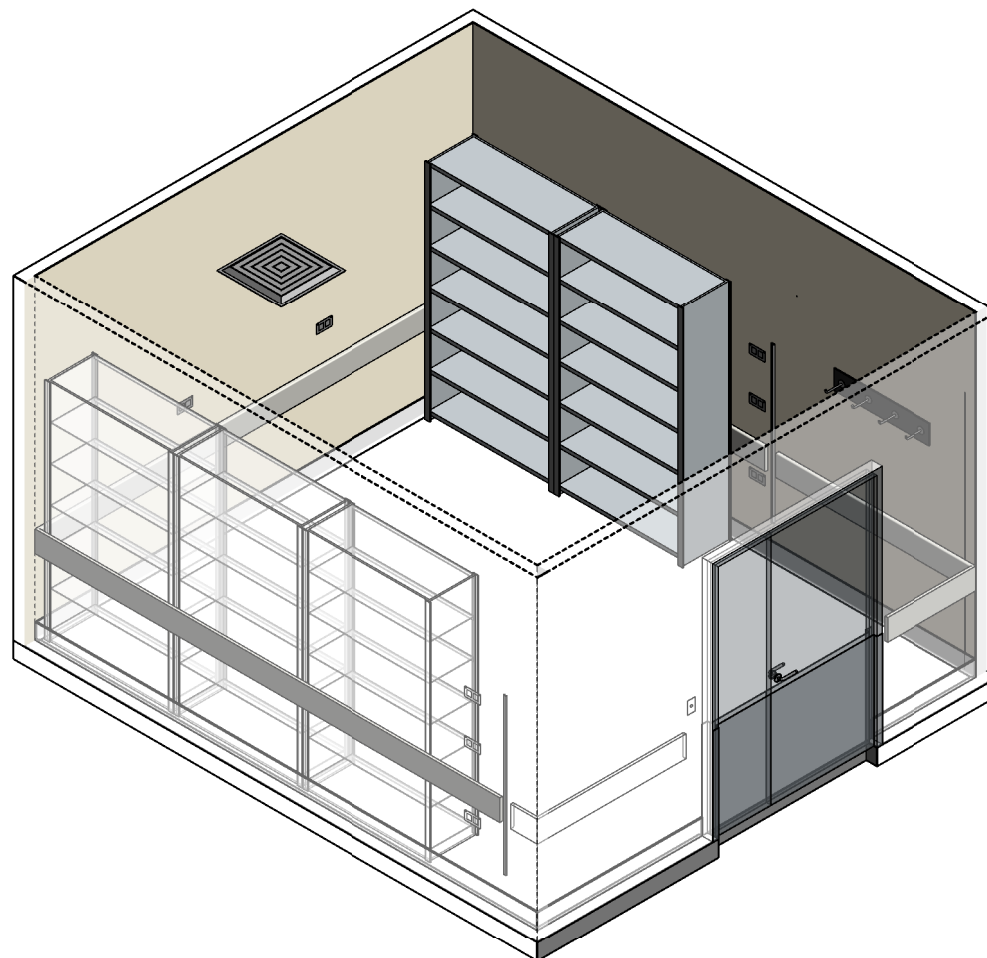

**ISOMETRIC VIEW 02**

REV	DESCRIPTION	DATE	BY	REV	DESCRIPTION	DATE	BY	COMPATIBILITY
1	FIRST ISSUE	08.01.14	NB					
2	GENERAL REVISION	30.12.22	RA					



International Health Facility Guidelines at:  
[www.healthdesign.com.au/iHFG](http://www.healthdesign.com.au/iHFG)  
 Editable version of Standard Components on  
 Health Facility Briefing System (HFBS) at:  
[www.healthdesign.com.au](http://www.healthdesign.com.au) ©TAHPI



DESIGNED	APPROVED	DATE	SCALE(S)	SHEET
RA	RH	30.12.22		3 OF 3
REVIT FILE NAME		PAPER DRAWING ID		ISSUE
steq-20-i		steq-20-i-3		2

This document is for advisory purpose only