

iHFG Standard Components

Room Layout Sheet

Room Name | **Store - Files, 8m2**

RLS Room Code

stfs-8-i

RDS Room Code

stfs-8-i

COM/1	COMMUNICATION OUTLET - SINGLE	SHM	METAL SHELVING
COM/2	COMMUNICATION OUTLET - DOUBLE	SK4	FLOOR VINYL COVED SKIRTING
DFP	DOOR AND DOOR FRAME PROTECTION	SUC	SHELVING UNIT - COMPACTUS
LS/R	LIGHT SWITCH - ROOM	TP/WM	TELEPHONE - WALL MOUNTED
P0/2	POWER OUTLET - DOUBLE	V1	VINYL FLOORING, STANDARD SLIP RESISTANT
		WPF	WALL PAINT FINISH

OPTION 1- STATIC SHELVING PLAN

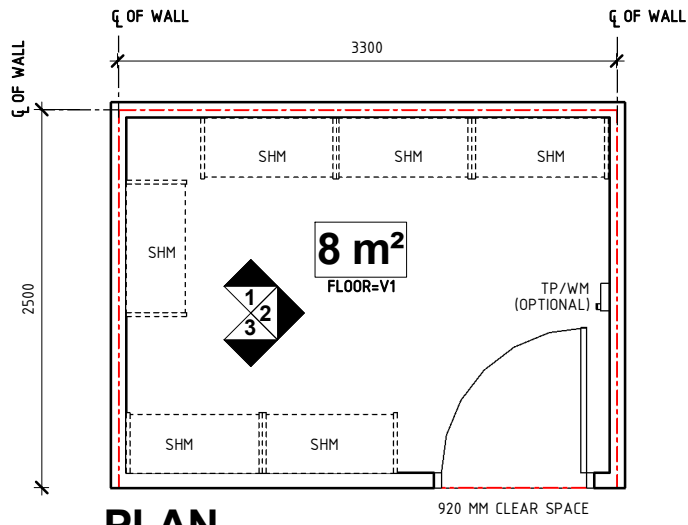

PLAN

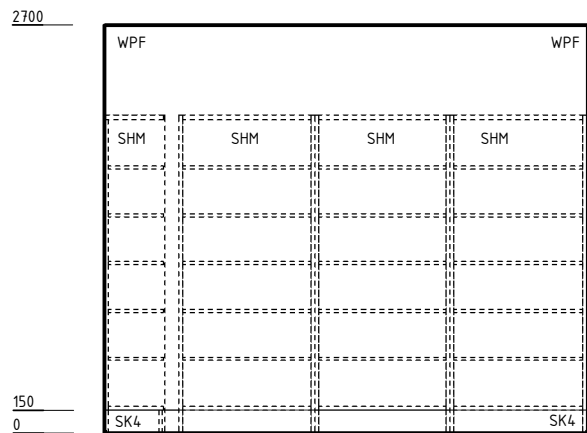

ELEVATION 1

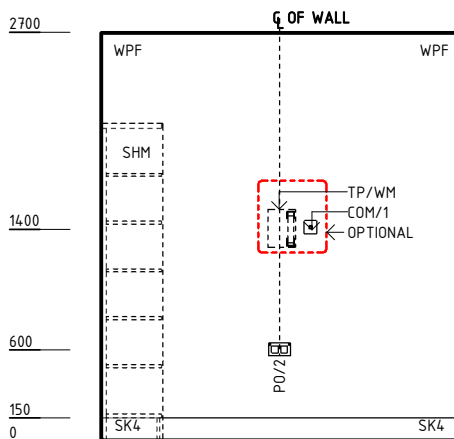

ELEVATION 2

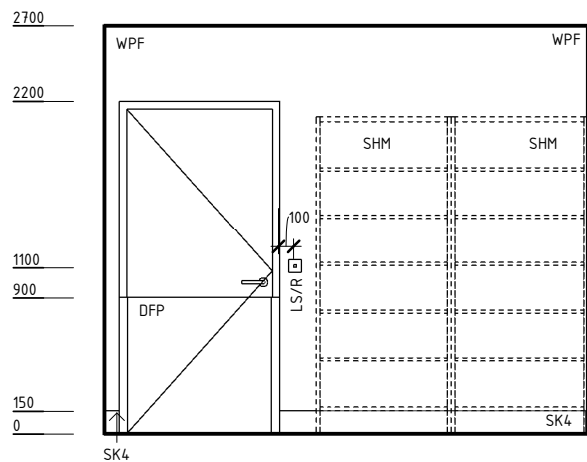

ELEVATION 3

OPTION 2- COMPACTUS SHELVING PLAN

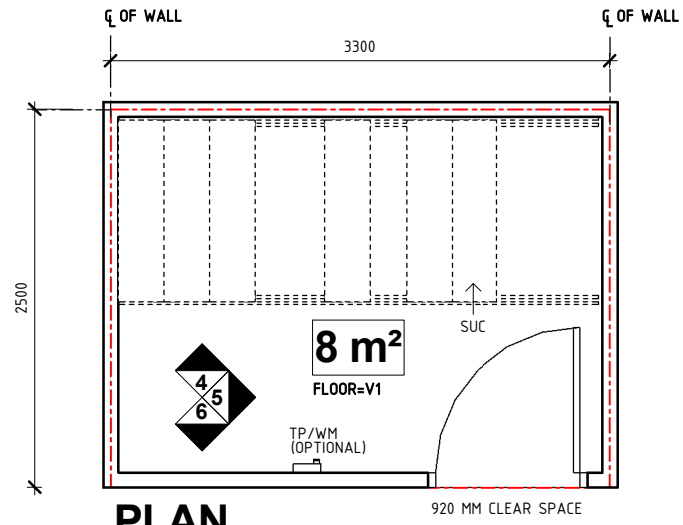

PLAN

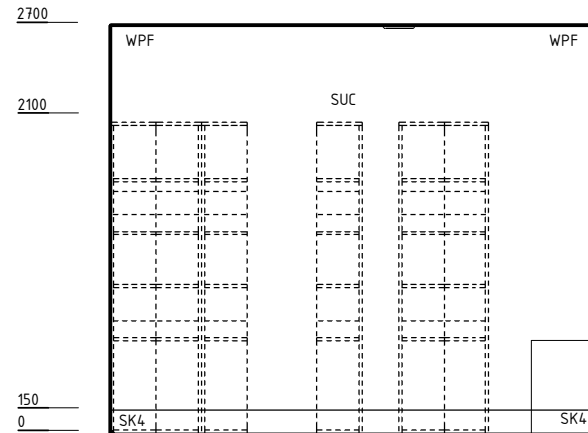

ELEVATION 4

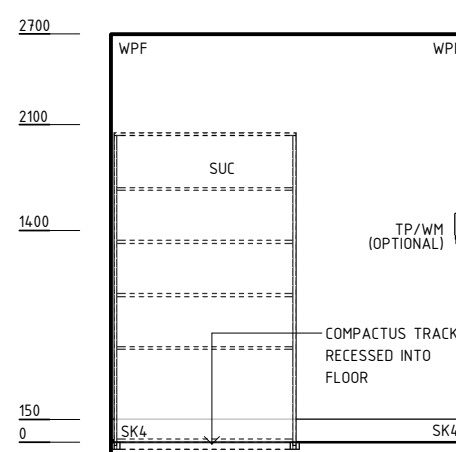

ELEVATION 5

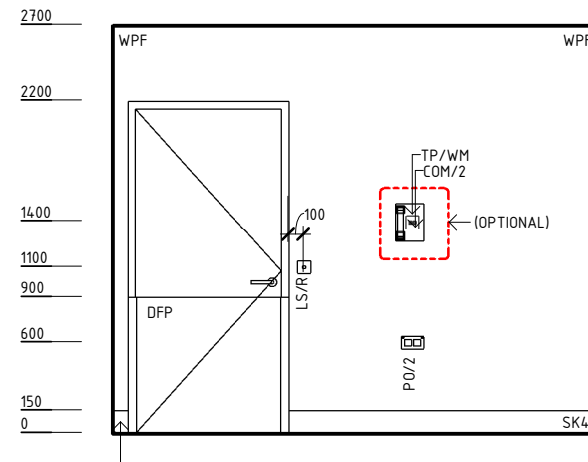

ELEVATION 6

REV	DESCRIPTION	DATE	BY	REV	DESCRIPTION	DATE	BY	COMPATIBILITY
1	FIRST ISSUE	24.10.12	CC	4	GENERAL REVISION	25.05.23	SS	
2	GENERAL REVISION	30.08.11	SK					
3	GENERAL REVISION	31.10.12	KC					

International Health Facility Guidelines	International Health Facility Guidelines at: www.healthdesign.com.au/iHFG Editable version of Standard Components on Health Facility Briefing System (HFBS) at: www.healthdesign.com.au ©TAHPI		DESIGNED SS	APPROVED SA	DATE 25.05.23	SCALE(S) 1 : 50	SHEET 1 OF 2
	REVIT FILE NAME stfs-8-i		PAPER DRAWING ID stfs-8-i-1		ISSUE 4		

iHFG Standard Components

Room Layout Sheet

RLS Room Code

stfs-8-i

RDS Room Code

stfs-8-i

Room Name

Store - Files, 8m2

GENERAL NOTES:

THIS DRAWING TO BE READ IN CONJUNCTION WITH R.D.S. (ROOM DATA SHEETS) WHICH TAKES PRECEDENCE.

ALL SERVICES INDICATED ARE INDICATIVE AND SUBJECT TO DETAILED PROJECT SPECIFIC ENGINEERING DESIGN.

CEILING LEGEND:

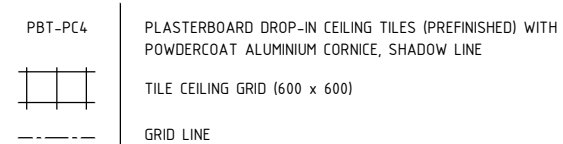

ELECTRICAL LEGEND:

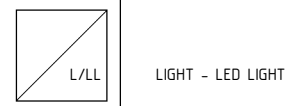

MECHANICAL LEGEND:



FIRE SERVICES LEGEND:

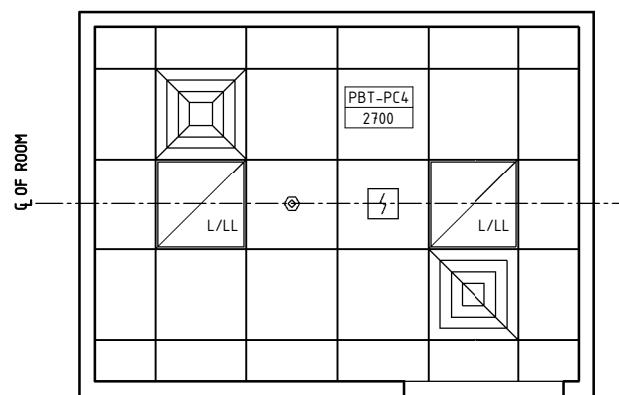

**REFLECTED CEILING PLAN
OPTION 1- STATIC SHELVING PLAN**

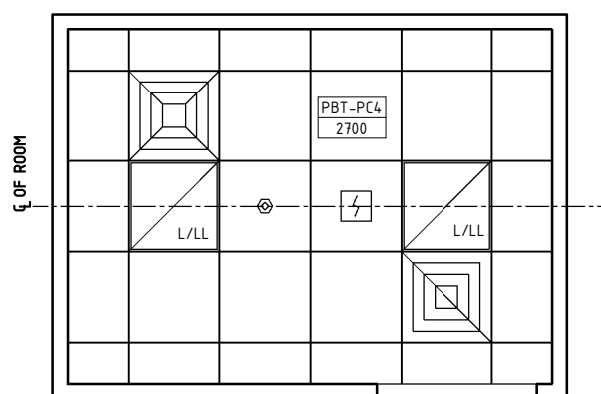

**REFLECTED CEILING PLAN
OPTION 2- COMPACTUS SHELVING PLAN**

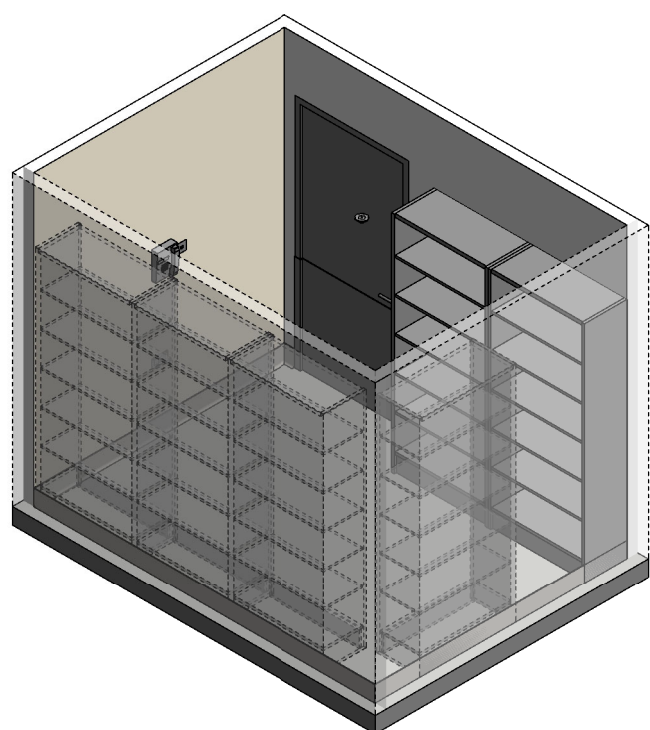

ISOMETRIC VIEW- OPTION1

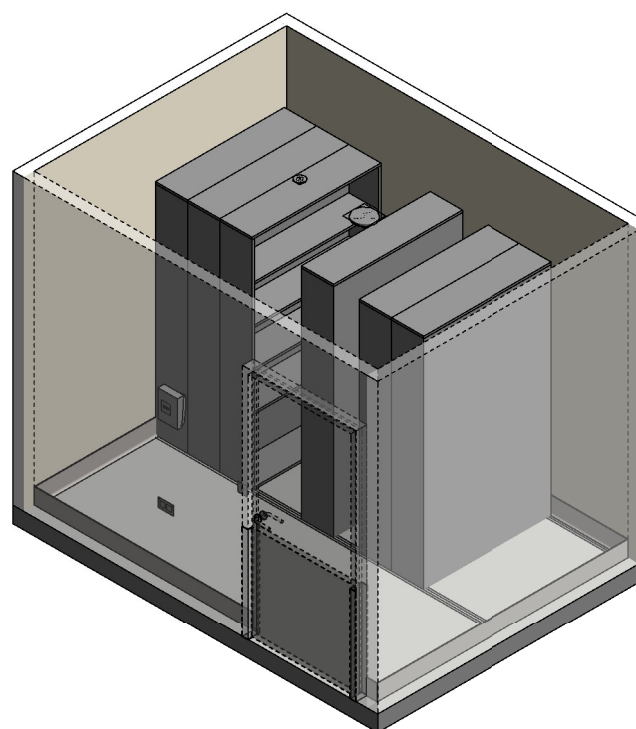

ISOMETRIC VIEW -OPTION-2

REV	DESCRIPTION	DATE	BY	REV	DESCRIPTION	DATE	BY	COMPATIBILITY																				
1	FIRST ISSUE	24.10.12	CC	4	GENERAL REVISION	25.05.23	SS																					
2	GENERAL REVISION	30.08.11	SK																									
3	GENERAL REVISION	31.10.12	KC																									
International Health Facility Guidelines www.healthdesign.com.au/iHFG Editable version of Standard Components on Health Facility Briefing System (HFBS) at: www.healthdesign.com.au ©TAHPI								<table border="1"> <tr> <th>DESIGNED</th> <th>APPROVED</th> <th>DATE</th> <th>SCALE(S)</th> <th>SHEET</th> </tr> <tr> <td>SS</td> <td>SA</td> <td>25.05.23</td> <td>1 : 50</td> <td>2 OF 2</td> </tr> <tr> <th colspan="2">REVIT FILE NAME</th> <th>PAPER DRAWING ID</th> <th colspan="2">ISSUE</th> </tr> <tr> <td colspan="2">stfs-8-i</td> <td>stfs-8-i-2</td> <td colspan="2">4</td> </tr> </table>	DESIGNED	APPROVED	DATE	SCALE(S)	SHEET	SS	SA	25.05.23	1 : 50	2 OF 2	REVIT FILE NAME		PAPER DRAWING ID	ISSUE		stfs-8-i		stfs-8-i-2	4	
DESIGNED	APPROVED	DATE	SCALE(S)	SHEET																								
SS	SA	25.05.23	1 : 50	2 OF 2																								
REVIT FILE NAME		PAPER DRAWING ID	ISSUE																									
stfs-8-i		stfs-8-i-2	4																									

This document is for advisory purpose only